

**GROUND FLOOR FLAT**  
**219 GOLDHURST TERRACE**  
**LONDON, NW6 3EP**

**SCALE 1:50**  
**DRAWN MARCH 2008**

The extension walls are to be brick blockwork cavity walls with the external brick skin matching the existing rear walls in London Stocks, with a red brick soldier course over the new openings. The flat roof is to be finished in asphalt. The windows and roof light are to be timber framed double glazed units.

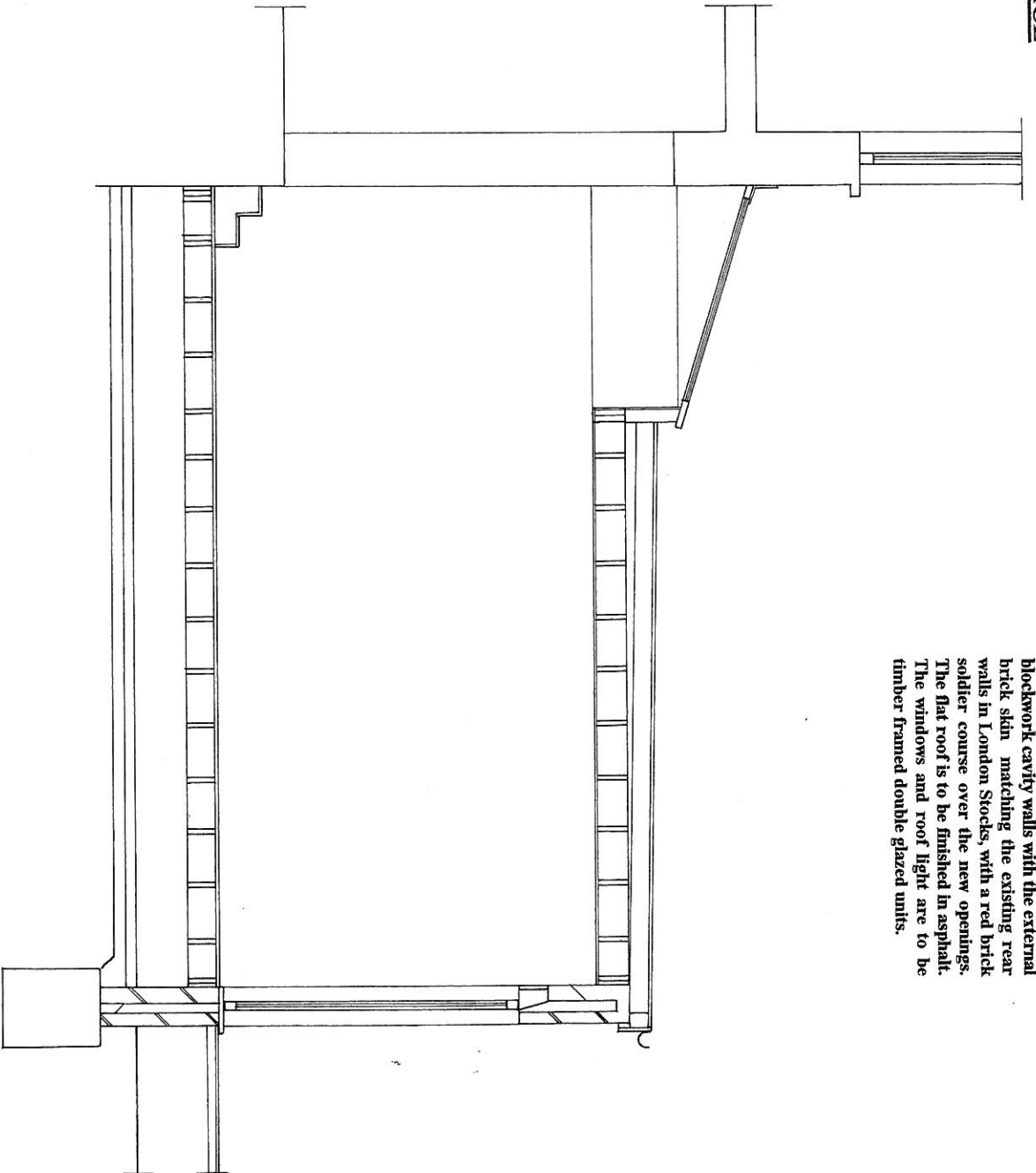

- NOTES**
1. Drawing for Local Authority approval only.
  2. Drawing not to be scaled.
  3. The builder is to check all dimensions on site.
  4. No responsibility is taken for checking legal ownership of site, covenants thereon and position of boundaries.
  5. All electrics are to be in accordance with the relevant IEE regulations.
  6. All workmanship and materials are to comply with the British Standards, Codes of Practice and manufacturers instructions.

**PROPOSED SECTION**

**PLAN NO 219GT/MZ/16**