

ALL INFORMATION REMAINS THE PROPERTY OF THE ARCHITECT AND MAY NOT BE USED FOR ANY PURPOSE WHATSOEVER, OR REPRODUCED THROUGH ANY MEDIUM WITHOUT THE WRITTEN PERMISSION OF THE ARCHITECT. NO RESPONSIBILITY ACCEPTED FOR UNAUTHORISED USE.

4 The Glasshouse
49A Goldhawk Road
London W12 8QP

T: +44(0)20 8743 4401
E: info@neildaviesarchitects.com

NOTES

IN COLLABORATION WITH

**Eckersley
O'Callaghan**

A Issued for planning 26/01/18

PLANNING

PROJECT CHALCOTS ESTATE
TITLE Blashford Parapet Sections
JOB NO 114
SCALE 1:10 @ A3
DATE 22/12/17
DRAWN BY SN
CHECKED BY ND
DWG NO 324
REVISION A

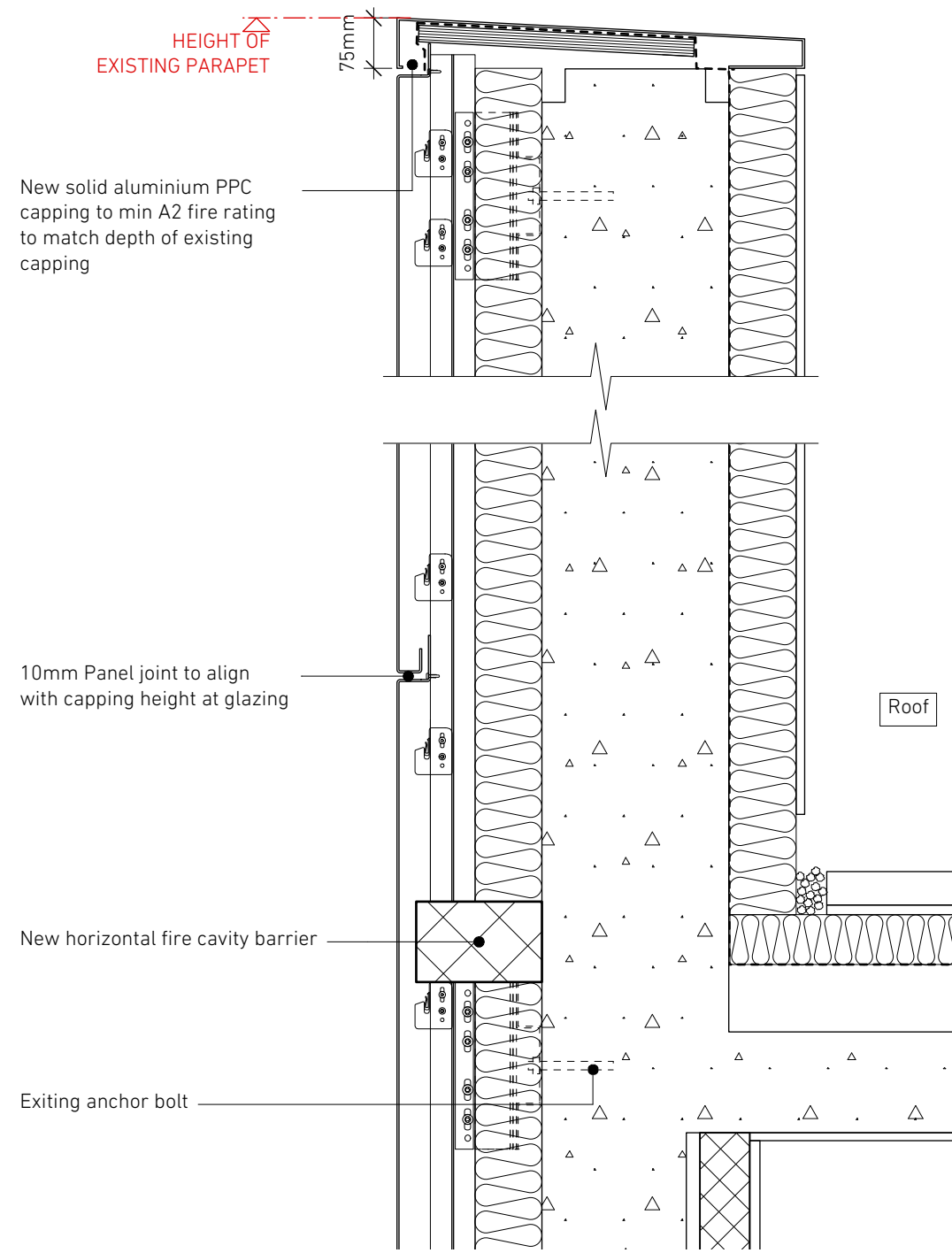

1 Cladding Parapet Section - Blashford
1:10 @ A3

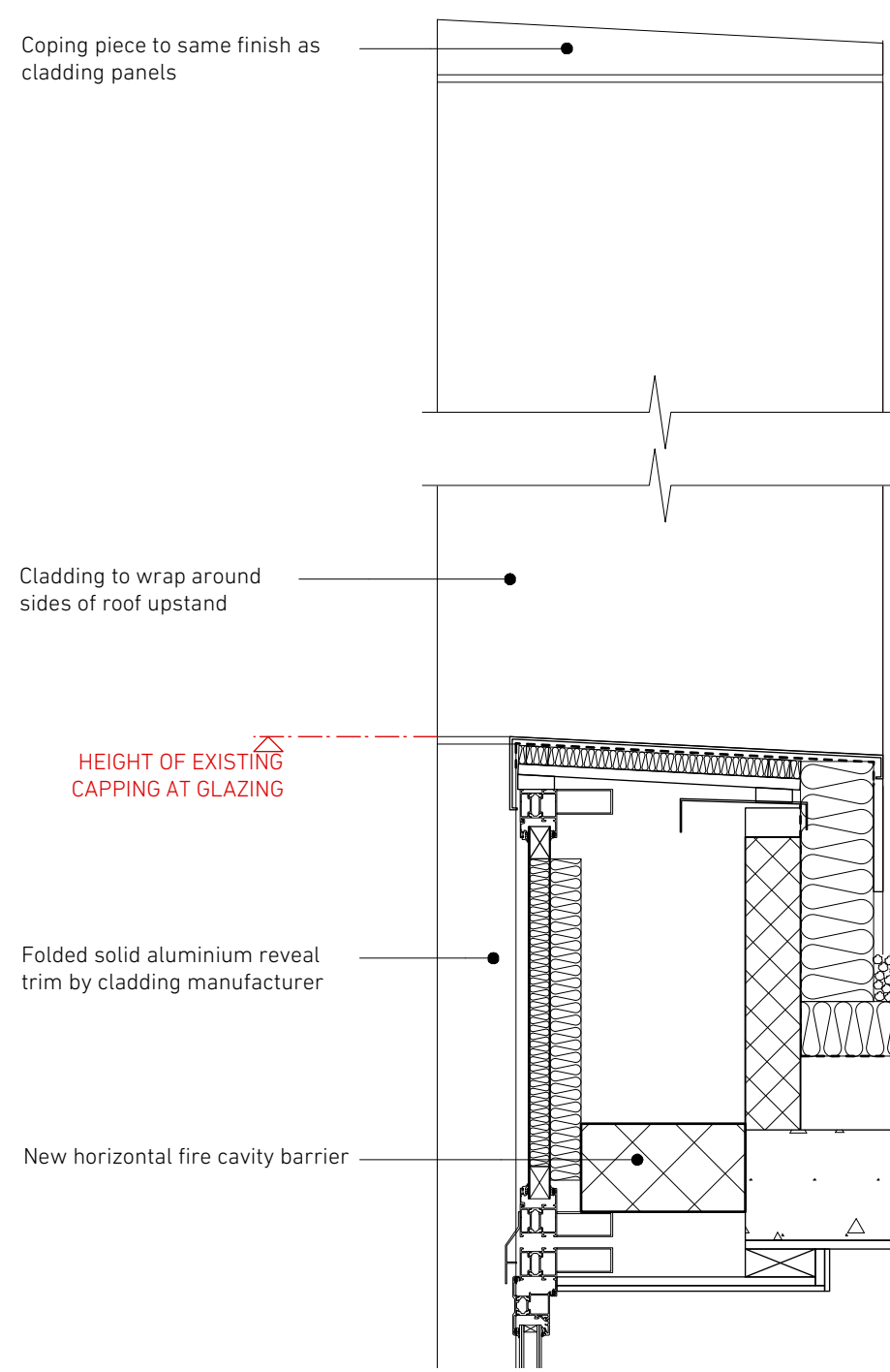

2 Glazing Parapet Section - Blashford
1:10 @ A3

