

NOTE

- ① FIXED GLAZED ROOFLIGHT
- ② ZINC/ LEAD FLAT ROOF
- ③ BOX-GUTTER
- ④ ALUMINIUM COPPING (POWDERCOATED FINISH)
- ⑤ ALUMINIUM GLAZED SLIDING DOORS
- ⑥ FIXED GLAZING
- ⑦ DOUBLE-GLAZED TIMBER WINDOW
- ⑧ ALUMINIUM DRAINAGE HOPPER & RAINWATER PIPES (PPC FINISH)
- ⑨ TIMBER DOOR
- ⑩ EXPOSED STEEL BEAM BELOW (SHOWN DOTTED)
- ⑪ FACED BRICK WALL
- ⑫ TRANSLUCENT FIXED GLAZING
- ⑬ SILICONE JOINTS

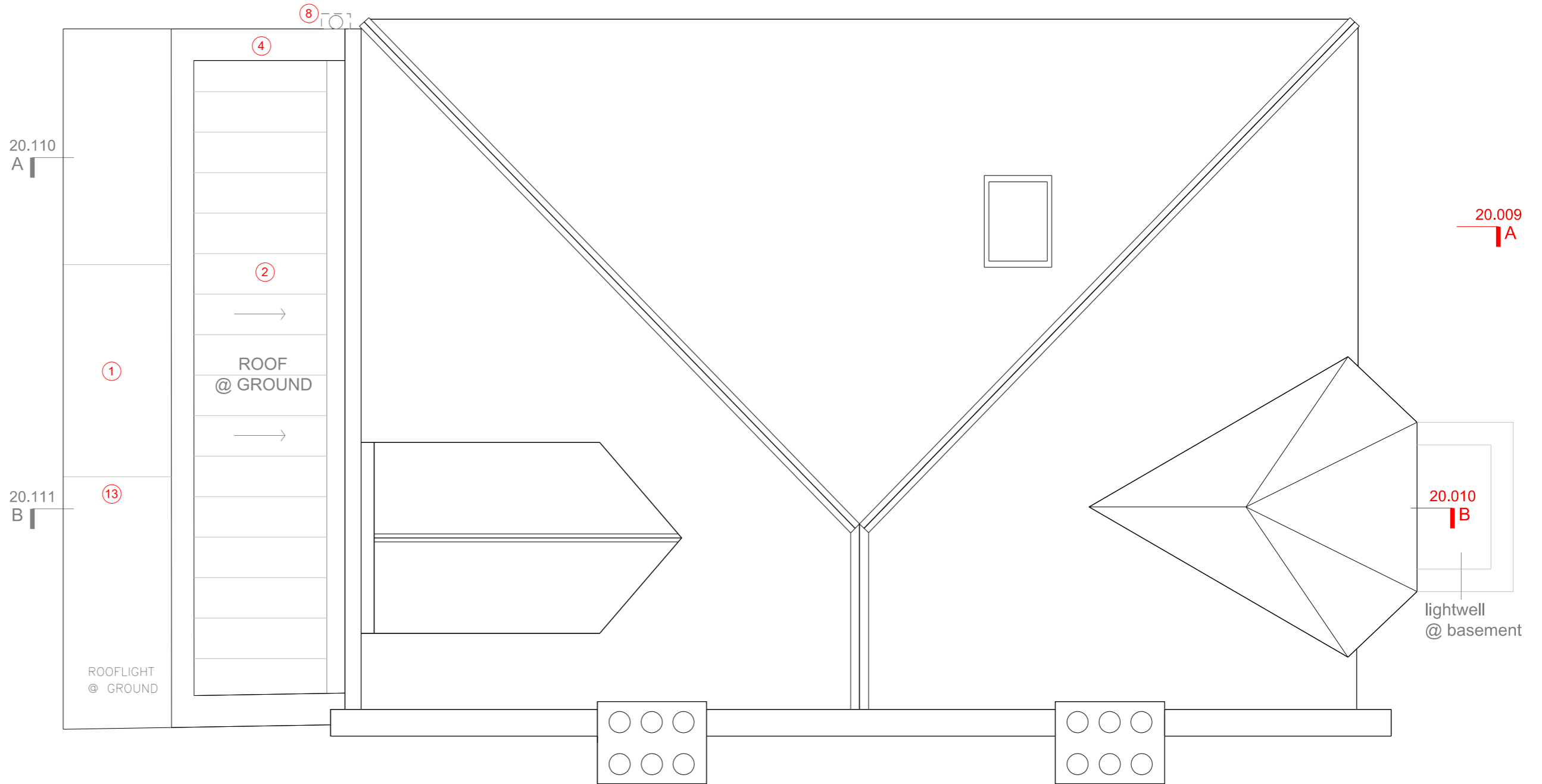

1 PROPOSED ROOF PLAN
- REAR EXTENSION

REVISION	DATE	DESCRIPTION
-	10 NOV 2017	ISSUED FOR PRIOR APPROVAL APPLICATION (LARGER REAR EXTENSION) - DRAFT
A	04 DEC 2017	ISSUED FOR PRIOR APPROVAL APPLICATION (LARGER REAR EXTENSION)
B	14 DEC 2017	ISSUED FOR PRIOR APPROVAL APPLICATION (LARGER REAR EXTENSION) - SCALE BAR REVISED
C	14 DEC 2017	ISSUED FOR PRIOR APPROVAL APPLICATION (LARGER REAR EXTENSION) - VALIDATION
D	26 JAN 2018	ISSUED FOR LAWFULNESS DEVELOPMENT CERTIFICATE (LARGER REAR EXTENSION)

NOTES:

- THIS IS A "SCHEME LEVEL DRAWING" AND IS INTENDED TO ILLUSTRATE THE GENERAL ARRANGEMENT OF THE PROJECT PROPOSALS FOR THE PURPOSE OF PLANNING APPLICATION
- THIS DRAWING MUST NOT BE USED FOR CONSTRUCTION
- DO NOT SCALE FROM THIS DRAWING
- ALL DIMENSIONS MUST BE VERIFIED FROM SITE

CLIENT	MR JONATHAN & CHARLOTTE AYRES
PROJECT	52 MINSTER ROAD LONDON NW2 3RE: REAR EXTENSION
TITLE	PROPOSED ROOF PLAN
DWG No	1085.2 20.105 D SCALE 1:50 @ A3

ERICA JONG ARCHITECTS
ARCHITECTURE DESIGN MANAGEMENT

48 Fairhazel Gardens London NW6 3SJ
T [0]207 372 5768
E info@ericajongarchitects.com
www.ericajongarchitects.com