

Site or package LTMP for: Cumberland Market gas main diversion

Authority: London Borough of Camden

<p>1. The transport context</p>	
<p>High Speed 2 in Camden</p>	<p>The site is at the junction of Cumberland Market and Augustus Street, NGR 529008, 182832.</p>
<p>The overall scope of construction and main feature and high level timetable</p>	<p>The works comprise diversion of National Grid gas mains, to enable planned Thames Water diversionary works for HS2 (Euston 42" Trunk Main Diversion). The works are required to clear space for a connection to the existing 42" trunk main in Cumberland Market.</p> <p>The works will be completed in two phases:</p> <p>Phase 1 (start date 4/12/17, duration 1-2 weeks) - local diversion of a 90mm gas main (green) and temporary abandonment of a section of 180mm / 90mm gas main by excavation and capping at either end (yellow).</p> <p>Phase 2 (start date TBC) - reinstatement of the abandoned 180mm gas main (pink) around completed Thames Water works.</p>

Documentation which precedes the production of the LTMP and how it fits with the LEMP	<ul style="list-style-type: none"> • Environmental Statement (ES) • Code of Construction Practice (CoCP)
On-going liaison processes - TLG and other liaison (e.g. NRSWA)	Traffic liaison group meetings with London Borough of Camden. Traffic management proposals submitted and approved by London Borough of Camden via. NRSWA process.
The security context	Heras Fencing and standard SLG will be used to secure the site.
2. The TMP context	
Purpose of the TMP	The TMP is to allow the safe execution of the works for all parties including General Public and Traffic.
Scope of the TMP	The TMP is specific to the gas main works at Cumberland Market / Augustus Street
Structure of the local TMP	<p>The works will be completed in two sections with temporary three way traffic lights installed to manage traffic flow for both sections of work.</p> 

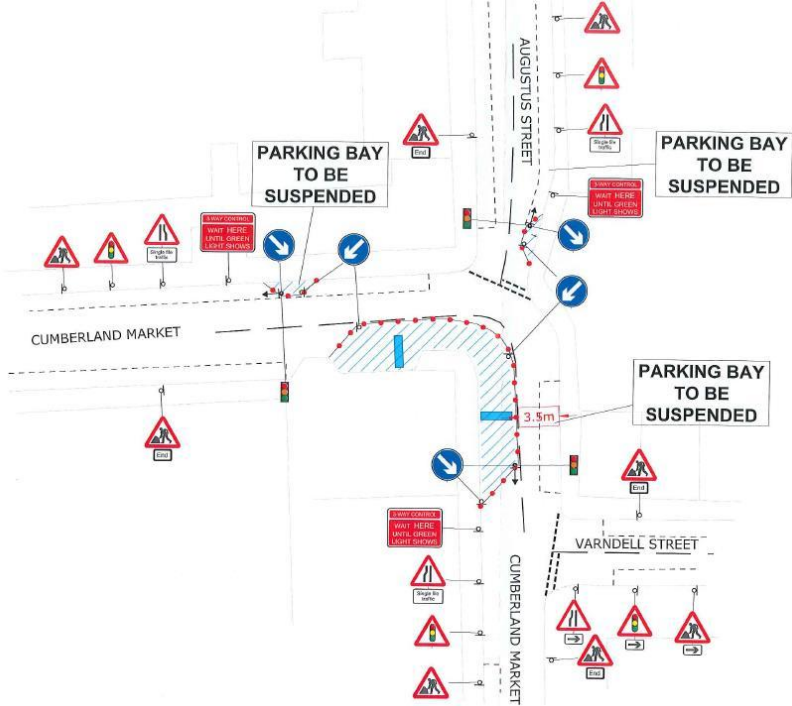
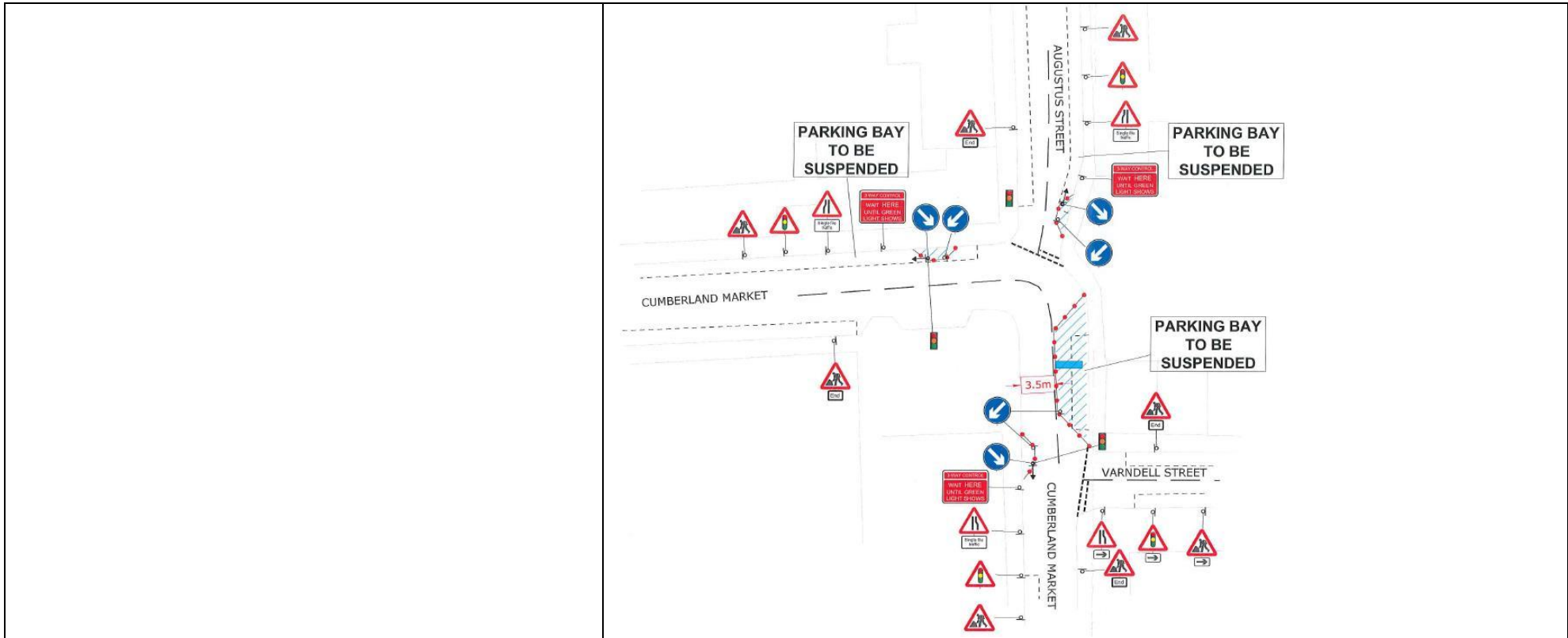

3. Transport networks and services

Road networks and significant construction changes	The following roads are affected: <ul style="list-style-type: none"> • Cumberland Market (North and East sides) • Augustus Street
Amendments to traffic, bus, cycle, walking and riding routes (including footpaths)	Three-way temporary traffic signals will be in place for the duration of the works. No road closures are required and there is a low impact on traffic.
Predicted impacts of longer road closures on social care transport and school journeys	N/A - no road closure required.
Impacts of road closures on emergency service travel from ambulance stations and fire stations and to A&E hospitals	N/A - no road closure required.

4. Temporary highway works

Worksites and access points for construction activities	The works will be contained to a single site local to the Cumberland Market / Augustus Street junction. Access will be directly to the worksite.
Temporary highway works to deliver the project	Not required.

Expected scope/sequence of significant highway works to deliver permanent works	Not required.
Temporary traffic management programme (including footpath diversions)	Traffic management proposals submitted to Camden council through NRWSA process and approved.
Temporary traffic modelling	Not required.
Road safety audit schedule	Not required.
Local direction signing requirements for emergency services and deliveries	Not required, no road closure.
Signals design requirements and procurement	Not required.
5. Road Network Management	
Temporary access points	Site will be access directly.
6. Managing construction movements	
Expected working hours (including start up and close down) (and hence time of traffic movements)	Core hours as per the CoCP Site hours 07.30 – 17.30 Monday - Friday with no noisy activity before 08.00hrs and after 17.00hrs and Saturday morning 07.30 – 13.00
Contractor forecast flows by vehicle types and activities	Vehicular access required to site for: <ul style="list-style-type: none"> • Delivery and collection of plant at start and finish of the project • Engineering team vehicle hi top transit to site (daily) • Support vehicle half truck transit to site (daily) • 7.5ton flat back reinstatement vehicle (2-3 days, daily) • 26 ton grab lorry removal of spoil and backfill (2 days approx.)
Local worksite capacities, holding areas and other local measures	N/A
U&As restrictions vehicle flows	N/A
7. Workforce transport	
Local travel plan(s) which will be prepared and associated monitoring	N/A

Appendices

Undertakings and
Assurances



Copy of
UC06-AAL-UT-PLN-01