

## Middlesex

### Published 1882

#### Source map scale - 1:10,560

The historical maps shown were reproduced from maps predominantly held at the Ordnance Survey, and Scotland in the 1840's. In 1854 the Ordnance Survey adopted the Cassini Projection for its maps. The maps were used to update the 1:10,560 maps. The published date when there are often some years later than the surveyed date. Before 1938, all OS maps were based on the Cassini Projection, with independent surveys in outlying areas. In the late 1940's, a Provisional Edition was produced, which updated the 1:10,560 mapping from a number of sources. The maps appear 'unfinished', with all military camps and other strategic sites removed. These maps were initially overprinted with the National Grid. In 1970, the first 1:10,000 maps were produced using the Transverse Mercator Projection. The revision process continued until recently, with new editions appearing every 10 years or so for urban areas.

#### Map Name(s) and Date(s)



#### Historical Map - Slice A

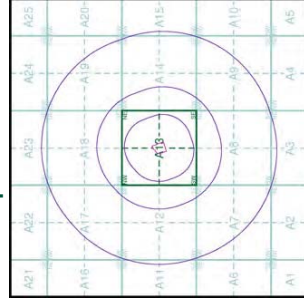

#### Order Details

Order Number: 76872908\_1\_1  
 Customer Ref: C145  
 National Grid Reference: 529060, 182360  
 Slice: A  
 Site Area (Ha): 0.85  
 Search Buffer (m): 1000

#### Site Details

Essensys Co. UK, 1 Triton Square, LONDON, NW1 3DX



## London

### Published 1896

### Source map scale - 1:10,560

The historical maps shown were reproduced from maps predominantly held at the Ordnance Survey archives in England, Wales and Scotland in the 1940's. In 1854 the Ordnance Survey was established and the first OS maps were produced. These were used to update the 1:10,560 maps. The published date given therefore refers to the date of the original map, not the date when the map was reproduced. The maps were based on the Cassini Projection, with independent surveys of a single county or group of counties, giving rise to significant inaccuracies in outlying areas. In the late 1940's, a Provisional Edition was produced, which updated the 1:10,560 mapping from a number of sources. The maps appear 'unfinished', with all military camps and other strategic sites removed. These maps were initially overprinted with the National Grid. In 1970, the first 1:10,000 maps were produced using the Transverse Mercator Projection. The revision process continued until recently, with new editions appearing every 10 years or so for urban areas.

### Map Name(s) and Date(s)

007NW	1896
1:10,560	
007SW	1896
1:10,560	

### Historical Map - Slice A

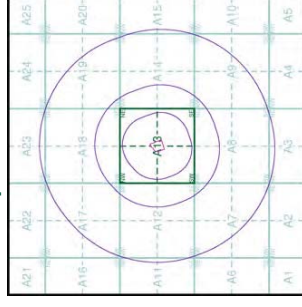

### Order Details

Order Number: 76872908\_1\_1  
 Customer Ref: C145  
 National Grid Reference: 529060, 182360  
 Slice: A  
 Site Area (Ha): 0.85  
 Search Buffer (m): 1000

### Site Details

Essensys Co. UK, 1 Triton Square, LONDON, NW1 3DX

## London

### Published 1920

#### Source map scale - 1:10,560

The historical maps shown were reproduced from maps predominantly held at a scale adopted for England, Wales and Scotland in the 1940's. In 1854 the Ordnance Survey published the first 1:10,560 maps. These maps are used to update the 1:10,560 maps. The published date given therefore often some years later than the surveyed date. Before 1938, all OS maps were based on the Cassini Projection, with independent surveys in cutting county or group of counties, giving rise to significant inaccuracies in cutting areas. In the late 1940's, a Provisional Edition was produced, which updated the 1:10,560 mapping from a number of sources. The maps appear unfinished - with all military camps and other strategic sites removed. These maps were initially overprinted with the National Grid. In 1970, the first 1:10,000 maps were produced using the Transverse Mercator Projection. The revision process continued until recently, with new editions appearing every 10 years or so for urban areas.

#### Map Name(s) and Date(s)

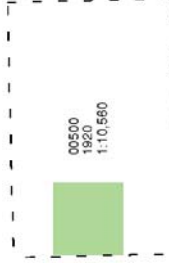

#### Historical Map - Slice A

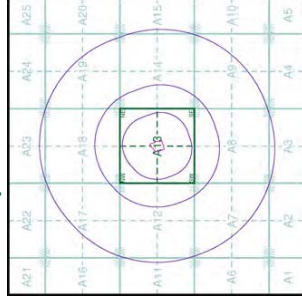

#### Order Details

Order Number: 76872908\_1\_1  
 Customer Ref: C145  
 National Grid Reference: 529060, 182360  
 Slice: A  
 Site Area (Ha): 0.85  
 Search Buffer (m): 1000

#### Site Details

Essensys Co. UK, 1 Triton Square, LONDON, NW1 3DX

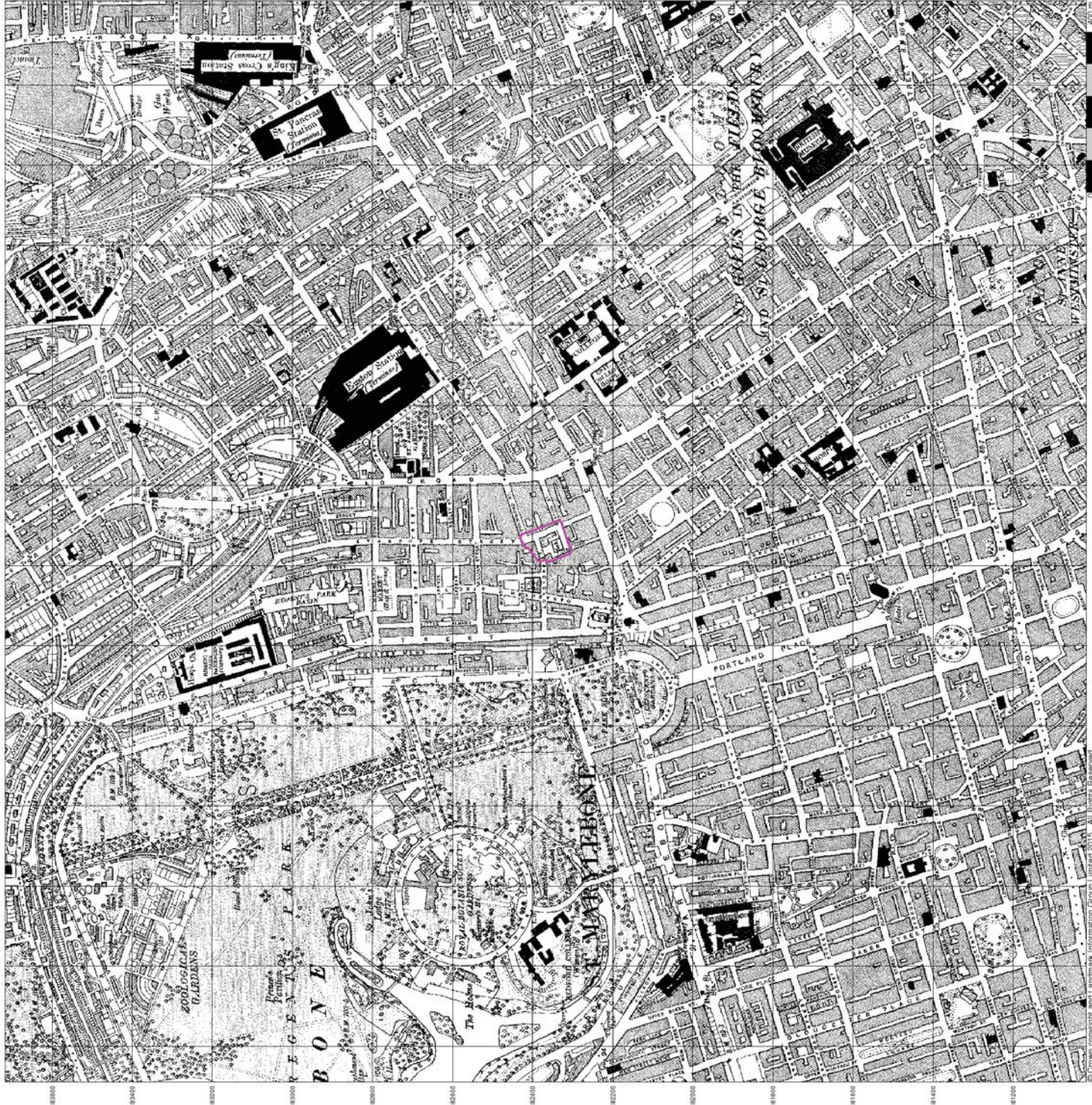

## London

### Published 1938

#### Source map scale - 1:10,560

The historical maps shown were reproduced from maps predominantly held at the Ordnance Survey, and Scotland in the 1940's. In 1854 at a 1:2,500 scale, the maps of the urban areas were used to update the 1:10,560 maps. The published date given therefore often some years later than the surveyed date. Before 1938, all OS maps were based on the Cassini Projection, with independent surveys of a single county or group of counties, giving rise to significant inaccuracies in outlying areas. In the late 1940's, a Provisional Edition was produced, which updated the 1:10,560 mapping from a number of sources. The maps appear 'unfinished', with all military camps and other strategic sites removed. These maps were initially overprinted with the National Grid. In 1970, the first 1:10,000 maps were produced using the Transverse Mercator Projection. The revision process continued until recently, with new editions appearing every 10 years or so for urban areas.

#### Map Name(s) and Date(s)

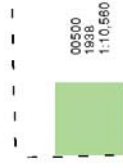

#### Historical Map - Slice A

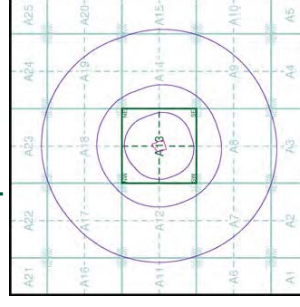

#### Order Details

Order Number: 76872908\_1\_1  
 Customer Ref: C145  
 National Grid Reference: 529060, 182360  
 Slice: A  
 Site Area (Ha): 0.85  
 Search Buffer (m): 1000

#### Site Details

Essensys Co. UK, 1 Triton Square, LONDON, NW1 3DX



## Ordnance Survey Plan Published 1940 - 1951

### Source map scale - 1:10,000

The historical maps shown were reproduced from maps predominantly held at the Ordnance Survey offices in England, Wales and Scotland in the 1940's. In 1854 the OS adopted the Cassini Projection for its maps. The published maps are used to update the 1:10,000 maps. The published data is then therefore often some years later than the surveyed date. Before 1938, all OS maps were based on the Cassini Projection, with independent surveys in outlying areas. In the late 1940's, a Provisional Edition was produced, which updated the 1:10,000 mapping from a number of sources. The maps appear unfinished - with all military camps and other strategic sites removed. These maps were initially overprinted with the National Grid. In 1970, the first 1:10,000 maps were produced using the Transverse Mercator Projection. The revision process continued until recently, with new editions appearing every 10 years or so for urban areas.

### Map Name(s) and Date(s)

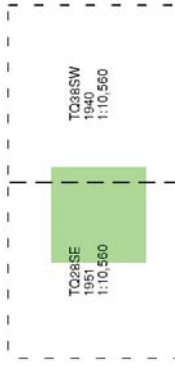

### Historical Map - Slice A

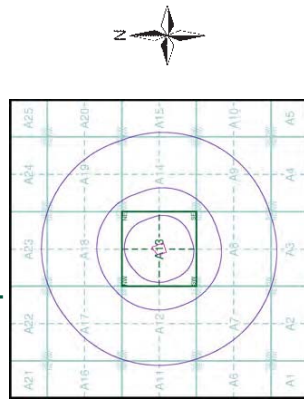

### Order Details

Order Number: 76872908\_1\_1  
 Customer Ref: C145  
 National Grid Reference: 529060, 182360  
 Slice: A  
 Site Area (Ha): 0.85  
 Search Buffer (m): 1000

### Site Details

Essensys Co. UK, 1 Triton Square, LONDON, NW1 3DX

