

10 RUGBY STREET GROUND FLOOR PLAN

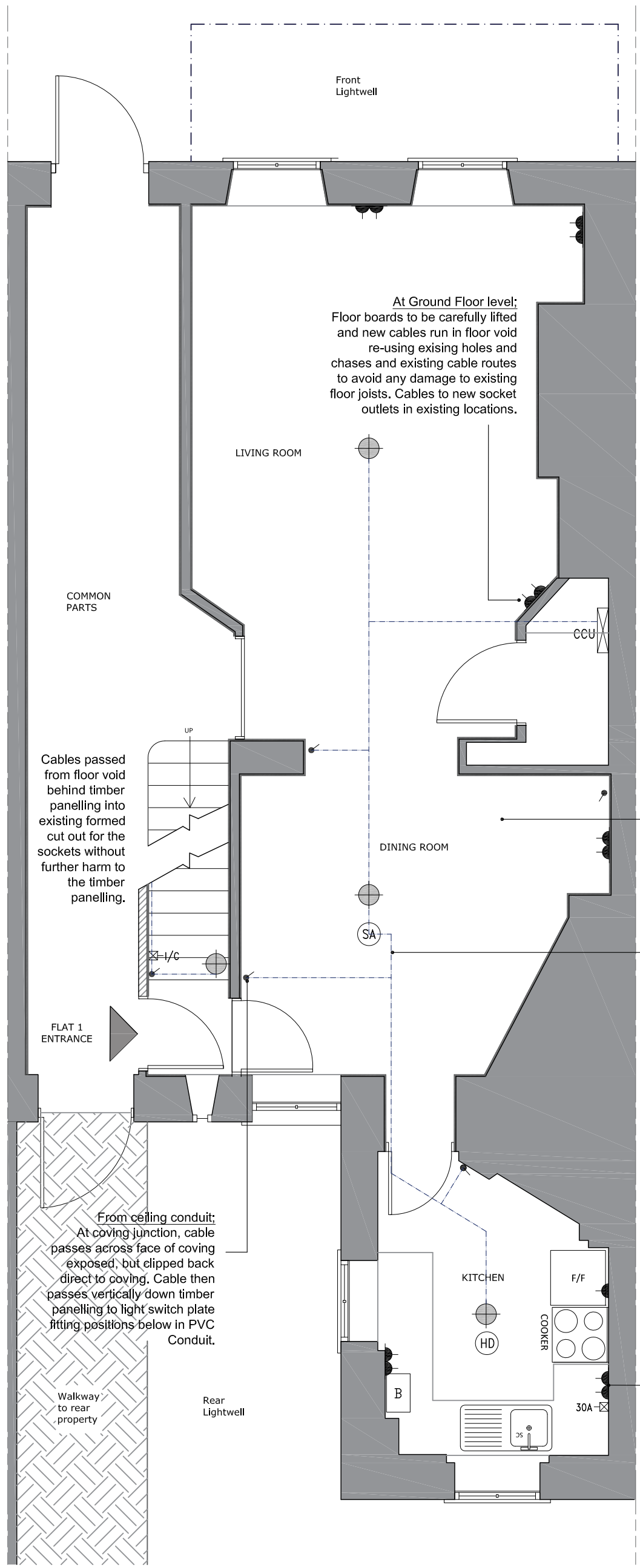

KEY

- D1 28W 2D CEILING MOUNTED FITTING OPAQUE DIFFUSER
- D2 26W LOW ENERGY PENDENT
- 1200 LONG FLUORESCENT CEILING MOUNTED FITTING OPAQUE DIFFUSER
- EX EXTERNAL LOW ENERGY ENCAPSULATED LIGHT FITTING WITH PIR AND DAYLIGHT SENSOR
- M WALL LIGHT FITTING OVER MIRROR WITH LONG PULL CORD
- ONE WAY LIGHT SWITCH
- IS-30A 30AMP FUSED & SWITCHED ISOLATOR WITH INDICATOR LIGHT
- IS SWITCHED FUSED ISOLATOR
- SD SWITCHED DOUBLE SOCKET OUTLET (450mm ABOVE FLOOR LEVEL)
- S 250/115 v SHAVER SOCKET
- CEILING MOUNTED EXTRACT FAN
- SA SMOKE ALARM. (WITH A SMOKE DETECTION FUNCTION).
- HD HEAT DETECTOR (MAINS-OPERATED)
- CCU RCD CONSUMER UNIT
- AV TV/AM & FM TV AERIAL SOCKET
- BT BT SOCKET
- SKY MASTER SKY TRIPLEX PLATE
- T TOWEL HEATER
- R RADIATOR
- P HEATING PROGRAMMER
- THERMOSTATIC CONTROL FOR UNDERFLOOR HEATING OR RADIATORS
- WALL-MOUNTED HIGH LEVEL EXTRACT FAN
- B BOILER
- MEGAFLO HOT WATER CYLINDER
- ELECTRIC METER
- GAS METER
- CEILING AFFIXED 20mm \varnothing PVC CONDUIT ROUTE FOR LIGHTING

All walls at ground level full height panelling and casing, unless indicated otherwise.

At ground floor level; lighting cables will be fed in 20mm \varnothing PVC Conduit surface fixed to ceiling as shown to original pendant positions.

Sockets/Cooker spur above work surface in existing locations to non-timber panelled walls.

CONTRACTORS TO VERIFY ALL DIMENSIONS ON SITE BEFORE COMMENCING ANY WORKS OR PREPARING SHOP DRAWINGS. ALL WORK MUST COMPLY WITH RELEVANT AUTHORITIES REQUIREMENTS. DIMENSIONS MUST NOT BE SCALED FROM THIS PRINT

LANDERS AND ASSOCIATES

Architecture, Building Surveying, Interior Design, Building Defects and
Project Co-ordination
RAPIER HOUSE, 40-46 LAMBS CONDUIT STREET
LONDON WC1N 3LJ
TEL: 020 7831 6311 FAX: 020 7831 1826

Client The Governing Body of Rugby School
c/o Farebrother

Project Flat1, 10 Rugby Street, London WC1N
Electrical Re-wire

Drawing Proposed Electrical Layout
Ground Floor Plan

Scale	Date	Drawn	Checked
1:50 @ A3	08.01.18	MN	RS

Drawing No.
17074/07

