

# 10 RUGBY STREET BASEMENT PLAN

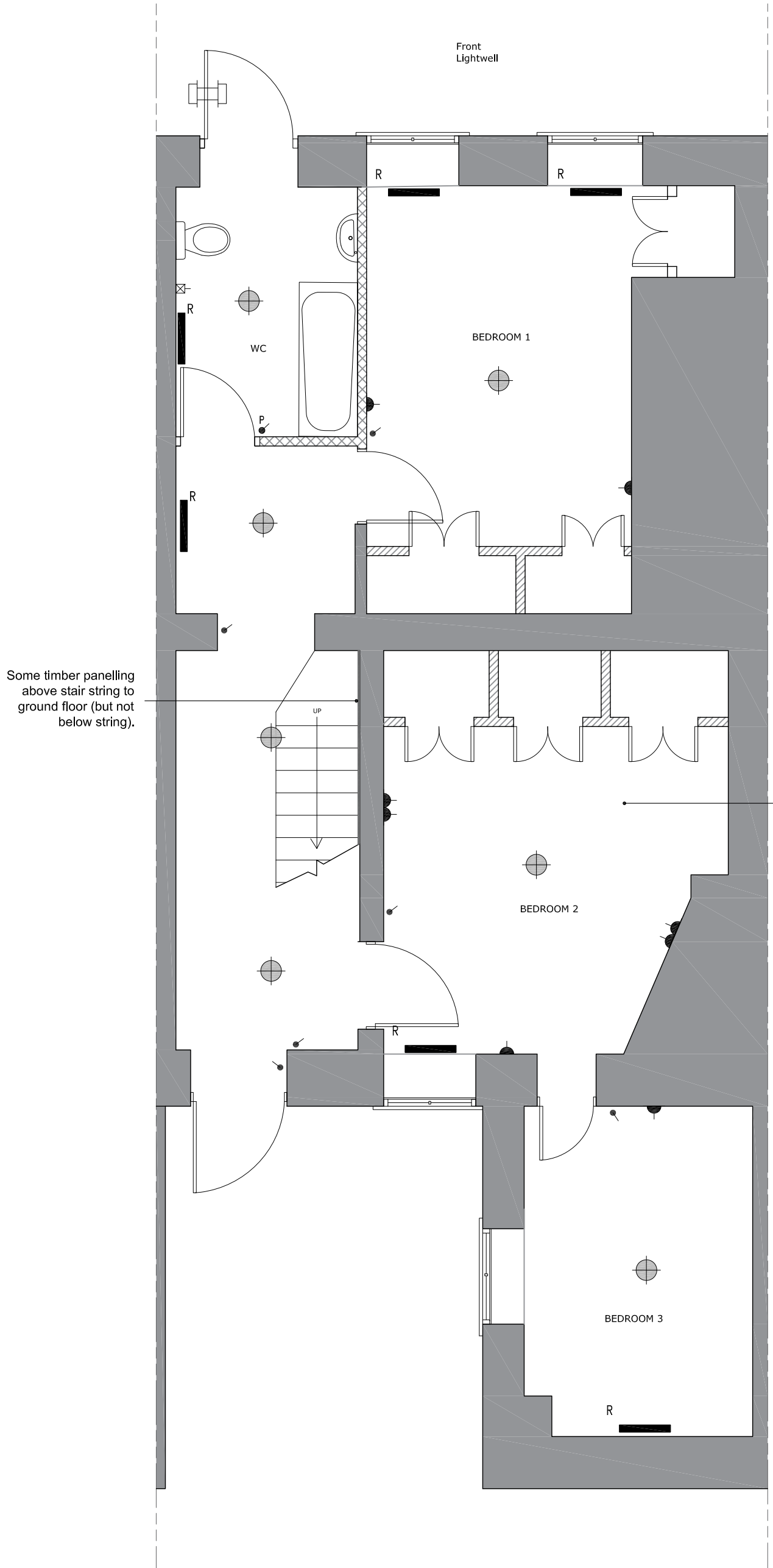

KEY	
D1	28W 2D CEILING MOUNTED FITTING OPAQUE DIFFUSER
D2	26W LOW ENERGY PENDENT
[Symbol]	1200 LONG FLUORESCENT CEILING MOUNTED FITTING OPAQUE DIFFUSER
EX	EXTERNAL LOW ENERGY ENCAPSULATED LIGHT FITTING WITH PIR AND DAYLIGHT SENSOR
[Symbol]	WALL LIGHT FITTING OVER MIRROR WITH LONG PULL CORD
[Symbol]	ONE WAY LIGHT SWITCH
[Symbol]	30A 30AMP FUSED & SWITCHED ISOLATOR WITH INDICATOR LIGHT
[Symbol]	SWITCHED FUSED ISOLATOR
[Symbol]	SWITCHED DOUBLE SOCKET OUTLET (450mm ABOVE FLOOR LEVEL)
[Symbol]	SWITCHED DOUBLE SOCKET OUTLET (1000mm ABOVE FLOOR LEVEL)
[Symbol]	250/115 v SHAVER SOCKET
[Symbol]	CEILING MOUNTED EXTRACT FAN
[Symbol]	SMOKE ALARM. (WITH A SMOKE DETECTION FUNCTION).
[Symbol]	HEAT DETECTOR (MAINS-OPERATED)
[Symbol]	RCD CONSUMER UNIT
AV	TV/AM & FM TV AERIAL SOCKET
BT	BT SOCKET
SKY	MASTER SKY TRIPLEX PLATE
T	TOWEL HEATER
R	RADIATOR
[Symbol]	HEATING PROGRAMMER
[Symbol]	THERMOSTATIC CONTROL FOR UNDERFLOOR HEATING OR RADIATORS
[Symbol]	WALL-MOUNTED HIGH LEVEL EXTRACT FAN
[Symbol]	BOILER
[Symbol]	MEGAFLO HOT WATER CYLINDER
[Symbol]	ELECTRIC METER
[Symbol]	GAS METER

CONTRACTORS TO VERIFY ALL DIMENSIONS ON SITE BEFORE COMMENCING ANY WORKS OR PREPARING SHOP DRAWINGS. ALL WORK MUST COMPLY WITH RELEVANT AUTHORITIES REQUIREMENTS. DIMENSIONS MUST NOT BE SCALED FROM THIS PRINT

## LANDERS AND ASSOCIATES

Architecture, Building Surveying, Interior Design, Building Defects and Project Co-ordination  
 RAPIER HOUSE, 40-46 LAMBS CONDUIT STREET  
 LONDON WC1N 3LJ  
 TEL: 020 7831 6311 FAX: 020 7831 1826

Client The Governing Body of Rugby School  
 c/o Farebrother  
 Project Flat 1, 10 Rugby Street, London WC1N  
 Electrical Re-Wire

Drawing Basement Plan  
 Existing Electrical layout

Scale 1:50 @ A3 | Date 08.01.18 | Drawn MN | Checked RS

Drawing No. 17074/03

