

**1** Green Wall  
**300** Section 1:20

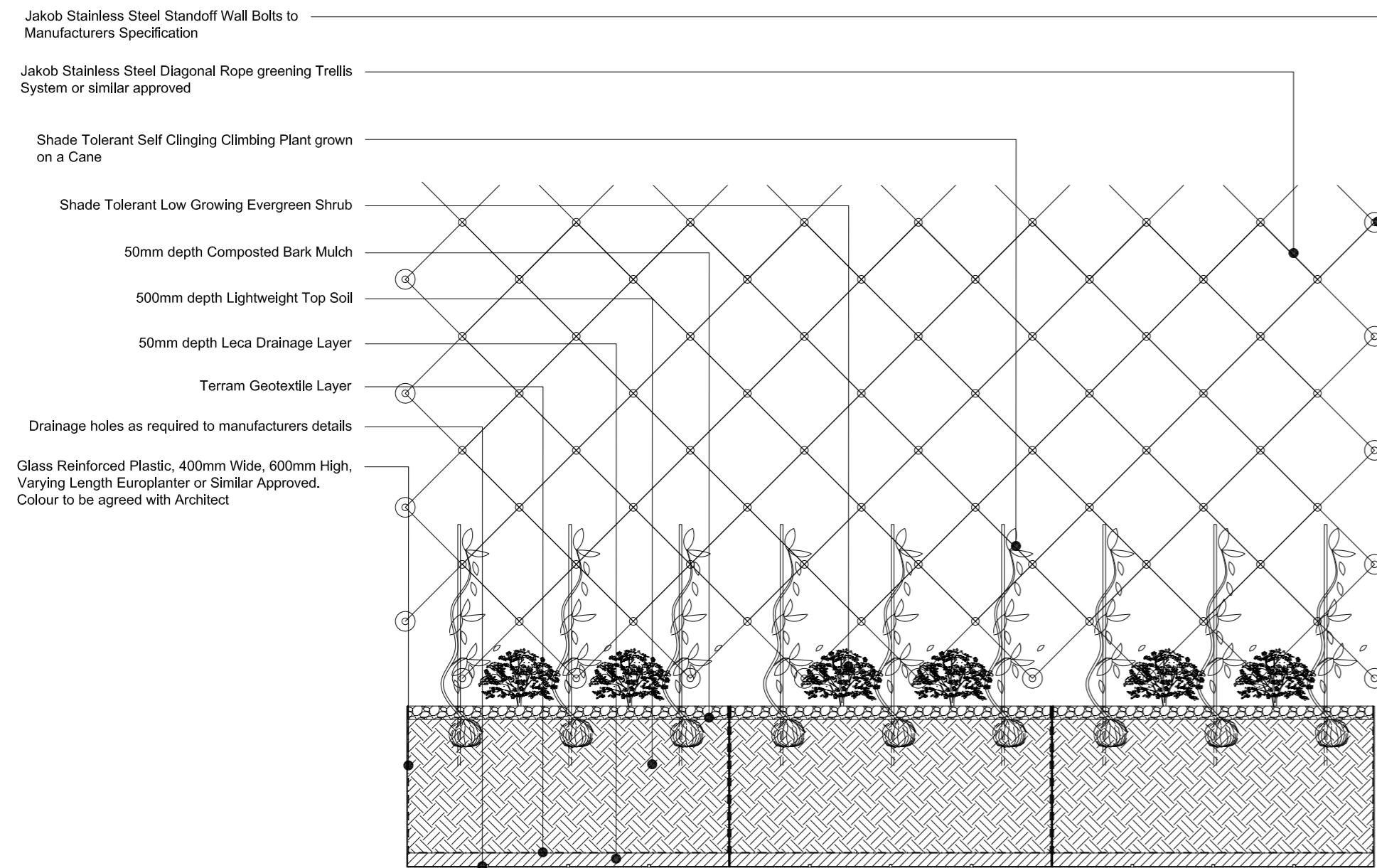

**2** Green Wall  
**300** Section 1:20

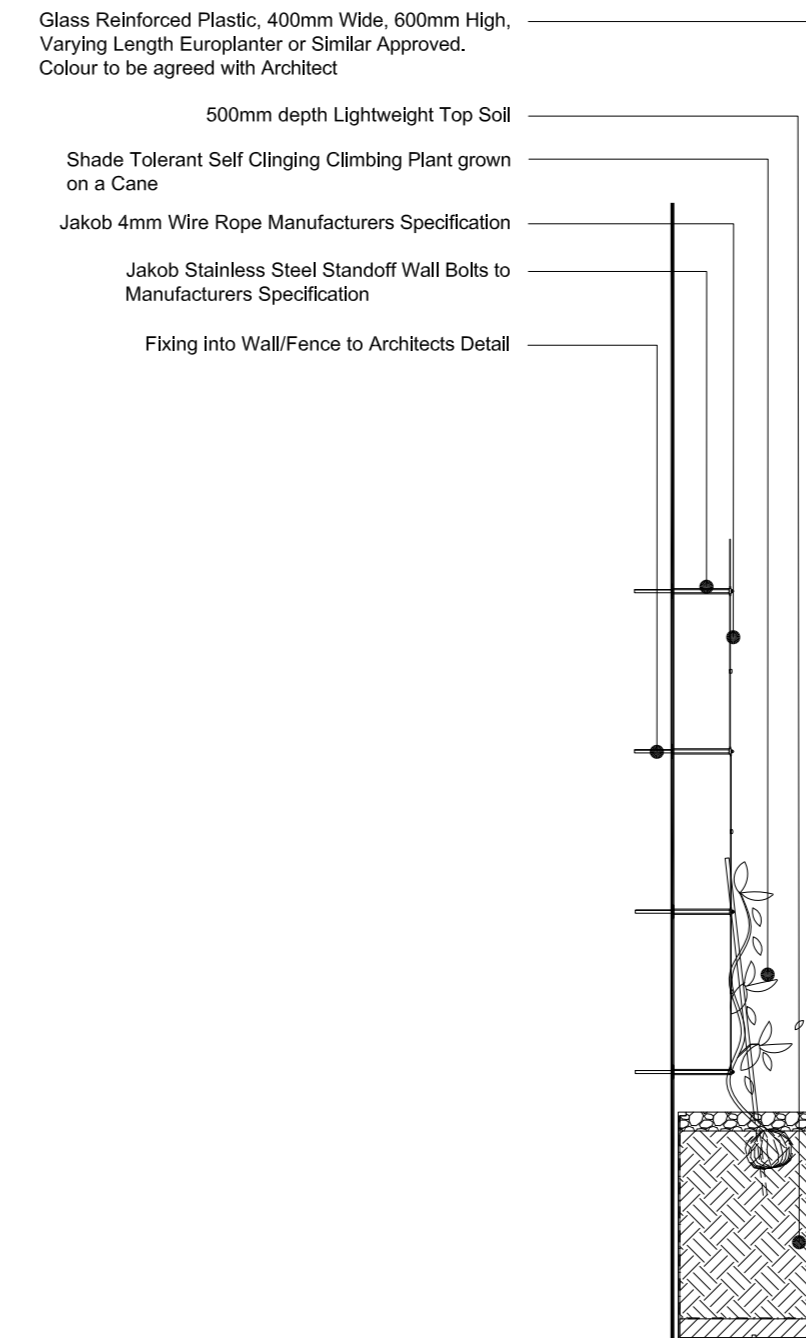

**Notes**

- Roof substrate specification:
  - 30% washed South Cerney gravel with stones (15cm diameter) placed regularly across the surface
  - 20% finely crushed clean brick (less than 5 cm diameter) (no engineering brick)
  - 10% shale
  - 30% standard grade grit sand
  - 10% well-rotted leaf compost

Depth: uneven 200mm average depth (150mm minimum)
- Engineered lightweight soil specification
 

Soil to be in accordance with BS 3882:2015 and to include a 60-85% fine to medium sand content and be peat free.
- Green Wall Extent
 

The Green Wall wire system will extend 5m from finished level (4.4m above the planters) based upon the constraint of aspect with proposed climbers selected accordingly.

**3** Brown Roof  
**300** Section 1:20

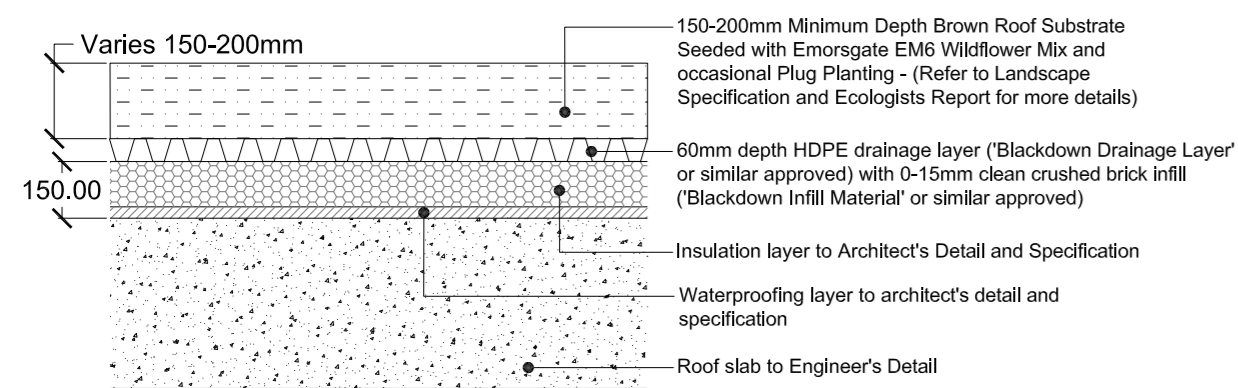

**4** Roof Ballast  
**300** Section 1:20

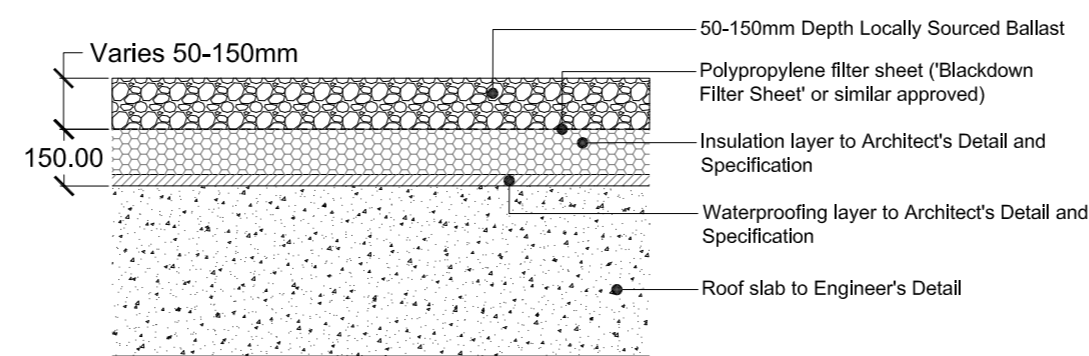

**5** Paving to Lower Ground Floors  
**300** Section 1:20

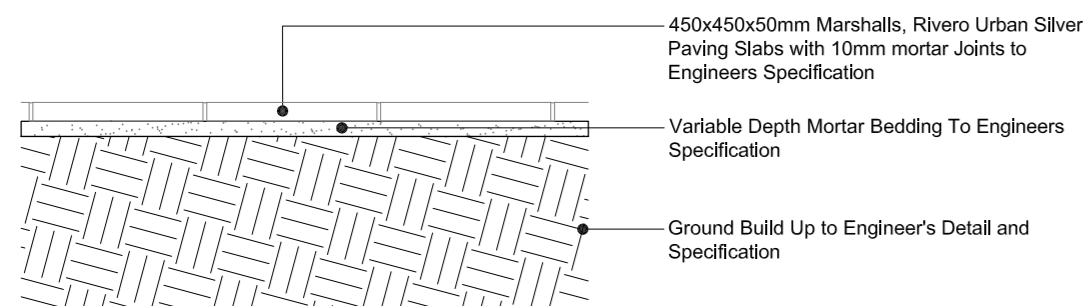

**6** Pedestal Mounted Paving To Roof Terraces  
**300** Section 1:20

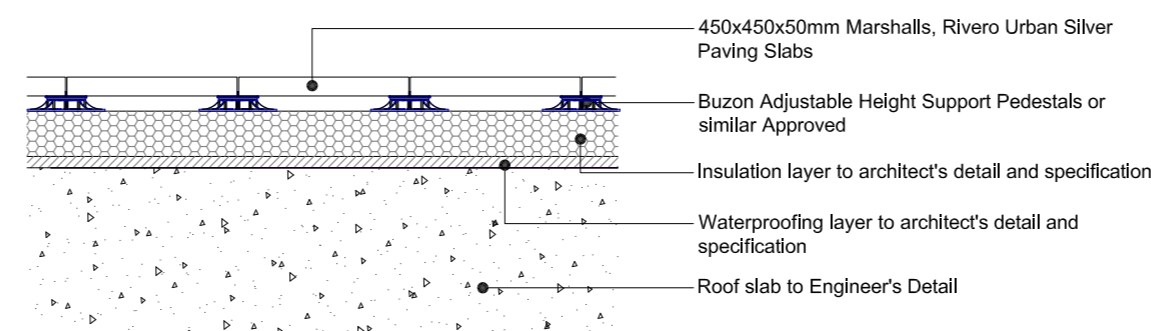

Rev	Date	By	Notes

Client

Stadium Capital Holdings

Project

Midland Crescent

Drawing Title

General Landscape Details

Drawing Status

FOR PLANNING

Scale	Date	Drawn
1:20 @ A2	Sep' 2017	CC

Drawing No	Checked	Approved
CS093348-L-300		NM

# CAPITA

Property and infrastructure

T+44 (0)121 423 6060  
1st Floor, Eleven Brindleyplace, 2 Brunswick Square  
Birmingham, B1 2LP www.capita.co.uk/property  
Capita Property and Infrastructure Ltd