

- CCTV
- LIGHTING POLE: ARTEMIDE PROVOCA outdoor pole lighting 3100mm
- PLANTER: IOTA 2000X500mm granite tree planters 600mm height, planted with HEBE DWARF EVERGREEN
- Marshalls SUDS compliant Prola paving in "Natural" with a self edging in "Brindie" with permeable sub base
- Marshalls 900x300 mm celestia skinned lyra external paving

Wall mounted bird boxes - hole front type

8no clustered together (4wide x 2 high) to form colony arrangement. remaining 6No individually mounted .

All boxes mounted between 2-4 metres from finished ground level and to be installed per the guidance within Camden Biodiversity Action Plan 2013 - 2018

Bird Box locations at Ground Floor Level

SK 254KHR-170711-01

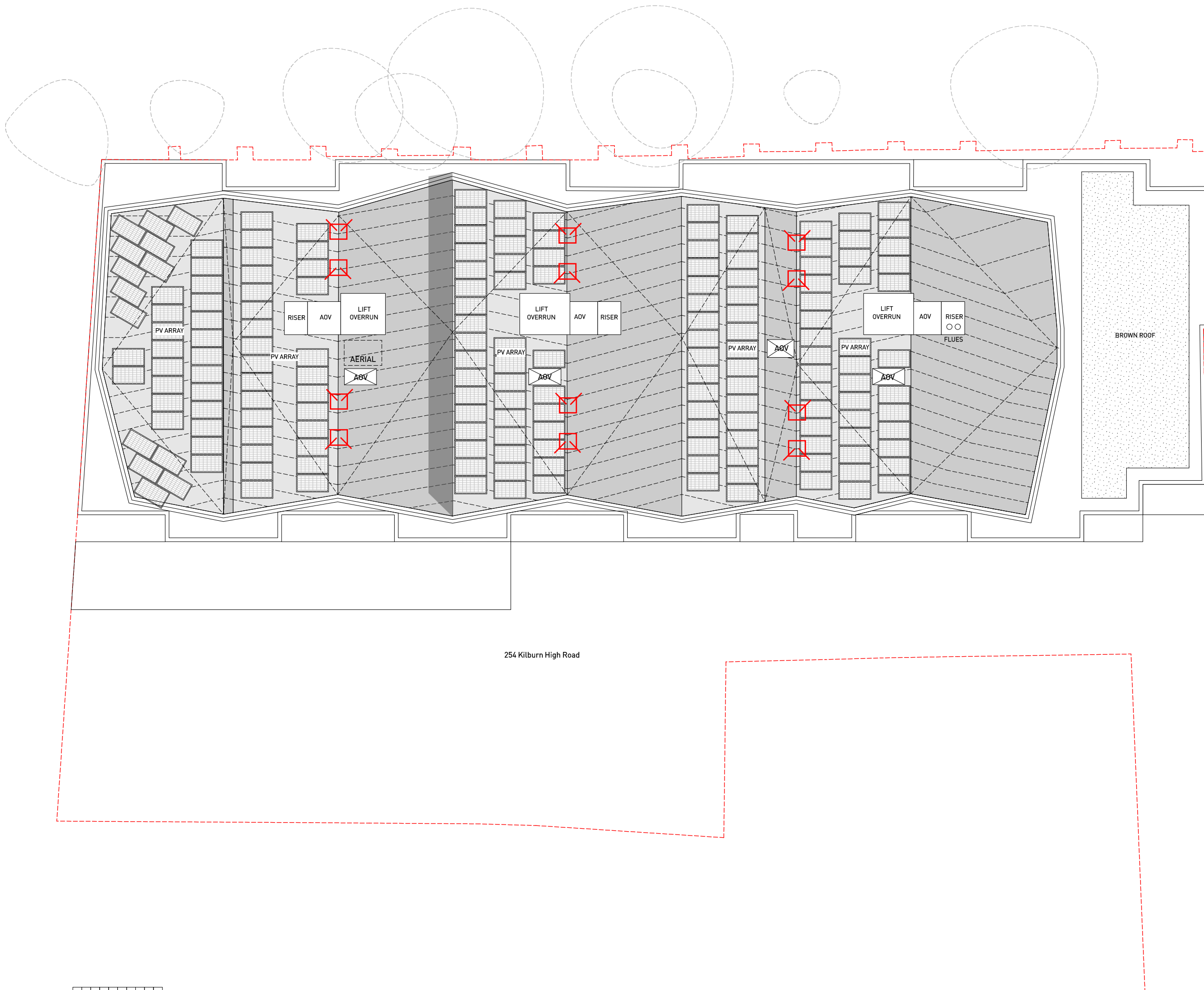

 Roof mounted bat box on support frame  
equally split between Schweffel and  
multi chamber boxes

Entrances located South East and South West

All boxes mounted between 1 metres from finished roof  
level and to be installed per the guidance within Camden  
Biodiversity Action Plan 2013 - 2018



Bat Box Locations at  
Roof Level

SK 254KHR-170711-02

[◀ Go back](#)[Equipment ▶ Nest Boxes, Habitats and Feeders ▶ Bat Boxes ▶ Woodcrete and Woodstone Bat Boxes](#)

# 1FF Schwegler Bat Box With Built-in Wooden Rear Panel

[📷 View Images](#)

***Robust roosting and nursery bat box for inaccessible locations***

**Schwegler**



[Specification](#) | [Accessories](#) | [Write a review](#)

**#174821** | Availability: **In stock**

NHBS Price: **£64.96** inc VAT \$84/€73 approx

Add to

## About this product

The Schwegler 1FF bat box is spacious enough for bats to use as a summer roost or nursery site and is open at the bottom, allowing droppings to fall out so it does not need cleaning. The 1FF is, therefore, especially suitable for hanging in inaccessible places such as high in trees, or on steep slopes and house walls. The 1FF is manufactured from long-lasting Woodcrete, which is a blend of wood, concrete and clay which will not rot, leak, crack or warp, and will last for at least 20 - 25 years, making it suitable for long-term mitigation projects. Woodcrete is breathable and maintains a stable temperature inside the box and the 1FF is painted black to absorb warmth. It also provides a good rough surface for bats to cling on to and climb. To compensate for fluctuations in temperature in spring and autumn, the 1FF is provided with a roughened rear panel made of hard-wearing wood. Depending on their individual temperature requirements, the bats can choose between the cooler Woodcrete surface or the warmer wooden panel.

The inner dimensions of the 1FF have a reducing width making it ideal for bat species which inhabit crevices such as pipistrelle and noctule bats. For conservation projects and studies, the entire front of the box can be easily swung open for inspection purposes.

The 1FF bat box can be sited in trees or on buildings and is best positioned at a height of between 4 to 6 metres. Please note that once bats have inhabited a roost or nursery site they may only be disturbed by licensed bat workers.

Schwegler bat and bird boxes are backed by conservation organisations, government agencies and forestry experts and have the highest occupation rates of all nest boxes. They are carefully designed to mimic natural nest and roost sites and to provide a stable environment.

Height 43cm x width 27cm x depth 14cm. Entrance hole 12cm x 24cm. Weight 9.5kg.  
Aluminium nail and hanger included.

## Specification

### Specifications

Dimensions: 43 x 27 x 14cm

Entrance hole dimensions: 12cm x 24cm

Weight: 9.5kg

Material: Schwegler Woodcrete

Colour: Black with stable hard-wearing wooden insert

Supplied with: Galvanised steel hanger and aluminium tree-friendly nail

## Accessories

### Recommended Accessories



#### Heavy Duty Aluminium Nails 1 Nail

Replacement tree-friendly nails are available either singly or in packs of 100 and 500

NHBS Price: **£0.35** inc VAT \$0/€0 approx

[More !\[\]\(0b5e7e25e8775f7e7e80906ada4f0021\_img.jpg\)](#)[Buy Now](#)

## Write a review

There are currently no reviews for this product. Be the first to review this product!

[Write a Review](#)

VAT: GB 407 4846 44

NHBS Ltd is registered in England and Wales: 1875194

4.8 ★★★★★

Google  
Customer Reviews

[◀ Go back](#)[Equipment ▶ Nest Boxes, Habitats and Feeders ▶ Bat Boxes ▶ Wooden Bat Boxes](#)

## Double Chamber Bat Box

[📷 View Images](#)**SPECIAL OFFER**[Wildlife World](#)[G+1](#) [0](#)[Specification](#) | [Write a review](#)#183446 | Availability: **In stock**NHBS Price: **£22.50** inc VAT ~~£31.25~~ (Save £8.75) \$29/€25 approx[Add to !\[\]\(aab88c0d099e5d18d6533a97b13ec28d\_img.jpg\)](#)

### About this product

This attractive wooden bat box has two internal chambers and is constructed from natural sustainable materials. The heavy construction provides good insulation and longevity, as well as preventing predators from chewing the entrance slot. The front door is hinged for inspection and cleaning.

This box is suitable for siting on trees in gardens or woodland and also on house walls. It is simple to install and the timber requires no annual maintenance. Site 2.5 - 5m high on a building, mature tree or vegetation line (trees/tall hedge) or on a feeding/flight route in partial daytime sun.

Wooden boxes should not be painted or treated with any type of preservative, as these can harm the bats.

Made using FSC certified wood.

## Specification

### Dimensions:

- \* Height: 31.3 cm
- \* Width: 16 cm
- \* Depth: 16 cm
- \* Weight: 1.8 kg

## Write a review

There are currently no reviews for this product. Be the first to review this product!

[Write a Review](#)

VAT: GB 407 4846 44

NHBS Ltd is registered in England and Wales: 1875194

4.8 ★★★★★  
Google  
Customer Reviews



[◀ Go back](#)[Equipment ▶ Nest Boxes, Habitats and Feeders ▶ Bird Boxes ▶ Wooden Bird Boxes](#)

## Bowland FSC Bird Box

[📷 View Images](#)[CJ Wildlife](#)[G+1](#) [0](#)[Write a review](#)**#198957** | Availability: **In stock**NHBS Price: **£11.50** inc VAT \$15/€13 approx[Add to !\[\]\(95b425611cbd2b8716a140cf67c81822\_img.jpg\)](#)

### About this product



This attractive FSC wood nest box will attract Nuthatches, House Sparrows and Great Tits.

The front panel will pivot open for ease of cleaning.

**Height:** 25cm

**Width:** 12cm

**Depth:** 17.5cm

**Hole:** 32mm

## Write a review

There are currently no reviews for this product. Be the first to review this product!

Write a Review

VAT: GB 407 4846 44

NHBS Ltd is registered in England and Wales: 1875194

4.8 ★★★★★  
Google  
Customer Reviews