

GLENLOCH ROAD

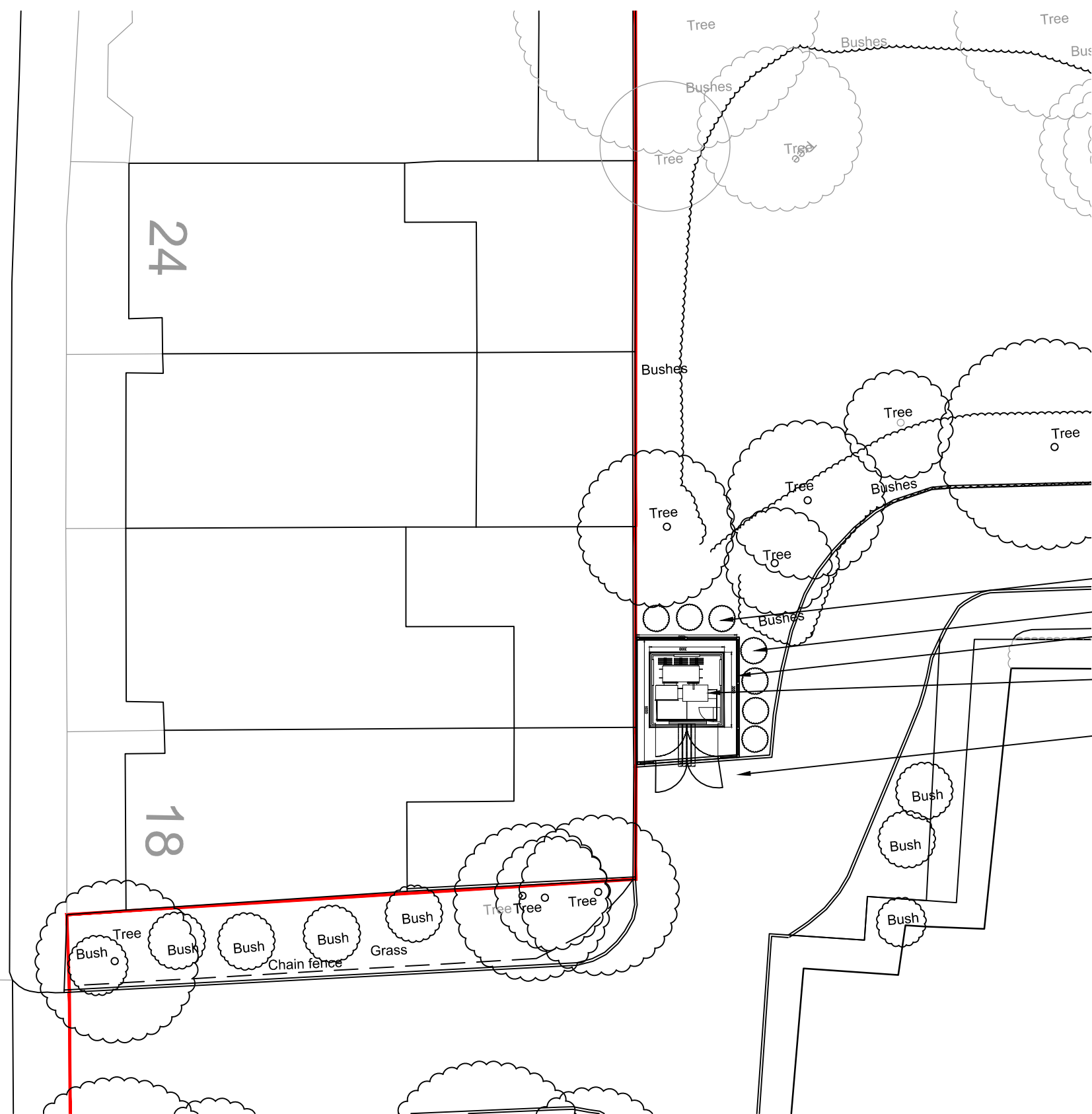

- 3No 10ltr Pot Laurels
- 4No 10ltr Potted Laurels
- 1.8m high timber post, rail and nailed boarding fence, stained dark oak
- New GRP Substation
- 1.8m high timber rail gates and nailed boarding, stained dark oak with FB lock

SITE PLAN
1:200@A3

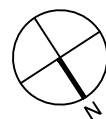

50mm on original sheet

revisions				
no.	description	date	initial	check initial
1	FIRST ISSUE	04/10/17	PB	PB
2	Landscape Added	22/01/18	PB	PB

OS LOCATION PLAN Scale 1:2500

notes

DO NOT SCALE FROM THIS DRAWING*
DRAWING SUBJECT TO COPYRIGHT ACT

BLOX

ARCHITECTS

Peter Bloxham Architect RIBA
19 Crows Road
Epping
Essex, CM16 5DE
Telephone 01992 610 819
Email : peter@bloxarchitects.co.uk

client
Kinleigh Folkard & Hayward

project
NEW UKPN SUBSTATION
PLANNING CONSENT

drawing
1-114 Belsize Avenue / London NW3 4BG
SITE PLAN
PROPOSED

scales		date drawn		drawn by	
1:200 @ A3		20/10/17		PB	
1 check date	checked by	2 check date	checked by		
20/10/17	PB	.	.		
drawing no.			revision		
1014_HFC_AL-0-004			2		