

DO NOT SCALE
 THIS DRAWING IS © IAN RITCHIE ARCHITECTS LTD
 Dimensions to be verified on site.
 Figural dimensions to take preference to those scaled.
 All discrepancies to be clarified with the project architect.
 Unless otherwise stated all levels to be AOS.
 This drawing is the property of Ian Ritchie Architects Ltd, and is
 loaned on the condition it is not reproduced, retained or
 disclosed to any unauthorized person, either wholly or in part without
 written consent.

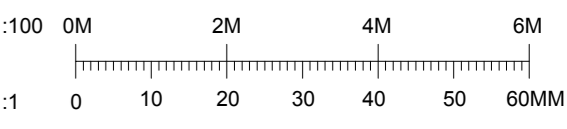

MALET STREET

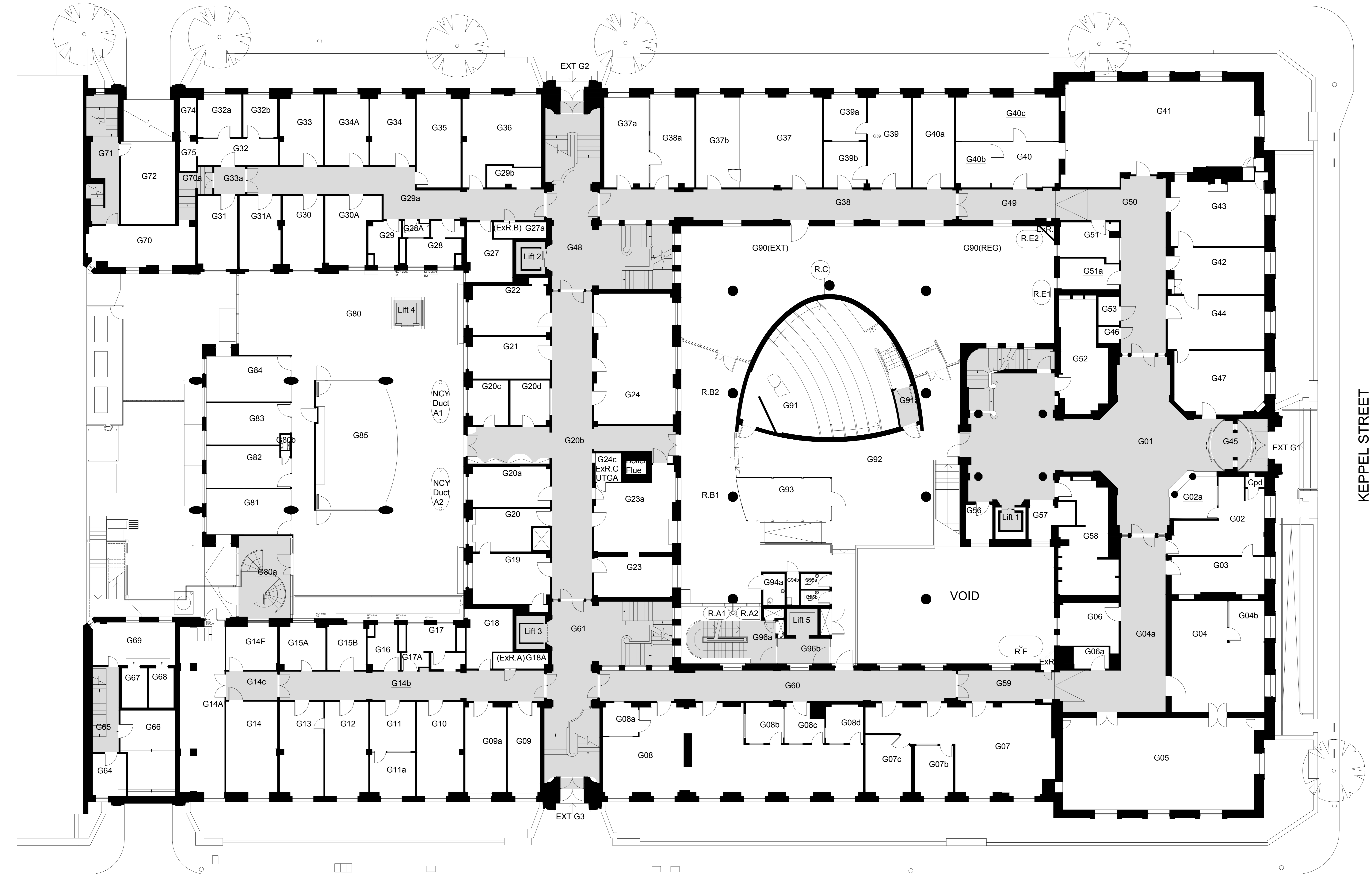

KEPPEL STREET

GOWER STREET

01 Existing Ground Floor Level Plan
 18-0100 Scale = 1:100

P00 19.12.17 TOD CR AS First Issue	
Rev. Date	By Ck. App. Description
Job Title	
LONDON SCHOOL OF HYGIENE AND TROPICAL MEDICINE (KEPPEL STREET)	
Drawing Title	
GA Plan Ground Level Existing	
© Ian Ritchie Architects Ltd 110 Three Cole Street London E14 6AE Tel: (44) 207381100 Fax: (44) 207381199	
Status PLANNING	
Scale 1:100@A0	Date 19.12.2017
Drawn TOD	Checked CR
Job No. 739	Drawing No. IRAL-P1-08-0100
Rev. P00	Rev. P00