

OPTION 1

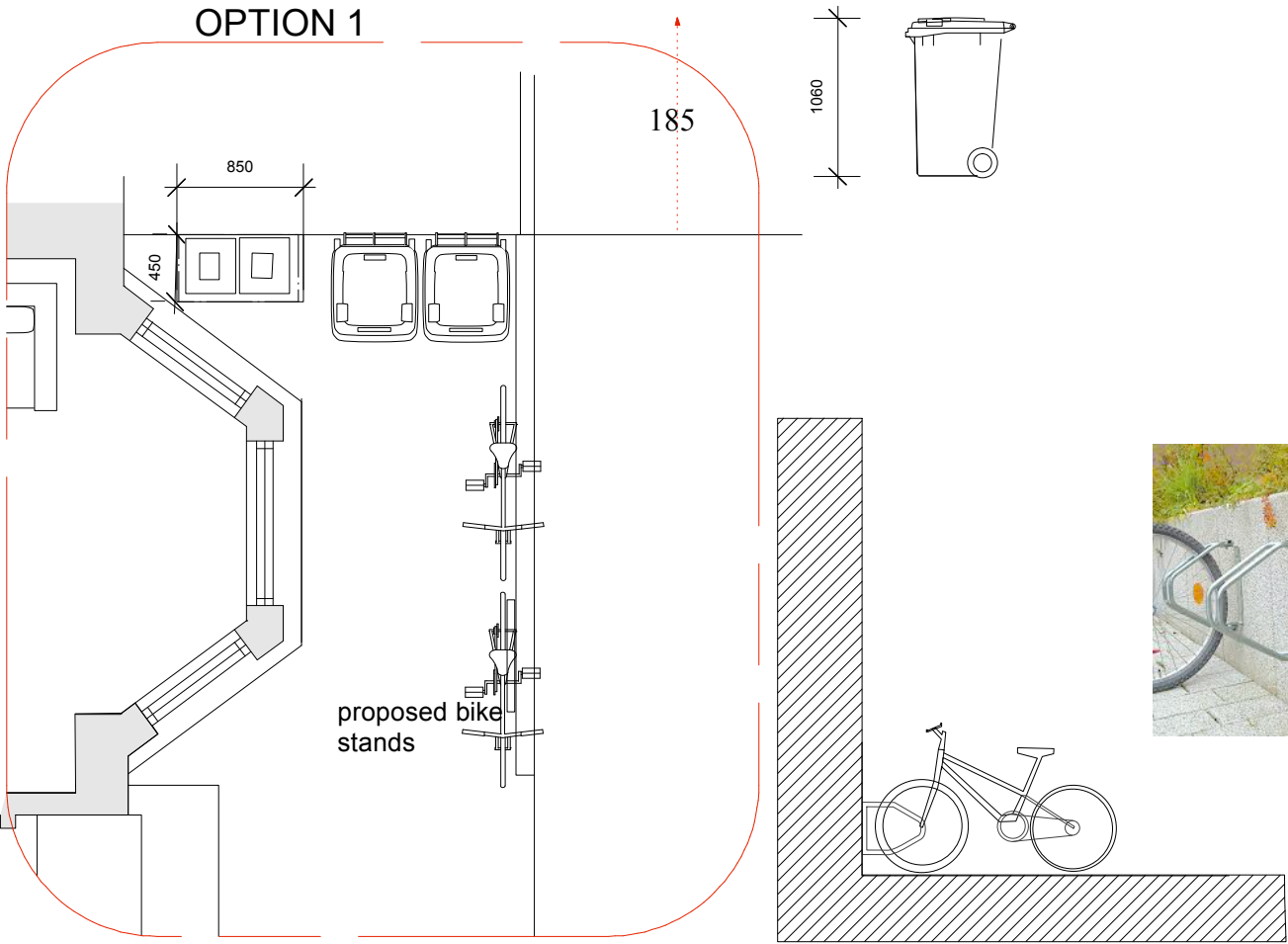

OPTION 2

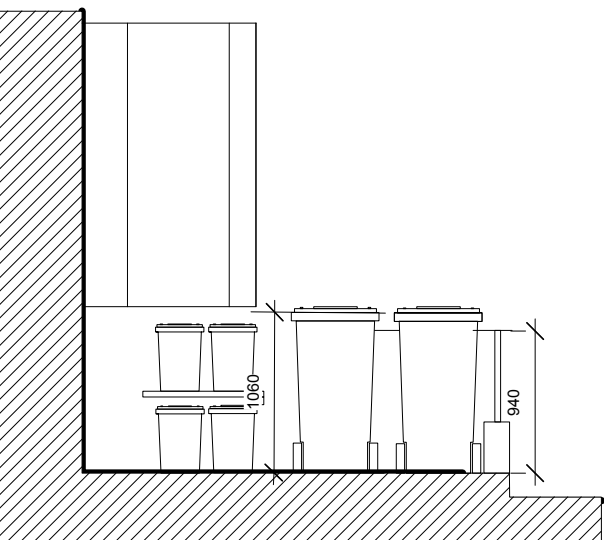
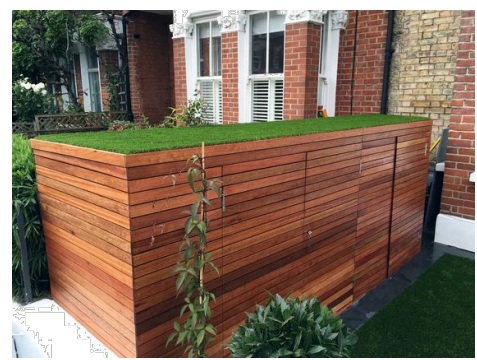
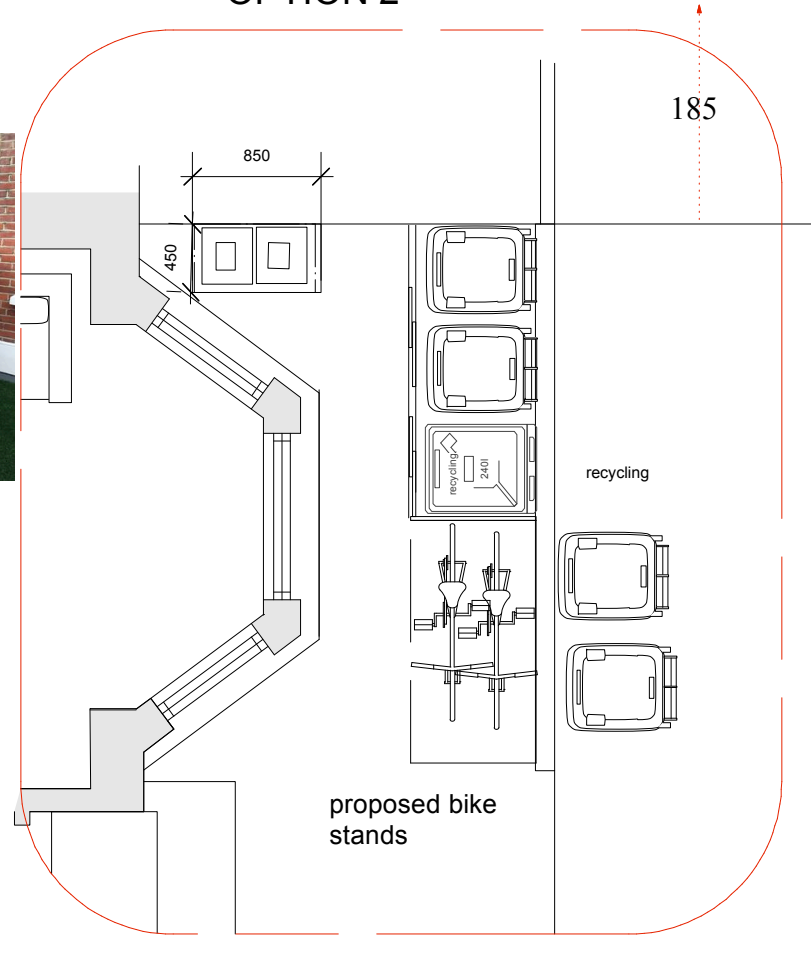

Refuse Bins, Side Elevation 2 no. of 240 L Eurobins
4no. 23 L food waste

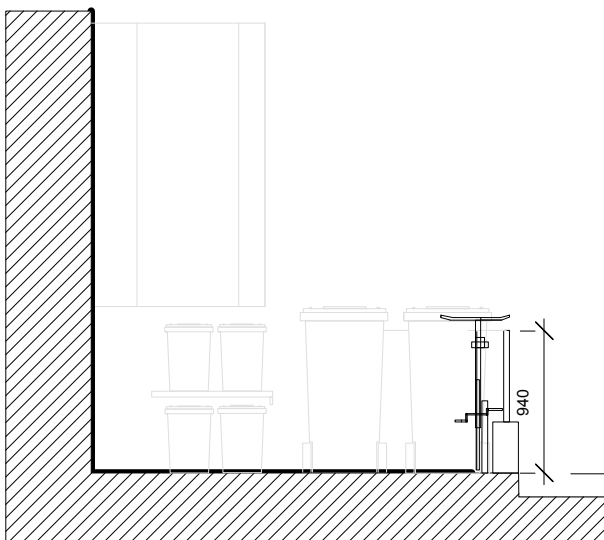

Refuse Bins, Side Elevation 2 no. of 240 L Eurobins
4no. 23 L food waste

240 L recycling bin	1	sufficient for approx 6 dwellings or fewer
---------------------	---	--

240 L recycling bin	1	sufficient for approx 6 dwellings or fewer
---------------------	---	--

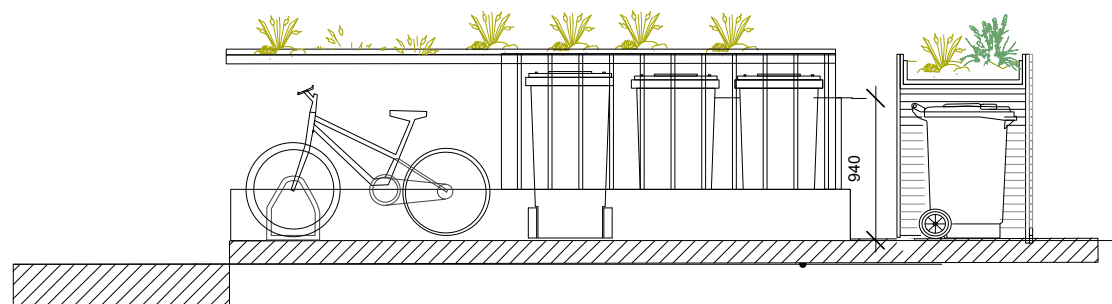

Refuse Bins, front Elevation 2 no. of 240 L Eurobins + 1 recycling +
4no. 23 L food waste + covered bike stand

Notes

© This drawing remains the property of **Golzari NG Architects**. It should not be reproduced in hard or electronic copies without a prior permission from Golzari-NG Architects.
Drawings are for planning purposes only. These are not construction drawings. I



GOLZARI (NG) ARCHITECTS
United House
39-41 North Road
London N7 9DP
+44 (0)2036748462
+44(0)7918197532
Email: info@ngarchitects.co.uk

Project No. NGA 1701	Drawing No. NG07A	Rev	Date	DRAWN
Project 187 Sumatra Road	Scale: 1:50@A3	A	11.12.17	
Drawing Title Proposed Bin and cycle Storage	Comments/Issue For Information Only			