

INDICATIVE CONSTRUCTION Seq (PILES INSTALLED PREVIOUSLY)

1. UNDERPIN PARTY WALL TO GRAVEL (APPROX 6m)
- TWO STAGE U/PIN TO BE INSTALLED CONCURRENTLY WITHIN SAME EXCAVATION.
USE NON-SHRINK GROUT BETWEEN PINS
2. CAST UNDERPINS AND BEAM STRIPS AS SHOWN. MAX WIDTH = 900mm. TRENCH SHEETING AND PROPPING USED TO STABILISE SIDES OF EXCAVATION
3. INSTALL PLYFORM BEAMS @ HIGH LEVEL BETWEEN UNDERPINS (REINFORCING KWIK-STRIPS TO BE INSTALLED) USED TO PROVIDE PROP TO HEADS OF WALL IN PERMANENT CASE
4. CAST REMAINING RC WALLS IN UNDERPIN SEQUENCE (INSTALLING COUPLERS @ BASE TO FORM CONTINUOUS BEAM BETWEEN PINS SUPPORTED ON PILES
5. EXCAVATE DOWN AND PROD METHODOLOGY IN PREVIOUSLY ISSUED REPORT
6. CAST RAFT, TYING INTO BEAMS AND PILES

Piled raft 500thk

Underpin to wall over cast in hit/miss sequence in lengths no greater than 900mm

Locally underpin wall over (cast internally with piled raft)

Further investigation to determine line of existing structure

300thk RC suspended slab (two-way spanning)

Mass concrete underpin to gravel - 6m BGL, width to suit wall over, wall to be cast in hit/miss sequence in lengths no greater than 900mm

New Steel stairs

Min 350thk RC wall cast integrally with raft slab

New Steel stairs

350thk RC wall to form lift pit cast integrally with raft slab

No. 53 Tottenham Court Road

RC underpin to gravel - 6m BGL new RC suspended slab spans between walls

NOTES:

1. ALL STRUCTURAL ENGINEERING DRAWINGS ARE TO BE READ WITH THE SPECIFICATION AND WITH ALL RELEVANT ARCHITECTS AND SERVICE ENGINEERS DRAWINGS AND SPECIFICATIONS
2. DO NOT SCALE FROM THIS DRAWING IN EITHER PAPER OR DIGITAL FORM. USE WRITTEN DIMENSIONS ONLY. TO CHECK DRAWING HAS BEEN PRINTED TO INTENDED SCALE THIS BAR SHOULD BE 50mm LONG @ A1 OR 25mm LONG @ A3
3. ALL DIMENSIONS ARE IN MILLIMETRES AND LEVELS IN METRES.

KEY

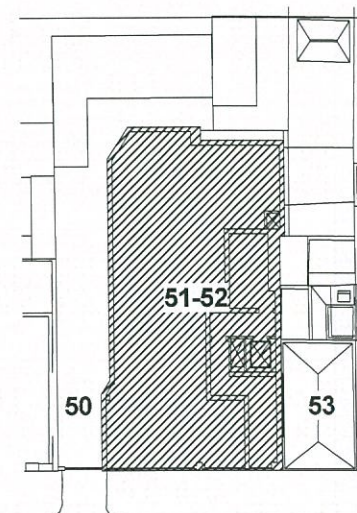
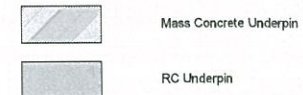

Key Plan

THIS DRAWING IS NOT FOR CONSTRUCTION

Rev	Date	Issued	For Planning	Amendment
1	05.04.17	CS	For Planning	

SINCLAIR JOHNSTON
Consulting Civil & Structural Engineers

93 Great Suffolk Street
London SE1 0BX
T: 020 7593 1900
F: 020 7593 1910
www.sinclairjohnston.co.uk

51-52 Tottenham Court Road

Basement Plan
Proposed

Drawn	Author	Scale	As indicated @ A1
Project No./Drawing No.	Rev		
8781/ 009	-		

B1 - Basement Proposed

1:50