

NOTE:
LAYOUT IS PROVISIONAL ONLY AND SUBJECT TO A FULL MEASURED VERIFICATION SURVEY OF THE EXISTING STRUCTURE & FABRIC BEING CARRIED OUT FOLLOWING THE COMPLETE STRIP OUT OF EXISTING TENANTS FIXTURES & FITTINGS.

- COMMUNAL CIRCULATION AREA / STAIRWAY
- LBG - CIRCULATION AREA / STAIRWAY
- ACCESS FOR MAINTENANCE REQUIRED BY NON LBG EMPLOYEES

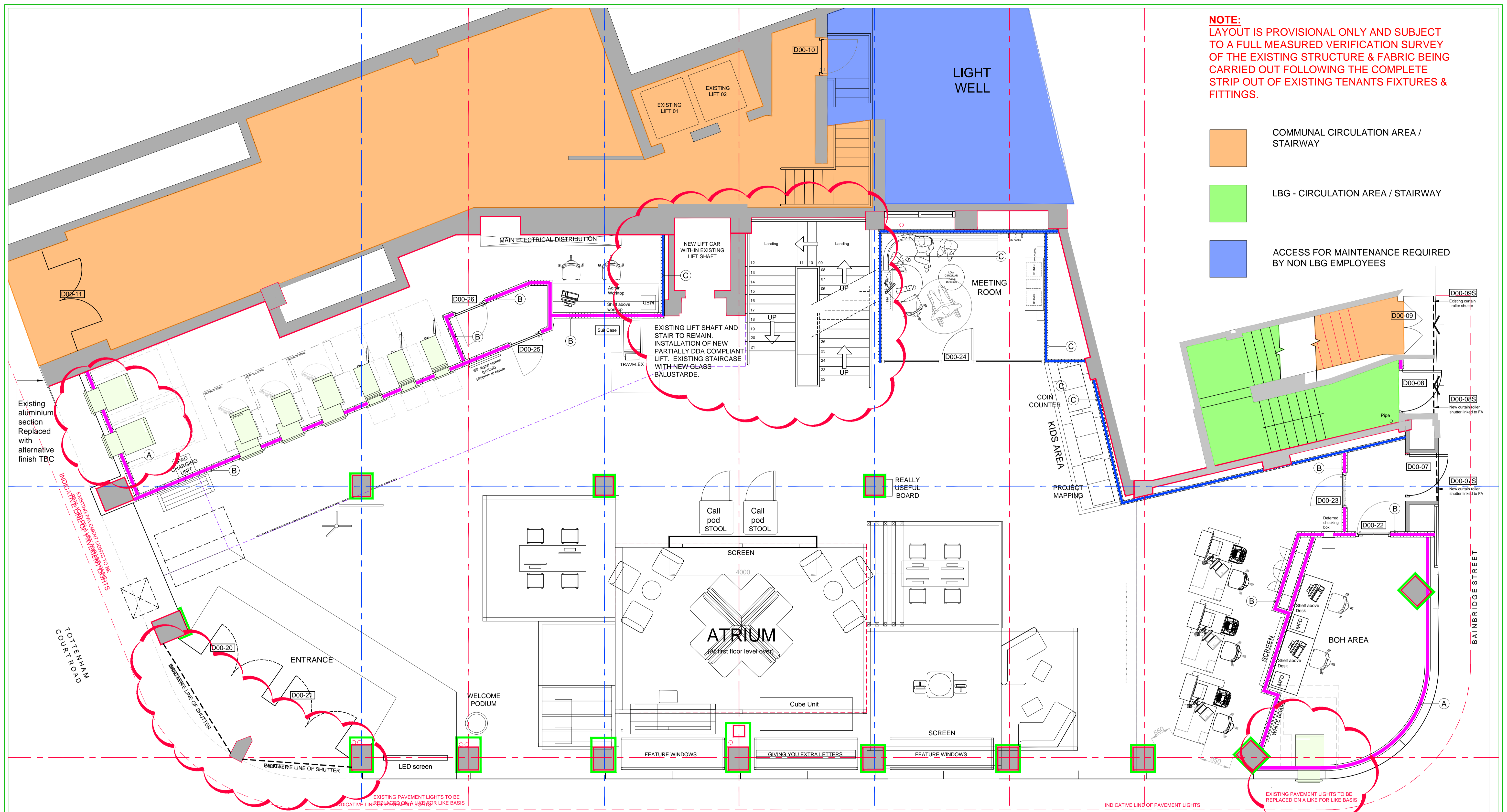

PROPOSED GROUND FLOOR PLAN

DIRECTION OF TRAFFIC FLOW →



LLOYDS BANKING GROUP

ALL DIMENSIONS TO BE VERIFIED PRIOR TO COMMENCING WORK. DRAWING TO BE READ IN CONJUNCTION WITH PROJECT SPECIFICATIONS.

THIS DRAWING IS THE PROPERTY OF LLOYDS BANKING GROUP AND COPYRIGHT IS RESERVED BY THEM. THE DRAWING IS ISSUED ON CONDITION THAT IT IS NOT COPIED OR DISCLOSED BY OR TO ANY UNAUTHORISED PERSONS WITHOUT PRIOR CONSENT IN WRITING TO LLOYDS BANKING GROUP - GROUP PROPERTY. ALL MODIFIED DRAWINGS SHOULD BE RETURNED TO LLOYDS BANKING GROUP.

GROUP PROPERTY

BRISTOL - PO Box 112, Canons House, Canons Way, BRISTOL, BS99 7LB
 EDINBURGH - Sighthill South, 12 Bankhead Crossway South, EDINBURGH, EH11 4EN
 HALIFAX - Trinity Road, HALIFAX, West Yorkshire, HX1 2RG

PROJECT ADDRESS	SCALE
Halifax 118-132, New Oxford Street West End LONDON, WC1A 1HL	A1 - 1:50 A3 - 1:100
DRAWING DESCRIPTION	DATE
Ground Floor Plan Proposed Plan	06/12/2017
DRAWING NUMBER	DRAWN BY
50941725-AR03-00-0001	PW
	REVISION
	-

REV	DATE	REVISION	INITIALS