

KEY - DEMOLITION

DEMOLITION

Broken red line denotes furniture, areas of partition, glazing or door etc to be removed.

COMPLETE BARE SHELL STRIP OUT TO INCLUDE ALL RETAIL FIXTURES AND FITTINGS, PLASTERBOARD AND SUSPENDED CEILINGS, DOORS & FRAMES AS INDICATED, EXISTING CIRCULATION STAIRCASE, ESCALATORS, RETAIL UNIT ENTRANCE DOORS LIMITED AREAS OF EXISTING SHOPFRONT.

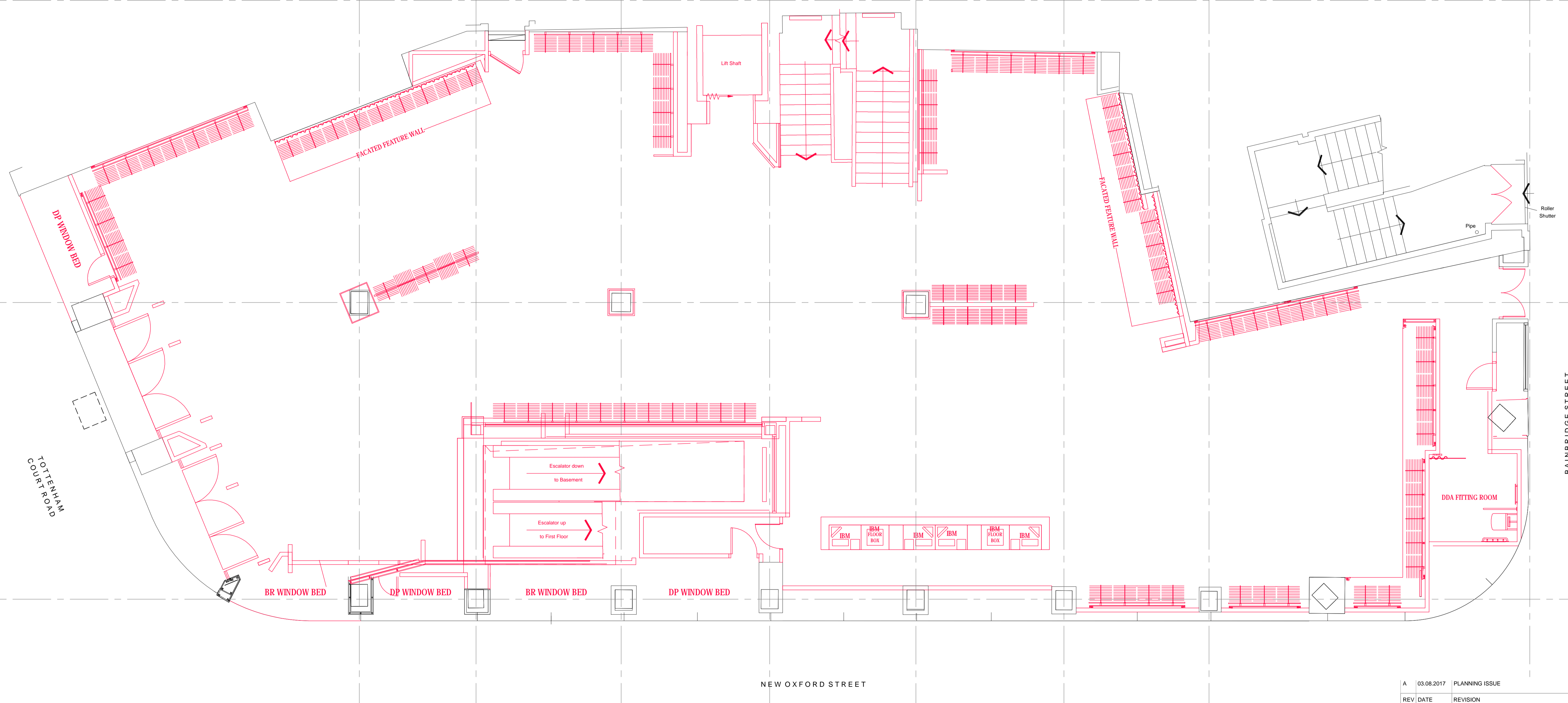

EXISTING GROUND FLOOR PLAN

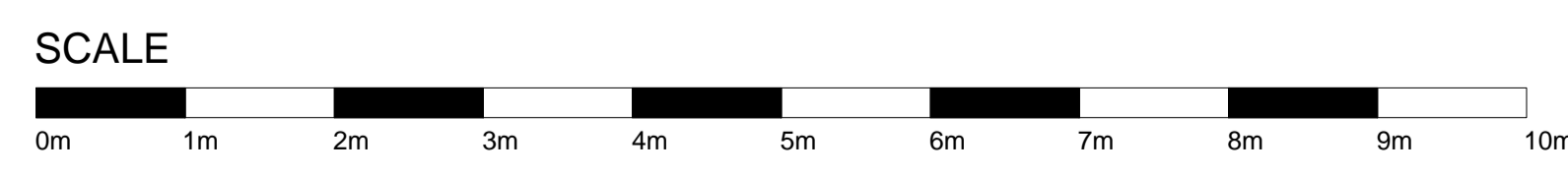

A	03.08.2017	PLANNING ISSUE	RA
REV	DATE	REVISION	INITIALS
LLOYDS BANKING GROUP			
ALL DIMENSIONS TO BE VERIFIED PRIOR TO COMMENCING WORK. DRAWING TO BE READ IN CONJUNCTION WITH PROJECT SPECIFICATIONS.			
THIS DRAWING IS THE PROPERTY OF LLOYDS BANKING GROUP AND COPYRIGHT IS RESERVED BY THEM. THE DRAWING IS ISSUED ON CONDITION THAT IT IS NOT COPIED OR DISCLOSED BY OR TO ANY UNAUTHORISED PERSONS WITHOUT PRIOR CONSENT IN WRITING TO LLOYDS BANKING GROUP - GROUP PROPERTY. ALL MODIFIED DRAWINGS SHOULD BE RETURNED TO LLOYDS BANKING GROUP.			
GROUP PROPERTY			
BRISTOL - PO Box 112, Canons House, Canons Way, BRISTOL, BS99 7LB EDINBURGH - Sighthill South, 12 Bankhead Crossway South, EDINBURGH, EH11 4EN HALIFAX - Trinity Road, HALIFAX, West Yorkshire, HX1 2RG			
PROJECT ADDRESS	Brand - Halifax 118-132, New Oxford Street West End LONDON, WC1A 1HL	SCALE	A1 - 1:50 A3 - 1:100
DRAWING DESCRIPTION	Ground Floor Plan Demolition and Removals PLANNING	DATE	30/08/2016
DRAWING NUMBER	50941725-AREX-00-0021 PL	DRAWN BY	RA
		REVISION	A