

proposed ground floor plan

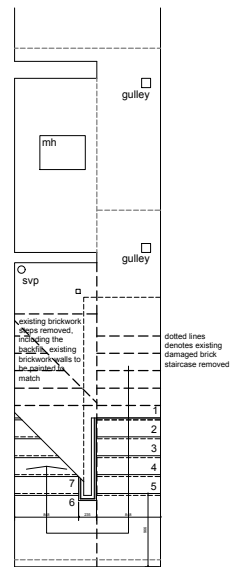

proposed lower ground floor plan



proposed sectional front elevation

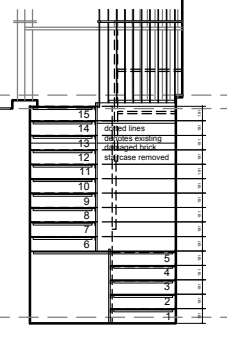

proposed sectional elevation

staircase:
total rise to be determined on site. metal staircase to manufacturers design and spec. to suit external location with equal risers @ 190mm max. (check on site). equal treads @ 250mm min. to give a max. pitch of 36 degrees. 2.00m riser head room. handrails and balustrades 900mm above pitch lines and 1100mm above landings. 100mm max. dia. voids to vertical balusters also to edge of main landing.
handrail and balustrade to match the existing railings painted black.

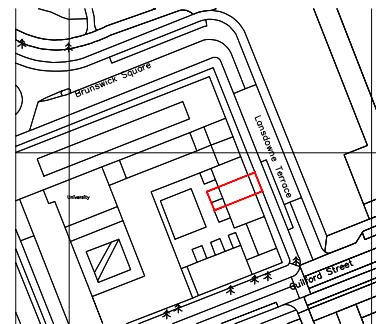
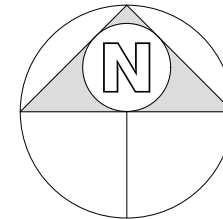

location plan
1:1250

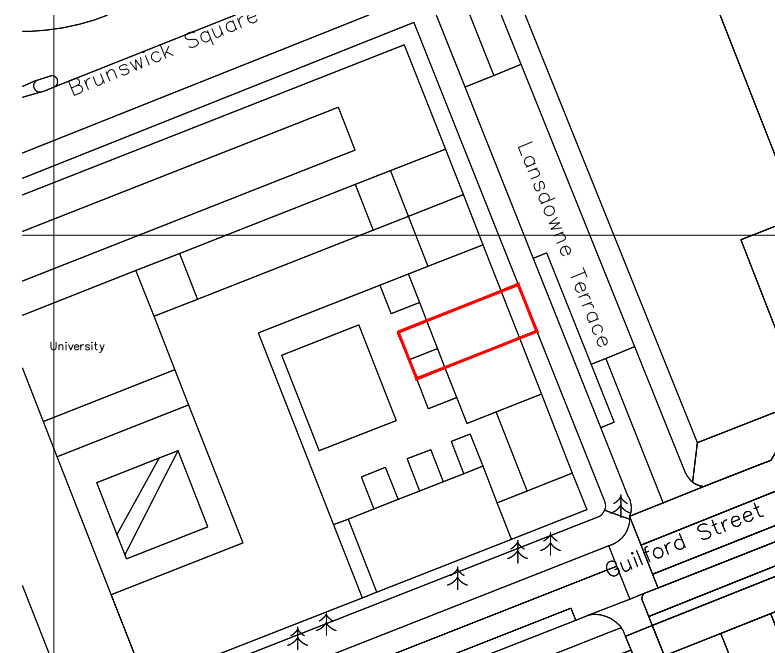

site plan 1:500

1:2500	0	50m	100m	200m
1:1250	0	25m	50m	100m
1:500	0	10m	20m	40m
1:200	0	5m	10m	20m
1:100	0	2m	4m	8m
1:50	0	1m	2m	4m

notes:
any discrepancies should be reported immediately
all dimensions should be checked on site prior to commencement of work
site/survey based on ordnance survey information provided by prodats systems plc. (www.promap.co.uk) prodats does not guarantee that all past or current uses or features will be identified in the product
the product does not give details about the actual state or condition of the site nor should it be used or taken to indicate or exclude actual suitability or unsuitability of the site for any particular purpose, or relied upon for determining suitability or value, or used as a substitute for any physical investigation or inspection.
drawings to be read in accordance with the dwelling emission rate (der/ter) calculation. the building must be built 'as designed' meeting the criteria set for air permeability.
© HERTFORD PLANNING SERVICE

note
when printing off pdf's, it is the responsibility of the user to verify that the resulting prints are to scale on the appropriate sized sheet.
also that the scale bars on the plan measure correctly.

Date	Description	Rev
Westgate House, 37-41 Castle Street, Hertford, Herts SG14 1HH Tel: 01992 552173 Fax: 01992 587643 Email: contact@hertfordplanning.co.uk www.hertfordplanning.co.uk		
Client	KCH Contractors Ltd	
Description	International House London	
Project	New staircase to lightwell	
Drawing	Planning Drawing	
Date	09/10/2017	
Scale	1:50 & 1:500	
Sheet size	A1	
Drawn		
13138-P-001-1st		