

PROPOSED CIRCLE PLAN  
(SCALE 1:10 AT A1)

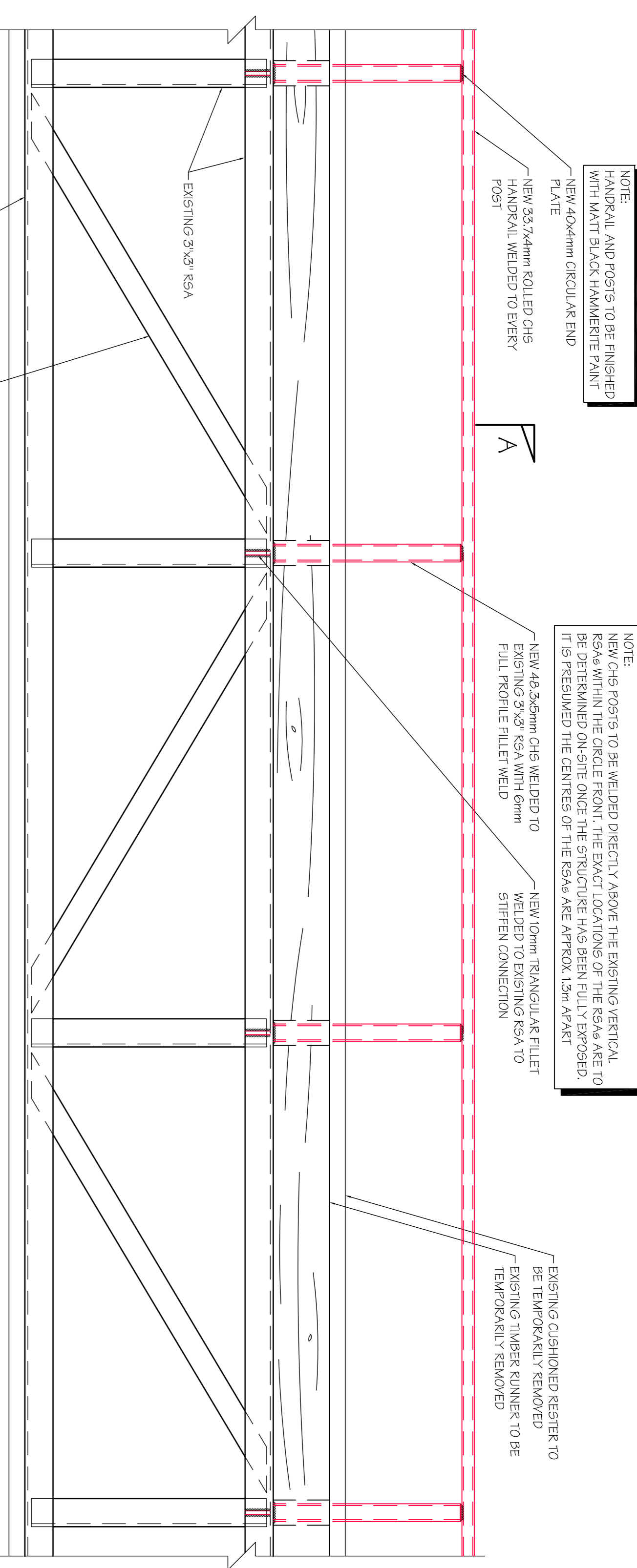

TYPICAL PROPOSED ELEVATION ON CIRCLE FRONT  
(SCALE 1:10 AT A1)

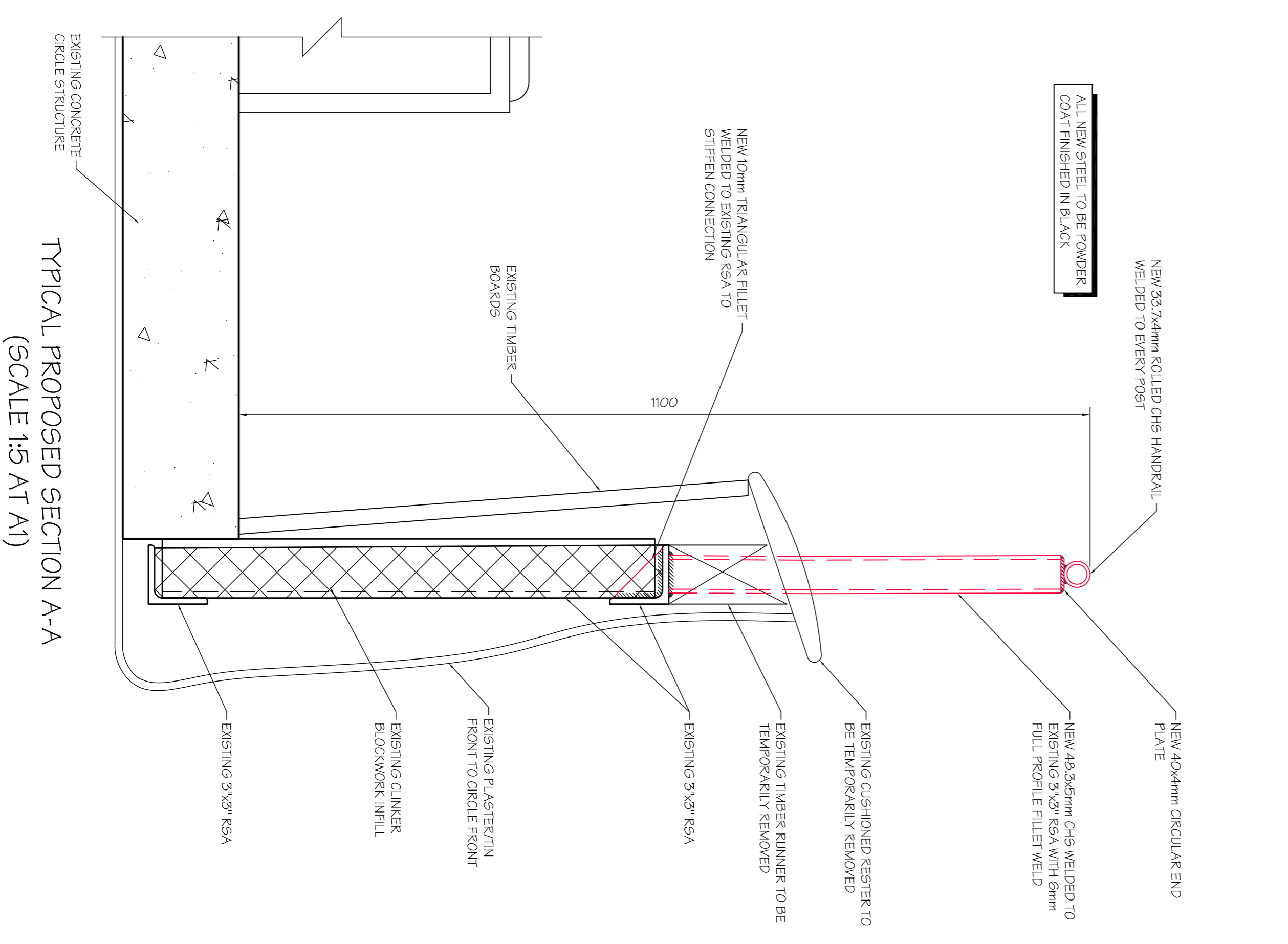

TYPICAL PROPOSED SECTION A-A  
(SCALE 1:5 AT A1)

NOTE:  
EXISTING CIRCLE TIMBER RUNNERS AND CISIONED RESTER TO BE ALTERED TO SUIT THE NEW POSTS AND REINSTATED PRIOR TO INSTALLING THE GLAZING

NOTE:  
HANDRAIL AND POSTS TO BE FINISHED WITH MATT BLACK HAMMERITE PAINT

NOTE:  
NEW CH9 POSTS TO BE WELDED DIRECTLY ABOVE THE EXISTING VERTICAL R5A6 WITHIN THE CIRCLE FRONT. THE EXACT LOCATIONS OF THE R5A6 ARE TO BE DETERMINED ON-SITE ONCE THE STRUCTURE HAS BEEN FULLY EXPOSED. IT IS PRESUMED THE CENTRES OF THE R5A6 ARE APPROX. 1.3m APART

EXISTING CISIONED RESTER TO BE TEMPORARILY REMOVED  
EXISTING TIMBER RUNNER TO BE TEMPORARILY REMOVED

- GENERAL**
- G1. ALL DIMENSIONS SHOWN ARE IN mm UNLESS NOTED OTHERWISE.
  - G2. ALL DIMENSIONS SHOWN ARE APPROXIMATELY ONLY AND MUST BE CHECKED AND CONFIRMED BY THE CONTRACTOR VIA A FULL DIMENSIONAL SURVEY OF THE AREA OF THE WORKS PRIOR TO UNDERTAKING OF THE WORKS. THE ENGINEER MUST BE NOTIFIED IMMEDIATELY SHOULD ANY DISCREPANCIES BECOME APPARENT.
  - G3. ALL DETAILS AND DIMENSIONS SHOWN RELATING TO THE EXISTING STRUCTURE ARE SO FORTH AND AS SHOWN AND SHOULD BE VERIFIED PRIOR TO COMMENCEMENT OF THE FABRICATION OF THESE DETAILS.
  - G4. THE DEPTH AND LOCATION OF ANY SERVICES HAS NOT BEEN ESTABLISHED. THE CONTRACTOR IS RESPONSIBLE FOR LOCATING AND PROTECTING THEM.
  - G5. ALL WORKMANSHIP AND MATERIALS TO COMPLY WITH THE CURRENT BUILDING REGULATIONS AND RELEVANT CURRENT BRITISH STANDARDS.
  - G6. THE CONTRACTOR SHALL ALLOW FOR ALL WORK NECESSARY TO OBTAIN FULL APPROVAL AND SIGNIFICATION OF THE BUILDING INSPECTOR.
  - G7. THE CONTRACTOR SHALL COMPLY WITH ALL REQUIREMENTS OF THE CURRENT HEALTH & SAFETY ATWORK ACT AND CONSTRUCTION REGULATIONS.
  - G8. THE CONTRACTOR IS RESPONSIBLE FOR ENSURING THAT HIS OPERATIONS DO NOT IN ANY WAY IMPAIR THE SAFETY OR CONDITION OF THE EXISTING STRUCTURE OR ADJACENT STRUCTURES. HE IS TO PROVIDE ANY TEMPORARY SUPPORTS, SHORING, ETC REQUIRED FOR THE PURPOSE AND HE IS TO CAREFULLY INSPECT THE CONDITION OF THE STRUCTURES BOTH BEFORE AND DURING ST TO BE NOTIFIED IMMEDIATELY SHOULD ANY DAMAGE OCCUR.
  - G9. ALL PROPRIETARY PRODUCTS TO BE USED IN STRICT ACCORDANCE WITH MANUFACTURERS INSTRUCTIONS AND RECOMMENDATIONS.

DO NOT SCALE THIS DRAWING.  
ORIGINAL DRAWING SIZE A1

Revisions	Revised By	Date	Description
A	DS	08-12-17	GLAZING SWAPPED FOR RAIL

**STEELWORK**

- S1. ALL STEELWORK TO BE GRADE A3 UNLESS NOTED OTHERWISE.
- S2. ALL STEEL WORK CONNECTIONS TO HAVE A MINIMUM OF 2 NO. M16 BOLTS GRADE 8.8
- S3. ALL NUTS TO BE M16000 TYPE GRADE 8.8
- S4. ALL STEEL IS TO MEET THE REQUIREMENTS OF EN1090. THE EXECUTION CLASS IS TO BE OBTAINED BY THE CONTRACTOR FROM THE CODE.
- S5. NEW STEELWORK TO BE TREATED AS FOLLOWS:  
SHOT BLAST CLEAN TO SA 2 1/2. SHOP APPLY ZINC RICH EPOXY PRIMER TO 40 MICRONS, THEN SHOT APPL. HIGH BUILD EPOXY WLD TO 120 MICRONS, THEN SITE APPL. HIGH BUILD EPOXY WLD TO 120 MICRONS.
- S6. ANY DAMAGED AREA OF PAINT FINISH TO BE TOUCHED UP LOCALLY ON SITE.
- S7. THE STEELWORK CONTRACTOR IS TO PROVIDE THE ENGINEER WITH 2 SETS OF FABRICATION DRAWINGS A MINIMUM OF 21 WORKING DAYS IN ADVANCE OF THE COMMENCEMENT OF FABRICATION.

**Client**  
Michael Jackson Consulting  
Chartered Structural Engineers

**204 BOSTON ROAD  
WALKER, WORCESTER  
MAKINSLEY, WS9 9BN**  
Tel: 0181 290 4404  
Fax: 0181 290 4405

**amg**  
ADAPTIVE WORK GROUP

**Venue**  
THE FORUM, KENTISH TOWN

**Project**  
CIRCLE RESTER IMPROVEMENTS

**Drawing Title**  
PROPOSED CIRCLE RESTER

Scale	Date	Drawn	Checked	Posted
AS SHOWN	JUNE 17	DS		

DRG. No. **2778-002 A**