

KEY:

- 1** = existing solid wall construction (including retained 1980s sand/cement render)
- 2** = existing sash window
- 3** = 12.5 mm plasterboard with Thistle finish coat on dabs on 3 mm thick Newton 503 vapour control/isolating membrane fixed to wall with Multiplug nailable plugs - 28 mm total thickness
- 4** = Selectaglaze secondary glazing (overall 68 mm standoff from inner face of sash window box frame)
- 5** = painted timber cill board
- 6** = painted softwood joinery (frame packing etc for secondary glazing) including ogee architraves

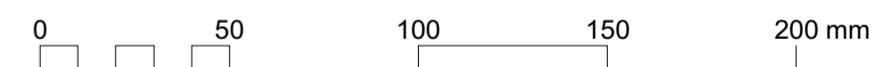
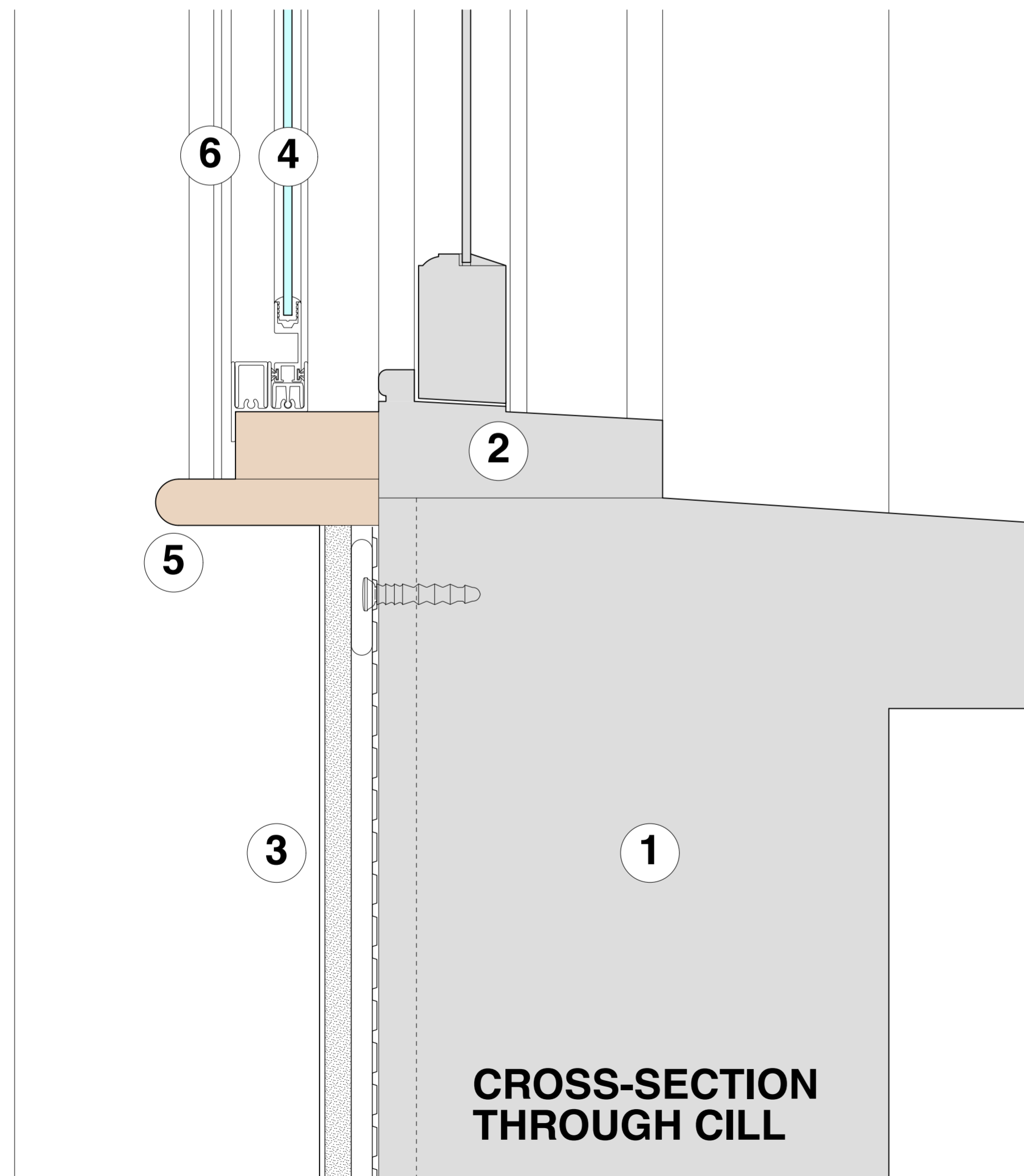
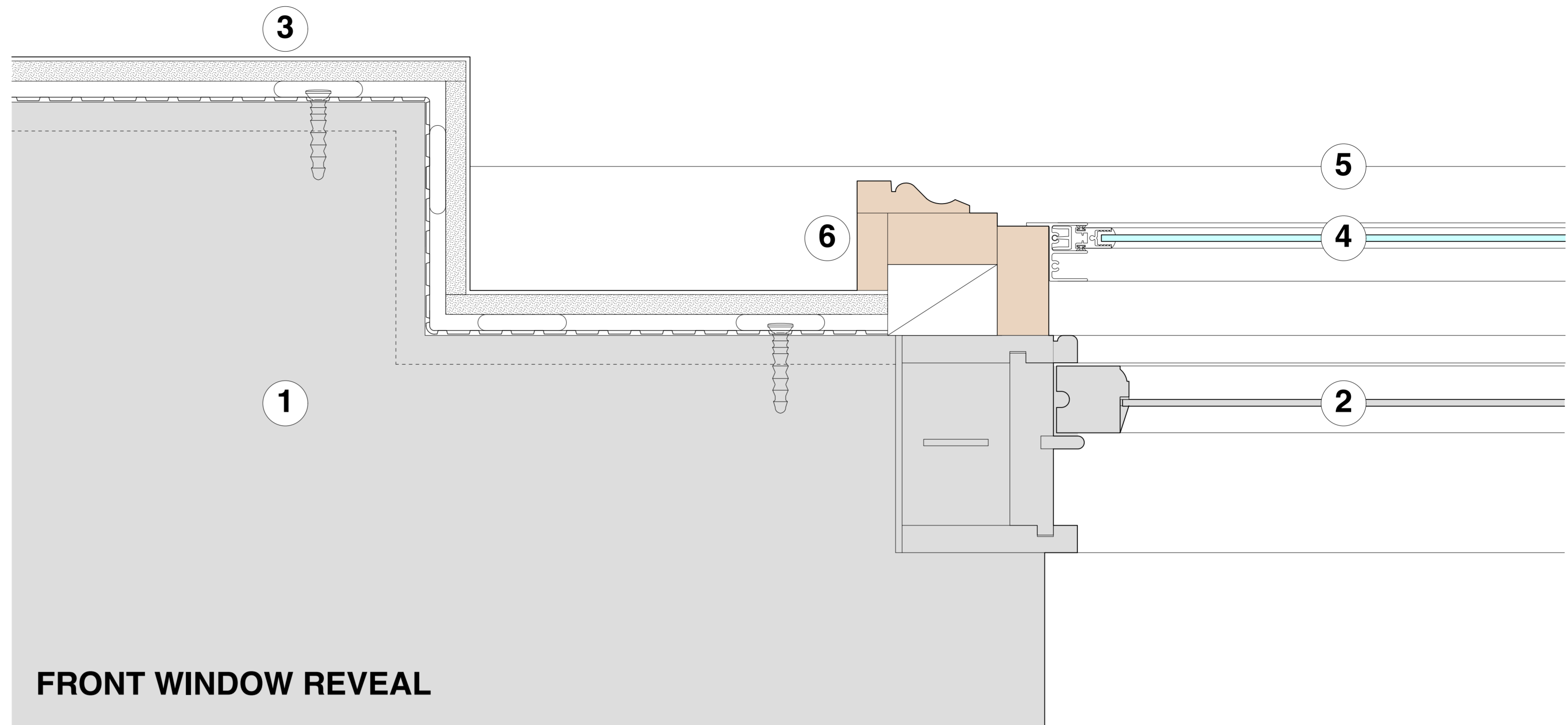

client ONE HOUSING GROUP	
job title FREDERICK STREET PORTFOLIO LONDON	
drawing 24 FREDERICK STREET BASEMENT DRY LINING DETAILS	
scale 1:2 @ A1 or 1:4 @ A3	date NOVEMBER 2017
drawn PS	checked SA
 <small>PROJECT 5 ARCHITECTURE LLP 8 Wilton Street London E2 8PL T: +44 (0)20 7739 9131 F: +44 (0)20 7739 3687 E: info@p5.co.uk</small>	
drawing no. 6214-FAC-D281	