

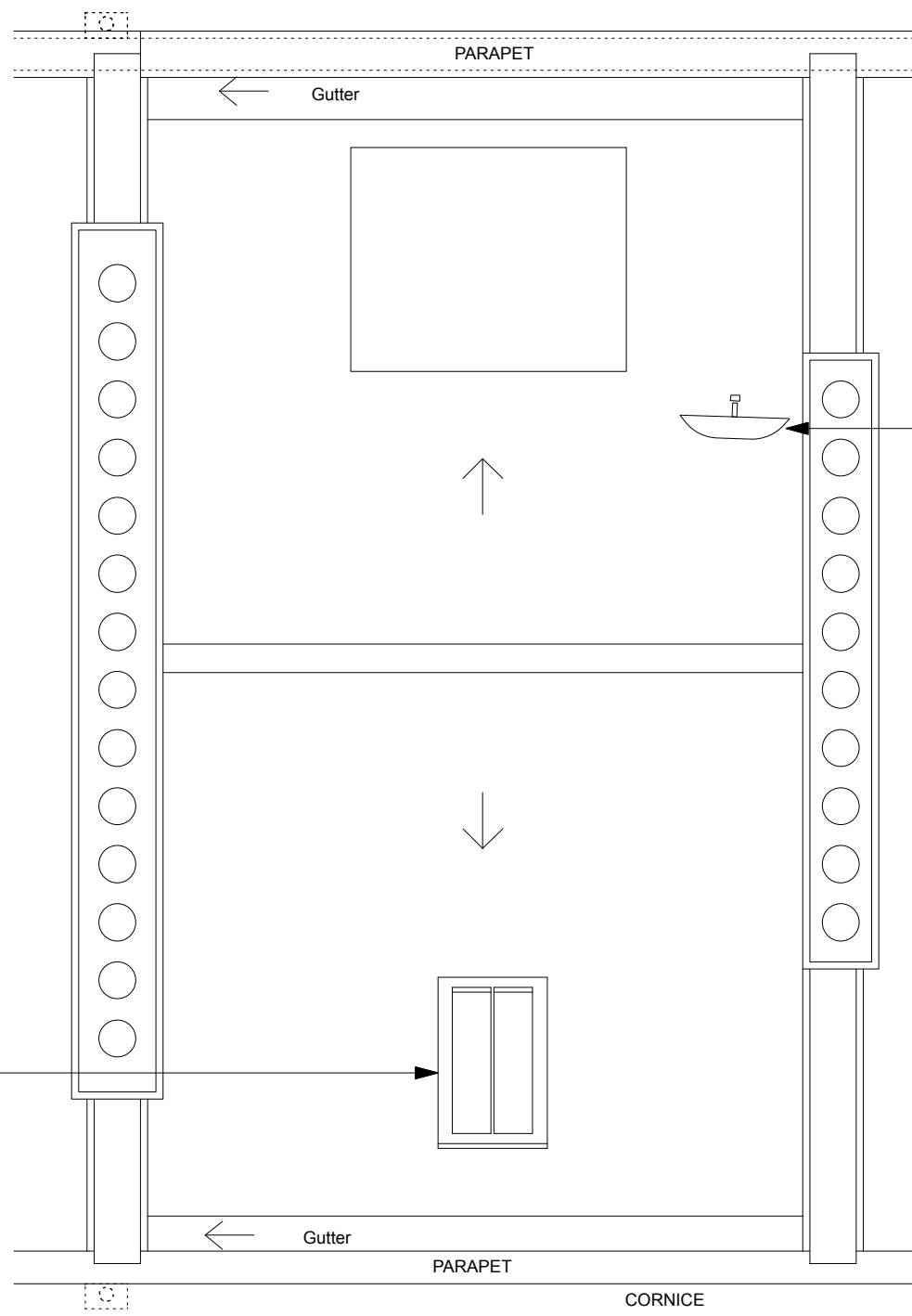

CONSTRUCTION KEY	
	existing retained
	line over/under/behind
	demolished
	new construction



Integrated Reception System (IRS) comprising 78cm diameter shared satellite dish and FM, UHF & DAB aerials. To be painted black and to be located on rear section of chimney stack as far below ridge as practicable, so as to minimise its effect on the property and on the amenity of the area.

new Velux top hung conservation rooflight
780x1400mm

	PROJECT 5 ARCHITECTURE LLP 8 Waterson Street London E2 8HL T: +44 (0)20 7739 9131 F: +44 (0)20 7739 3687 E: info@p5a.co.uk	job title 3 FREDERICK STREET, LONDON WC1X 0NG	scale 1:50 @ A3	drawn SA	drawing no. 6214-FS3-P06
	drawing ROOF PLAN - PROPOSED	date NOV 2017	checked XX		