

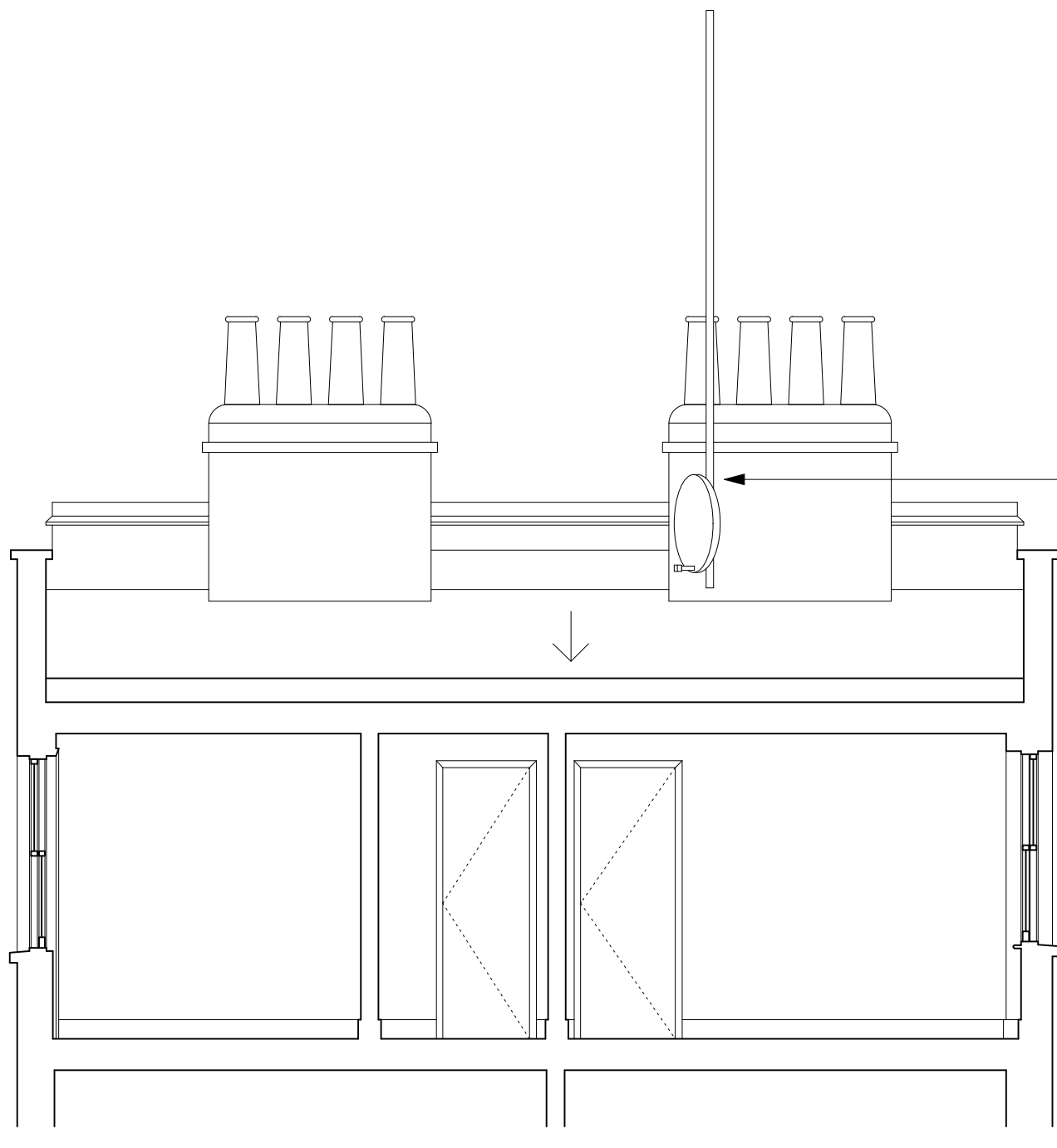

CONSTRUCTION KEY	
	existing retained
	line over/under/behind
	demolished
	new construction
	28mm thick drylining (incorporating Newton 503 mesh & 12.5mm plasterboard)

EXAMPLE OF IRS INSTALLATION - SATELLITE DISH (PAINTED BLACK), TV & RADIO AERIALS (at 33 FREDERICK STREET)



Integrated Reception System (IRS) comprising 78cm diameter shared satellite dish and FM, UHF & DAB aerials. To be painted black and to be located on rear section of chimney stack as far below ridge as practicable, so as to minimise its effect on the property and on the amenity of the area.

FRONT

REAR

	PROJECT 5 ARCHITECTURE LLP 8 Waterson Street London E2 8HL T: +44 (0)20 7739 9131 F: +44 (0)20 7739 3687 E: info@p5a.co.uk	job title 32 AMPTON STREET, LONDON WC1X 0LX	scale 1:50 @ A3	drawn SA	drawing no. 6214-AS32-P09
	drawing PROPOSED TV AERIAL INSTALLATION	date NOV 2017	checked XX		