





**CONSTRUCTION KEY**

-  existing retained
-  line over/under/behind
-  demolished
-  new construction
-  28mm thick drylining (incorporating Newton 503 mesh & 12.5mm plasterboard)

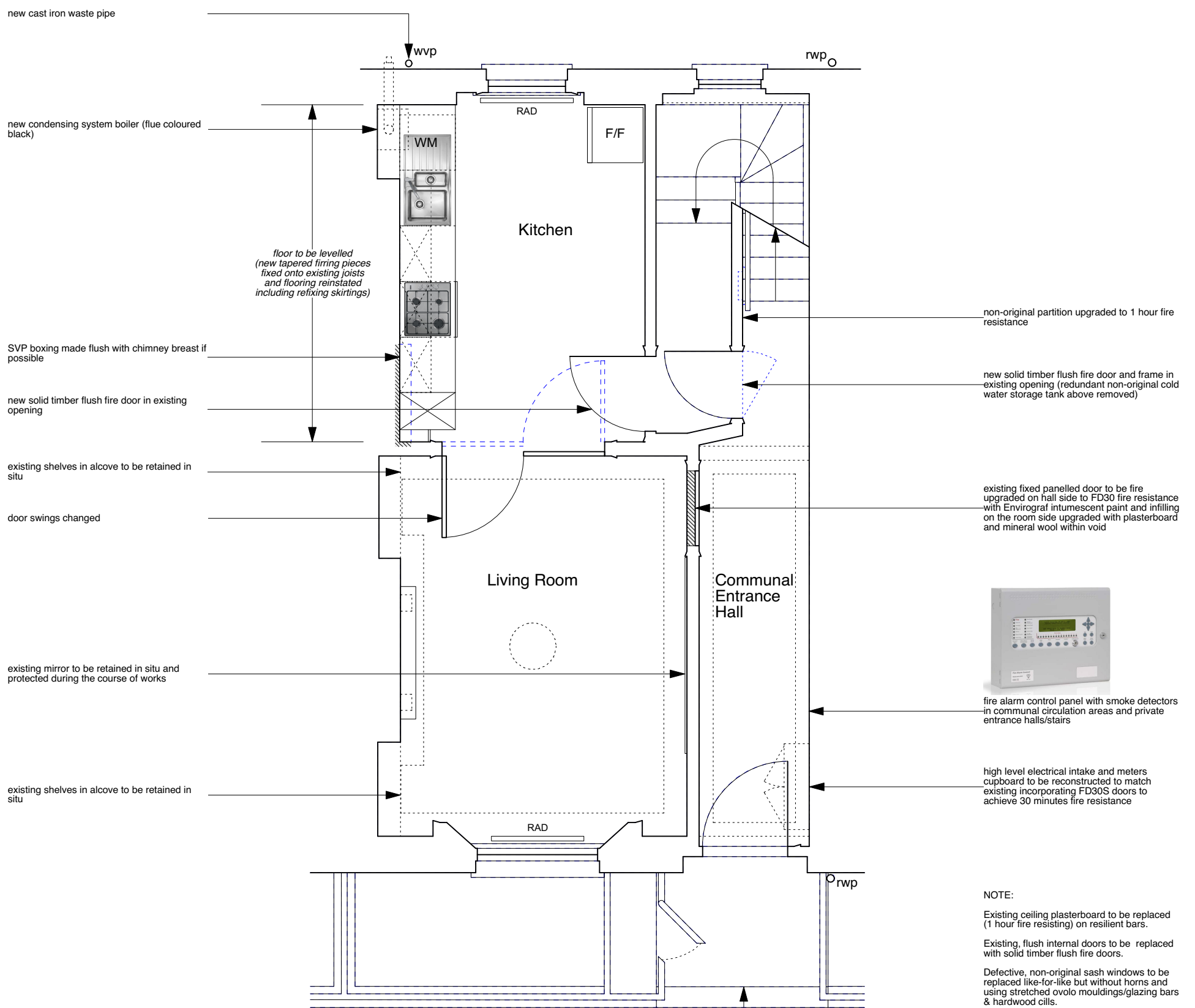

fire alarm control panel with smoke detectors in communal circulation areas and private entrance halls/stairs

high level electrical intake and meters cupboard to be reconstructed to match existing incorporating FD30S doors to achieve 30 minutes fire resistance

**NOTE:**  
 Existing ceiling plasterboard to be replaced (1 hour fire resisting) on resilient bars.  
 Existing, flush internal doors to be replaced with solid timber flush fire doors.  
 Defective, non-original sash windows to be replaced like-for-like but without horns and using stretched ovolo mouldings/glazing bars & hardwood cills.