

Unit 6  
Carrera Court  
Church Lane  
Dinnington, Sheffield  
South Yorkshire, S25 2RG  
Tel: 01909 560673

Prospect House  
The Hyde Business Park  
Hevendean  
Brighton, BN2 4JE  
Tel: 01273 621100

tersus



#### FOUR STAGE CLEARANCE TEST REPORT

**Job Number: J265040/EW01**

<b>Job Number</b>	J265040/EW01	<b>Report Date</b>	10 Oct 2017
<b>Customer Name</b>	Medway Insulations Ltd.	<b>Contractor</b>	Medway Insulations Ltd., 7 Viewpoint, Boxley Road, Penenden Heath, Maidstone, Kent, ME14 2DZ
<b>Customer Address</b>	7 Viewpoint, Boxley Road, Penenden Heath, Maidstone, Kent, ME14 2DZ	<b>Site Address</b>	19 - 21 High Holborn, Grays Inn Chambers, London, WC1R 5ET

#### Scope of Works

Brief Description of Work / Type of ACM / Location of ACM and Work Area / Any ACM to Remain by Design:

Removal and disposal of AIB Cladding that is hidden in partition walls (Phase 3) under fully controlled conditions.

I confirm that the scope of works has been completed and is ready for 4 Stage Clearance testing. \*

Site Supervisor  
Name Dave Ward

Signature

Date 10 Oct 2017

Time 10:00

#### STAGE 1 - Preliminary Check of Site Conditions and Job Completeness

Start Time	10:00	Finish Time	10:20
1. Method statement (Plan of work) on site and checked	Yes	2. DCU intact, operational and clean	Yes
3. Transit route free from obvious ACMs	Yes	4. Waste route free from obvious ACMs	Yes
5. Surrounding areas free from obvious ACMs	No	6. Negative pressure unit in situ and operational	Yes
7. Viewing panel fitted / CCTV (no if visibility is limited)	Yes	8. Integrity of enclosure/work area checked and satisfactory	Yes
9. Waste disposal / storage area checked and satisfactory	Yes	10. Previous air / smoke testing carried out (state)	
/ smoke testing carried out (state)			N/A

#### Comments

No DCU test required due to ongoing works.  
Bitumen is present on the Floor of the Enclosure in places and on the Waste/Transit Route (Beyond the Scope of Works).

For and on behalf of Tersus Consultancy Ltd.

Ant Browne

Signature

Date 10 Oct 2017

Time 10:20

Site assessment for reoccupation (4 Stage Clearance) comprises four stages of assessment, undertaken to satisfy current asbestos regulations, resulting in the issue of a Certificate of Reoccupation (CoR). In some cases Stage 3 (air testing) may be omitted as stated in L143, paragraph 284, when requested by the customer. In this case this will be clearly stated on the test report. Clearance (C), static samples are taken in order to assess an environment to the clearance indicator (as part of the CoR process and for decontamination units). Any deviations to these standard tests shall be recorded as appropriate.

FOUR STAGE CLEARANCE TEST REPORT

Job Number: J265040/EW01

STAGE 2 - Visual Inspection

Start Time	10:24	Finish Time	10:45
11. All ACMs removed according to plan of work, dust debris contaminated clothing etc.	Yes	16. Dust and debris in enclosure and airlocks, or work area	No
12. Enclosure and airlocks, or work area dry	Yes	17. Negative Pressure unit switched on	Yes
13. Presence of sprayed sealant	No	18. ACMs to remain (by design as noted on stage 1)	Yes
14. Inaccessible areas (if yes please indicate on diagram)	No	19. Number of visuals undertaken	
Number of visuals undertaken		1	

Approximate Area/Enclosure dimensions Length: 6 m Width: 4 m Height: 3 m Approx. Area: 24 m<sup>2</sup> Approx. Volume: 72 m<sup>3</sup>

Site Plan

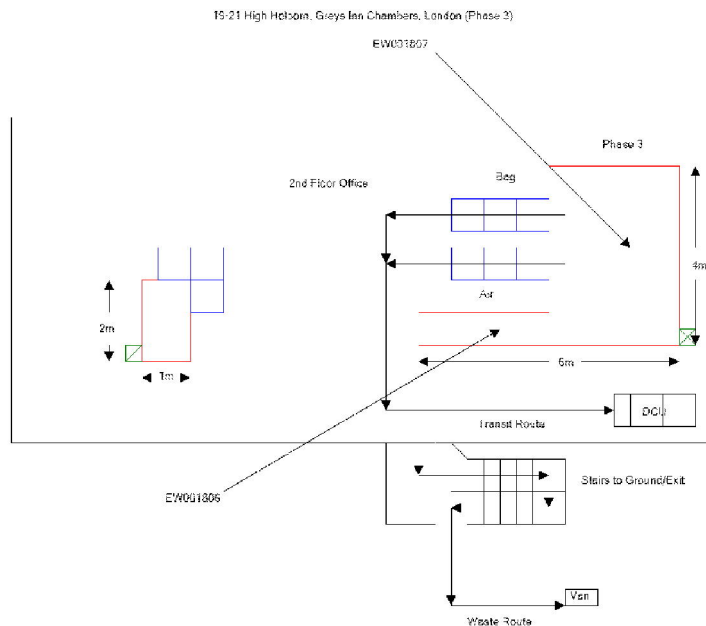

For and on behalf of Tersus Consultancy Ltd.

Ant Browne

Signature

Date

10 Oct 2017

Time

10:45

## FOUR STAGE CLEARANCE TEST REPORT

Job Number: J265040/EW01

Site Address				19 – 21 High Holborn, Grays Inn Chambers, London, WC1R 5ET														
Lab location / Veh. Reg.				DL16 SVU			Respirator type			Full Face		Filter Diameter					22 mm	
Flow meter reference				SFM 07			Micrometer reference			SM 10								
HSE/NPL Test slide ref.				3813														
Microscope reference							N 26		Graticule diameter					100 µm				
Timer reference				BTT 08			Filter box reference			267		Centred and block 5 visible					Yes	
Sample ref	Sample (s) location	Pump ref	Filter Head ref	Temp (°C)	Pressure (mb)	Flow Rate Start	Sample Start Time	Brush Disturbance (mins)	Sample Stop Time	Flow Rate Stop	Duration (mins)	Sample Volume (l)	Average Flow Rate	Fibres	Fields	Limit of Detection (f/ml)	Calculated Result (f/ml)	Reported Result (f/ml)
EW001806	Corridor	AB8L 1550	GB3	15.6	1016	8.0	10:47	10:47 10:50	11:47	8.1	60	483	8.1	8.5	200	0.01	0.0042	<0.01
EW001807	Main	AB8L 1553	GB5	15.6	1016	8.2	10:47	10:47 10:50	11:47	8.3	60	495	8.3	9	200	0.01	0.0044	<0.01
EW001809	Field Blank	N/A	FMB	15.6	1016	N/A	N/A	N/A	N/A	N/A	N/A	N/A	N/A			Field Blank		

## Comments:

N/A

REPORTING RESULTS: These results have been obtained and reported under the requirements of our UKAS accreditation to ISO 17025:2005, applying the methods as detailed in HSG248. WHO fibre counting rules are applied, as detailed in HSG248. At least 20 fields must be read, and counting stops when either 100 fibres or 200 fields is reached. The number of fields counted may be reduced where the volume is greater than 480 litres. Opinions and interpretations based on test results are outside the scope of UKAS accreditation. Where the results are < 0.010 f/ml the area has passed relative to the clearance indicator as required for CoR. At least 80% of the results should be < 0.010 f/ml, and all should be < 0.015 f/ml. Results are calculated to three decimal places to distinguish between 0.009 f/ml (which is acceptable) and 0.010 f/ml (which is unacceptable). If the sample appears to be uncountable or biased this statement and reasoning shall be noted on the report. Uncertainty budget: sampling and analysis is performed to an estimated level of confidence of 95%.

ABBREVIATIONS f/ml: fibres per millilitre of air, l: litre, m: metre, °C: centigrade, mb: millibar, N/A: Not Applicable, NPU: Negative Pressure Unit, FMB Field Media Blank (media check).

FILTER EVALUATION: Discrimination between asbestos and non-asbestos fibres is NOT undertaken in the application of the method for filter evaluation.

For and on behalf of Tersus Consultancy Ltd.

Ant Browne

Signature



Date 10 Oct 2017

Time 12:07

**Comments:**

The Enclosure is formed by two walls and two sides are Polythene with wooden supports.  
 A suspended Ceiling is being held up by wooden stilts and the top of the Ceiling has been sheeted out of the Enclosure.  
 The Windows and below the Windows have been sheeted out prior to inspection.  
 The Floor has been sheeted out apart from where the Partition Walls and the AIB Has been removed.  
 All the Walls that had AIB in and all supporting Timber has been removed revealing small sections of the Floor and Ceiling that are clean and debris free.  
 All Polythene is clean and debris free.  
 The Ceiling is painted White and is clean and debris free.  
 All Holes that are in the Enclosure Ceiling are clean and debris free.  
 No AIB Debris present.

**STAGE 3 - Air Monitoring**

29. Measurements required	2	30. No of measurements taken	2
32. Areas of limited dust disturbance (state)	No		

**STAGE 4 - Final assessment post enclosure/work area dismantling**

33. Enclosure, airlocks or designated work area removed completely	Yes	34. Former enclosure or work area free of dust and debris	Yes
35. Transit route free from obvious ACM	Yes	36. Waste route free from obvious ACM	Yes
37. Where ACM remains by design, is it in a good condition?	Yes	38. Further remedial action required	No
39. Surrounding areas free from obvious ACM	Yes	40. Does the decontamination unit require testing	No

**Comments**

DCU to remain on Site for ongoing works.

For and on behalf of Tersus Consultancy Ltd.

Ant Browne

Signature



Date 10 Oct 2017

Time 13:10

**Contractor/Customer acknowledgement**

Name Dave Ward

Company/Organisation Medway Insulations Ltd.

Signature



Date 10 Oct 2017

Unit 6  
Carrera Court  
Church Lane  
Dinnington, Sheffield  
South Yorkshire, S25 2RG  
Tel: 01909 560673

Prospect House  
The Hyde Business Park  
Hevendale  
Brighton, BN2 4JE  
Tel: 01273 621100

tersus



Certificate for Reoccupation

Job Number: J265040/EW01

Job Number	J265040/EW01	Report Date	10 Oct 2017
Customer Name	Medway Insulations Ltd.	Contractor	Medway Insulations Ltd., 7 Viewpoint, Boxley Road, Penenden Heath, Maidstone, Kent, ME14 2DZ
Customer Address	7 Viewpoint, Boxley Road, Penenden Heath, Maidstone, Kent, ME14 2DZ	Site Address	19-21 High Holborn, Grays Inn Chambers, London, WC1R 5ET
Enclosure Location / Work Area Offices 2nd Floor (Phase 3)			

STAGE 1 OF 4 - PRELIMINARY SITE ASSESSMENT Précis of assessment criteria		
SCOPE OF WORK / METHOD STATEMENT PRESENT ALL WORKS WITHIN SCOPE COMPLETED WORK AREA ENCLOSURE AND AIRLOCKS INTACT AND CLEAN AIR EXTRACTION UNIT OPERABLE HYGIENE FACILITIES OPERATING AND CLEAN AREA SURROUNDING ENCLOSURE CLEAN TRANSIT ROUTE CLEAN WASTE ROUTE & DISPOSAL AREA CLEAN	SATISFACTORY	As Detailed on Report <b>'Preliminary Check of Site Conditions and Job Completeness'</b>
STAGE 2 OF 4 - VISUAL INSPECTION Précis of assessment criteria		
AIR LOCKS CLEAR OF DEBRIS AND CLEAN ENCLOSURE / WORK AREA CLEAR OF DUST AND DEBRIS ALL SPECIFIED WORKS UNDERTAKEN	SATISFACTORY	As Detailed on Report <b>'Visual Inspection'</b>
STAGE 3 OF 4 - AIR MONITORING Précis of assessment criteria		
DETERMINATION OF AIRBORNE FIBRE CONCENTRATION RESULTS TO THE CLEARANCE INDICATOR (0.01f/ml)	SATISFACTORY	As Detailed on Report <b>'Determination of Airborne Fibre Concentrations'</b>
STAGE 4 OF 4 - FINAL SITE ASSESSMENT Précis of assessment criteria		
ENCLOSURE AND AIR LOCKS REMOVED FORMER WORK AREA FREE FROM DUST AND DEBRIS TRANSIT ROUTE CLEAN WASTE ROUTE CLEAN REMAINING ACMs IN GOOD CONDITION	SATISFACTORY	As Detailed on Report <b>'Final Assessment - Post Enclosure/Work Area Dismantling'</b>
<b>Reason for Sampling</b> Removal and disposal of AIB Cladding that is hidden in partition walls (Phase 3) under fully controlled conditions.		

For and on behalf of Tersus Consultancy Ltd.

I CONFIRM THAT THE FORMER WORK AREA / ENCLOSURE LOCATION DESCRIBED IS CLASSED AS SAFE FOR REOCCUPATION

Signature

Ant Browne

Notes: This certificate is not complete unless a copy of the results of the individual stages is appended.

CONTRACTOR / CUSTOMER ACKNOWLEDGEMENT

Signature

Dave Ward