

- DEMOLITION AND STRIP-OUT NOTES:**
- REMOVE ALL LOOSE FURNITURE FROM SPACE.
 - REMOVE ALL FITTED NON-ORIGINAL SHELVING/BOOKCASES INCLUDING PELVERS AND FINISH.
 - REMOVE EXISTING UP-LIGHTING TO TOP OF NON-ORIGINAL SHELVING.
 - REMOVE EXISTING NON-ORIGINAL STAIRCASE INCLUDING FINISHBASE AND BOOKCASE SURROUNDS.
 - REMOVE ALL NON-ORIGINAL FLOOR FINISHES AND NON-ORIGINAL UNDERLAYERS.
 - REMOVE EXISTING NON-ORIGINAL GLASS AND STEEL BALUSTRADE FROM PERIMETER OF VOID IN FLOOR.
 - REMOVE EXISTING NON-ORIGINAL DROPPED CEILING DETAIL OVER VOID.
 - REMOVE ALL EXISTING NON-ORIGINAL SURFACE RIGID LIGHTING AND SERVICES FROM CEILING AND WALLS (IE LIGHT FINISHES, SMOKE ALARMS BELLS, SQUIDERS, FIRE ALARM SENSOR CABLES AND CABLE CONDUITS).
 - REMOVE EXISTING NON-ORIGINAL TIMBER PARTITION OFFICE AND CURVED GLASS FRONTAGE.
 - REMOVE EXISTING NON-ORIGINAL TIMBER PARTITION AND DROPPED CEILING FORMING CORNER AREA (OPPOSITE CORNER TO OFFICE).
 - INCREASE WIDTH AND HEIGHT OF EXISTING DOOR OPENING BETWEEN LIBRARY AND CLASSROOM ON UPPER GROUND FLOOR.
 - REMOVE EXISTING NON-ORIGINAL TIMBER VERNER PANELING, DOORS AND GLASS VISION PANELS TO OPENINGS BETWEEN LIBRARY AND CORRIDOR.
 - REMOVE EXISTING NON-ORIGINAL GLASS AND STEEL BALUSTRADE FROM INSIDE OF EXISTING WINDOWS.

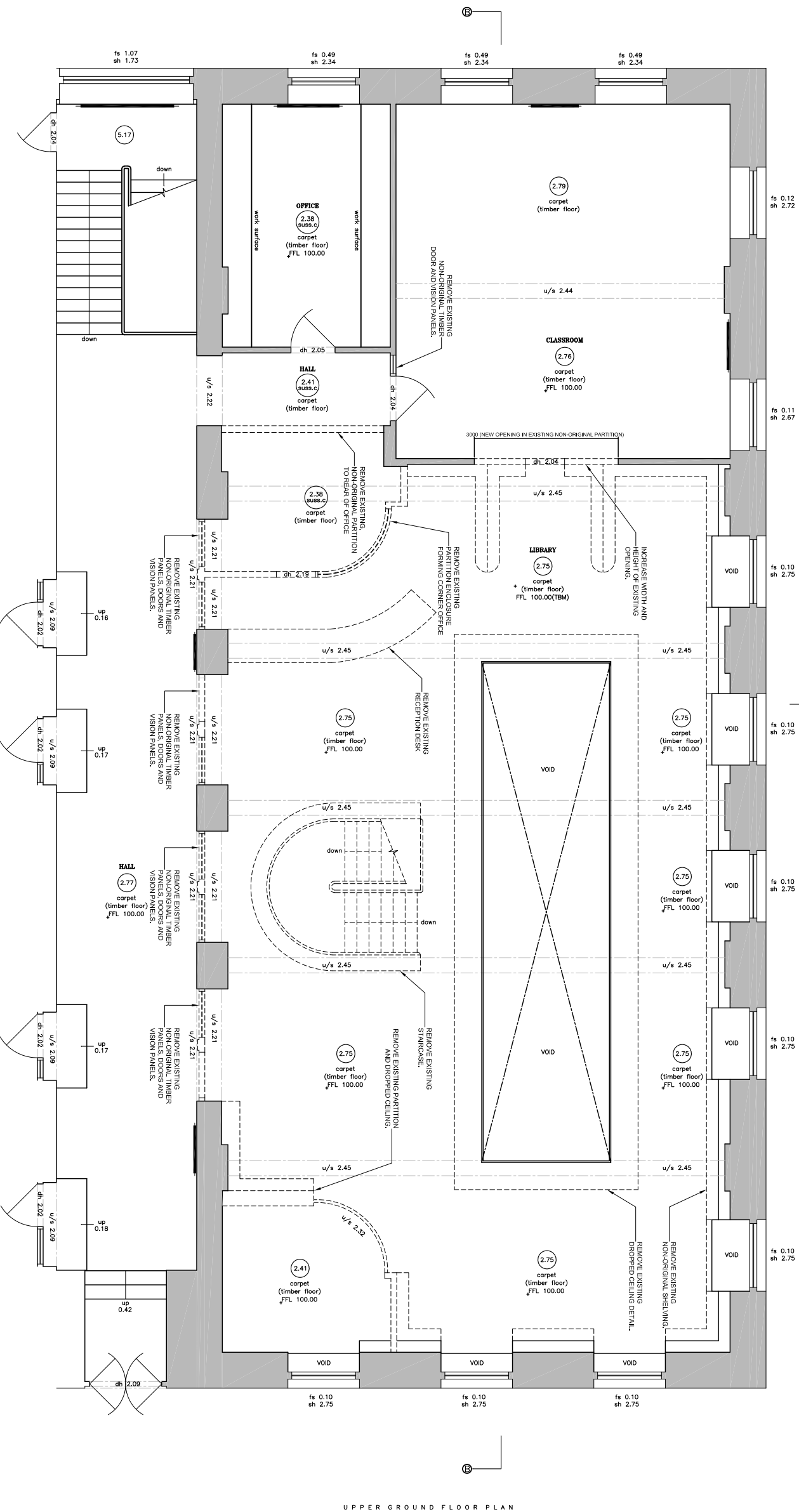

UPPER GROUND FLOOR PLAN

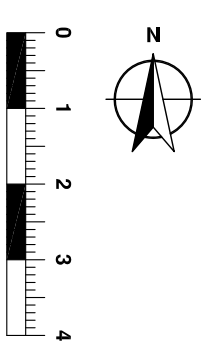

- EXISTING WALLS TO BE RETAINED.
- DEMOLITION AND STRIP-OUT ELEMENTS, SHEDDING WALLS TO BE REMOVED, NON-ORIGINAL CEILING DETAILS TO BE REMOVED.

REV	DATE	DESCRIPTION	DRAWN
00	DEC 2017	ISSUED FOR TENDER BIDDING CONSOLE	AC

CLIENT: UCS HAMPSTEAD SENIOR SCHOOL
 PROJECT: REFURBISHMENT OF EXISTING LIBRARY & CREATION OF CLIT CLASSROOM
 DRAWING TITLE: UPPER GROUND FLOOR DEMO

STATUS: FOR PLANNING

PROJECT No	DWG TYPE	DWG No	REV
2495	PL	050	00

SCALE: 1:100@A3 NOV17
 DATE: NOV 17
 DRAWN: AC
 CHECKED: AC

CONTRACTOR TO CHECK, RE-DESIGN AND REPORT ANY VARIATIONS OR OMISSIONS TO LEWANDOWSKI ARCHITECTS. CONTRACTOR TO VERIFY ALL DIMENSIONS AND LOCATIONS OF ALL EXISTING AND PROPOSED ELEMENTS. CONTRACTOR TO VERIFY ALL DIMENSIONS AND LOCATIONS OF ALL EXISTING AND PROPOSED ELEMENTS. CONTRACTOR TO VERIFY ALL DIMENSIONS AND LOCATIONS OF ALL EXISTING AND PROPOSED ELEMENTS.

1st FLOOR: RAFTS COURT, BROCCAS ST, ETON, SL4 6RF.
 T: 01753 620700 F: 01753 620621
 www.lewandowskiarchitects.com