

FYTOTEXTILE MODULE

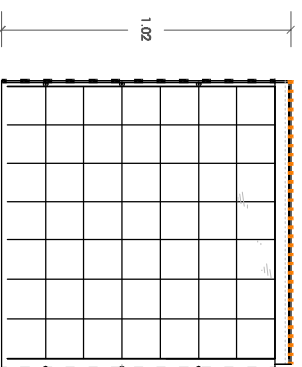

POSITION OF ZINC PLATED HEX
HEAD SCREW TO FIX THE
MODULES, DIAMETER 4-5 mm



--- SIDEBAND JOINT
--- UPPER JOINT

STEPS INSTALLATION

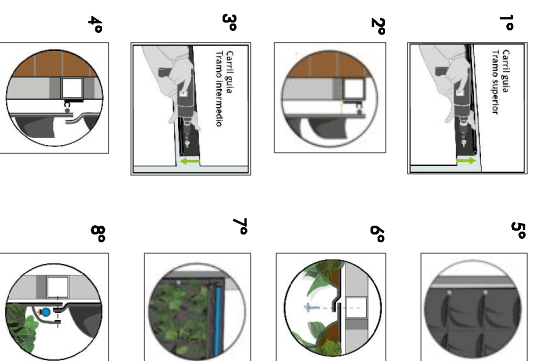

Previously you would need to install the auxiliary substructures we indicate in the drawing number 02.01

Installation steps

- 1º Install the upper profile of the module of the top
- 2º Install the modules of the top
- 3º Install the intermediate upper profile
- 4º Install the intermediate modules
- 5º Screw the screws with side bands (1 screw as we indicate in the drawing 01.1)
- 6º Screw the screws in the joints of the modules
- 7º Install the pipelines with autocompensating drippers in the top of the living wall
- 8º Install the pipelines with autocompensating drippers in the intermediate position of the living wall
- 9º Install the irrigation system as we indicate in the drawing 04.1
- 10º Place the plants as we indicate in the drawing 05.1. Previously you would need to check the irrigation circuit

1 7003 LIVING WALL CANOPY

NOVEMBER 2017

OVERLAY OF MODULES 02.01

S: 1/50

INSTALLER:
SCOTSCAPE Ltd



CONSULTOR
Terapia Urbana S.L.
B-91880724.
c/ Fuencarral Acc.12-14 Local 4D.
Cp. 41015 Sevilla
+34 955 229 666

R7