

0 Gnd Floor Core Existing plan
1:100 @A1

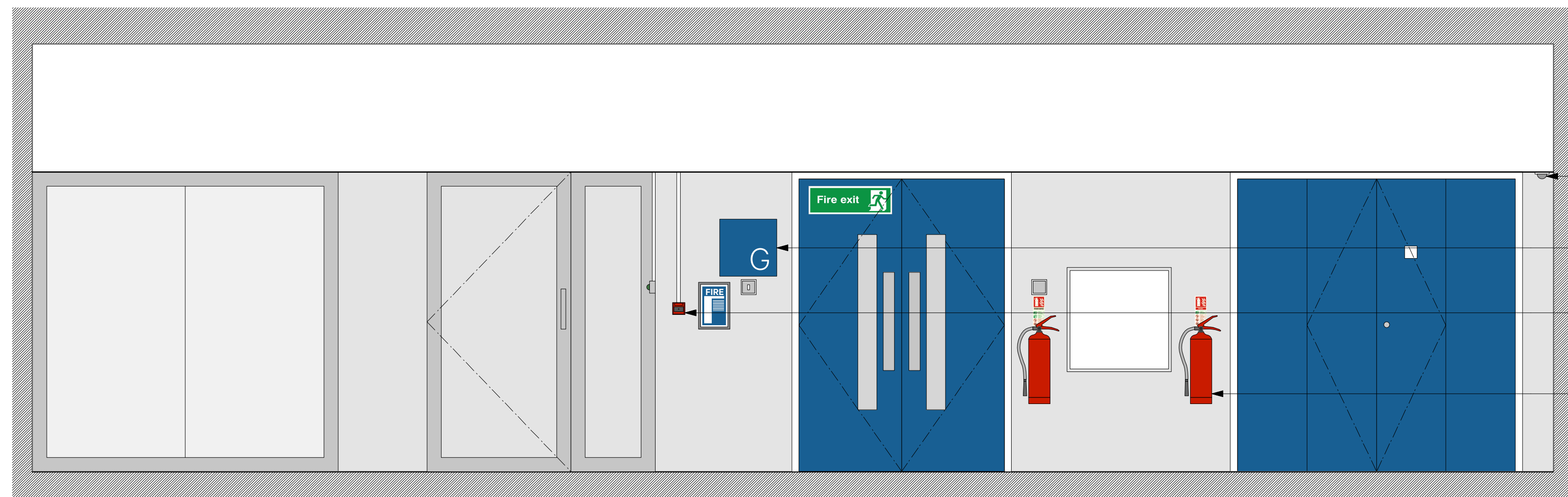

- Existing CCTV to be removed.
- All signage to be stripped out.
- Fire break glass to be relocated.
- Fire Extinguishers to be relocated into new joinery unit.

1 Gnd floor core existing elevation 1
1:25 @A1

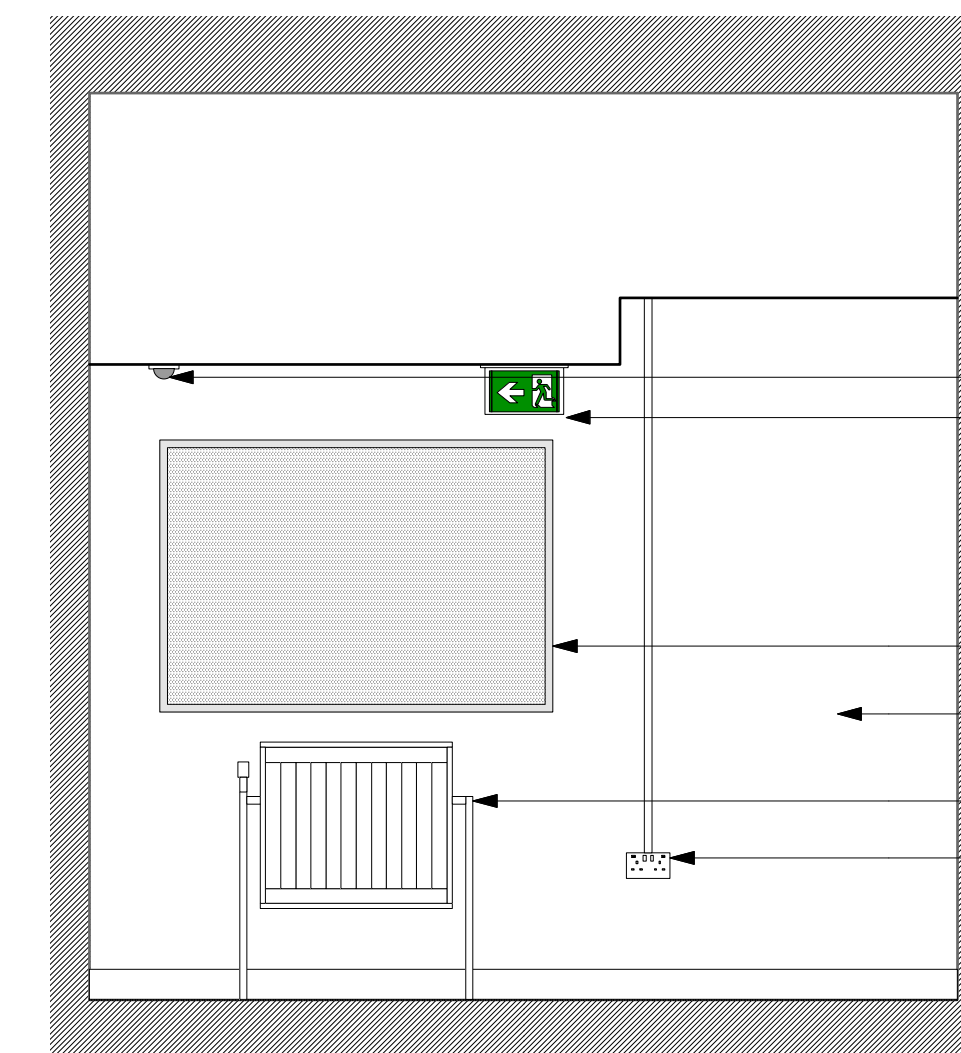

- Existing CCTV to be removed.
- Fire Exit sign to be removed.
- Noticeboard to be removed.
- Existing plasterboard lining and skirting to be made good and painted.
- Radiator to be removed.
- Socket and conduit to be removed.

2 Gnd floor core existing elevation 2
1:25 @A1

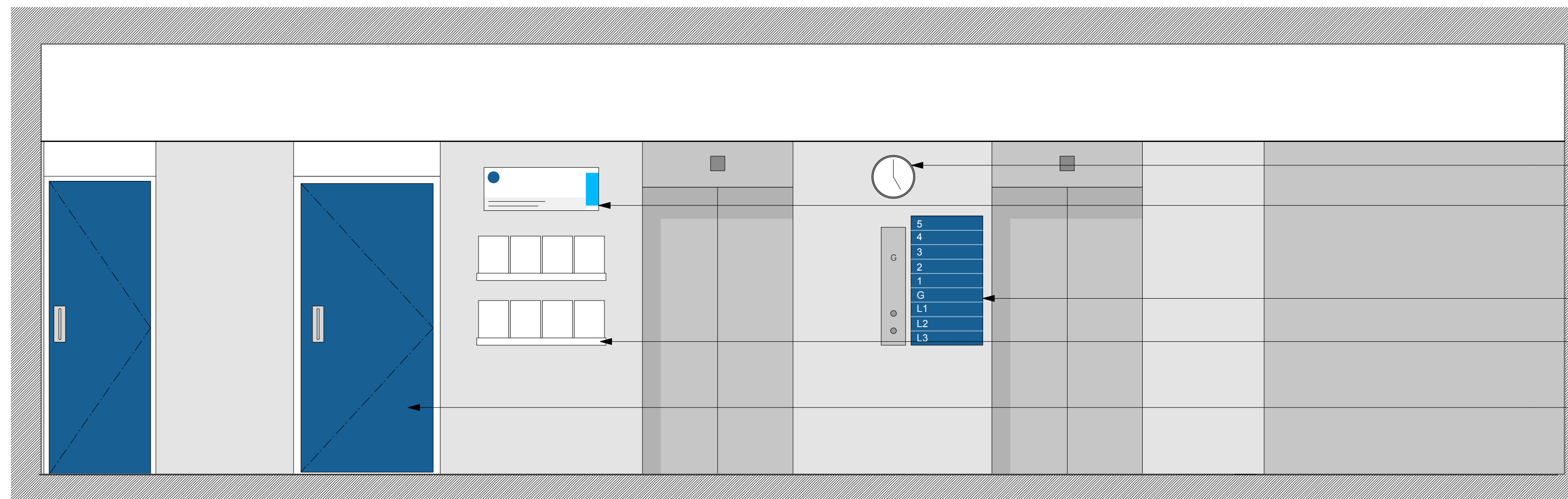

- Clock to be removed.
- All signage to be stripped out.
- Signage to be replaced. T.B.C
- Bookshelves to be removed.
- Doors to be repainted to match existing.

3 Gnd floor core existing elevation 3
1:25 @A1

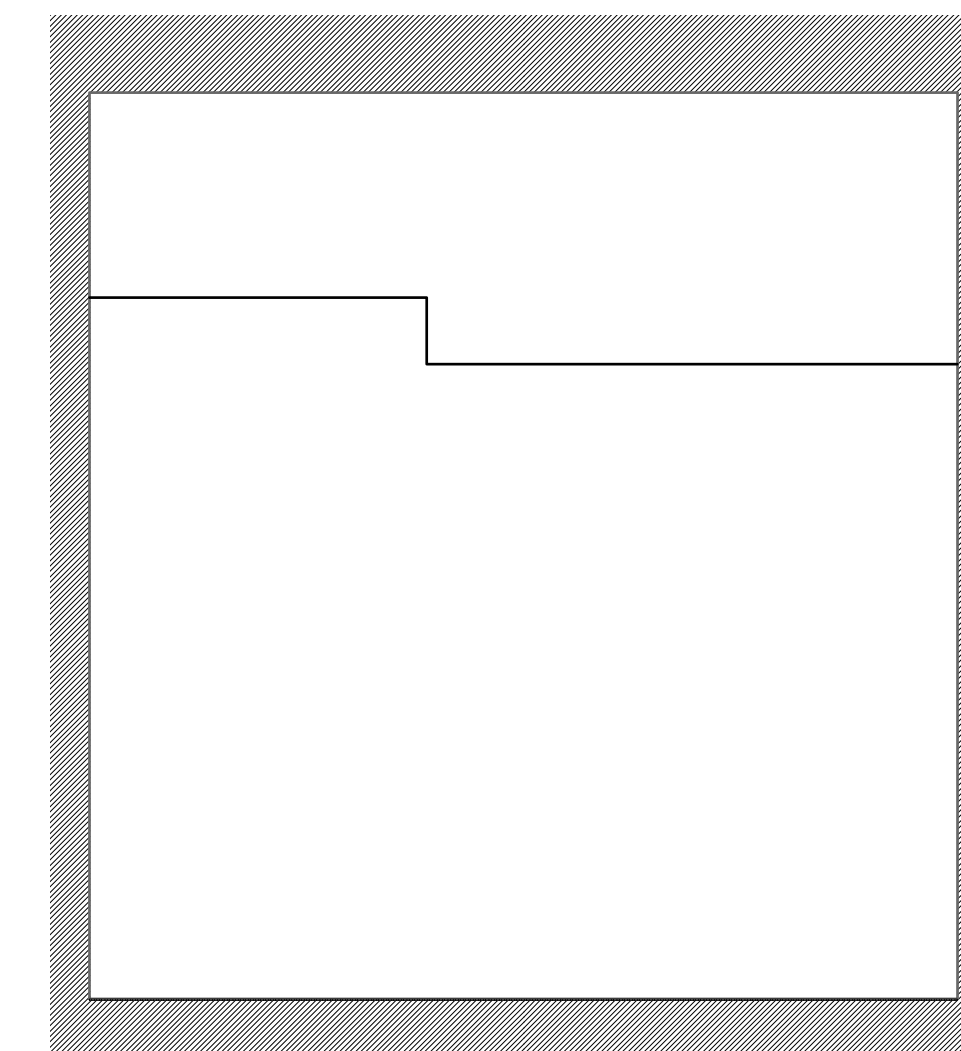

4 Gnd floor core existing elevation 4
1:25 @A1

Revision	Date	Amendment	Notes											Client	Project	Drawing	Scale	Date	Drawn	SK	Revision	Project N°	Drawing N°	Revision	Unit 0.01	First Floor
/	10.11.17	Planning Issue												University of London	IALS Refurbishment	Existing Ground Lobby Elevations	1:25 @ A1	October 2017			A	739	739/PL/160	A	California Building	© Southwark
A	22.11.17	Final Planning Issue												info@burwellarchitects.com	www.burwellarchitects.com										London SE13 7SF	West Exeter EX1 1JG
												NO DIMENSIONS ARE TO BE SCALED FROM THIS DRAWING. THE CONTRACTOR/MANUFACTURER IS RESPONSIBLE FOR CHECKING ALL DIMENSIONS AND QUERING ANY DISCREPANCIES. THIS DRAWING IS THE PROPERTY OF IDA ARCHITECTS LTD. COPYRIGHT IS RESERVED BY THEM AND THE DRAWING IS ISSUED ON CONDITION THAT IT IS NOT COPIED, REPRODUCED, RETAINED OR DISCLOSED TO ANY UNAUTHORISED PERSON, EITHER WHOLLY OR IN PART, WITHOUT WRITTEN CONSENT.		Burwell Deakins		+44 (0) 2083 056010		+44 (0) 1392 423981								