

KAY & CO made from steel letters individually laser cut powdercoated to match copper and applied to a 10mm opaque perspex with leds so halo illuminated fixed onto trods, the white perspex letters will be bonded onto the glass and the grey lettering below the main sign will be bonded on to rods, all internally illuminated.
The letters will need a cable from the frame for the illumination clear where possible
Main logo applied to stainless steel rails polished which the Kay & co will be fixed to and will carry the electrical feed.

New alu framework 50 x 100mm in powdercoated black finish

New double door to swing 180°; allow for stopper to external pavement. TBC

50mm upstand and top channel in brushed s/s

New projecting sign constructed from metal box all powdercoated to match blue / green RAL 7026 with copper steel letters powdercoated applied to 10mm perspex and applied to the sign.

Door handle refer to specification schedule

PROPOSED EXTERNAL ELEVATION
SCALE 1: 50

The Contractor to advise on all details and ensure stability and strength of construction. The Contractor to provide setting out and rod drawings for approval prior to construction.

The Contractor to check all dimensions on site and relate to these drawings. The Contractor to report any discrepancies to Designers to construction.

All services to Local Authorities, BCO and Environmental Health requirements and to Service Engineer's details.

All structure to Structural Engineer's details and Local Authority and BCO requirements.

All construction and materials to comply

Contractor shall comply with:
The CDM 2007 Regulations
Fire Precautions Act 1971 ;
Code of Practice for the Prevention of Fires on Construction sites and Buildings Undergoing Refurbishment (workplace) regulations 1997

Health & Safety at Work Regulations 1974
Code of Welfare conditions as outlined in the National Working Rule Agreement for the Building Industry and any Statutory Rules and Orders relating to the provision and maintenance of welfare and safety measures and amenities for all work people employed on site.

The workplace (Health , safety and welfare) Regulations 1992
The Construction (Health , safety and welfare) Regulations 1996

Rev E Signage amended 24/11/17

Rev D Possible ightbox positions
Rev C vinyl amended
REV B Signage fascia increased 1 additional projecting sign , and vinyl shown

FOR INFORMATION

THE FACES

amendments

client Kay & Co

project Unit 5, 6 St Pancras SQ

title Proposed Shopfront signage

scale 1: 50 @ A3

dwg by

date November 2017

dwg no **K&C-PS-04 1/2_{rev}** E

This drawing is the property of The Faces, copyright is reserved by them and the drawing is issued on the condition that it is not copied, reproduced, retained or disclosed to any unauthorised person, either wholly or in part without the consent in writing from The Faces

The Faces Design Ltd Studio 212 Third Floor ,
130 - 150 Hackney Road, London E2 7QS
email: info@thefaces.co.uk

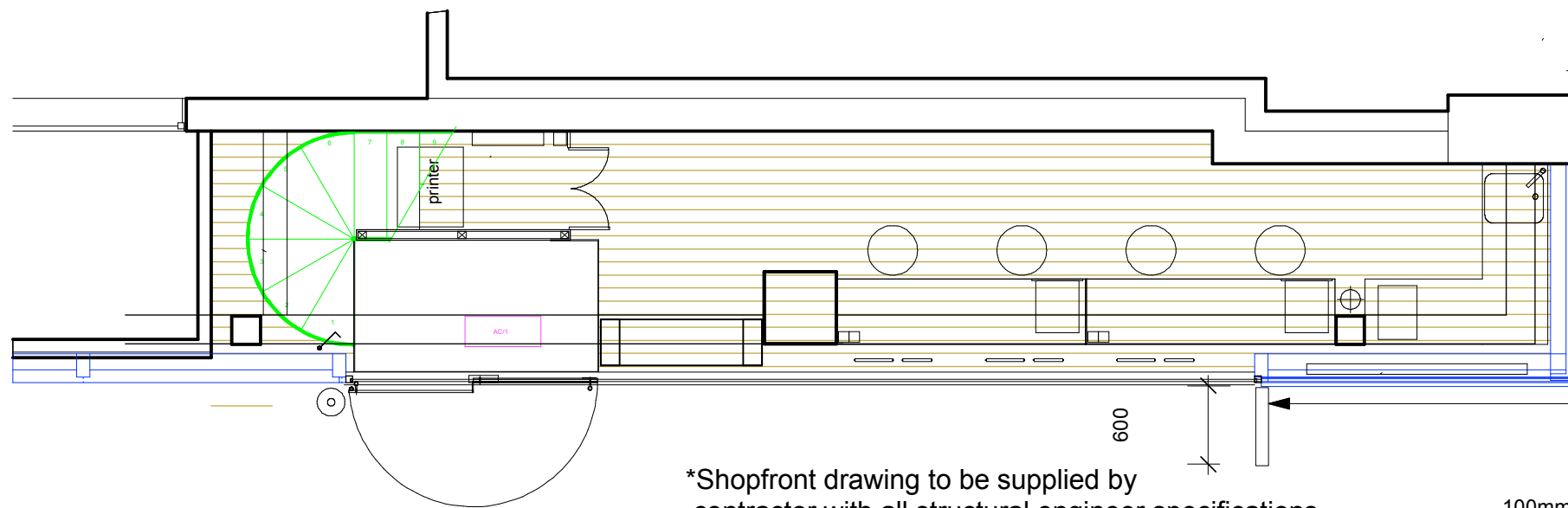

New projecting sign constructed from metal box all powdercoated to match blue / green RAL with copper steel letters powdercoated applied to 10mm perspex and applied to the sign.

New projecting sign constructed from metal box all powdercoated to match blue / green RAL with copper steel letters powdercoated applied to 10mm perspex and applied to the sign.

*Shopfront drawing to be supplied by contractor with all structural engineer specifications and loadings for Landlord approval. All approvals to be sent through E.Shield @Gardiner and Theobald

100mm 1m 3m 4m

SCALE

PROPOSED GROUND FLOOR PLAN
SCALE 1: 50