

**Notes**

These drawings have been prepared for the purpose of Building Notice submission only. Use of these drawings for any other purpose will be subjected to planning conditions, Rights of Covenants, of this and adjacent sites, detailed survey of ground or site conditions, design development, building regulations and statutory requirements or construction design and tolerances.

All dimensions and levels shown are to be verified on site. proposed layouts are subjected to amendment as a result of the reinforcement of existing floor, wall, roof structures by structural engineers.

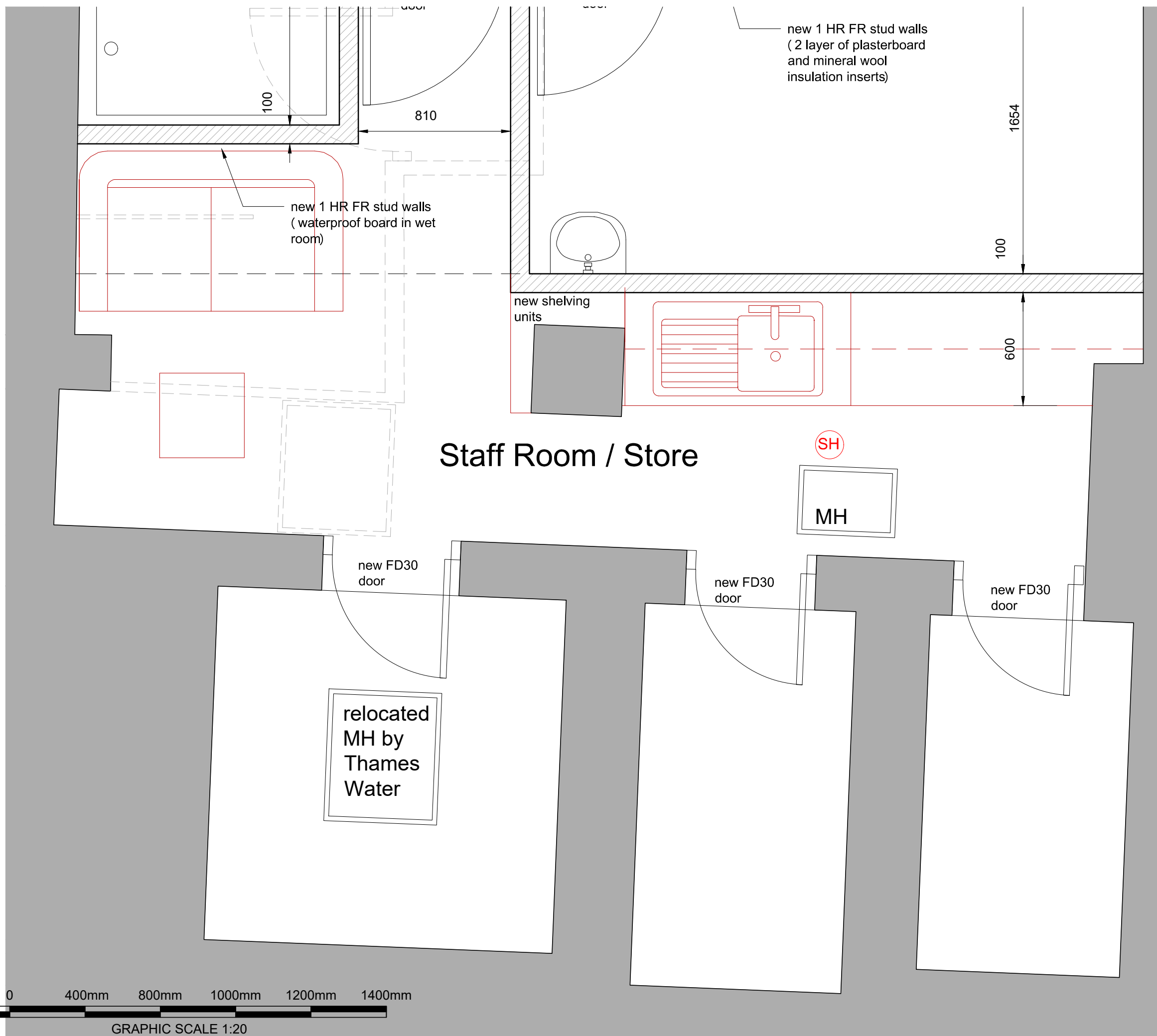

**Staff Room / Store**

SH

MH

relocated  
MH by  
Thames  
Water

Ver	Date	Comments	Drn	Chk	App

**JSHAN** ARCHITECTURAL PLANNING INTERIOR

JSHAN Architectural Services  
137 Uxendon Hill, Wembley, Middlesex HA9 9SH.  
M: 07940 118893  
E: jshan.architect@gmail.com

Approved By	Approved Date	Checked Date	Drawn By	Date Drawn
JSH	30/10/17	30/10/17	JH	20/10/17

Title  
**PROPOSED BASEMENT PLAN**

Scale	Status
1/20 @ A3	WIP

66\_WC1R-4NA\_BN002 Version 1.0