

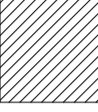

- All dimensions to be checked on site.
- All drawings to be read in conjunction with engineer's drawings. Any discrepancies between consultants drawings to be reported to the Architect before any work commences.
- The Contractor's attention is drawn to the Health & Safety matters identified in the Health & Safety plan and on drawings as being potentially hazardous. These items should not be considered as a full and final list.
- The Work Package Contractor's normal Health & Safety obligations still apply when undertaking constructional operations both on and off site.

cad file:

Key

-  SITE BOUNDARY
-  EXISTING WALLS
-  PROPOSED WALLS

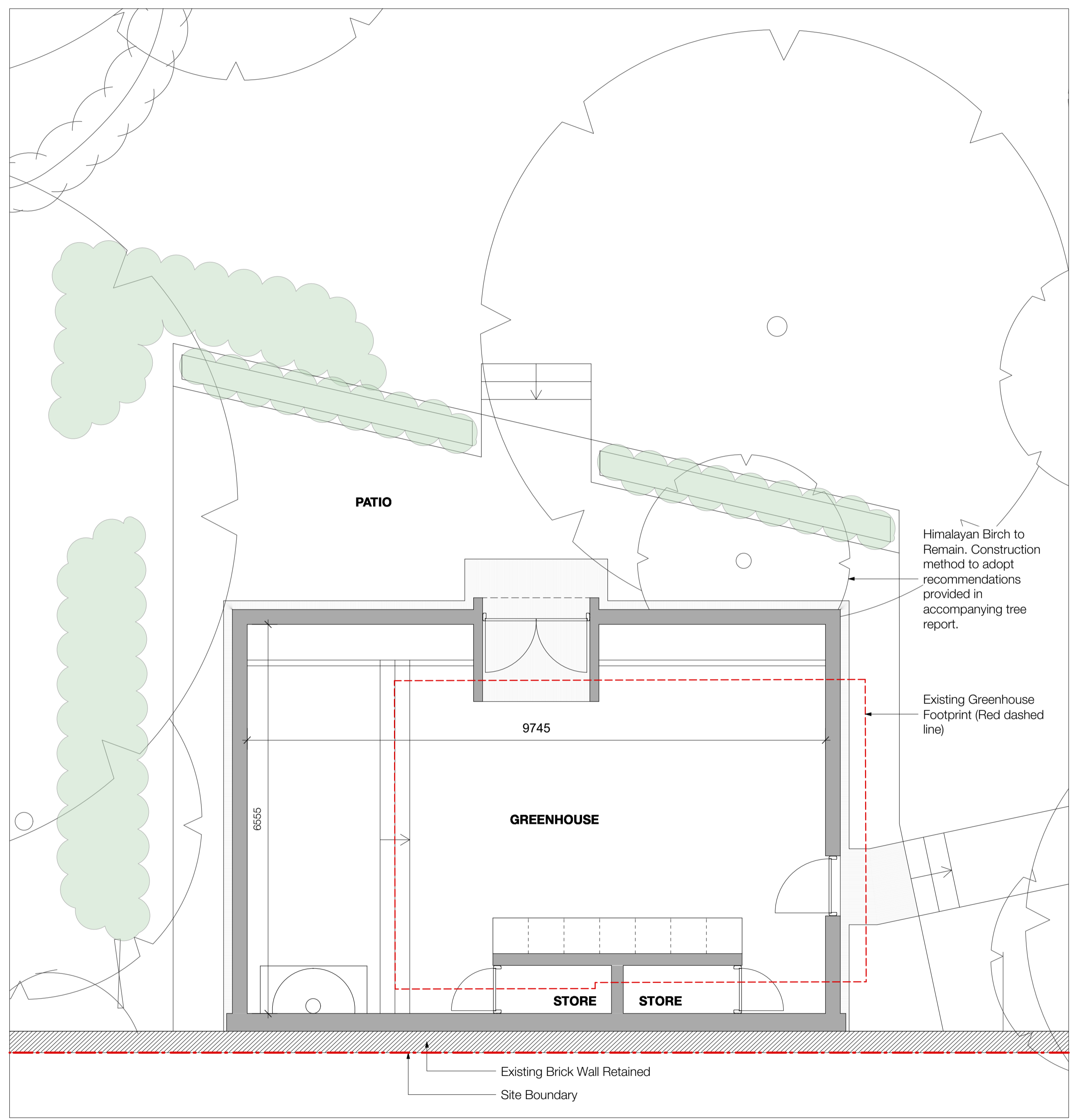

1 PROPOSED GROUND FLOOR PLAN

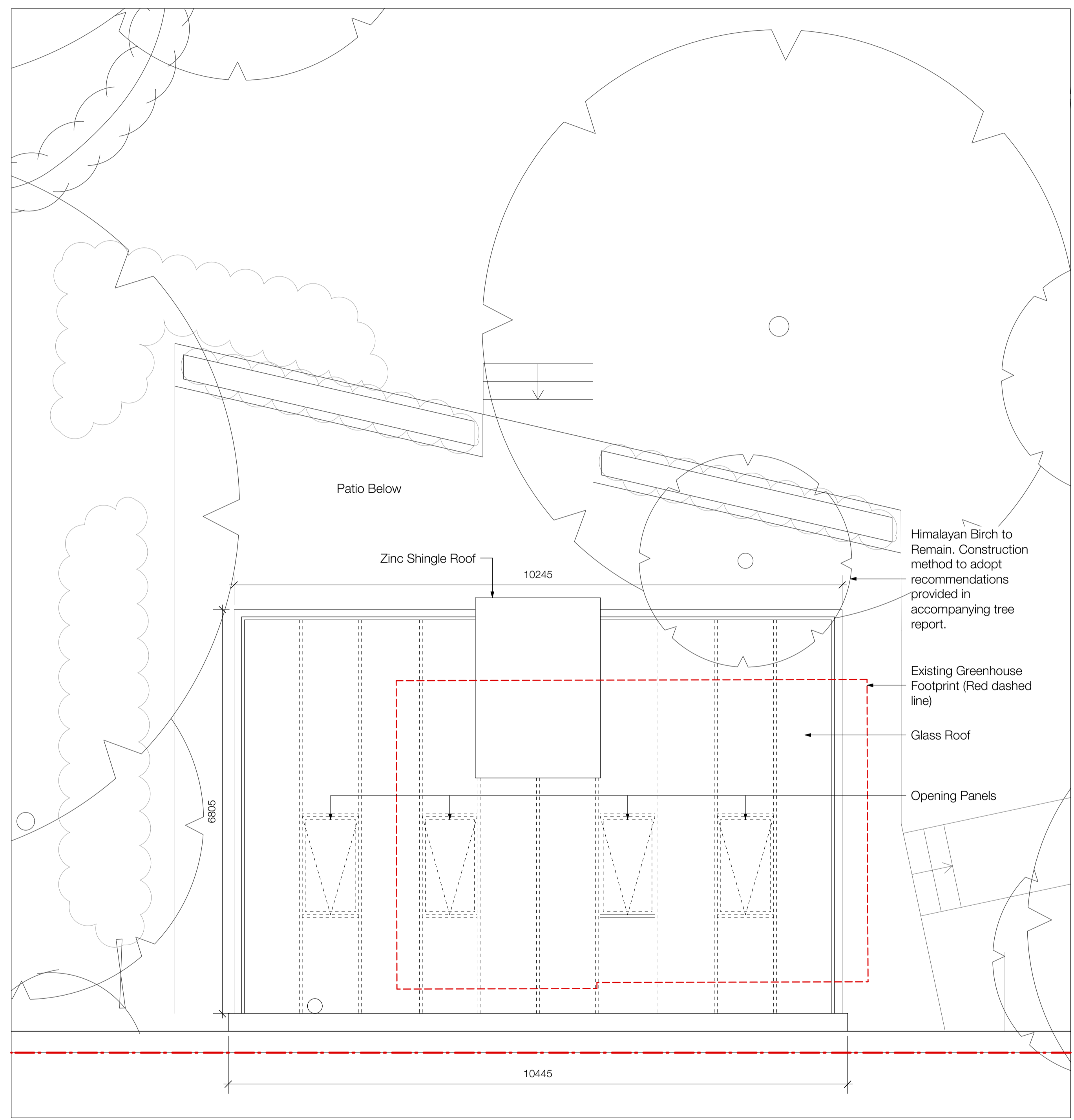

2 PROPOSED ROOF PLAN

rev	date	initials	description
F	08.11.17	DM	Planning Amendments
E	03.10.17	DM	Planning Issue
D	02.10.17	HK	Draft Planning Issue
C	31.08.17	HK	For Comment
B	24.08.17	CL	For Comment
A	23.08.17	DM	For Comment

drawing:  
**PROPOSED FLOOR PLANS**  
 project:  
**THE GROVE**  
 drawing no: **0252-250** revision: **F**  
 status:  
**PLANNING**  
 scale @ A1/A3: **1:50 / 1:100** date: **AUGUST 2017**

adam knibb architects  
 Adam Knibb Architects  
 The Daprin, 33 St. Thomas Street, Whitstable, G80 9JL  
 www.adamknibbarchitects.com  
 01622 660221

