

EXISTING SECTION AA

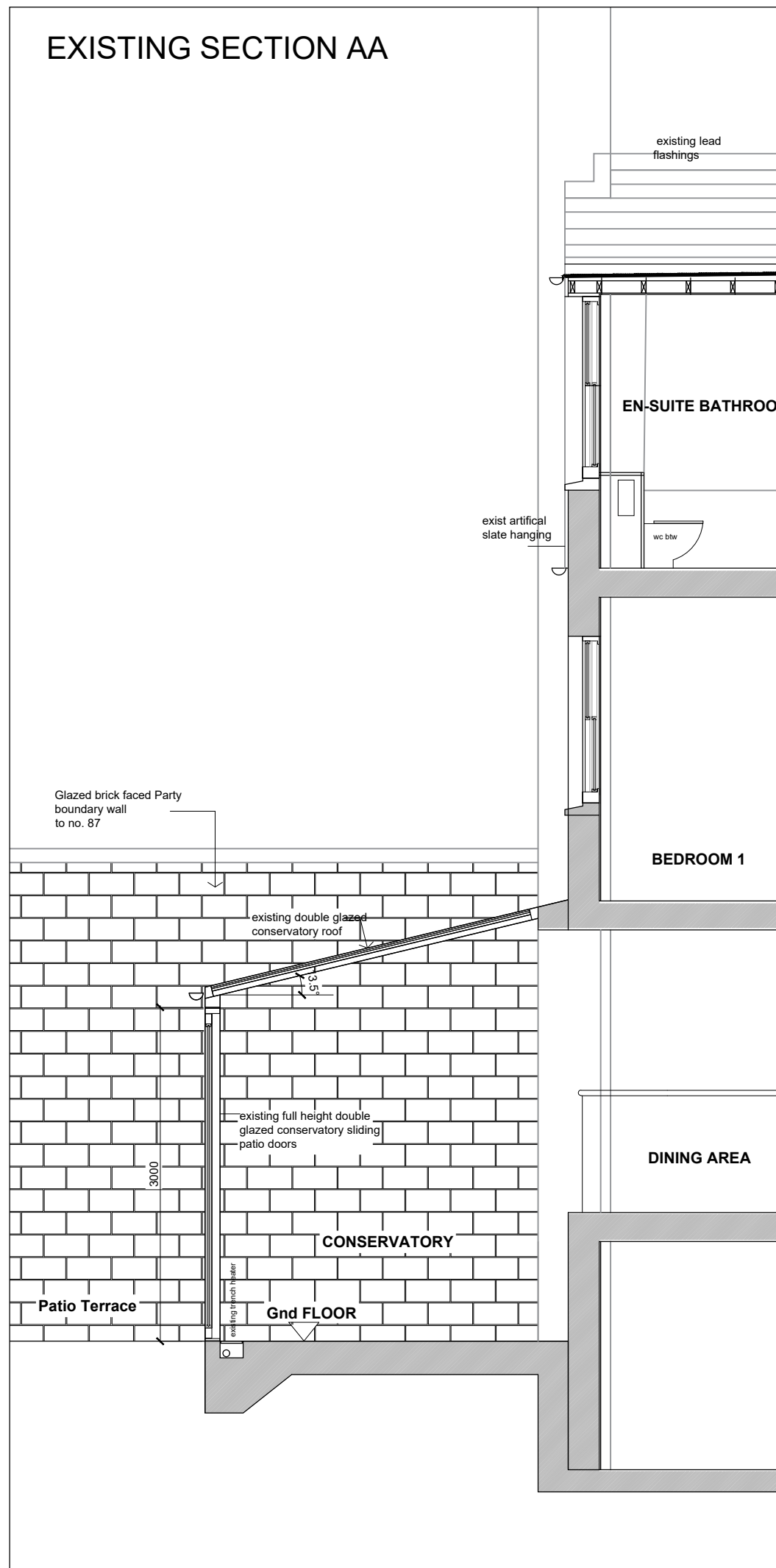

PROPOSED SECTION AA

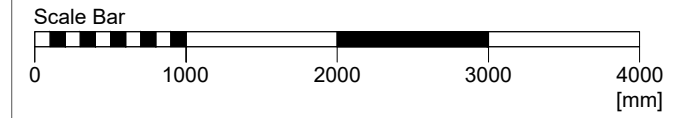
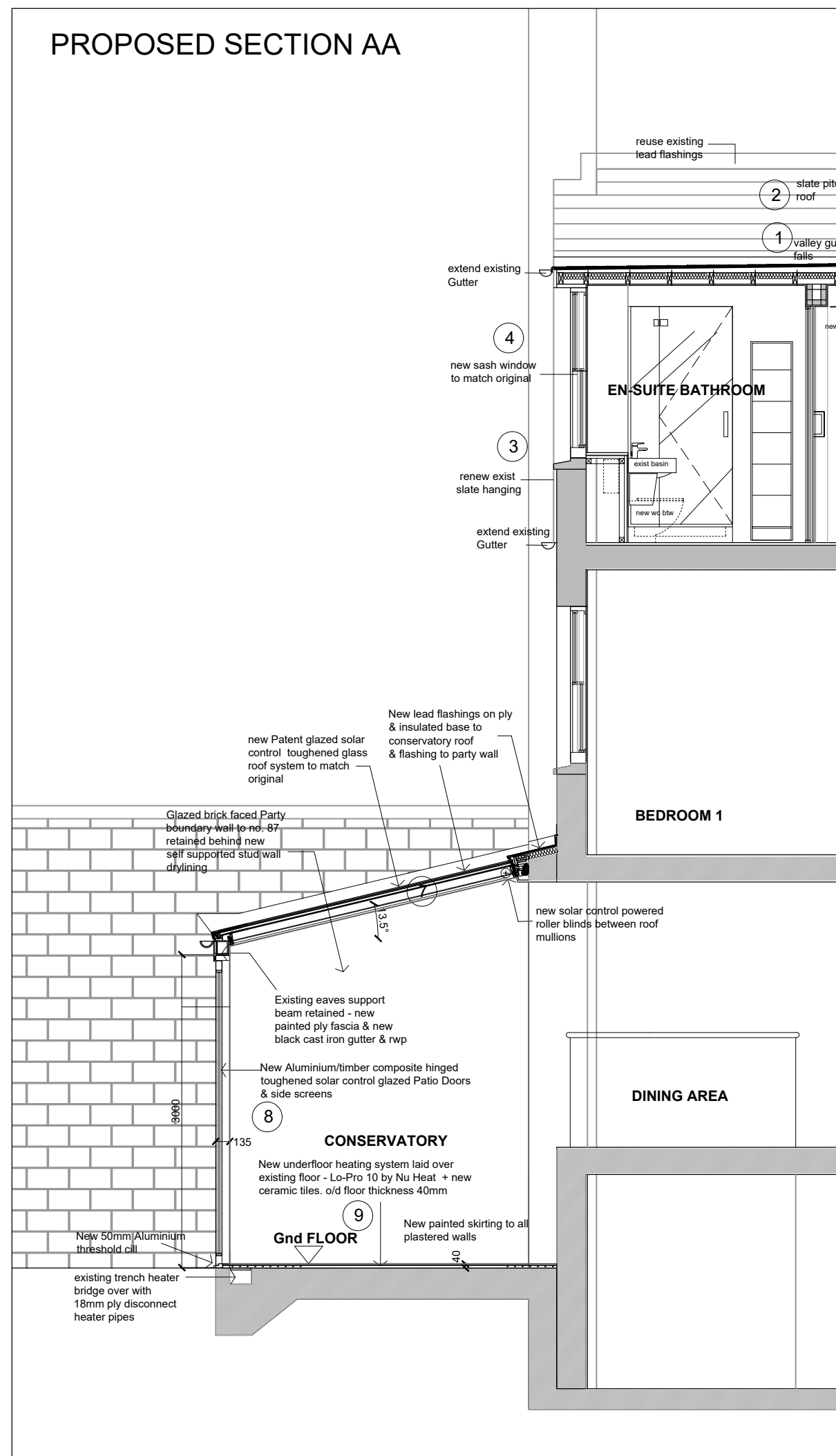

- 1 18mm ply gutter linings to valley & parapet laid to falls. Finish Icopal high performance 3 layer bitumen felt to all gutters with code 4 lead flashings to abutments.
- 2 Existing 22.5 deg main roof - existing concrete tiles removed & new/reclaimed natural slates laid on counterbattens on Tyvek breathable membrane 150mm Celotex insulation between & 50mm under existing rafters. New dark square grey conc. ridge tiles to hips.
- 3 Existing slate wall hanging to be replaced with new slate cladding on new tiling battens, quilt insulated & tyvek breathable membrane. S/Steel hook fixings each slate.
- 4 New timber traditional sash window complete including sash boxes & weights. Glazing bars & single glazing to match originals.
- 5 Acoustic wall lining - independent frame on party walls. 2 x soundblock & acoustic quilt on resilient bars to specialist performance spec.
- 6 Gutters, hoppers & down pipes - All in black Cast Iron.
- 7 Conservatory glass roof - New Patent Glazed system to match existing. U value 1.1 w/m2 degC Toughened solar control glass. New Lead verges & flashings to match existing.
- 8 New aluminium/timber composite framed glazed Patio Doors with 180 deg hinges & fixed side screens with toughened solar control glazing to replace existing sliding glazed doors. U value 1.1 w/m2 degC
- 9 Underfloor heating system applied over existing tiled floor. Nu-Heat LoPro10 system with new ceramic tiled floor laid - overall build-up 40mm max.

Do not scale from this drawing
All dimensions are to be checked on site
Any discrepancies are to be reported immediately to the Architect or Main Contractor

COPYRIGHT © 2014
ALL RIGHTS DESCRIBED IN THE CHAPTER IV OF THE COPYRIGHT DESIGN AND PATENTS ACT 1988, HAVE BEEN GENERALLY ASSERTED

Rev.	Date	Comment	By
P4	23.10.17	Reissued for Listed Building Application	FB
P3	20.10.17	Revised notes for Listed Building Application as Planning officer comments	FB
P2	18.08.17	Rear Conservatory Glazing spec added	FB
P1	10.07.17	Rear Conservatory Glazing replaced. Listed Building Planning submission	FB

Client
Hillary Bauer
85 Arlington Road
London NW1 7ES

Project
Repairs to 85 Arlington Road
London NW1 7ES

Drawing
Building Section AA
General Arrangement
Existing & Proposed

Project No. Drawing No. Issue Status
HB2016 SK009 P4 1

Scale Date Drawn By Checked By
1:50@A3 April 2017 FB FB

FRANCIS BIRCH ARCHITECT

Francis Birch Dipl Arch (Oxford) RIBA Architect
11 North Hill Avenue, Highgate, London N6 4RJ
T: 0208 342 8602
M: 07432 553861
E: f.birch123@gmail.com