

UTILITIES & UNDERGROUND INVESTIGATIONS

ABBREVIATIONS & SYMBOLS

1D 5C	1 Duct 5 Cables	CPC	Circ Plastic Chamber	EOT	End Of Trace
Ø	Diameter	CrL	Crown Level	IBD	Internal Backdrop
AR	Assumed Route	DCr	Depth To Crown	IL	Invert Level
BL	Base Level	DI	Depth To Invert	RBC	Rectangular Brick Chamber
CB	Concrete Benching	DS	Depth To Silt	RCC	Rectangular Conc Chamber
CBC	Circular Brick Chamber	DTB	Depth To Base	SL	Silt Level
CCC	Circular Conc Chamber	DTW	Depth To Water	TFR	Taken From Records
CL	Cover Level	EDB	External Backdrop	UTC	Unable To CCTV
				UTL	Unable To Lift
				UTT	Unable To Trace
				WL	Water Level

	BT CABLE(S)		UTILITIES COMMENT BOX
	OVERHEAD BT CABLE(S)		DEPTH TO SERVICE
	COMMUNICATIONS CABLE(S)		
	CABLE TV CABLE(S)		
	ELECTRIC CABLE(S)		
	OVERHEAD ELECTRIC CABLE(S)		
	FIBROPTIC CABLE(S)		
	GAS MAIN		
	GAS SERVICE		
	GROUND PENETRATING RADAR (GPR) TRACE		
	HOT WATER PIPE		
	LIGHTING CIRCUIT		
	SECURITY CABLING		
	UNIDENTIFIED TRACE		
	WATER MAIN		
	WATER SERVICE		
	COMBINED SEWER		
	FOUL SEWER		
	RIISING MAIN		
	SURFACE WATER SEWER		
	UTILITIES INVESTIGATION EXTENTS		

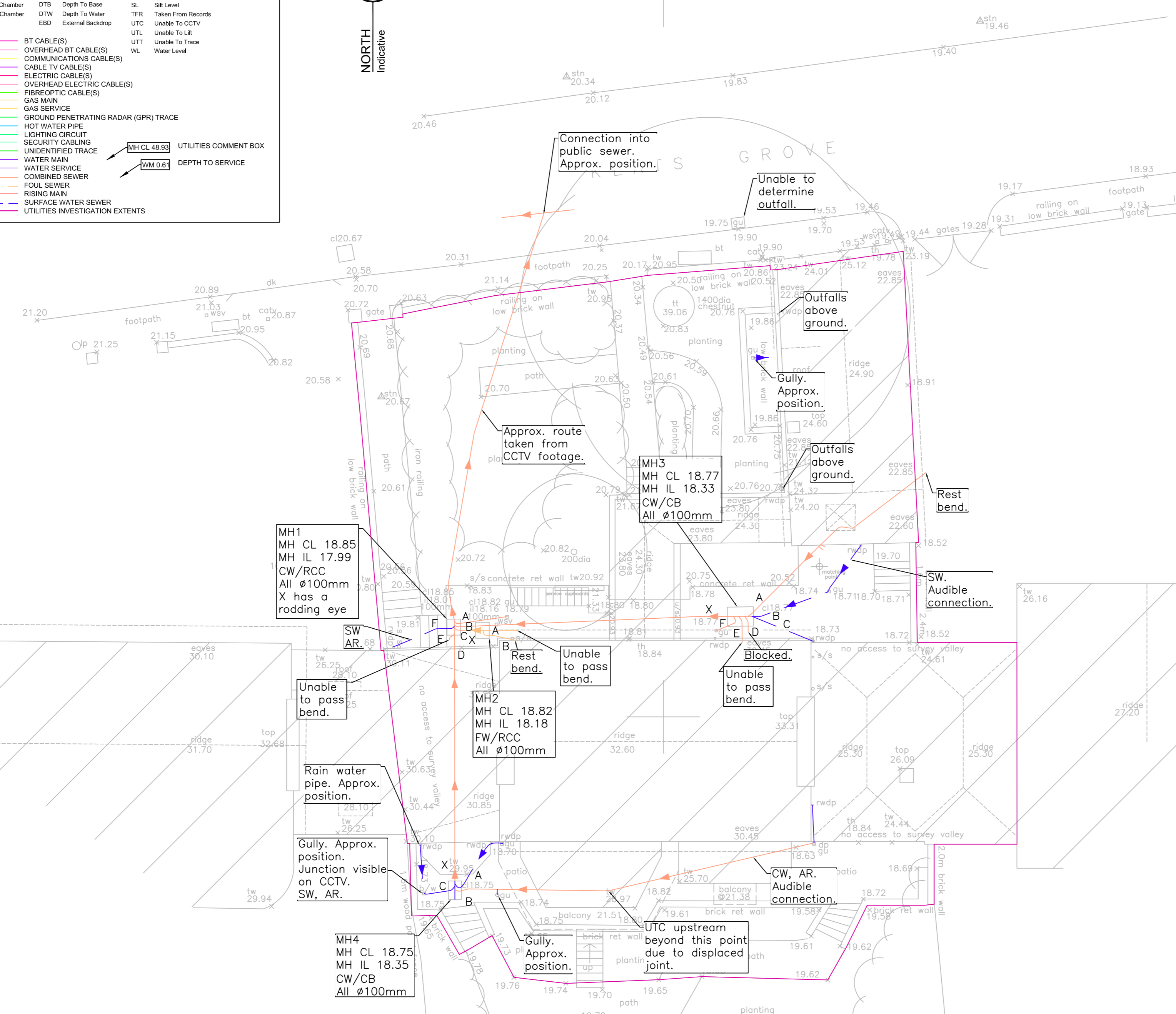
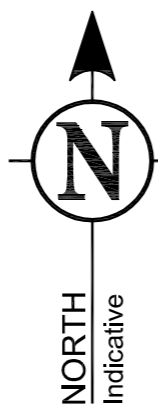

UTILITIES & UNDERGROUND INVESTIGATIONS

DRAWING NOTES

All below ground details shown have been identified from above ground without excavation. Survey Solution use electro-magnetic and/or ground penetrating radar (GPR) methods to investigate for underground utilities, services and features. Results using these methods are not infallible and we recommend trial excavations are carried out to confirm any identifications, positions and depths.

Any areas on the drawing where services or features have not been shown are not necessarily clear of services or features but are an indication that no items have been identified during our investigations. All reasonable care and normal good practice should still be employed during design and construction processes.

Certain types of services such as plastic or concrete pipes, some conduit and ducting where direct access can not be achieved for tracing may not be shown and alternative locating methods should be used.

Survey Solutions has used all reasonable care to research available service records but the completeness or use of the service records supplied to or by Survey Solutions cannot be guaranteed. Therefore Survey Solutions cannot be held responsible for any features annotated as 'taken from records' (TFR).

Depths obtained using electro-magnetic or GPR are effected by ground conditions and should be treated as indicative only. Electro-magnetic depths to utilities and services are generally taken to the centre of a feature, GPR depths to the top of a feature and drainage depth shown to inverts, unless otherwise indicated.

Drainage pipe sizes will be obtained without entering the camber and therefore should be treated as approximate. Pipe dimensions which have not been obtained visually will be taken from records when available.

All services, drainage and utilities routes are assumed straight between access points, unless otherwise stated. The numbers of cables in runs will not be shown unless specifically requested. All services are below ground unless indicated.

Services, utilities and features may not have been surveyed if obstructed or not reasonably visible or accessible at the time of survey.

Survey Solutions accept no responsibility for the completeness or accuracy of either the topographical survey or base mapping on this project.

All critical dimensions and measurements should be checked and verified with any errors or discrepancies notified to Survey Solutions immediately. The accuracy of the digital data is the same as the plotting scale implies. All dimensions are in metres unless otherwise stated.

The contractor must check and verify all site and building dimensions, levels, utilities and drainage details and connections prior to commencing work.

© Land Survey Solutions Limited hold the copyright to all the information contained within this document and their written consent must be obtained before copying or using the data other than for the purpose it was originally supplied.

Do not scale from this drawing.

AVAILABILITY OF UTILITY RECORD DRAWINGS

UTILITY	AVAILABILITY	UTILITY	AVAILABILITY	UTILITY	AVAILABILITY
SEWER	NO	BT	N/A	OIL PIPES	N/A
WATER MAIN	N/A	CABLE TV	N/A	OTHERS	N/A
GAS MAIN	N/A	ELECTRICITY	N/A		

A	CCTV DRAINAGE INFORMATION ADDED	SRA	GSB	05/07/2016
REV	DESCRIPTION	DRAWN	APPR	DATE

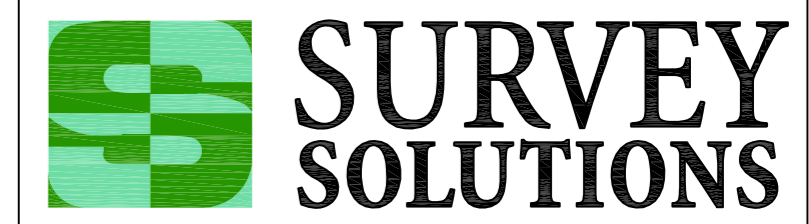

Ipswich Coventry Yeovil Norwich Perth Nottingham Brentwood

Tel No: 0845 0405 969 Fax No: 0845 0405 970
www.survey-solutions.co.uk enquiries@survey-solutions.co.uk

LAND SURVEYING BUILDING SURVEYING UNDERGROUND SURVEYING

PROJECT TITLE
4 KEATS GROVE
LONDON NW3 2RS

DRAWING DETAIL
CCTV DRAINAGE INVESTIGATION.
Sheet 1 of 1

CLIENT
RICHARD JACKSON LTD

SCALE
1:100

SURVEYOR	SURVEY DATE	CHECKED BY	APPROVED BY	DWG STATUS
SRA	06/05/2016	GSB	GSB	FINAL

DRAWING NUMBER	REVISION	ISSUE DATE
17723UG-01	A	MAY 2016