

Existing Weighted Box Sash Window

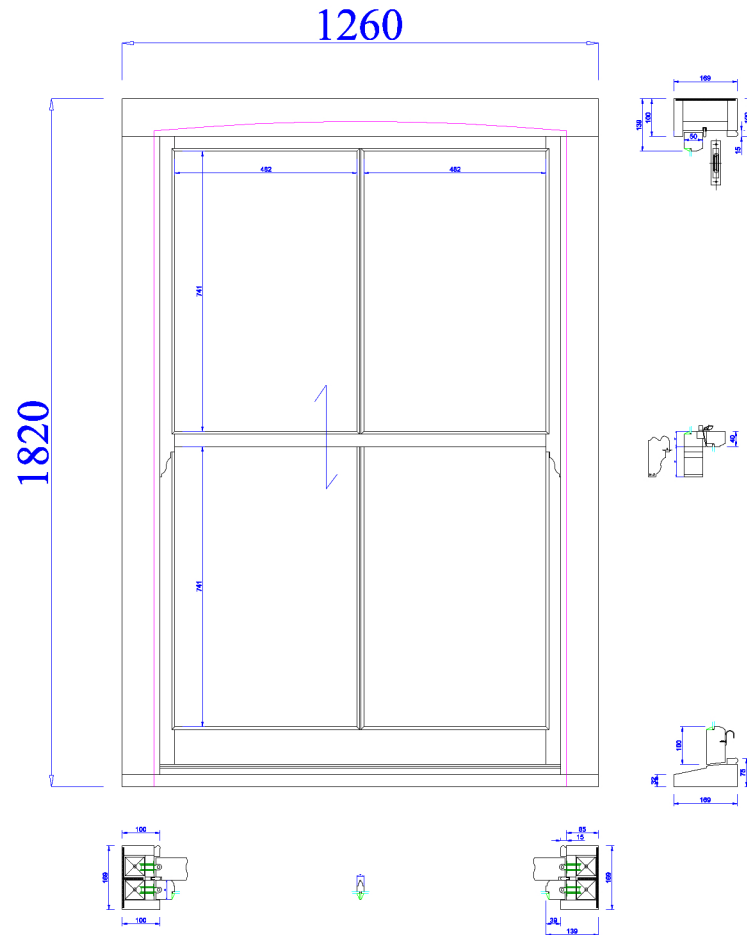

Proposed Sliding Sash

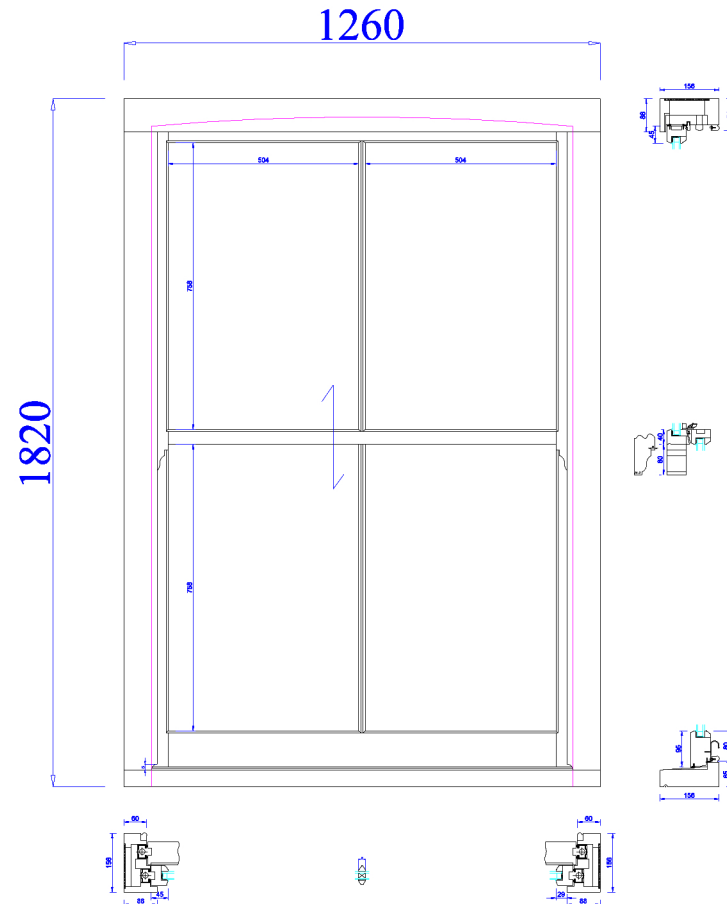

Timber	Engineered Pine
Paint colour	RAL 9016 (White)
Finish	Full 3 coat factory finish
Ironmongery finish	Satin Chrome 2 x Lockable Fitch Fastener 2 x Pressed Hook Sash Lift
Vent in head	TITON XS13
Horns Type	As per drawing
Glass spec:	
top sash:	4-14A/TGI-4 Low E
bottom sash:	4Tgh-12A/TGI-33.1 Low E
Opening restrictor (small)	100 mm
Operation	Sliding Sash

client	Keepmoat	
project	Malden Road	
drawing	Sliding Sash Window	
scale	drawn	date
1:20	P.Z	09.11.2017
drawing number	revision	
FL-535-001	B1	

Scale 1:20 @ A4

