

GLENLOCH ROAD

24

18

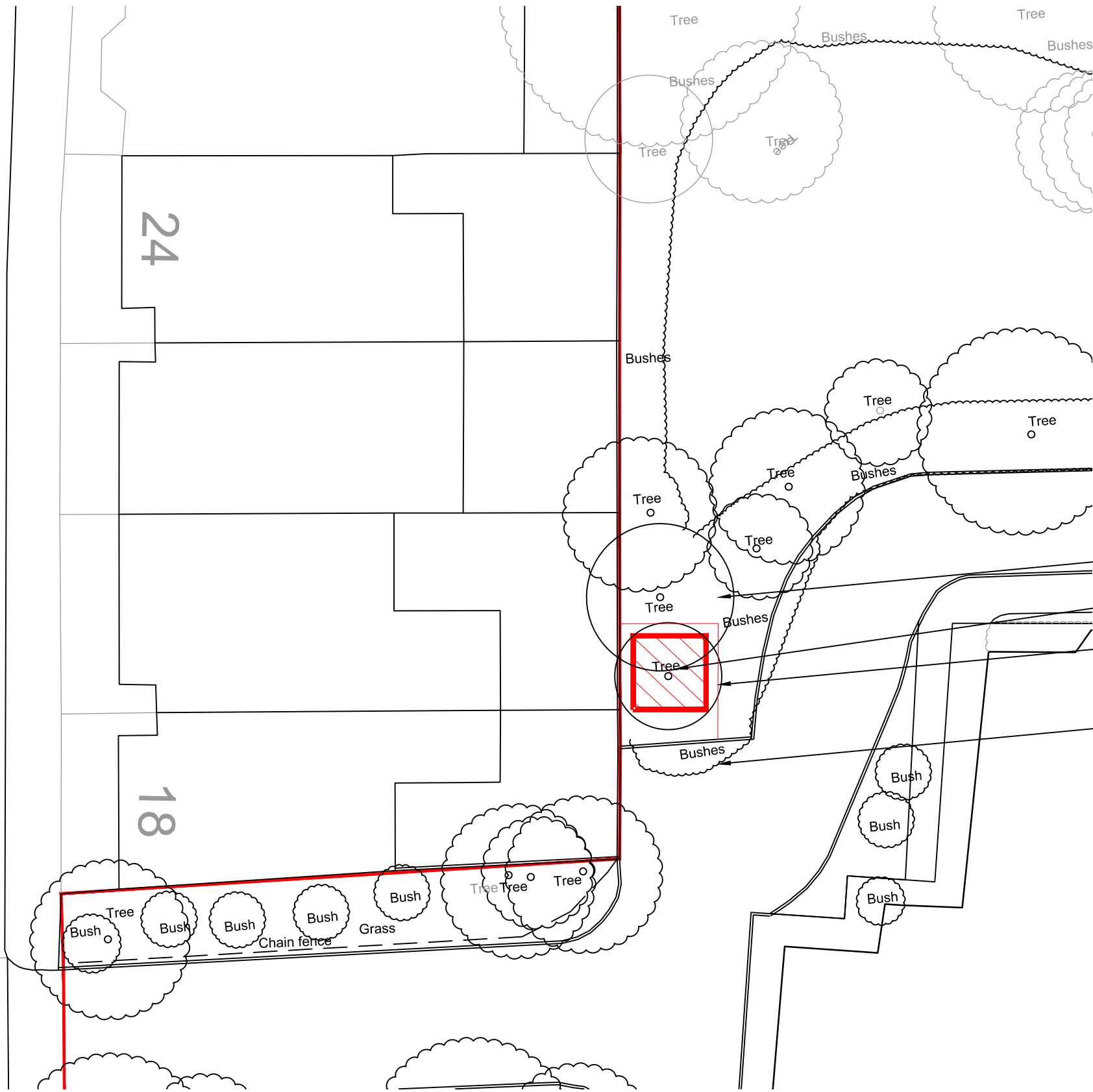

- Tree to be removed
- Tree to be removed
- Location of Proposed Substation
- Remove Bushes as required

SITE PLAN
1:200@A3

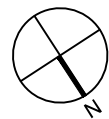

50mm on original sheet

revisions				
no.	description	date	initial	check initial
1	FIRST ISSUE	04/10/17	PB	PB

OS LOCATION PLAN
Scale 1:2500

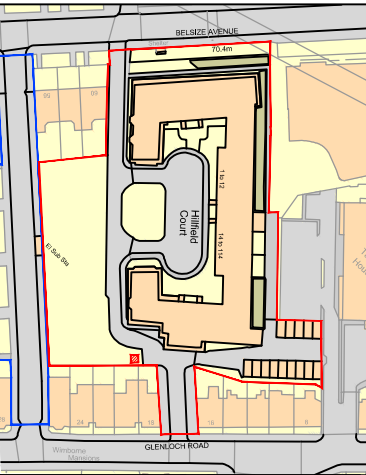

notes

DO NOT SCALE FROM THIS DRAWING*
DRAWING SUBJECT TO COPYRIGHT ACT

BLOX
ARCHITECTS

Peter Bloxham Architect RIBA
19 Crows Road
Epping
Essex, CM16 5DE
Telephone 01992 610 819
Email : peter@bloxarchitects.co.uk

client
Kinleigh Folkard & Hayward

project
NEW UKPN SUBSTATION
PLANNING CONSENT

drawing
1-114 Belsize Avenue / London NW3 4BG
SITE PLAN
AS EXISTING

scales		date drawn		drawn by	
1:200 @ A3		20/10/17		PB	
1 check date	checked by	2 check date	checked by		
20/10/17	PB	.	.		

drawing no.	revision
1014_HFC_AL-0-002	.