

Copyright: All rights reserved. This drawing must not be reproduced without permission.

Only the original drawing should be relied upon. Contractors, subcontractors and suppliers must verify all dimensions on site before commencing any work or making any shop drawings.

All shop drawings to be submitted to the architect for comment prior to fabrication.

This drawing is to be read in conjunction with the Architect's specification, bills of quantities / schedules, structural, mechanical & electrical drawings and all discrepancies are to be reported to the architect.

Do not scale from this drawing. Dimensions are in millimetres unless otherwise stated.

revision / date / amendments
- / - / -

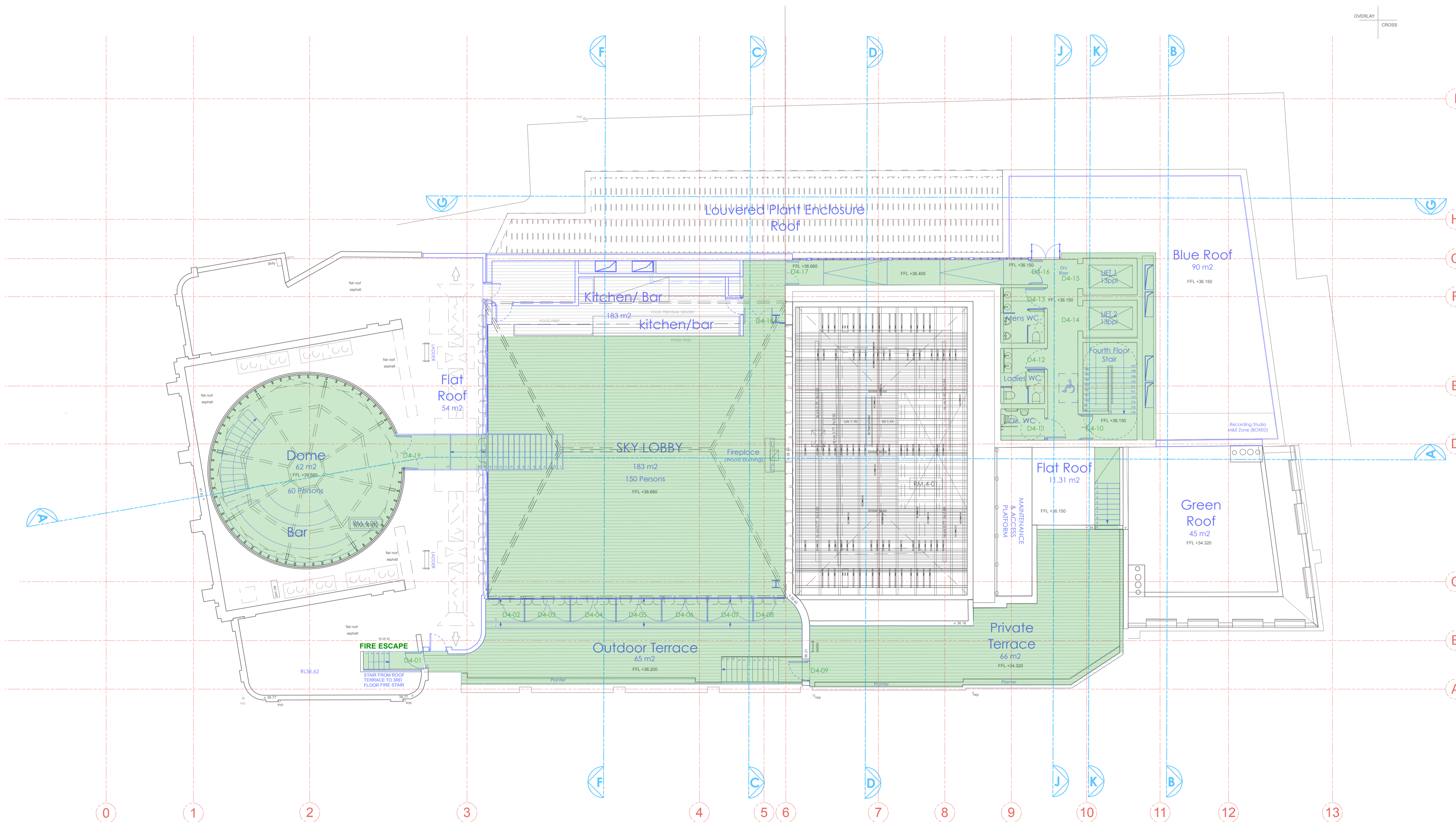

LEGEND

- Management Area - Staff
- Management Area - Koko Users
- Management Area - Private Members
- Management Area - Public Users
- Management Area - Artists

18.10.17

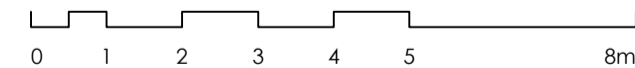
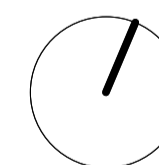

PLANNING

Archer Humphryes Architects

Basement
Central House
142 Central Street
London, United Kingdom
EC1V 8AR
T: +44 (0) 20 7251 8555

project title		KOKO + Hope & Anchor + Bayham Place Camden, London	
drawing title	scale	date	
Proposed Fourth Floor Plan Management - Private Members	1:100 @ A1	18.10.17	
drawing number	drawn / checked	FR/PC	DA
AHA/KKG/GA/016C	revision		

Spatial Extent Available to Hope and Anchor Customers

Copyright: All rights reserved. This drawing must not be reproduced without permission.

Only the original drawing should be relied upon. Contractors, subcontractors and suppliers must verify all dimensions on site before commencing any work or making any shop drawings.

All shop drawings to be submitted to the architect for comment prior to fabrication.

This drawing is to be read in conjunction with the Architect's specification, bills of quantities / schedules, structural, mechanical & electrical drawings and all discrepancies are to be reported to the architect.

Do not scale from this drawing. Dimensions are in millimetres unless otherwise stated.

revision / date / amendments
- / - / -

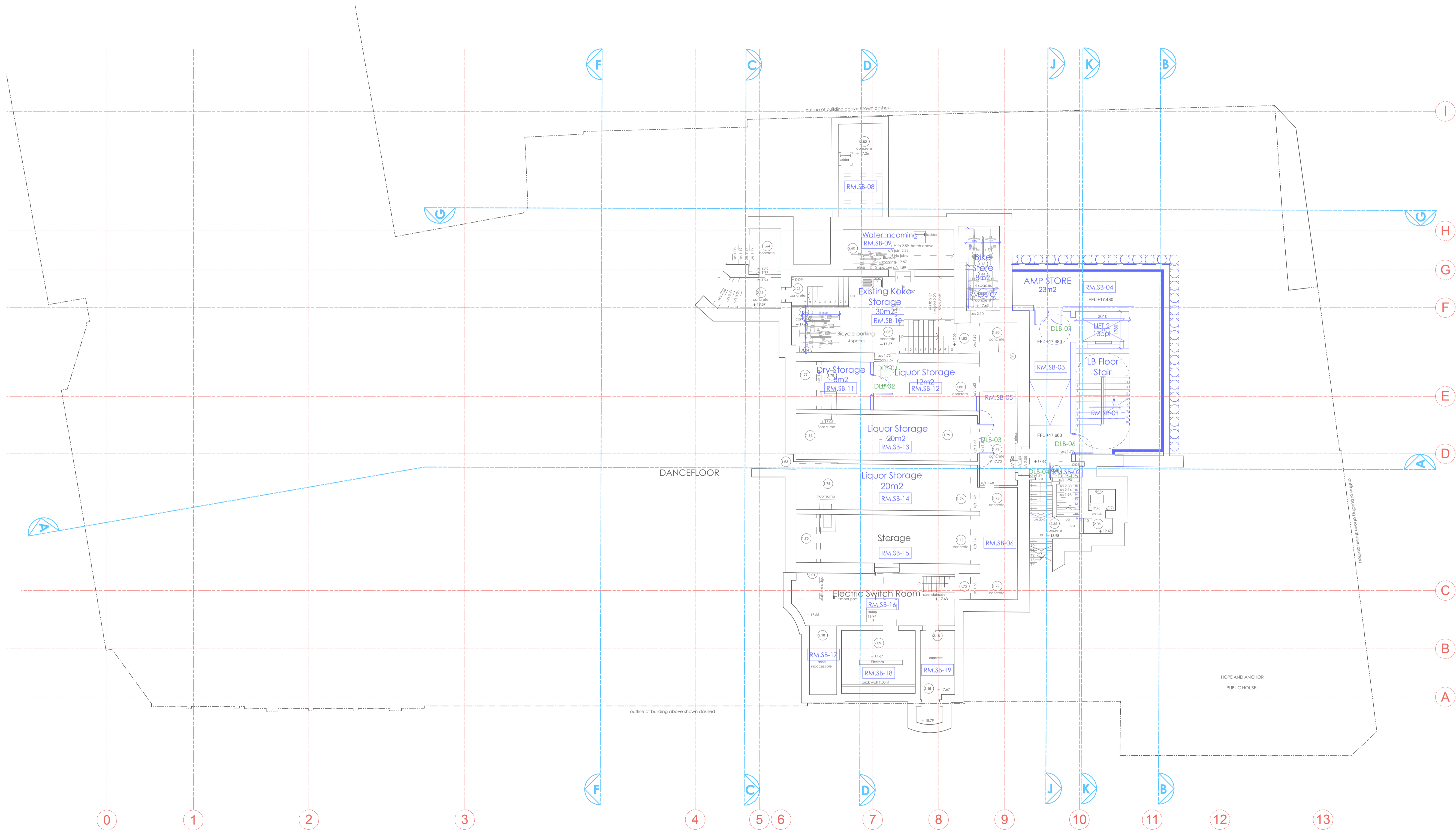

LEGEND

- Management Area - Staff
- Management Area - Koko Users
- Management Area - Private Members
- Management Area - Public Users
- Management Area - Artists

18.10.17

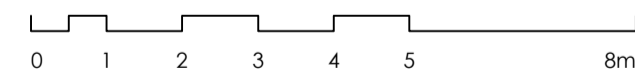
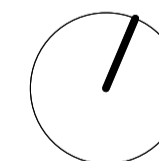

PLANNING

Archer Humphries Architects

Basement
Central House
142 Central Street
London, United Kingdom
EC1V 8AR
T: +44 (0) 20 7251 8555

NO ACCESS TO PUBLIC USERS

project title	KOKO + Hope & Anchor + Bayham Place Camden, London		
drawing title	scale	date	
Proposed Sub Basement Plan Management - Public Areas	1:100 @ A1	18.10.17	
drawing number	drawn / checked	FR/PC	DA
AHA/KKG/GA/010D	revision		

revision / date / amendments
- / - / -

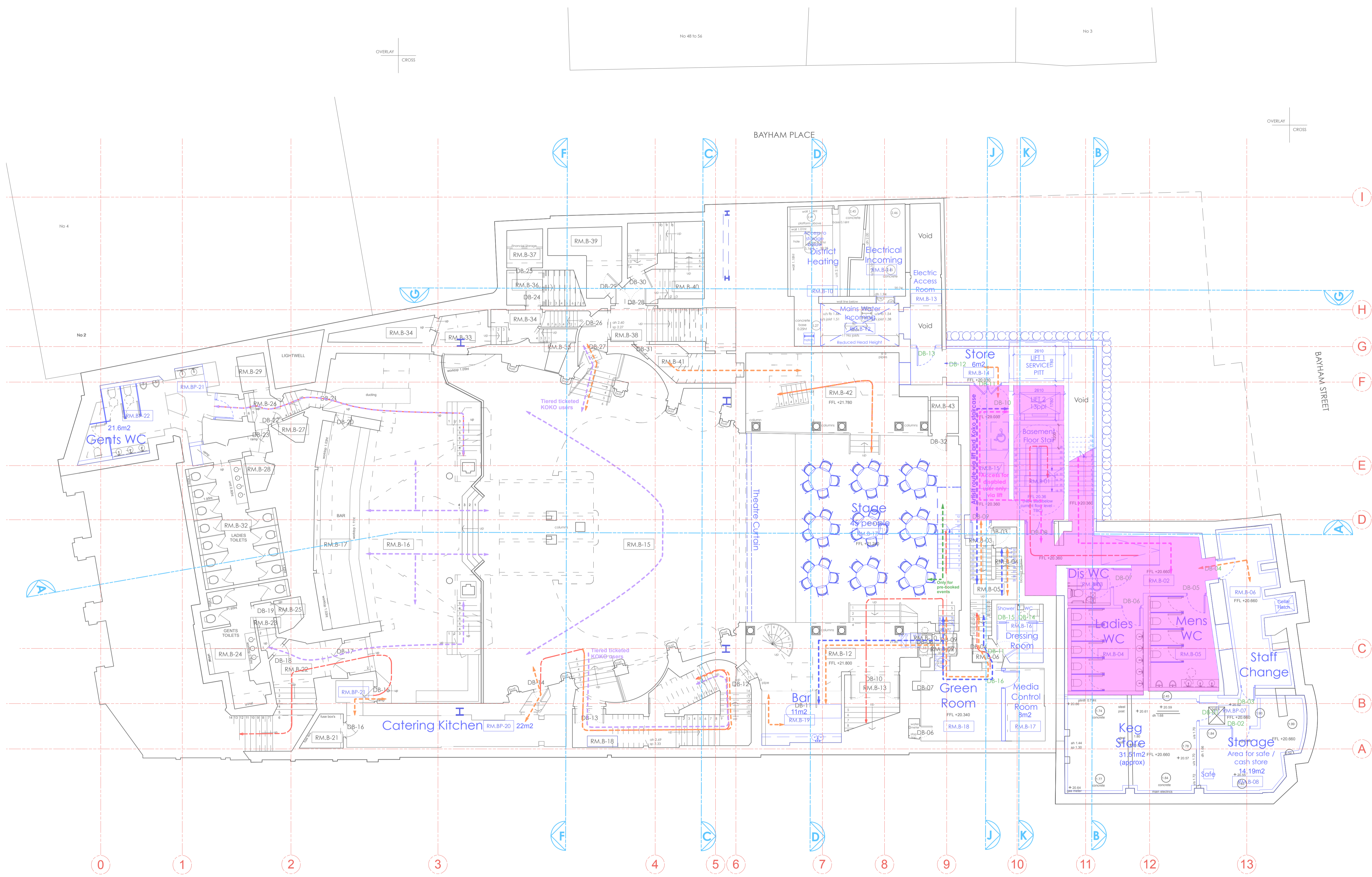

LEGEND

- Management Area - Staff
- Management Area - Koko Users
- Management Area - Private Members
- Management Area - Public Users
- Management Area - Artists

19.10.17

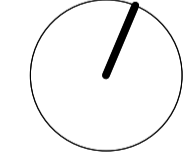

PLANNING

Archer Humphryes Architects

Basement
Central House
142 Central Street
London, United Kingdom
EC1V 8AR
T: +44 (0) 20 7251 8555

project title		KOKO + Hope & Anchor + Bayham Place Camden, London	
drawing title	scale	date	
Proposed Basement Plan Management - Public Users	1:100 @ A1	18.10.17	
drawing number	drawn	checked	revision
AHA/KKG/GA/011D	FR/PC	DA	-

revision / date / amendments
- / - / -

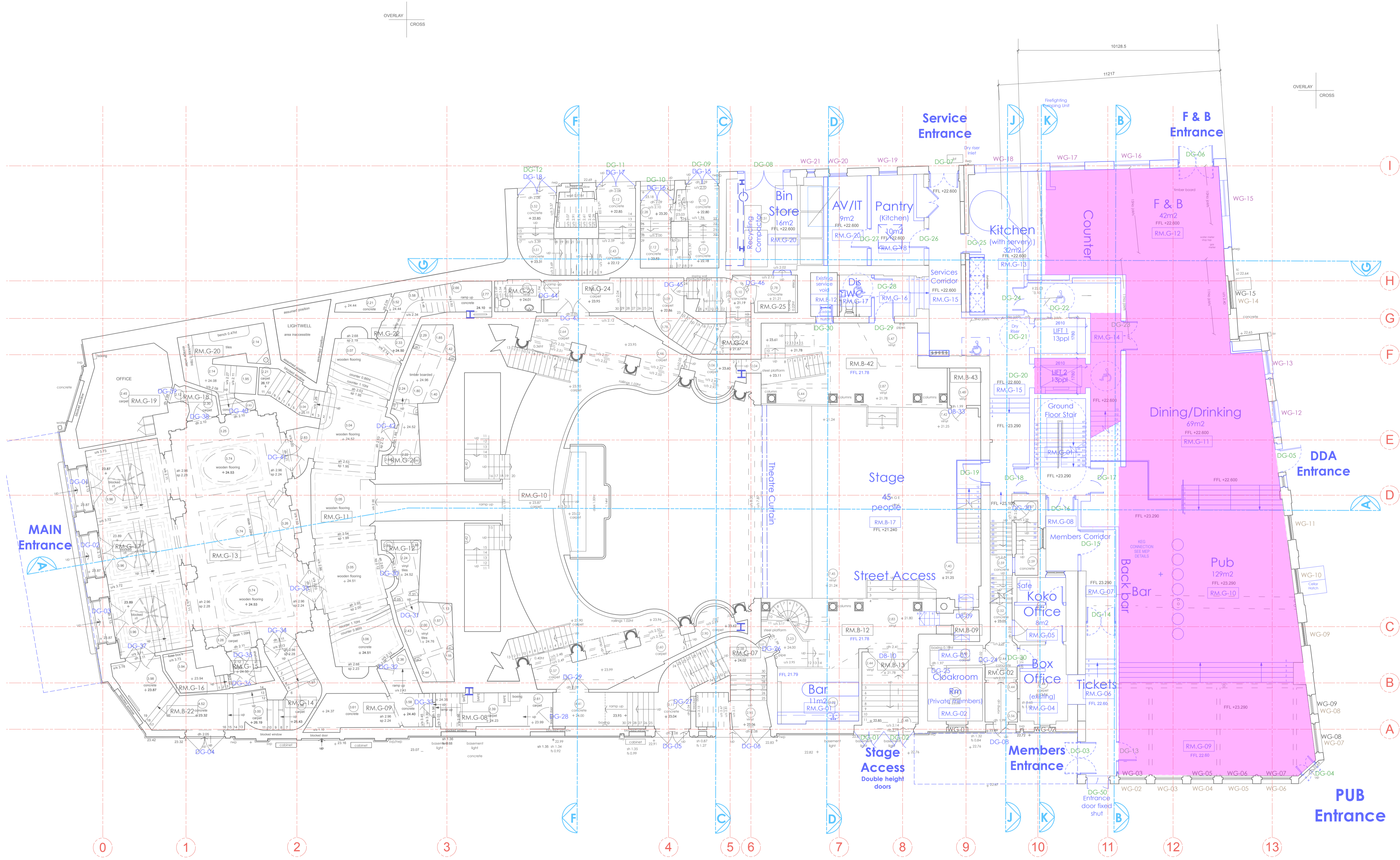

LEGEND

- Management Area - Staff
- Management Area - Koko Users
- Management Area - Private Members
- Management Area - Public Users
- Management Area - Artists

18.10.17

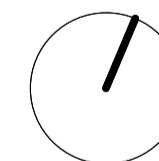

0 1 2 3 4 5 6m

PLANNING

Archer Humphryes Architects

Basement
 Central House
 142 Central Street
 London, United Kingdom
 EC1V 8AR
 T: +44 (0) 20 7251 8555

project title		KOKO + Hope & Anchor + Bayham Place Camden, London	
drawing title	scale	date	
Proposed Ground Floor Plan Management - Public Users	1:100 A1	18.10.17	
drawing number	drawn / checked	FR/PC	DA
AHA/KKG/GA/012D	revision		

OVERLAY CROSS

OVERLAY CROSS

OVERLAY CROSS

Copyright: All rights reserved. This drawing must not be reproduced without permission.
 Only the original drawing should be relied upon. Contractors, subcontractors and suppliers must verify all dimensions on site before commencing any work or making any shop drawings.
 All shop drawings to be submitted to the architect for comment prior to fabrication.
 This drawing is to be read in conjunction with the Architect's specification, bills of quantities / schedules, structural, mechanical & electrical drawings and all discrepancies are to be reported to the architect.
 Do not scale from this drawing. Dimensions are in millimetres unless otherwise stated.

revision / date / amendments
 - / - / -

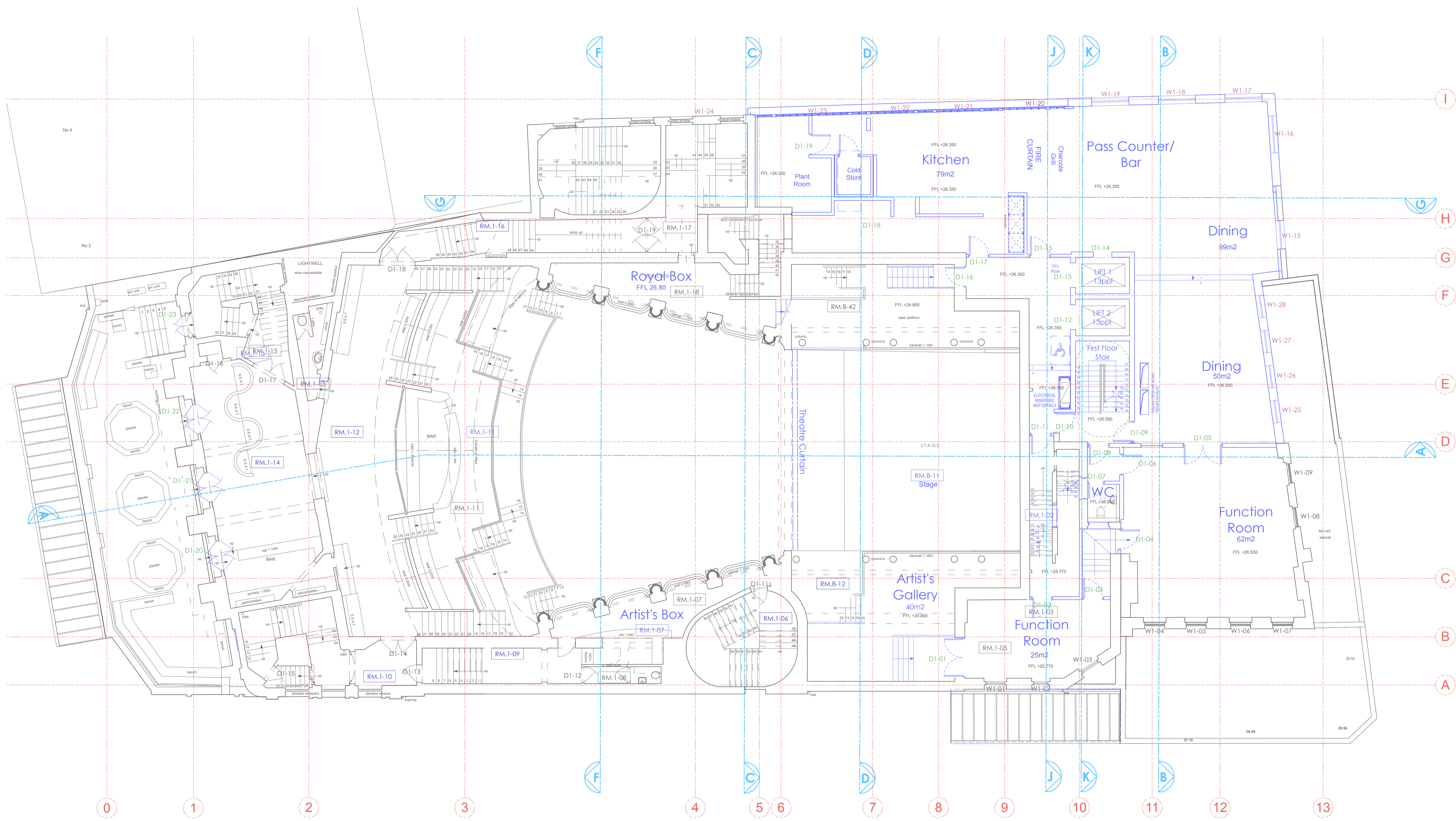

LEGEND

- Management Area - Staff
- Management Area - Koko Users
- Management Area - Private Members
- Management Area - Public Users
- Management Area - Artists

18.10.17

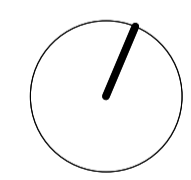

PLANNING

Archer Humphryes Architects

Basement
 Central House
 142 Central Street
 London, United Kingdom
 EC1V 8AR
 T: +44 (0) 20 7251 8555

NO ACCESS TO PUBLIC USERS

project title		KOKO + Hope & Anchor + Bayham Place Camden, London	
drawing title	scale	date	
Proposed First Floor Plan Management - Public Users	1:100 @ A1	18.10.17	
drawing number	drawn	checked	
AHA/KKG/GA/013D	FR/PC	DA	
	revision		

Copyright: All rights reserved. This drawing must not be reproduced without permission.
 Only the original drawing should be relied upon. Contractors, subcontractors and suppliers must verify all dimensions on site before commencing any work or making any shop drawings.
 All shop drawings to be submitted to the architect for comment prior to fabrication.
 This drawing is to be read in conjunction with the Architect's specification, bills of quantities / schedules, structural, mechanical & electrical drawings and all discrepancies are to be reported to the architect.
 Do not scale from this drawing. Dimensions are in millimetres unless otherwise stated.

revision / date / amendments
 - / - / -

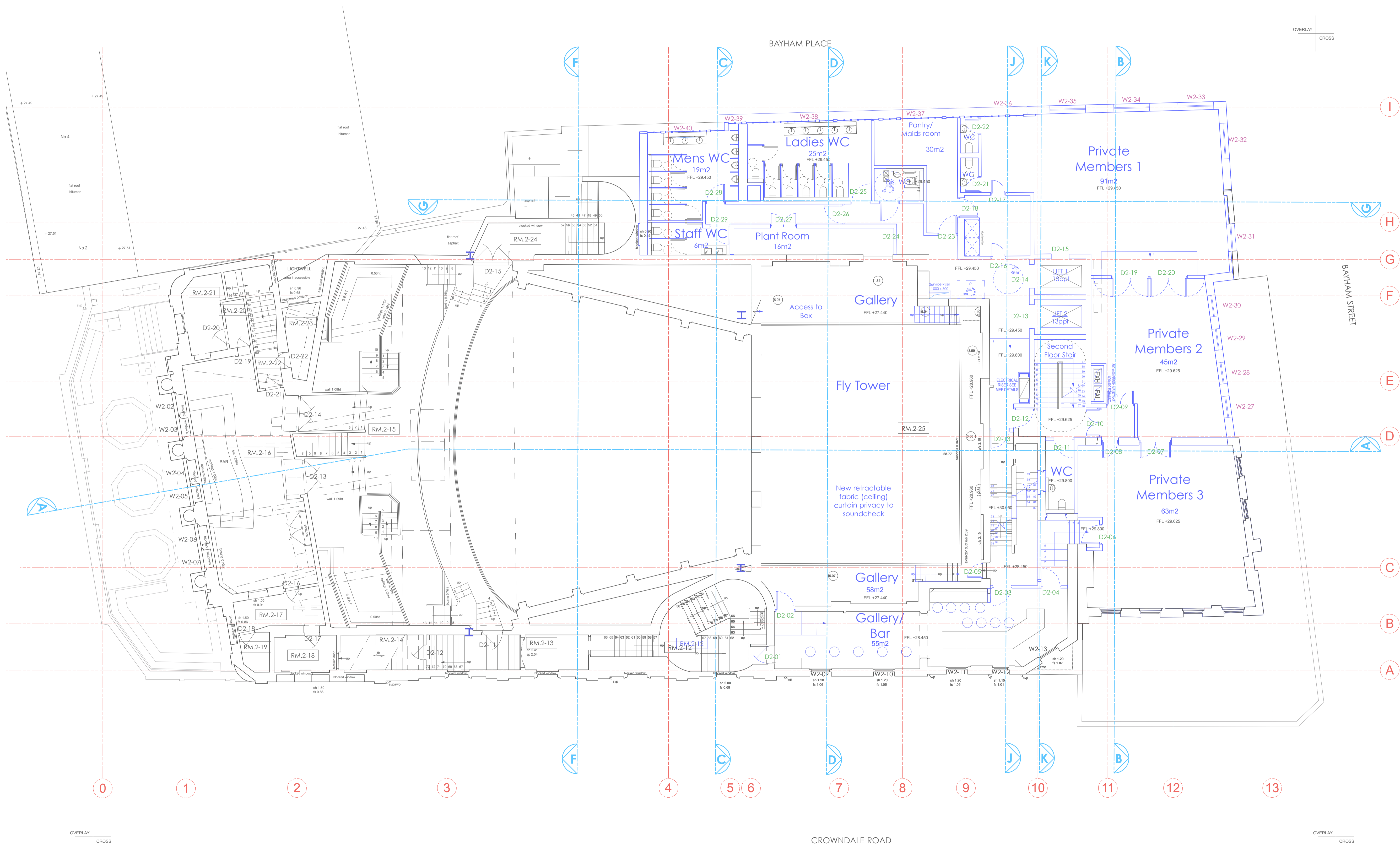

LEGEND

- Management Area - Staff
- Management Area - Koko Users
- Management Area - Private Members
- Management Area - Public Users
- Management Area - Artists

18.10.17

PLANNING
 Archer Humphries Architects
 Basement
 Central House
 142 Central Street
 London, United Kingdom
 EC1V 8AR
 T: +44 (0) 20 7251 8555

NO ACCESS TO PUBLIC USERS

project title		KOKO + Hope & Anchor + Bayham Place Camden, London	
drawing title	scale	date	
Proposed Second Floor Plan Management - Public Users	1:100 @ A1	18.10.17	
drawing number	drawn	checked	
AHA/KKG/GA/014D	FR/PC	DA	
	revision		

Copyright: All rights reserved. This drawing must not be reproduced without permission.
 Only the original drawing should be relied upon. Contractors, subcontractors and suppliers must verify all dimensions on site before commencing any work or making any shop drawings.
 All shop drawings to be submitted to the architect for comment prior to fabrication.
 This drawing is to be read in conjunction with the Architect's specification, bills of quantities / schedules, structural, mechanical & electrical drawings and all discrepancies are to be reported to the architect.
 Do not scale from this drawing. Dimensions are in millimetres unless otherwise stated.

revision / date / amendments
 - / - / -

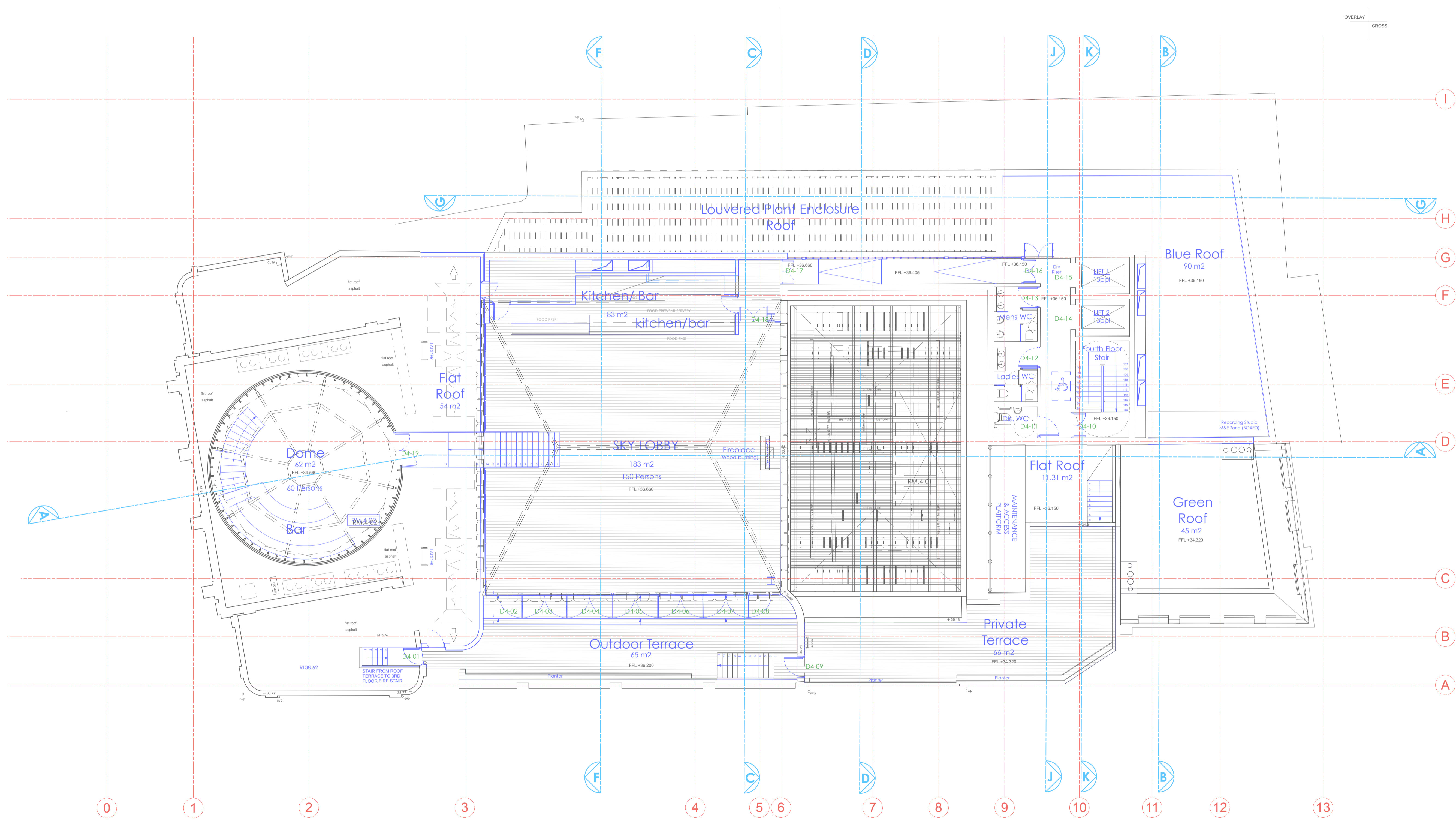

LEGEND

- Management Area - Staff
- Management Area - Koko Users
- Management Area - Private Members
- Management Area - Public Users
- Management Area - Artists

18.10.17

PLANNING
 Archer Humphryes Architects

Basement
 Central House
 142 Central Street
 London, United Kingdom
 EC1V 8AR
 T: +44 (0) 20 7251 8555

NO ACCESS TO PUBLIC USERS

project title		KOKO + Hope & Anchor + Bayham Place Camden, London	
drawing title	scale	date	
Proposed Fourth Floor Plan Management - Public Users	1:100 @ A1	18.10.17	
drawing number	drawn	checked	
AHA/KKG/GA/016D	FR/PCI	DA	
	revision		

Spatial Extent Available to Artists and Crew

Copyright: All rights reserved. This drawing must not be reproduced without permission.

Only the original drawing should be relied upon. Contractors, subcontractors and suppliers must verify all dimensions on site before commencing any work or making any shop drawings.

All shop drawings to be submitted to the architect for comment prior to fabrication.

This drawing is to be read in conjunction with the Architect's specification, bills of quantities / schedules, structural, mechanical & electrical drawings and all discrepancies are to be reported to the architect.

Do not scale from this drawing. Dimensions are in millimetres unless otherwise stated.

revision / date / amendments
- / - / - / -

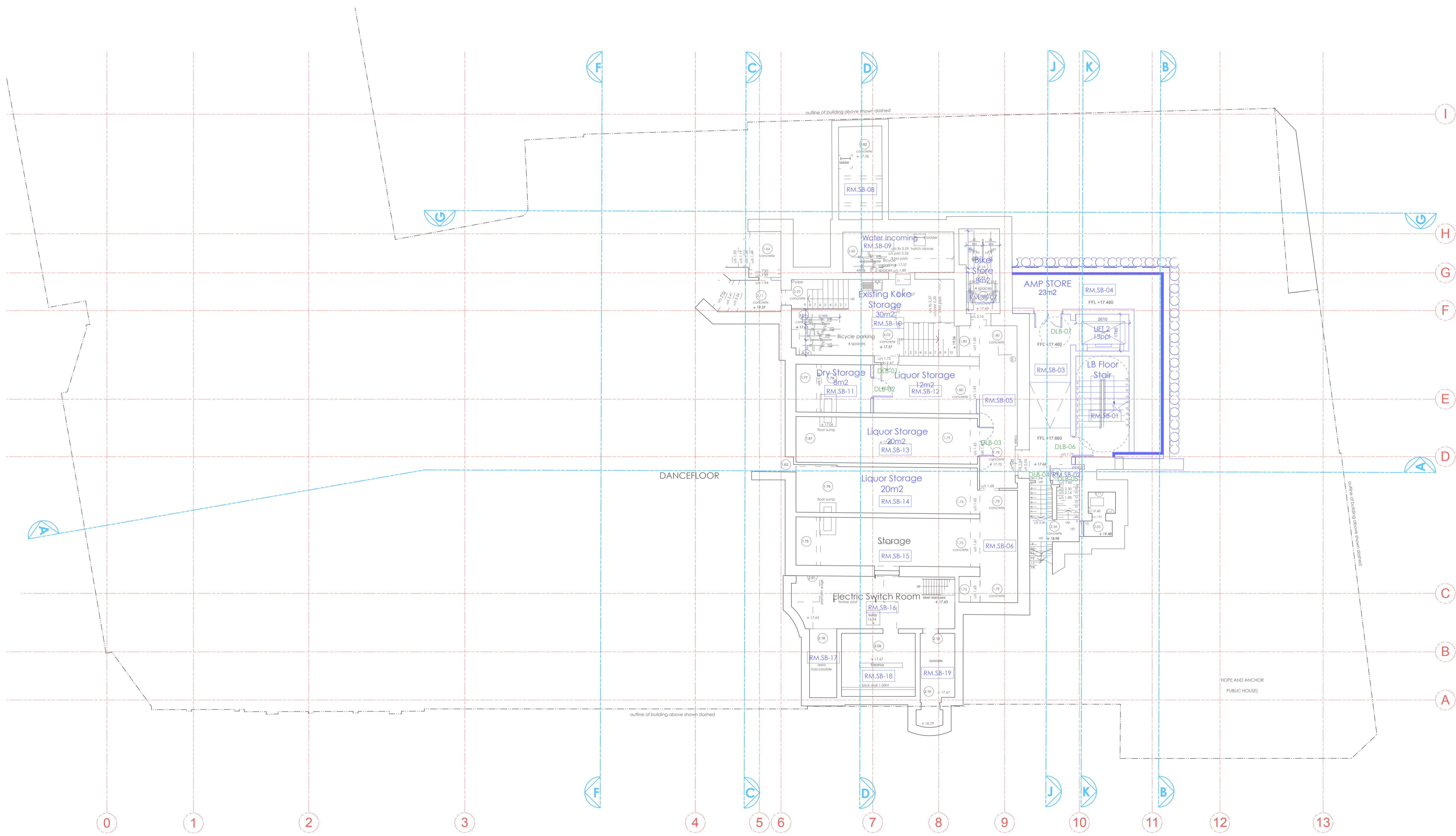

LEGEND

- Management Area - Staff
- Management Area - Koko Users
- Management Area - Private Members
- Management Area - Public Users
- Management Area - Artists

NO ACCESS TO ARTISTS

18.10.17

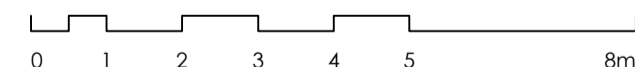
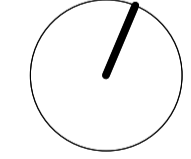

PLANNING

Archer Humphryes Architects

Basement
Central House
142 Central Street
London, United Kingdom
EC1V 8AR
T: +44 (0) 20 7251 8555

project title	
KOKO + Hope & Anchor + Bayham Place Camden, London	
drawing title	scale date
Proposed Sub Basement Plan Management - Public Areas	1:100 @ A1 18.10.17
drawing number	drawn checked
AHA/KKG/GA/010E	FR/PC DA
	revision
	-

revision / date / amendments

- / - / -

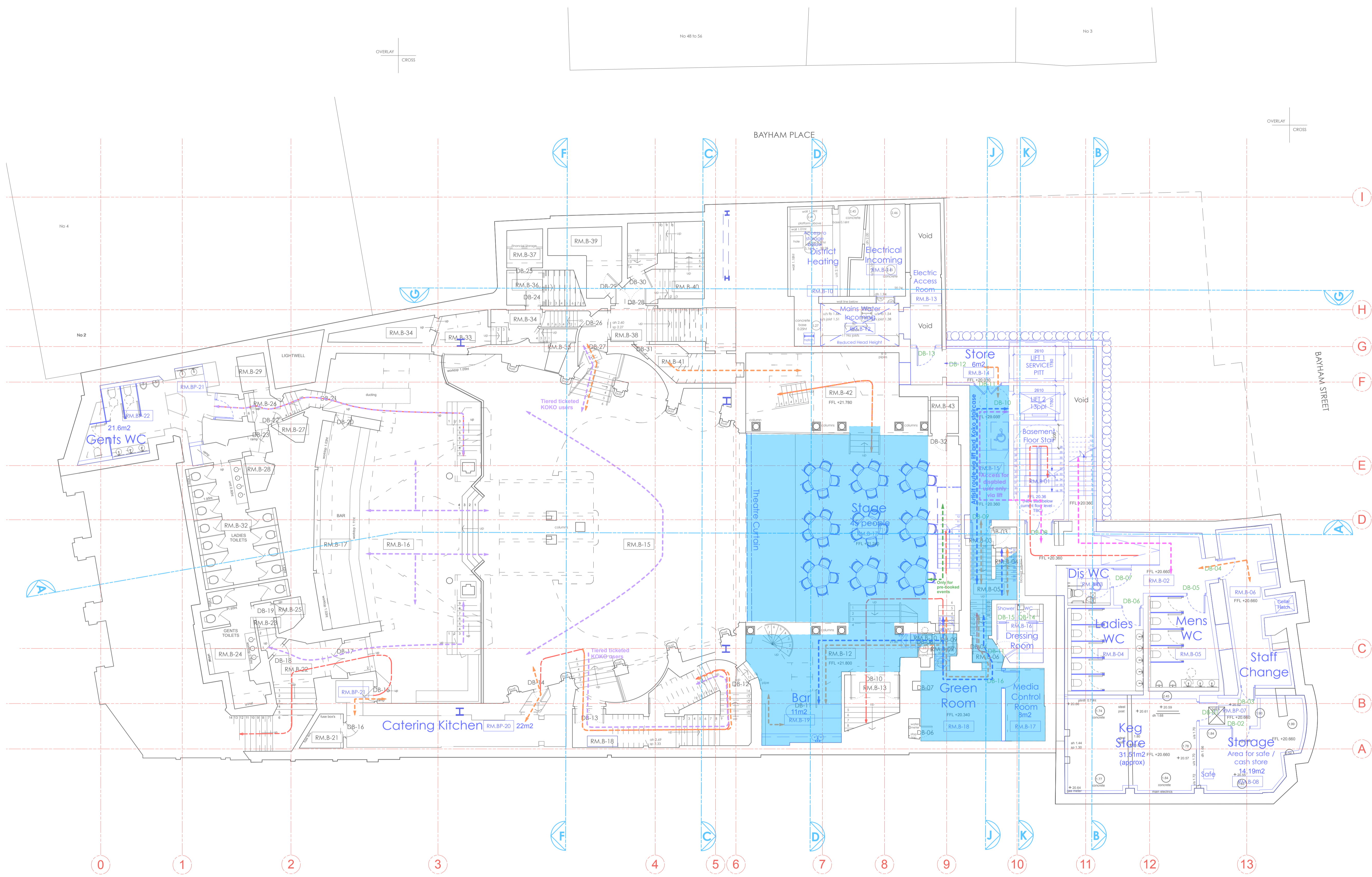

LEGEND

- Management Area - Staff
- Management Area - Koko Users
- Management Area - Private Members
- Management Area - Public Users
- Management Area - Artists

19.10.17

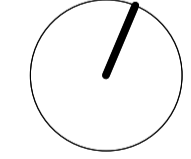

PLANNING

Archer Humphryes Architects

Basement
Central House
142 Central Street
London, United Kingdom
EC1V 8AR
T: +44 (0) 20 7251 8555

project title		KOKO + Hope & Anchor + Bayham Place Camden, London	
drawing title	scale	date	
Proposed Basement Plan Management - Public Users	1:100 @ A1	18.10.17	
drawing number	drawn	checked	
AHA/KKG/GA/011E	FR/PC	DA	
	revision		

revision / date / amendments
- / - / -

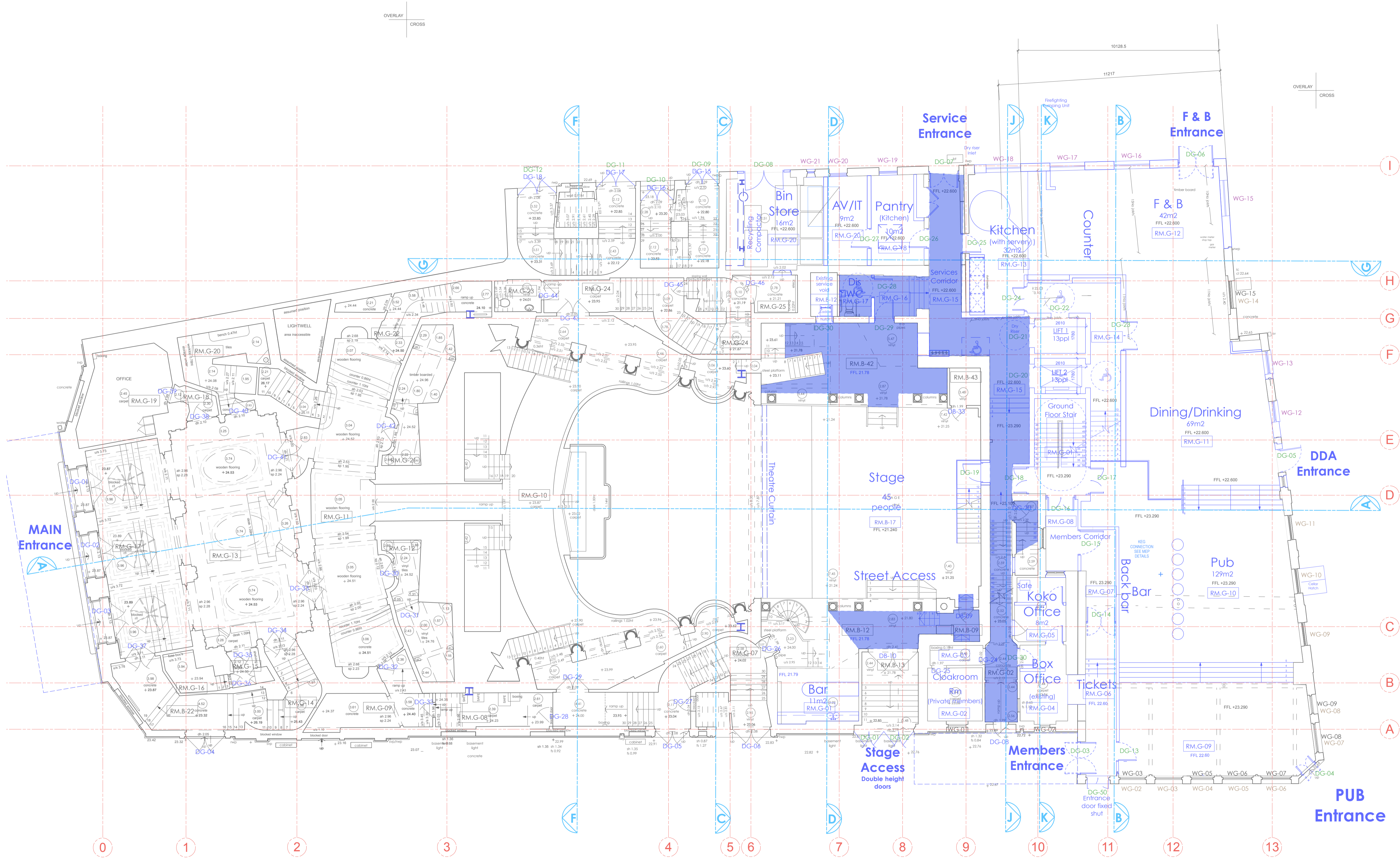

LEGEND

- Management Area - Staff
- Management Area - Koko Users
- Management Area - Private Members
- Management Area - Public Users
- Management Area - Artists

18.10.17

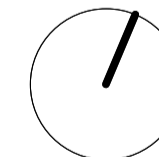

0 1 2 3 4 5 6m

PLANNING

Archer Humphries Architects

Basement
Central House
142 Central Street
London, United Kingdom
EC1V 8AR
T: +44 (0) 20 7251 8555

project title		KOKO + Hope & Anchor + Bayham Place Camden, London	
drawing title	scale	date	
Proposed Ground Floor Plan Management - Artists	1:100 A11	18.10.17	
drawing number	drawn	checked	
AHA/KKG/GA/012E	FR/PC	DA	
	revision		

revision / date / amendments
- / - / -

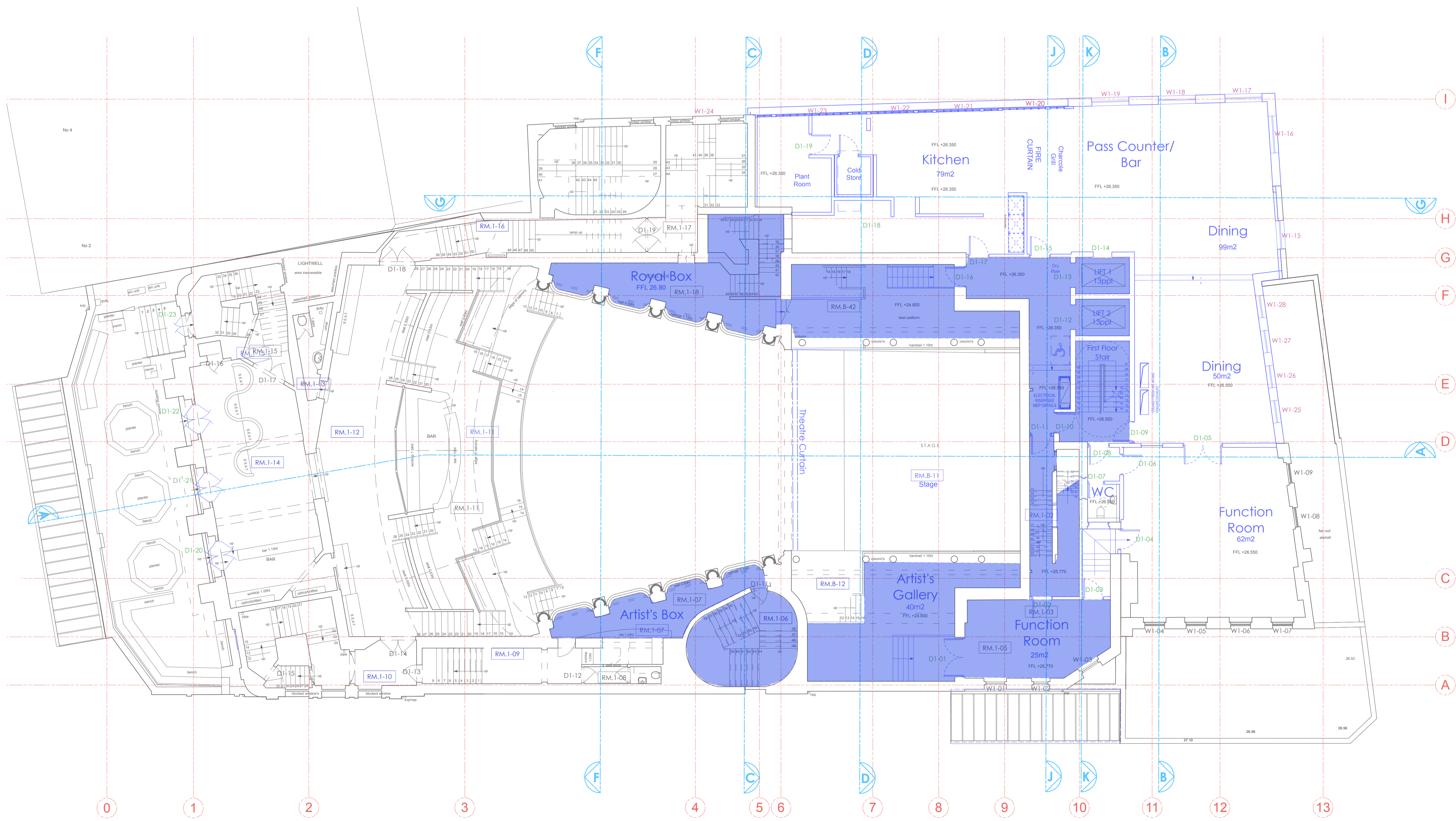

LEGEND

- Management Area - Staff
- Management Area - Koko Users
- Management Area - Private Members
- Management Area - Public Users
- Management Area - Artists

18.10.17

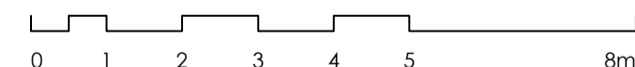
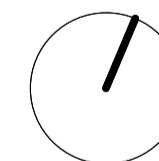

PLANNING

Archer Humphryes Architects

Basement
Central House
142 Central Street
London, United Kingdom
EC1V 8AR
T: +44 (0) 20 7251 8555

project title	
KOKO + Hope & Anchor + Bayham Place Camden, London	
drawing title	scale / date
Proposed First Floor Plan Management - Artists	1:100 @ A1 18.10.17 drawn / checked FR/PC DA
drawing number	revision
AHA/KKC/GA/013E	-

revision / date / amendments
- / - / -

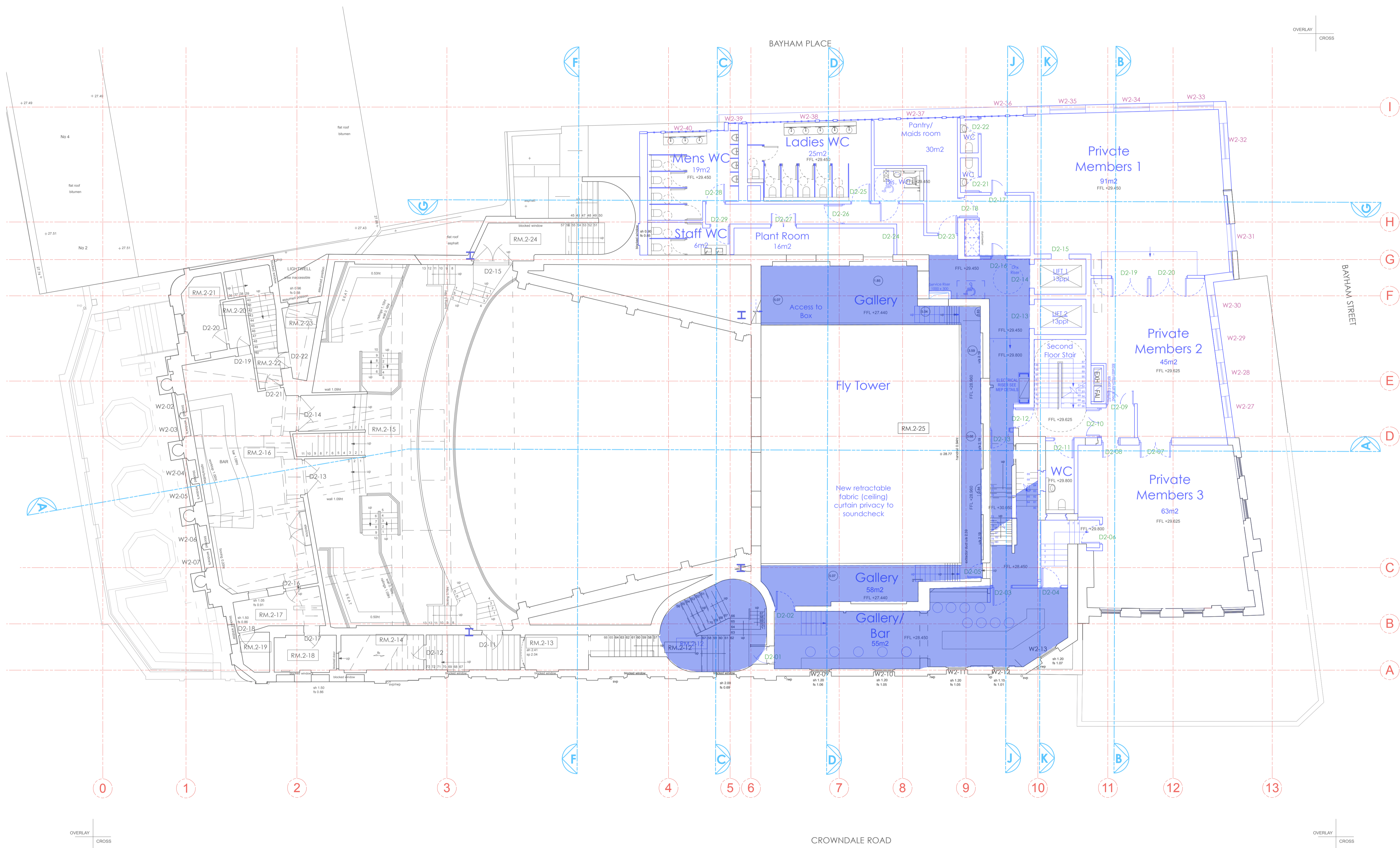

LEGEND

- Management Area - Staff
- Management Area - Koko Users
- Management Area - Private Members
- Management Area - Public Users
- Management Area - Artists

18.10.17

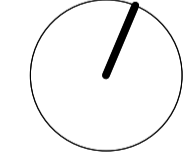

PLANNING

Archer Humphryes Architects

Basement
Central House
142 Central Street
London, United Kingdom
EC1V 8AR
T: +44 (0) 20 7251 8555

project title		KOKO + Hope & Anchor + Bayham Place Camden, London	
drawing title	scale	date	
Proposed Second Floor Plan Management - Public Users	1:100 @ A1	18.10.17	
drawing number	drawn	checked	
AHA/KKG/GA/014E	FR/PC	DA	
	revision		

Copyright: All rights reserved. This drawing must not be reproduced without permission.
 Only the original drawing should be relied upon. Contractors, subcontractors and suppliers must verify all dimensions on site before commencing any work or making any shop drawings.
 All shop drawings to be submitted to the architect for comment prior to fabrication.
 This drawing is to be read in conjunction with the Architect's specification, bills of quantities / schedules, structural, mechanical & electrical drawings and all discrepancies are to be reported to the architect.
 Do not scale from this drawing. Dimensions are in millimetres unless otherwise stated.

revision / date / amendments
 - / - / -

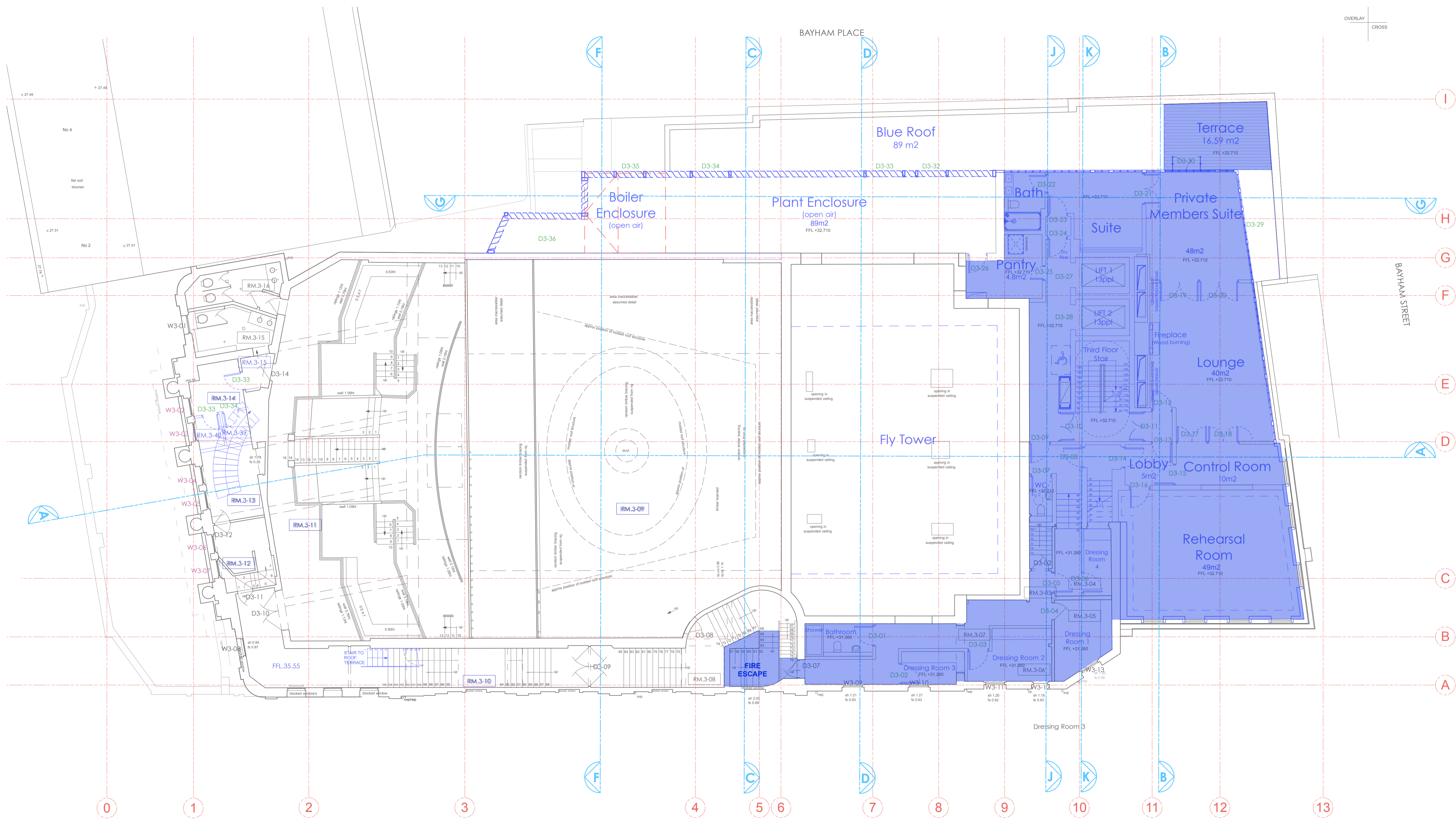

LEGEND

- Management Area - Staff
- Management Area - Koko Users
- Management Area - Private Members
- Management Area - Public Users
- Management Area - Artists

18.10.17

PLANNING
 Archer Humphryes Architects

Basement
 Central House
 142 Central Street
 London, United Kingdom
 EC1V 8AR
 T: +44 (0) 20 7251 8555

project title	
KOKO + Hope & Anchor + Bayham Place Camden, London	
drawing title	scale
Proposed Third Floor Plan	1:100 @ A1
Management - Artists	date
drawing number	drawn / checked
AHA/KKG/GA/015E	FR/PCI DA
	revision
	-

Copyright: All rights reserved. This drawing must not be reproduced without permission.
 Only the original drawing should be relied upon. Contractors, subcontractors and suppliers must verify all dimensions on site before commencing any work or making any shop drawings.
 All shop drawings to be submitted to the architect for comment prior to fabrication.
 This drawing is to be read in conjunction with the Architect's specification, bills of quantities / schedules, structural, mechanical & electrical drawings and all discrepancies are to be reported to the architect.
 Do not scale from this drawing. Dimensions are in millimetres unless otherwise stated.

revision / date / amendments
 - / - / -

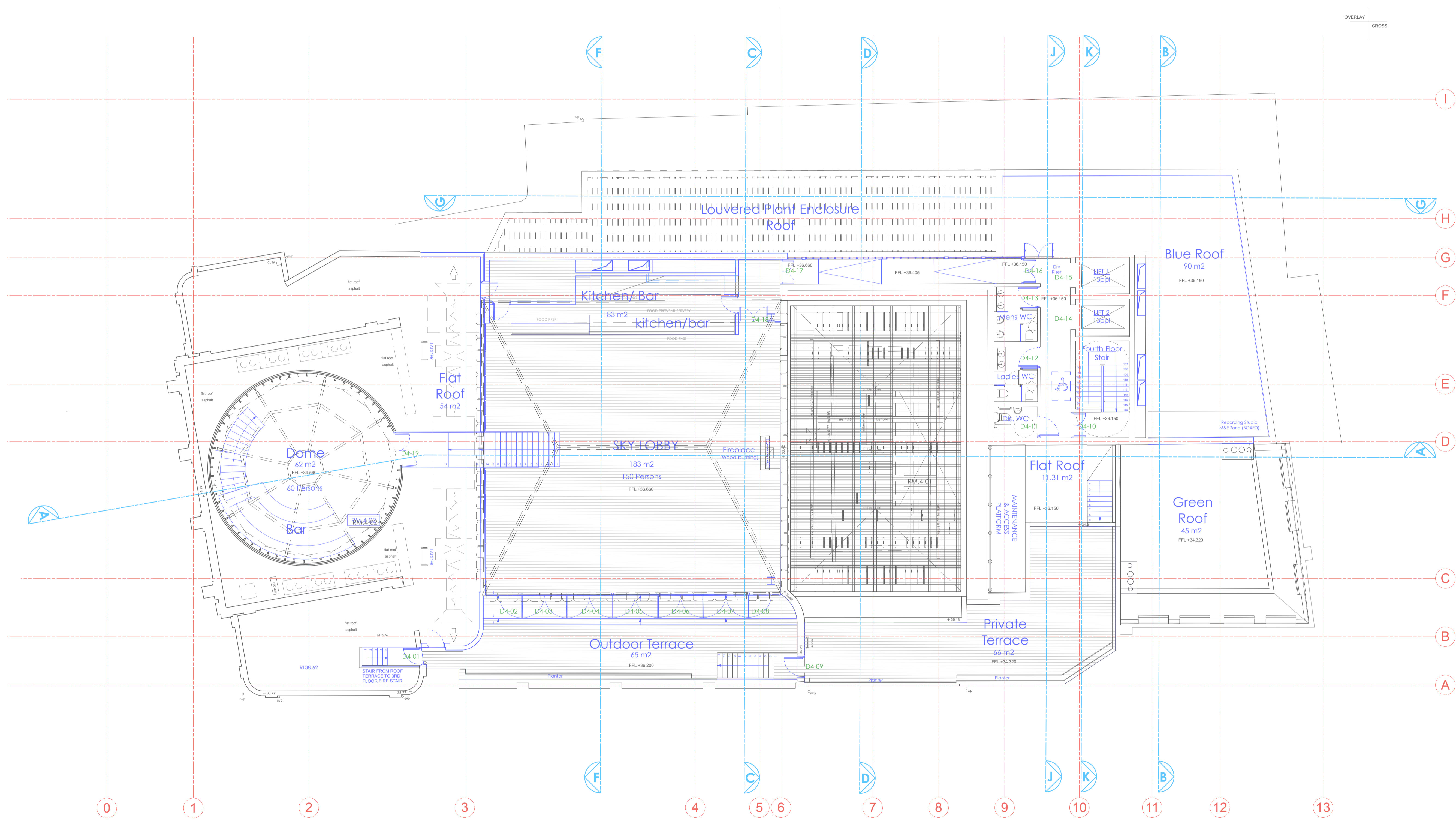

LEGEND

- Management Area - Staff
- Management Area - Koko Users
- Management Area - Private Members
- Management Area - Public Users
- Management Area - Artists

18.10.17

PLANNING
 Archer Humphryes Architects
 Basement
 Central House
 142 Central Street
 London, United Kingdom
 EC1V 8AR
 T: +44 (0) 20 7251 8555

NO GENERAL ACCESS TO ARTIST - ONLY AT MANAGEMENT'S DISCRETION

project title		KOKO + Hope & Anchor + Bayham Place Camden, London	
drawing title	scale	date	
Proposed Forth Floor Plan Management - Artists	1:100 @ A1	18.10.17	
drawing number	drawn / checked	FR/PC	DA
AHA/KKG/GA/016E	revision		

