

Copyright: All rights reserved. This drawing must not be reproduced without permission.  
 Only the original drawing should be relied upon. Contractors, subcontractors and suppliers must verify all dimensions on site before commencing any work or making any shop drawings.  
 All shop drawings to be submitted to the architect for comment prior to fabrication.  
 This drawing is to be read in conjunction with the Architect's specification, bills of quantities / schedules, structural, mechanical & electrical drawings and all discrepancies are to be reported to the architect.  
 Do not scale from this drawing. Dimensions are in millimetres unless otherwise stated.

revision / date / amendments  
 - / - / - / -

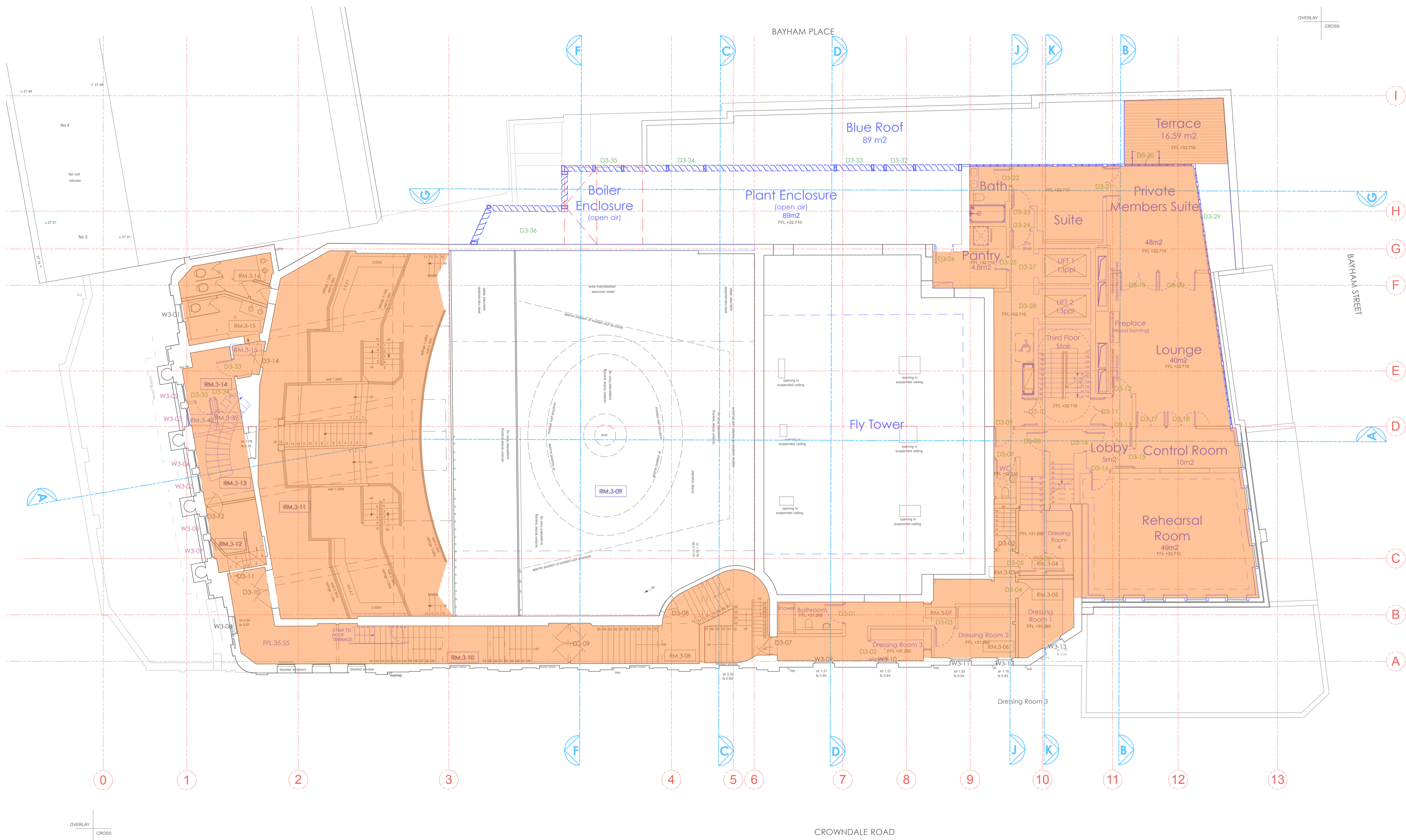

- LEGEND**
- Management Area - Staff
  - Management Area - Koko Users
  - Management Area - Private Members
  - Management Area - Public Users
  - Management Area - Artists

18.10.17

**PLANNING**  
 Archer Humphryes Architects

Basement  
 Central House  
 142 Central Street  
 London, United Kingdom  
 EC1V 8AR  
 T: +44 (0) 20 7251 8555

project title		KOKO + Hope & Anchor + Bayham Place Camden, London	
drawing title	scale	date	
Proposed Third Floor Plan Management - Staff Areas	1:100 @ A1	18.10.17	
drawing number	drawn	checked	
AHA/KKG/GA/015A	FR/PC	DA	
	revision		

Copyright: All rights reserved. This drawing must not be reproduced without permission.

Only the original drawing should be relied upon. Contractors, subcontractors and suppliers must verify all dimensions on site before commencing any work or making any shop drawings.

All shop drawings to be submitted to the architect for comment prior to fabrication.

This drawing is to be read in conjunction with the Architect's specification, bills of quantities / schedules, structural, mechanical & electrical drawings and all discrepancies are to be reported to the architect.

Do not scale from this drawing. Dimensions are in millimetres unless otherwise stated.

revision / date / amendments  
- / - / -

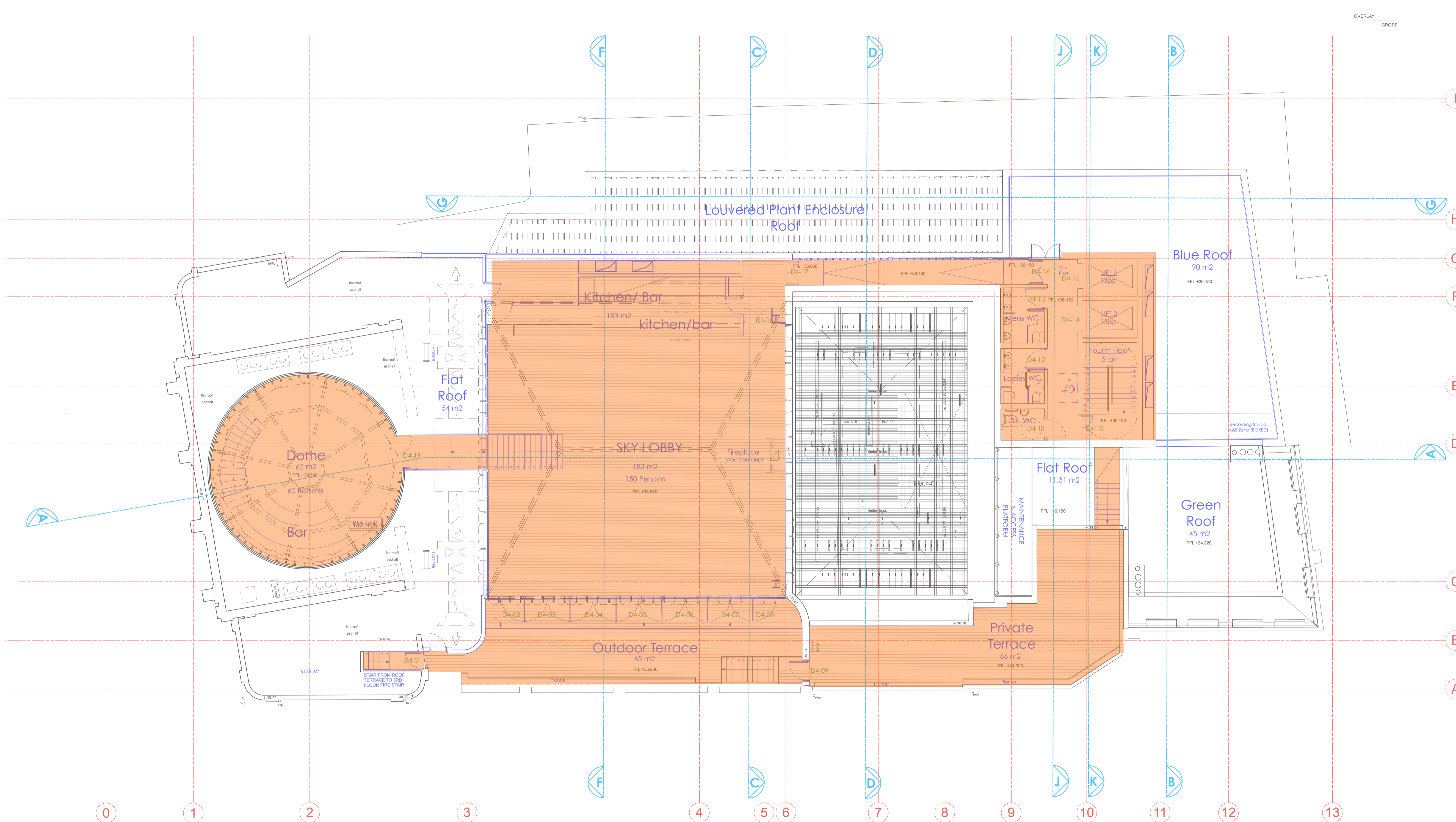

LEGEND

- Management Area - Staff
- Management Area - Koko Users
- Management Area - Private Members
- Management Area - Public Users
- Management Area - Artists

18.10.17

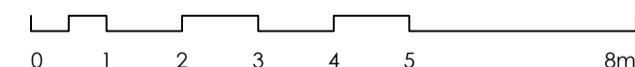
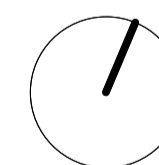

PLANNING

Archer Humphries Architects

Basement  
Central House  
142 Central Street  
London, United Kingdom  
EC1V 8AR  
T: +44 (0) 20 7251 8555

project title		scale	date
KOKO + Hope & Anchor + Bayham Place Camden, London		1:100 @ A1	18.10.17
drawing title	Proposed Fourth Floor Plan Management - Staff Areas	drawn	checked
drawing number	AHA/KKG/GA/016A	FR/PC	DA
		revision	

# Spatial Extent Available to KOKO Patrons

revision / date / amendments
- / - / - / -

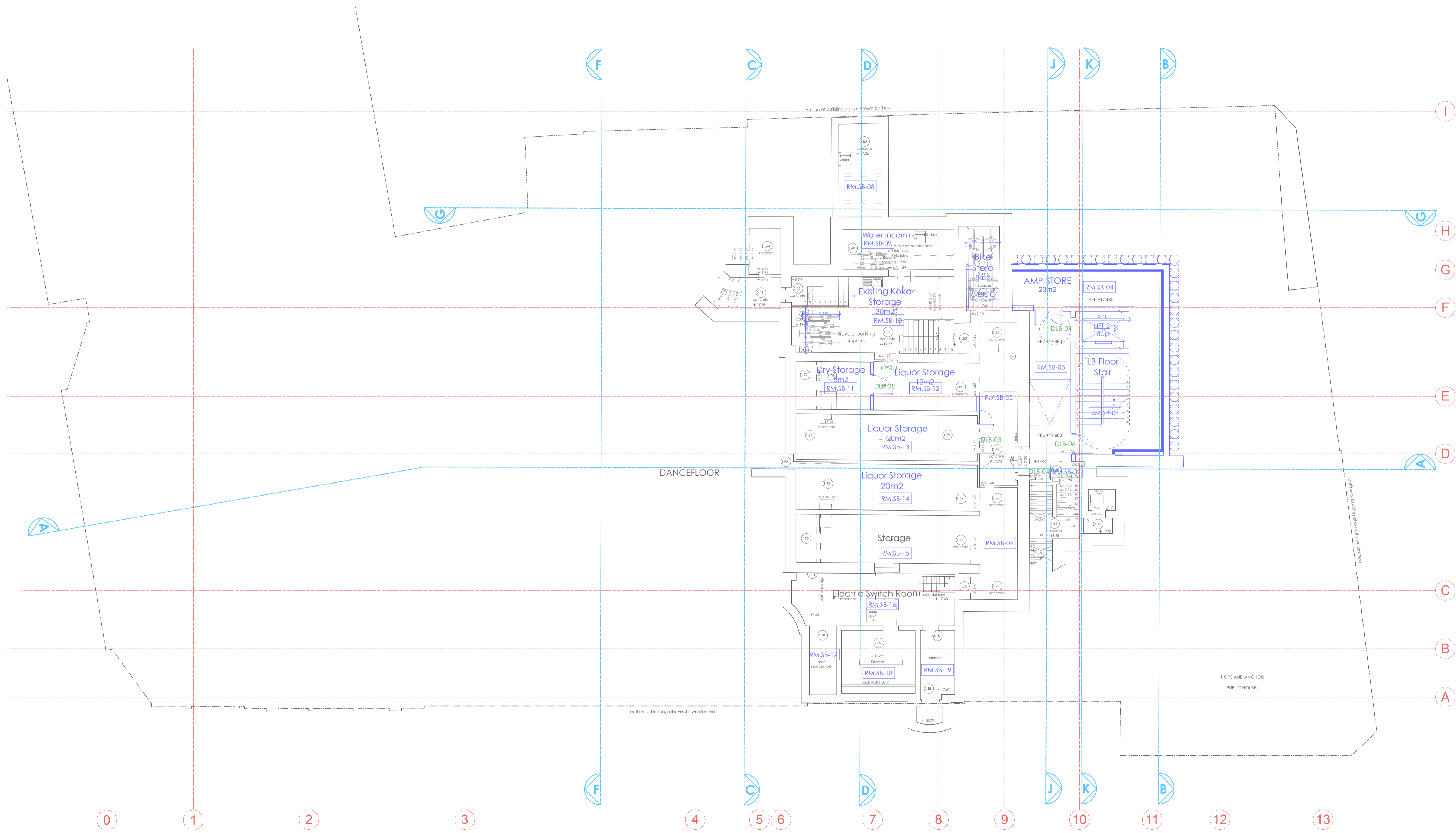

LEGEND

- Management Area - Staff
- Management Area - Koko Users
- Management Area - Private Members
- Management Area - Public Users
- Management Area - Artists

NO ACCESS TO KOKO USERS

18.10.17

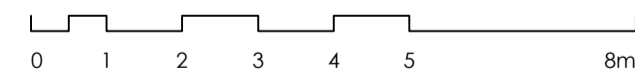
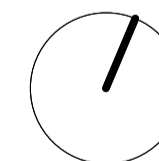

PLANNING

Archer Humphryes Architects

Basement  
Central House  
142 Central Street  
London, United Kingdom  
EC1V 8AR  
T: +44 (0) 20 7251 8555

project title		KOKO + Hope & Anchor + Bayham Place Camden, London	
drawing title	scale	date	
Proposed Sub Basement Plan Management - Koko Users	1:100 @ A1	18.10.17	
drawing number	drawn / checked	revision	
AHA/KKG/GA/010B	FR/PCI DA	-	

Copyright: All rights reserved. This drawing must not be reproduced without permission.

Only the original drawing should be relied upon. Contractors, subcontractors and suppliers must verify all dimensions on site before commencing any work or making any shop drawings.

All shop drawings to be submitted to the architect for comment prior to fabrication.

This drawing is to be read in conjunction with the Architect's specification, bills of quantities / schedules, structural, mechanical & electrical drawings and all discrepancies are to be reported to the architect.

Do not scale from this drawing. Dimensions are in millimetres unless otherwise stated.

revision / date / amendments

- / - / -

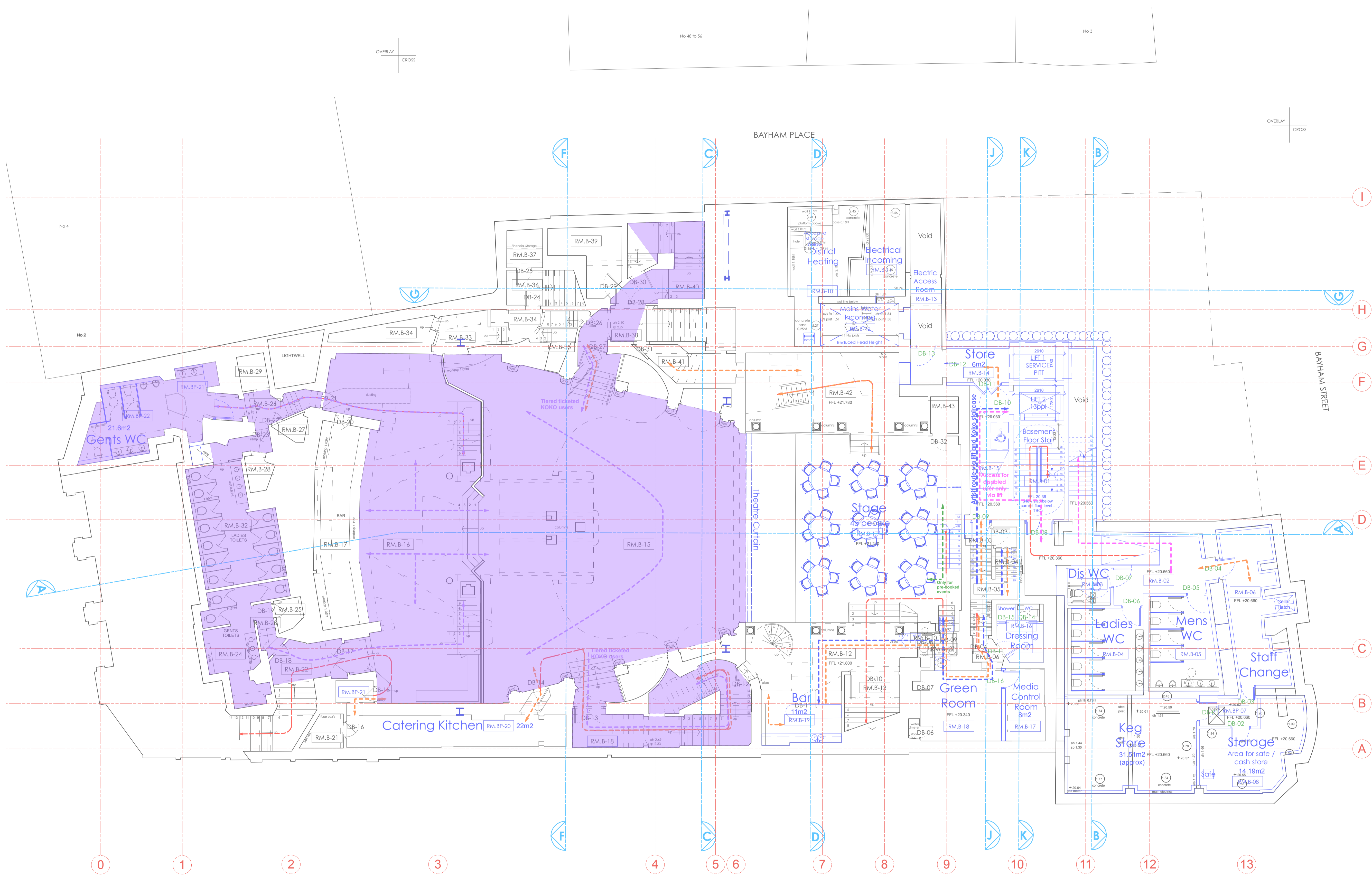

LEGEND

- Management Area - Staff
- Management Area - Koko Users
- Management Area - Private Members
- Management Area - Public Users
- Management Area - Artists

19.10.17

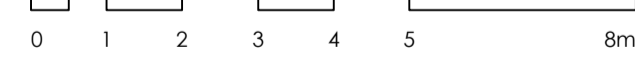
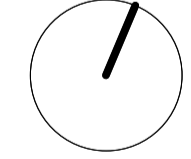

PLANNING

Archer Humphryes Architects

Basement  
 Central House  
 142 Central Street  
 London, United Kingdom  
 EC1V 8AR  
 T: +44 (0) 20 7251 8555

project title		KOKO + Hope & Anchor + Bayham Place Camden, London	
drawing title	scale	date	
Proposed Basement Plan Management - Koko Users	1:100 @ A1	18.10.17	
drawing number	drawn	checked	
AHA/KKG/GA/011B	FR/PC	DA	
	revision		

revision / date / amendments  
- / - / -

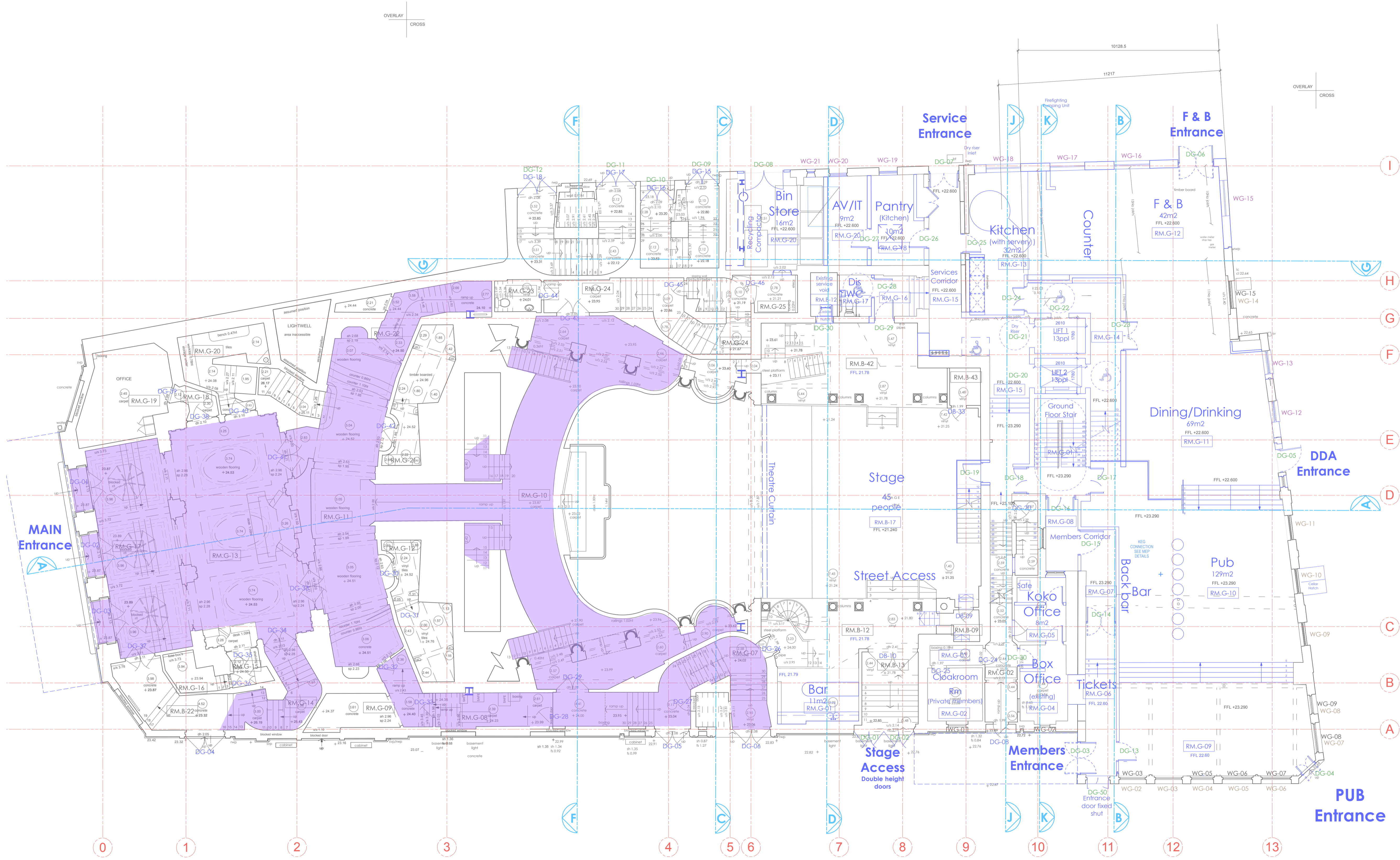

LEGEND

- Management Area - Staff
- Management Area - Koko Users
- Management Area - Private Members
- Management Area - Public Users
- Management Area - Artists

18.10.17

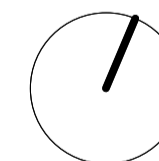

0 1 2 3 4 5 6m

PLANNING

Archer Humphries Architects

Basement  
Central House  
142 Central Street  
London, United Kingdom  
EC1V 8AR  
T: +44 (0) 20 7251 8555

project title		KOKO + Hope & Anchor + Bayham Place Camden, London	
drawing title	scale	date	
Proposed Ground Floor Plan Management - Koko Users	1:100 A1	18.10.17	
drawing number	drawn / checked	FR/PC	DA
AHA/KKG/GA/0128	revision		

revision / date / amendments  
- / - / -

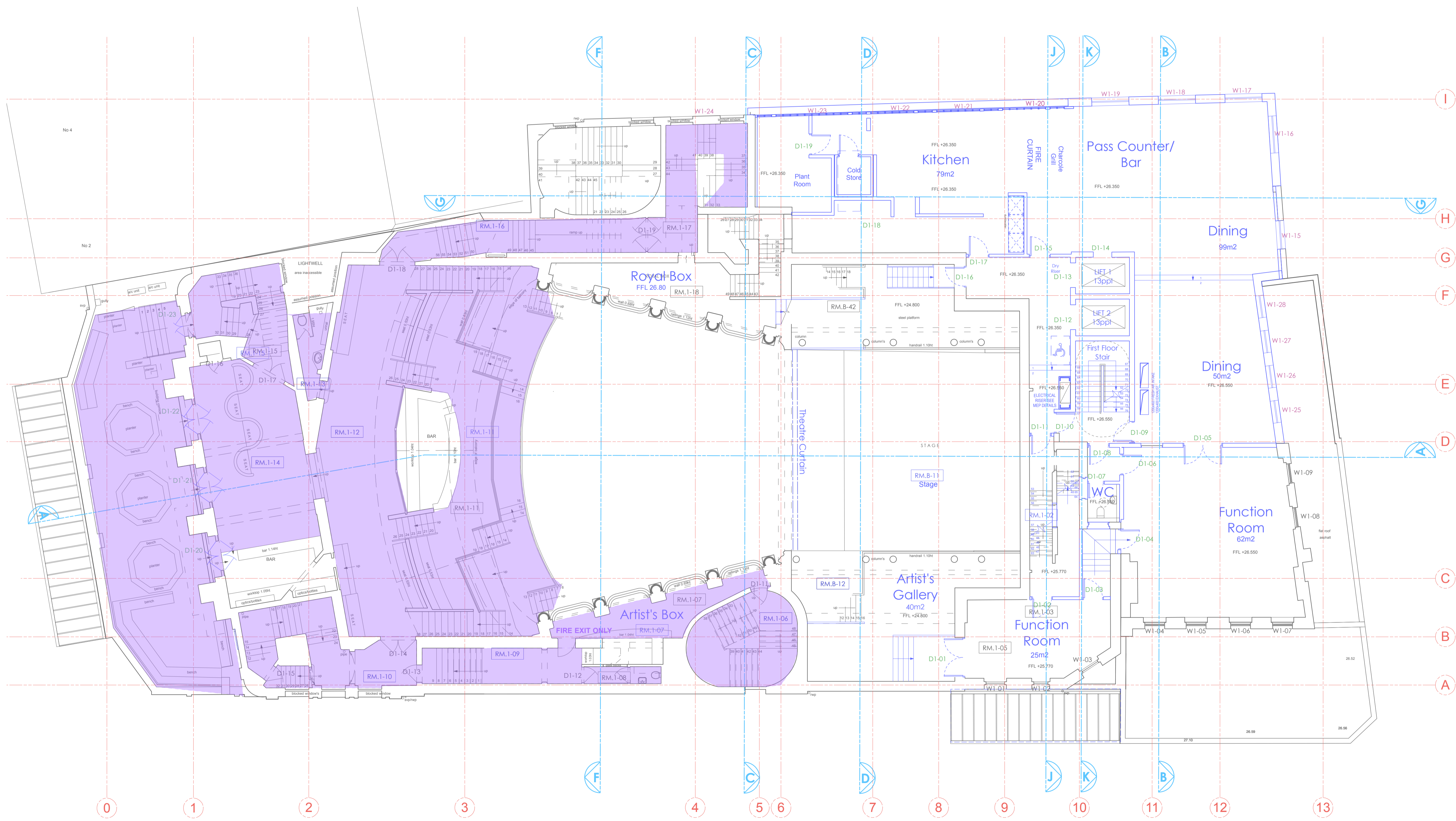

LEGEND

- Management Area - Staff
- Management Area - Koko Users
- Management Area - Private Members
- Management Area - Public Users
- Management Area - Artists

18.10.17

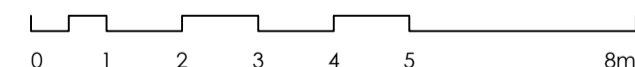
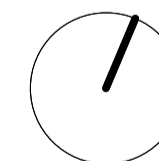

PLANNING

Archer Humphryes Architects

Basement  
Central House  
142 Central Street  
London, United Kingdom  
EC1V 8AR  
T: +44 (0) 20 7251 8555

project title		KOKO + Hope & Anchor + Bayham Place Camden, London	
drawing title	scale	date	
Proposed First Floor Plan Management - Koko Users	1:100 @ A1	18.10.17	
drawing number	drawn	checked	
AHA/KKG/GA/013B	FR/PC	DA	
	revision		

Copyright: All rights reserved. This drawing must not be reproduced without permission.

Only the original drawing should be relied upon. Contractors, subcontractors and suppliers must verify all dimensions on site before commencing any work or making any shop drawings.

All shop drawings to be submitted to the architect for comment prior to fabrication.

This drawing is to be read in conjunction with the Architect's specification, bills of quantities / schedules, structural, mechanical & electrical drawings and all discrepancies are to be reported to the architect.

Do not scale from this drawing. Dimensions are in millimetres unless otherwise stated.

revision / date / amendments

- / - / -

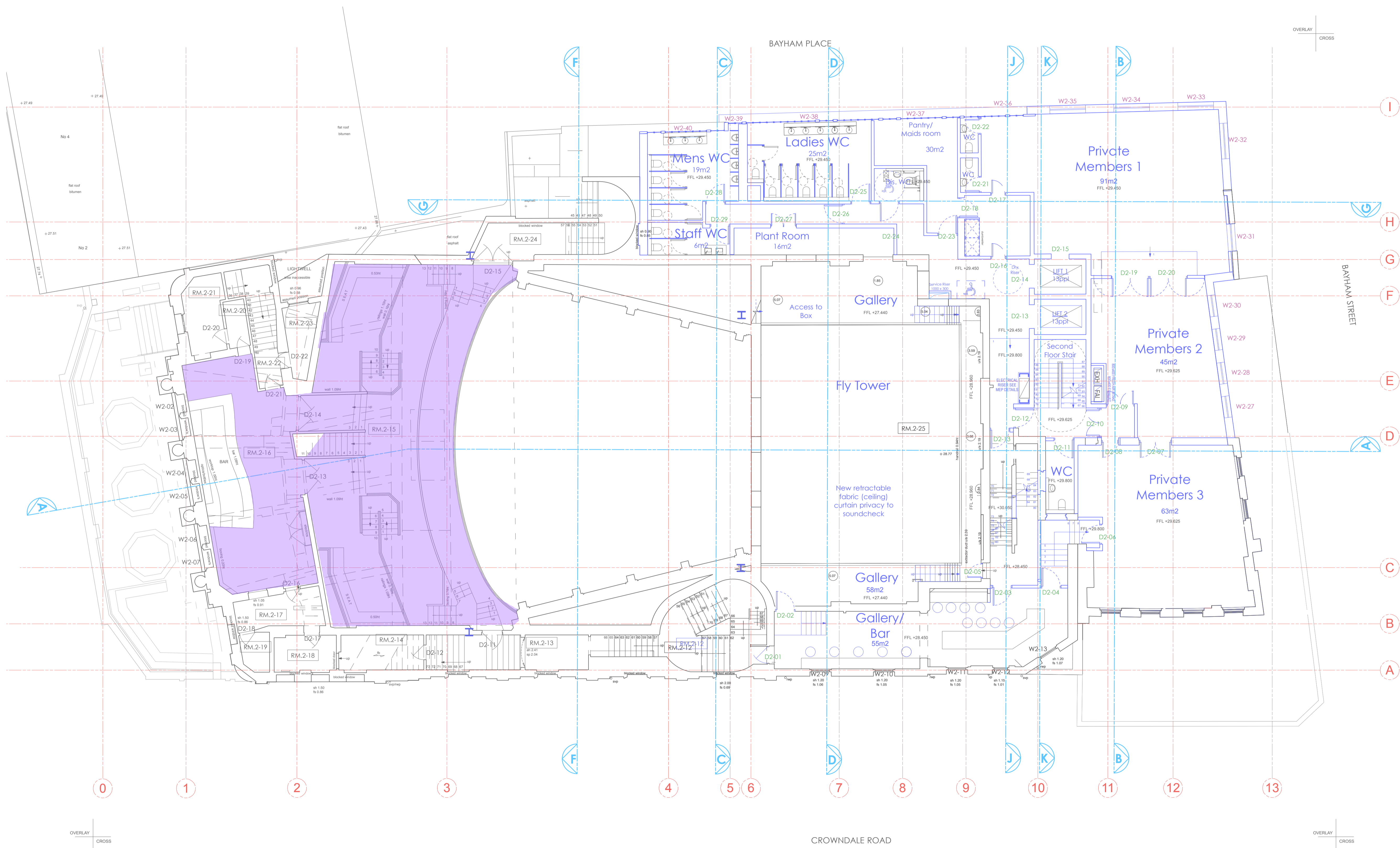

LEGEND

- Management Area - Staff
- Management Area - Koko Users
- Management Area - Private Members
- Management Area - Public Users
- Management Area - Artists

18.10.17

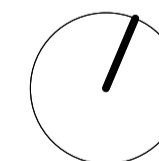

PLANNING

Archer Humphryes Architects

Basement  
 Central House  
 142 Central Street  
 London, United Kingdom  
 EC1V 8AR  
 T: +44 (0) 20 7251 8555

project title		KOKO + Hope & Anchor + Bayham Place Camden, London	
drawing title	Proposed Second Floor Plan Management - Koko Users	scale	1:100 @ A1 18.10.17
drawing number	AHA/KKG/GA/0148	drawn / checked	FR/PC DA
		revision	-



Copyright: All rights reserved. This drawing must not be reproduced without permission.  
 Only the original drawing should be relied upon. Contractors, subcontractors and suppliers must verify all dimensions on site before commencing any work or making any shop drawings.  
 All shop drawings to be submitted to the architect for comment prior to fabrication.  
 This drawing is to be read in conjunction with the Architect's specification, bills of quantities / schedules, structural, mechanical & electrical drawings and all discrepancies are to be reported to the architect.  
 Do not scale from this drawing. Dimensions are in millimetres unless otherwise stated.

revision / date / amendments  
 - / - / -

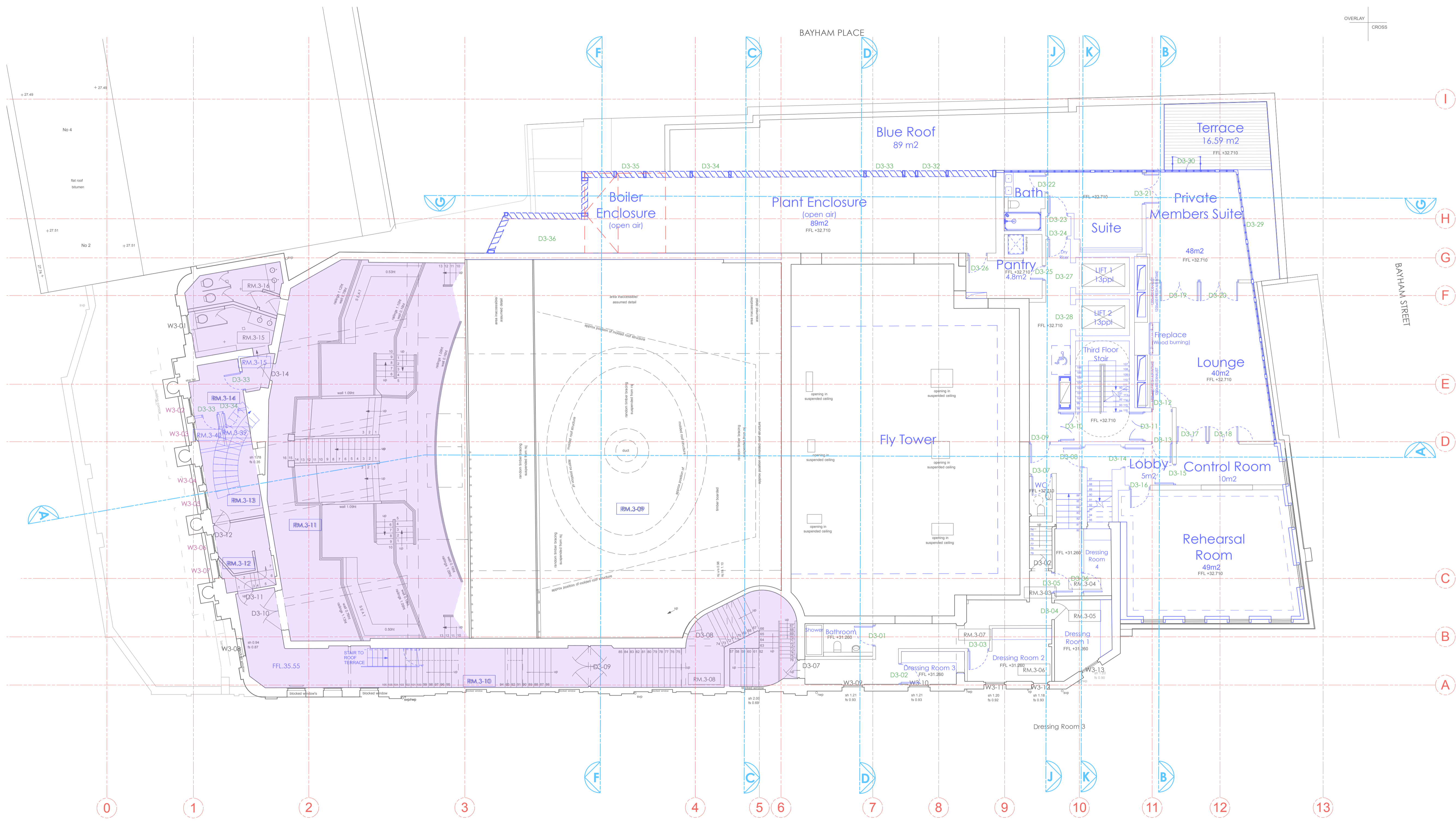

- LEGEND**
- Management Area - Staff
  - Management Area - Koko Users
  - Management Area - Private Members
  - Management Area - Public Users
  - Management Area - Artists

18.10.17

**PLANNING**  
 Archer Humphryes Architects

Basement  
 Central House  
 142 Central Street  
 London, United Kingdom  
 EC1V 8AR  
 T: +44 (0) 20 7251 8555

project title		KOKO + Hope & Anchor + Bayham Place Camden, London	
drawing title	scale	date	
Proposed Third Floor Plan Management - Koko Users	1:100 @ A1	18.10.17	
drawing number	drawn / checked	FR/PC	DA
AHA/KKG/GA/0158	revision		

OVERLAY CROSS

CROWDALE ROAD

OVERLAY CROSS

BAYHAM STREET

BAYHAM PLACE

Copyright: All rights reserved. This drawing must not be reproduced without permission.

Only the original drawing should be relied upon. Contractors, subcontractors and suppliers must verify all dimensions on site before commencing any work or making any shop drawings.

All shop drawings to be submitted to the architect for comment prior to fabrication.

This drawing is to be read in conjunction with the Architect's specification, bills of quantities / schedules, structural, mechanical & electrical drawings and all discrepancies are to be reported to the architect.

Do not scale from this drawing. Dimensions are in millimetres unless otherwise stated.

revision / date / amendments  
- / - / -

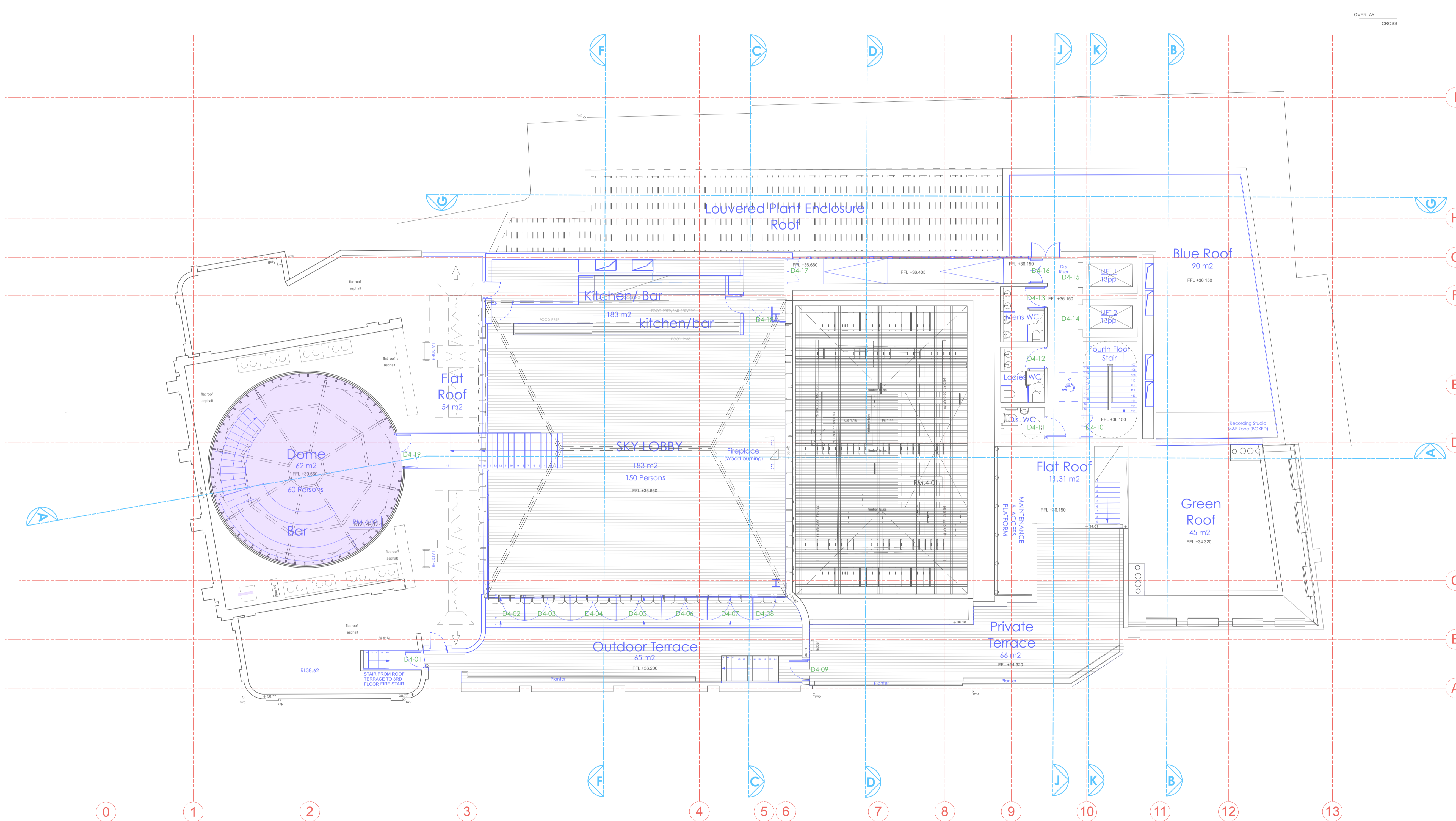

LEGEND

- Management Area - Staff
- Management Area - Koko Users
- Management Area - Private Members
- Management Area - Public Users
- Management Area - Artists

18.10.17

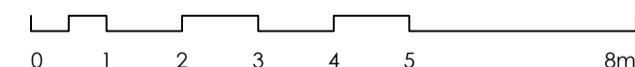
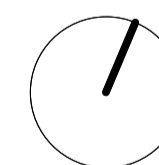

PLANNING

Archer Humphryes Architects

Basement  
Central House  
142 Central Street  
London, United Kingdom  
EC1V 8AR  
T: +44 (0) 20 7251 8555

project title		KOKO + Hope & Anchor + Bayham Place Camden, London	
drawing title	scale	date	
Proposed Fourth Floor Plan Management - Koko Users	1:100 @ A1	18.10.17	
drawing number	drawn / checked	FR/PC	DA
AHA/KKG/GA/016B	revision		

Spatial Extent Available to Private Members

Copyright: All rights reserved. This drawing must not be reproduced without permission.

Only the original drawing should be relied upon. Contractors, subcontractors and suppliers must verify all dimensions on site before commencing any work or making any shop drawings.

All shop drawings to be submitted to the architect for comment prior to fabrication.

This drawing is to be read in conjunction with the Architect's specification, bills of quantities / schedules, structural, mechanical & electrical drawings and all discrepancies are to be reported to the architect.

Do not scale from this drawing. Dimensions are in millimetres unless otherwise stated.

revision / date / amendments  
- / - / - / -

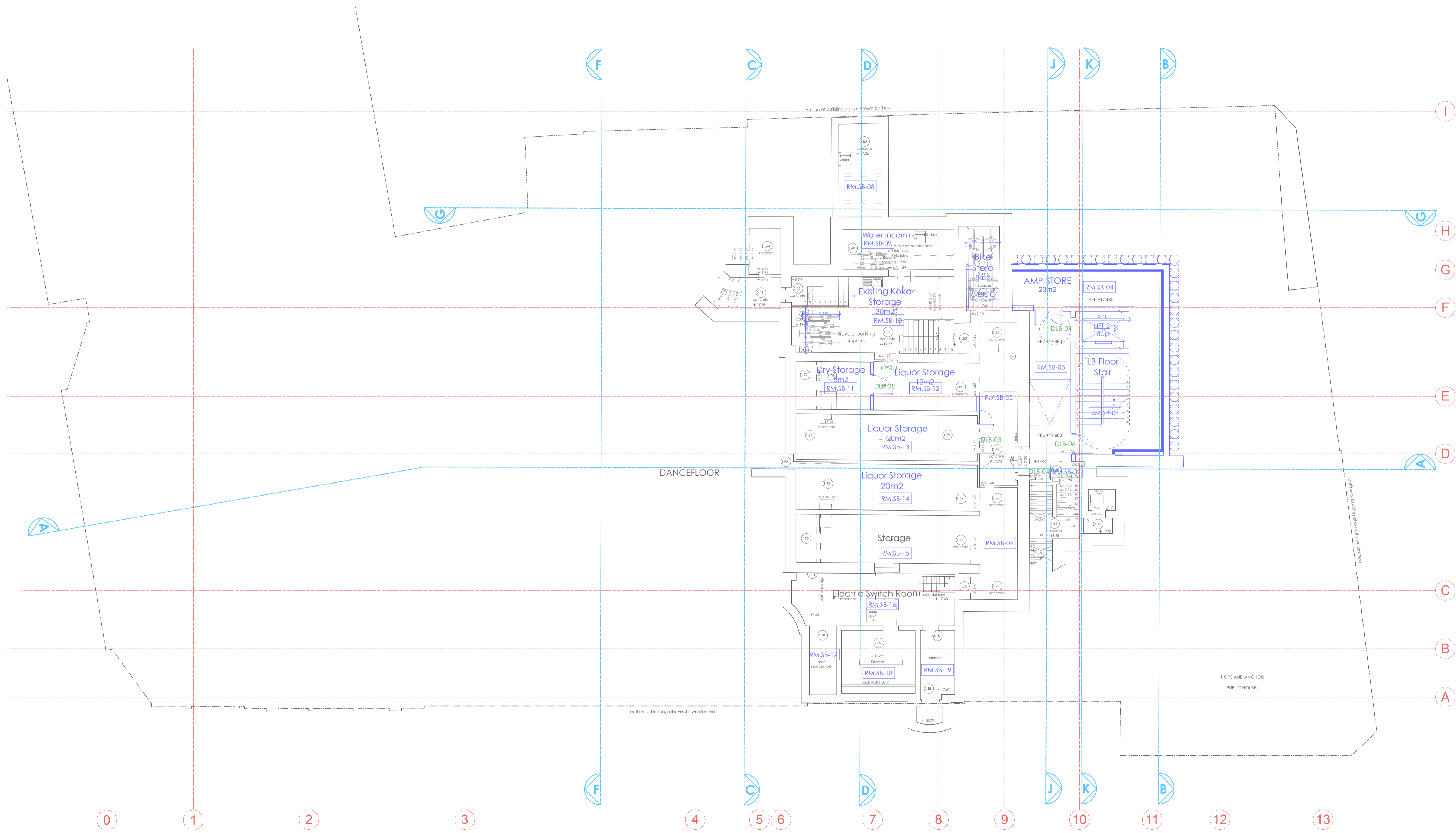

LEGEND

- Management Area - Staff
- Management Area - Koko Users
- Management Area - Private Members
- Management Area - Public Users
- Management Area - Artists

**NO ACCESS TO PRIVATE MEMBERS**

18.10.17

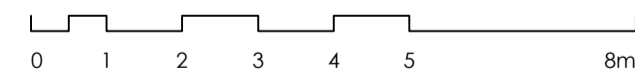
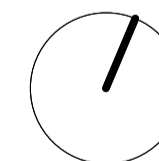

PLANNING

Archer Humphryes Architects

Basement  
Central House  
142 Central Street  
London, United Kingdom  
EC1V 8AR  
T: +44 (0) 20 7251 8555

project title		KOKO + Hope & Anchor + Bayham Place Camden, London	
drawing title	scale	date	
Proposed Sub Basement Plan Management - Private Members	1:100 @ A1	18.10.17	
drawing number	drawn	checked	
AHA/KKG/GA/010C	FR/PC	DA	
	revision		
	-		

revision / date / amendments  
- / - / -

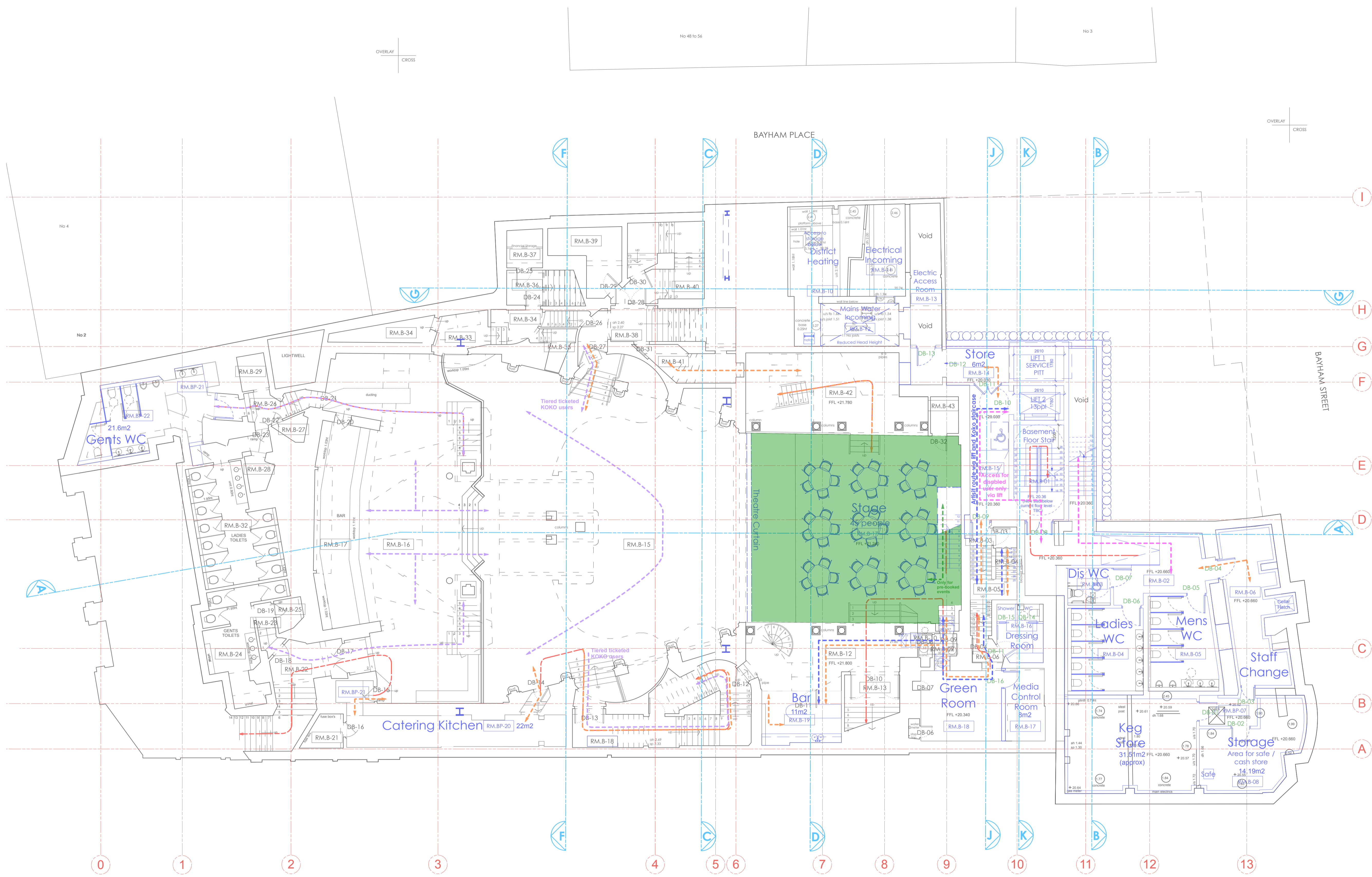

LEGEND

- Management Area - Staff
- Management Area - Koko Users
- Management Area - Private Members
- Management Area - Public Users
- Management Area - Artists

19.10.17

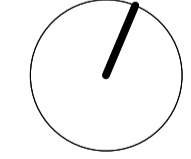

PLANNING

Archer Humphryes Architects

Basement  
Central House  
142 Central Street  
London, United Kingdom  
EC1V 8AR  
T: +44 (0) 20 7251 8555

project title		KOKO + Hope & Anchor + Bayham Place Camden, London	
drawing title	scale	date	
Proposed Basement Plan	1:100 @ A1	18.10.17	
Management - Private Members	drawn	checked	
	FR/PC	DA	
drawing number	revision		
AHA/KKG/GA/011C			

revision / date / amendments  
- / - / -

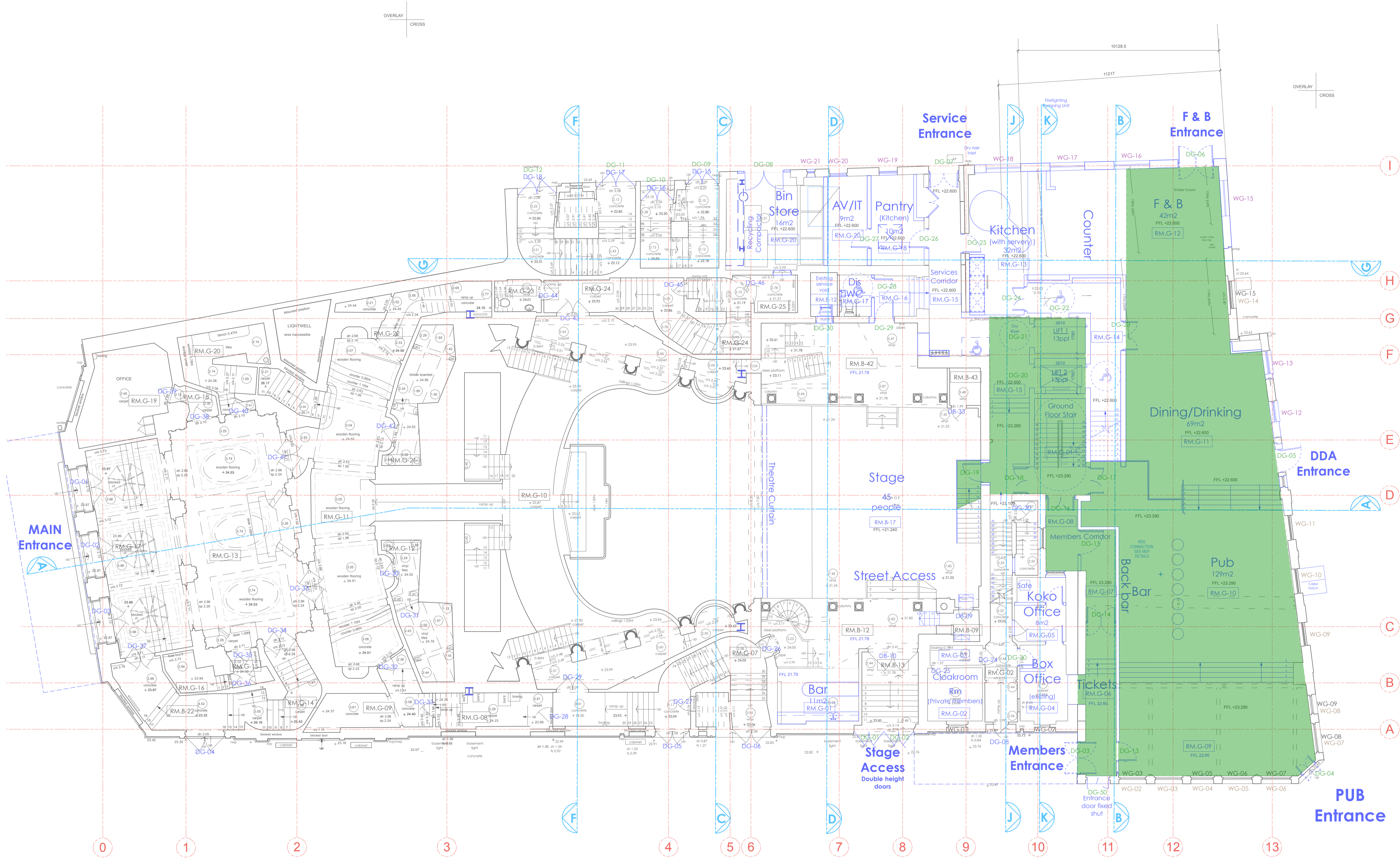

LEGEND

- Management Area - Staff
- Management Area - Koko Users
- Management Area - Private Members
- Management Area - Public Users
- Management Area - Artists

18.10.17

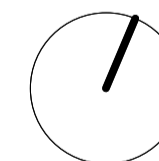

0 1 2 3 4 5 6m

PLANNING

Archer Humphries Architects

Basement  
 Central House  
 142 Central Street  
 London, United Kingdom  
 EC1V 8AR  
 T: +44 (0) 20 7251 8555

project title		KOKO + Hope & Anchor + Bayham Place Camden, London	
drawing title	scale	date	
Proposed Ground Floor Plan Management - Private Members	1:100 A1	18.10.17	
drawing number	drawn	checked	
AHA/KKG/GA/012C	FR/PC	DA	
	revision		

revision / date / amendments  
- / - / -

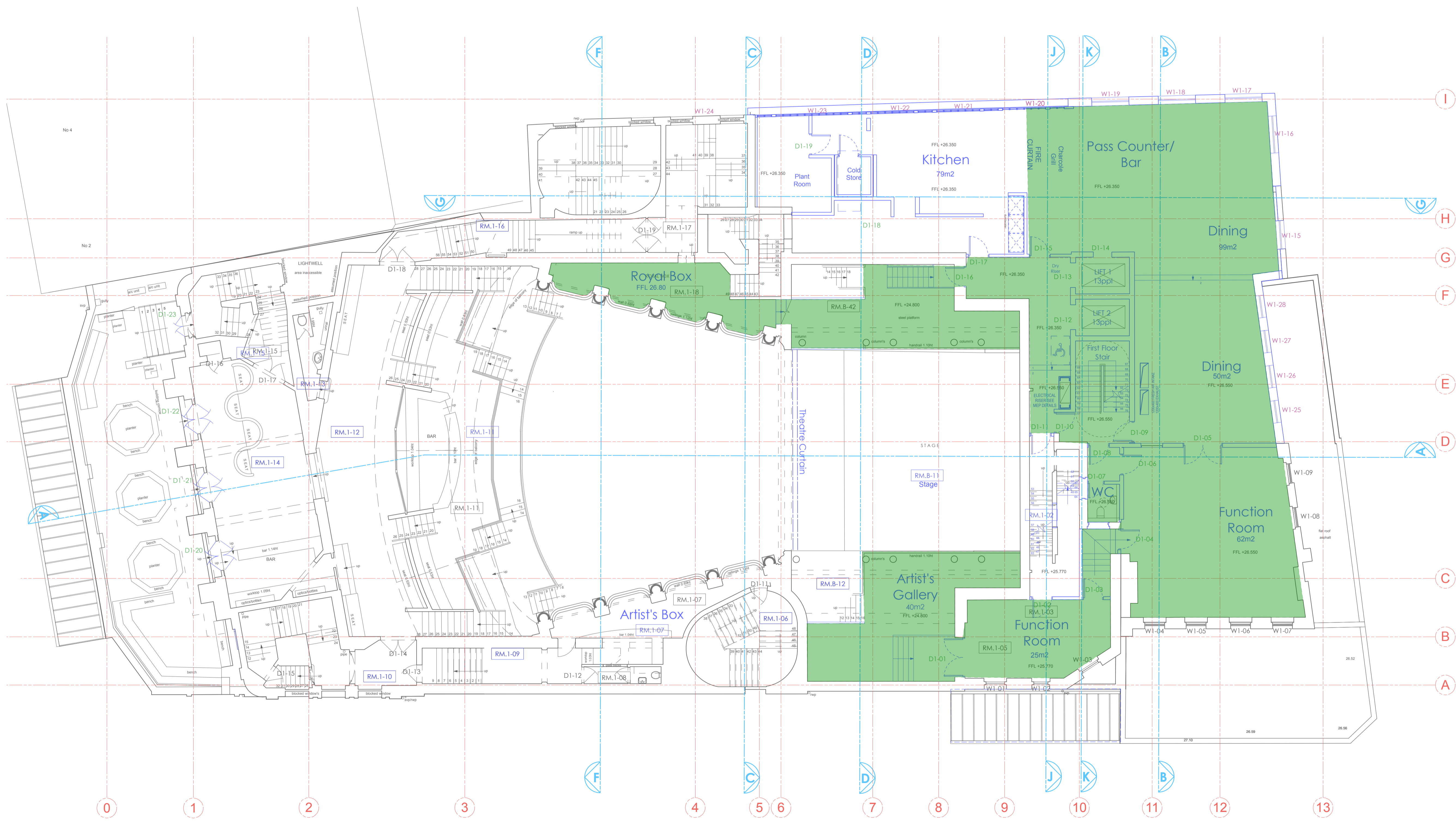

AREA  
397m<sup>2</sup>

LEGEND

- Management Area - Staff
- Management Area - Koko Users
- Management Area - Private Members
- Management Area - Public Users
- Management Area - Artists

18.10.17

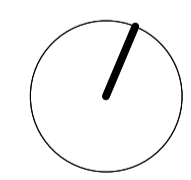

PLANNING

Archer Humphryes Architects

Basement  
Central House  
142 Central Street  
London, United Kingdom  
EC1V 8AR  
T: +44 (0) 20 7251 8555

project title KOKO + Hope & Anchor + Bayham Place Camden, London	
drawing title Proposed First Floor Plan Management - Private Members	scale / date 1:100 @ A1 18.10.17
drawing number AHA/KKG/GA/013C	drawn / checked FR/PC DA
	revision -

revision / date / amendments  
- / - / -

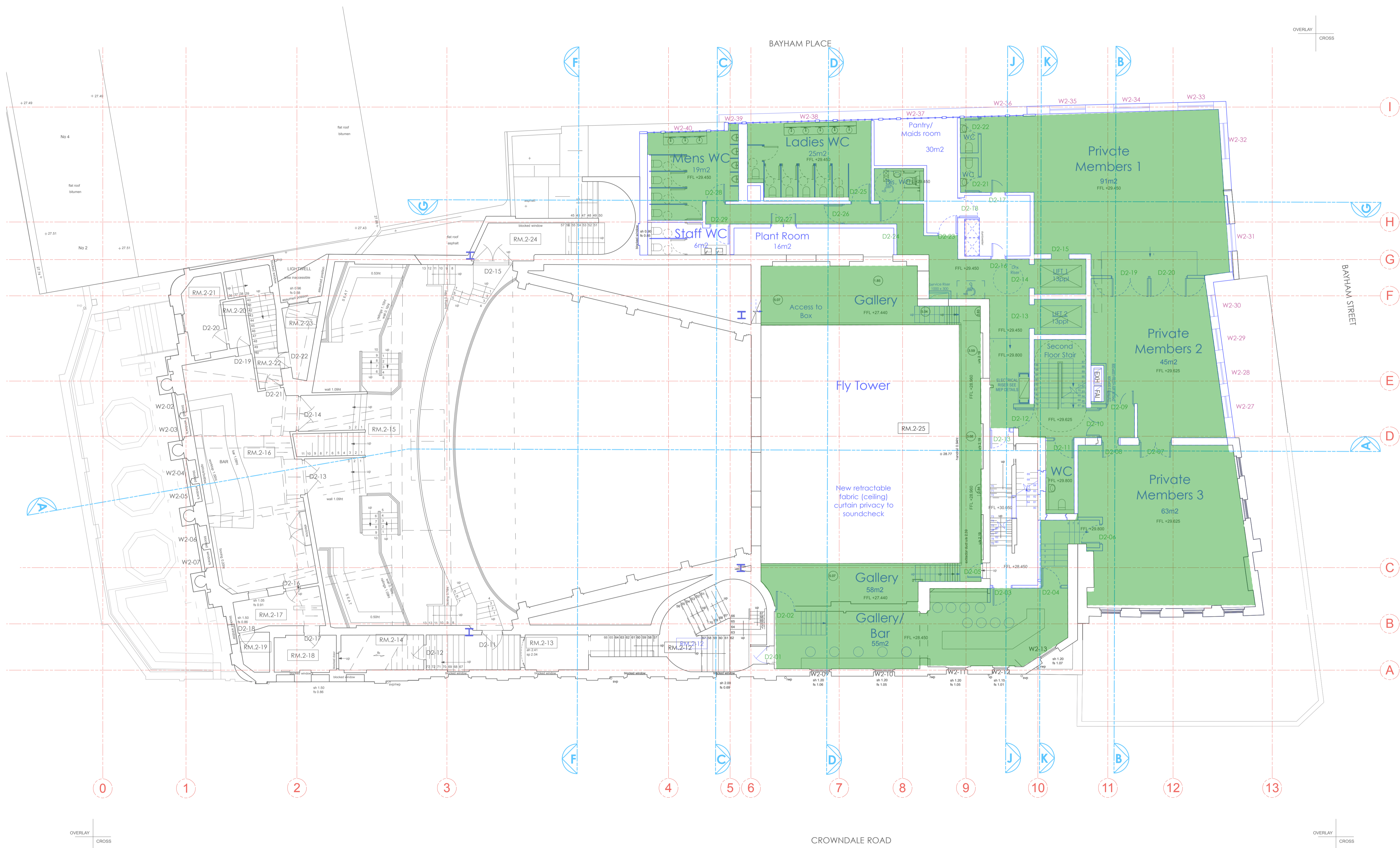

LEGEND

- Management Area - Staff
- Management Area - Koko Users
- Management Area - Private Members
- Management Area - Public Users
- Management Area - Artists

18.10.17

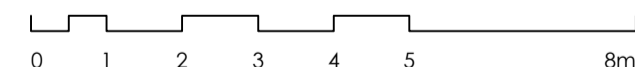
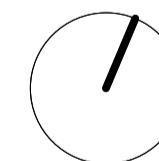

PLANNING

Archer Humphryes Architects

Basement  
Central House  
142 Central Street  
London, United Kingdom  
EC1V 8AR  
T: +44 (0) 20 7251 8555

project title		KOKO + Hope & Anchor + Bayham Place Camden, London	
drawing title	scale	date	
Proposed Second Floor Plan Management - Private Members	1:100 @ A1	18.10.17	
drawing number	drawn	checked	revision
AHA/KKG/GA/014C	FR/PC	DA	-



Copyright: All rights reserved. This drawing must not be reproduced without permission.

Only the original drawing should be relied upon. Contractors, subcontractors and suppliers must verify all dimensions on site before commencing any work or making any shop drawings.

All shop drawings to be submitted to the architect for comment prior to fabrication.

This drawing is to be read in conjunction with the Architect's specification, bills of quantities / schedules, structural, mechanical & electrical drawings and all discrepancies are to be reported to the architect.

Do not scale from this drawing. Dimensions are in millimetres unless otherwise stated.

revision / date / amendments

- / - / -

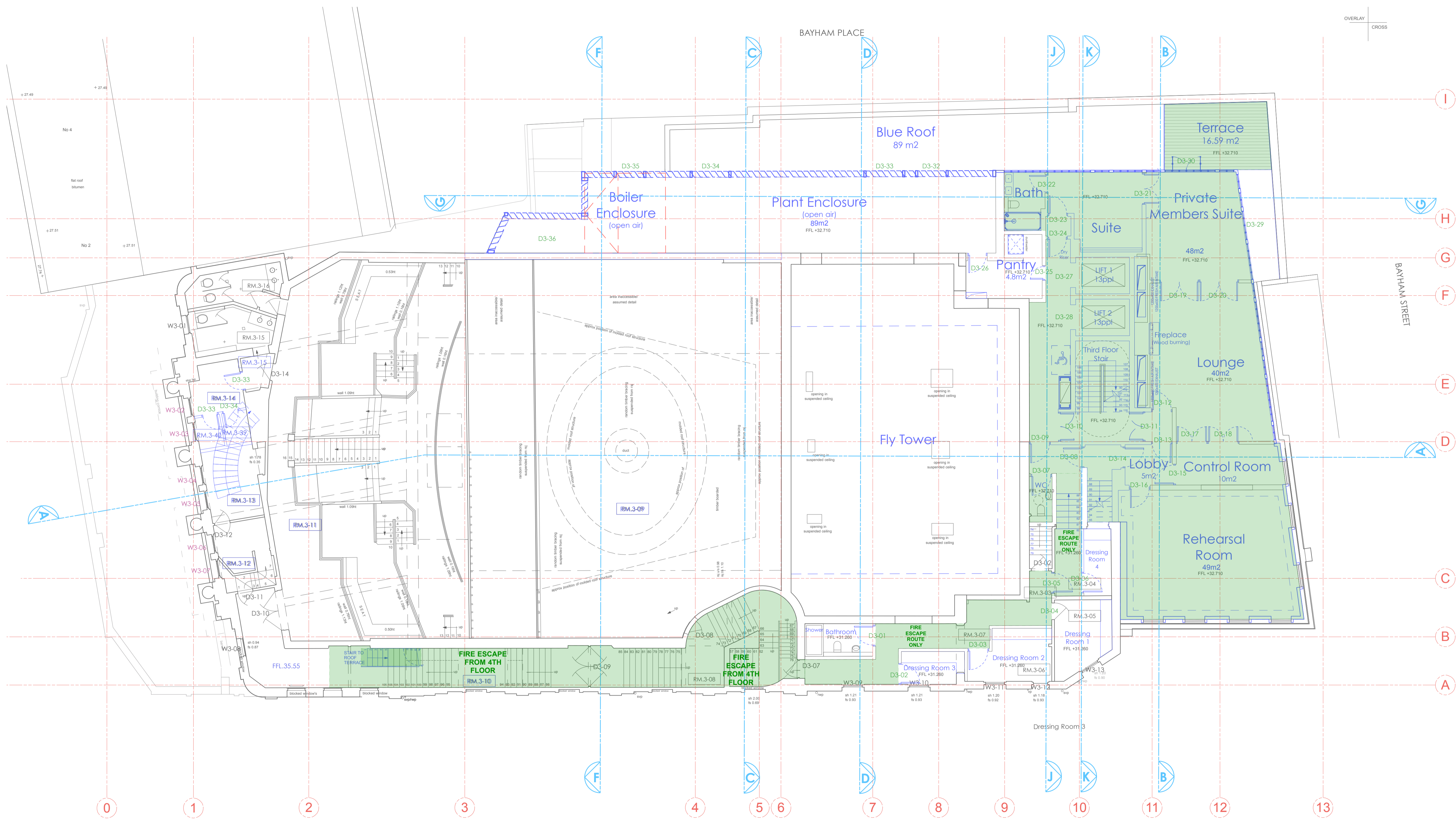

LEGEND

- Management Area - Staff
- Management Area - Koko Users
- Management Area - Private Members
- Management Area - Public Users
- Management Area - Artists

18.10.17

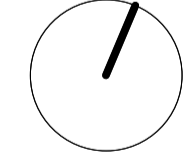

PLANNING

Archer Humphryes Architects

Basement  
 Central House  
 142 Central Street  
 London, United Kingdom  
 EC1V 8AR  
 T: +44 (0) 20 7251 8555

project title	
KOKO + Hope & Anchor + Bayham Place Camden, London	
drawing title	scale / date
Proposed Third Floor Plan Management - Private Members	1:100 @ A1 18.10.17 drawn / checked FR/PC DA
drawing number	revision
AHA/KKG/GA/015C	-

CROWDALE ROAD

BAYHAM STREET

BAYHAM PLACE

OVERLAY CROSS

OVERLAY CROSS