

Copyright: All rights reserved. This drawing must not be reproduced without permission.  
 Only the original drawing should be relied upon. Contractors, subcontractors and suppliers must verify all dimensions on site before commencing any work or making any stop drawings.  
 All shop drawings to be submitted to the architect for comment prior to fabrication.  
 This drawing is to be read in conjunction with the Architect's specification, bills of quantities / schedules, structural, mechanical & electrical drawings and all discrepancies are to be reported to the architect.  
 Do not scale from this drawing. Dimensions are in millimetres unless otherwise stated.

revision / date / amendments  
 - / - / - / -

4.2m

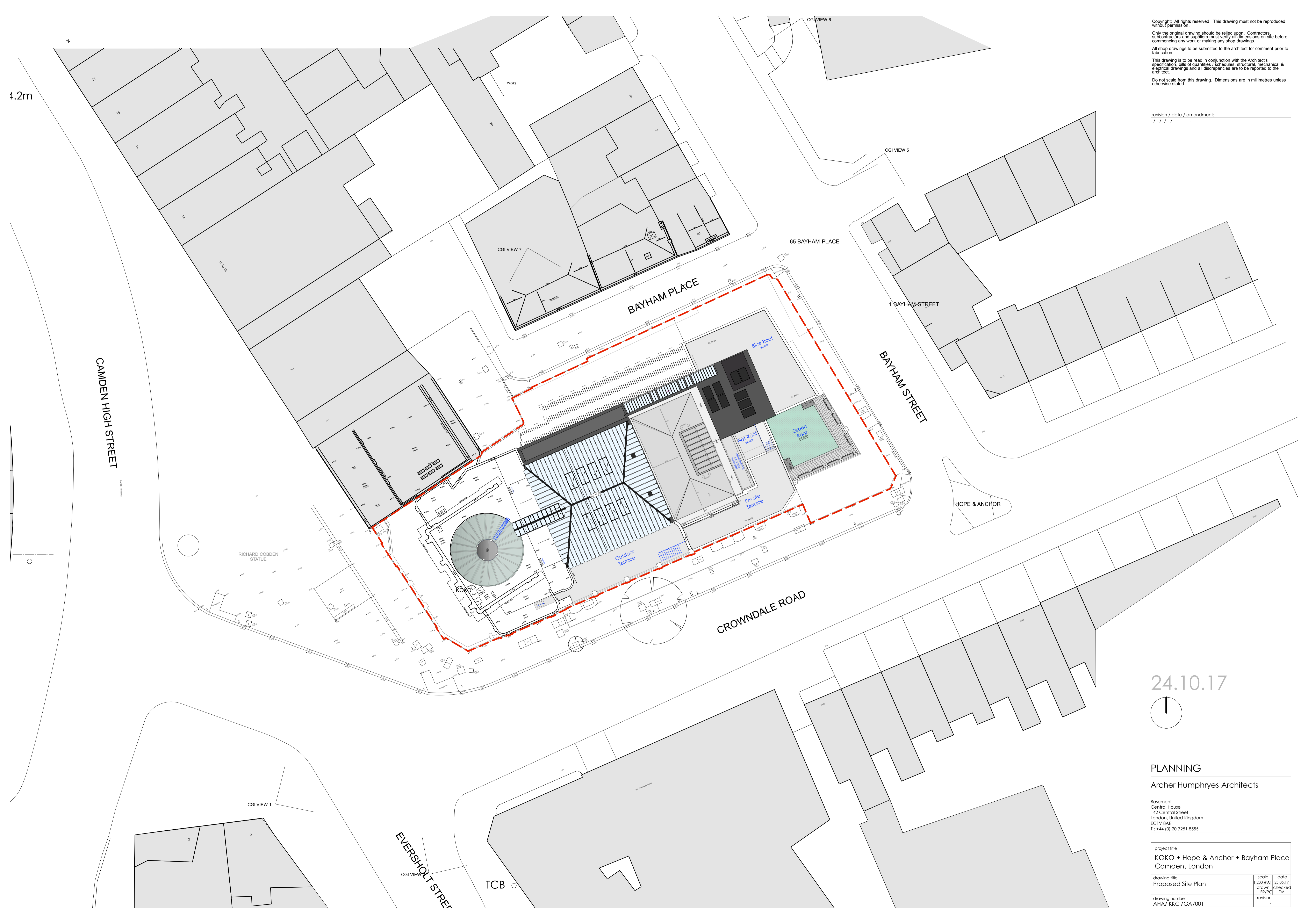

24.10.17

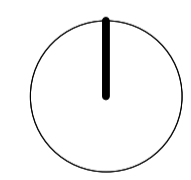

**PLANNING**

Archer Humphryes Architects

Basement  
 Central House  
 142 Central Street  
 London, United Kingdom  
 EC1V 8AR  
 T: +44 (0) 20 7251 8555

project title	
KOKO + Hope & Anchor + Bayham Place Camden, London	
drawing title	scale   date
Proposed Site Plan	1:200 @ A1   25.05.17
drawing number	drawn   checked
AHA/KKC/GA/001	FR/PC   DA
	revision
	-

RICHARD COBDEN  
 STATUE

HOPE & ANCHOR

TCB