

Copyright: All rights reserved. This drawing must not be reproduced without permission.
 Only the original drawing should be relied upon. Contractors, subcontractors and suppliers must verify all dimensions on site before commencing any work or making any shop drawings.
 All shop drawings to be submitted to the architect for comment prior to fabrication.
 This drawing is to be read in conjunction with the Architect's specification, bills of quantities / schedules, structural, mechanical & electrical drawings and all discrepancies are to be reported to the architect.

revision / date / amendments
 A / 24/10/17 / -Window numbers updated

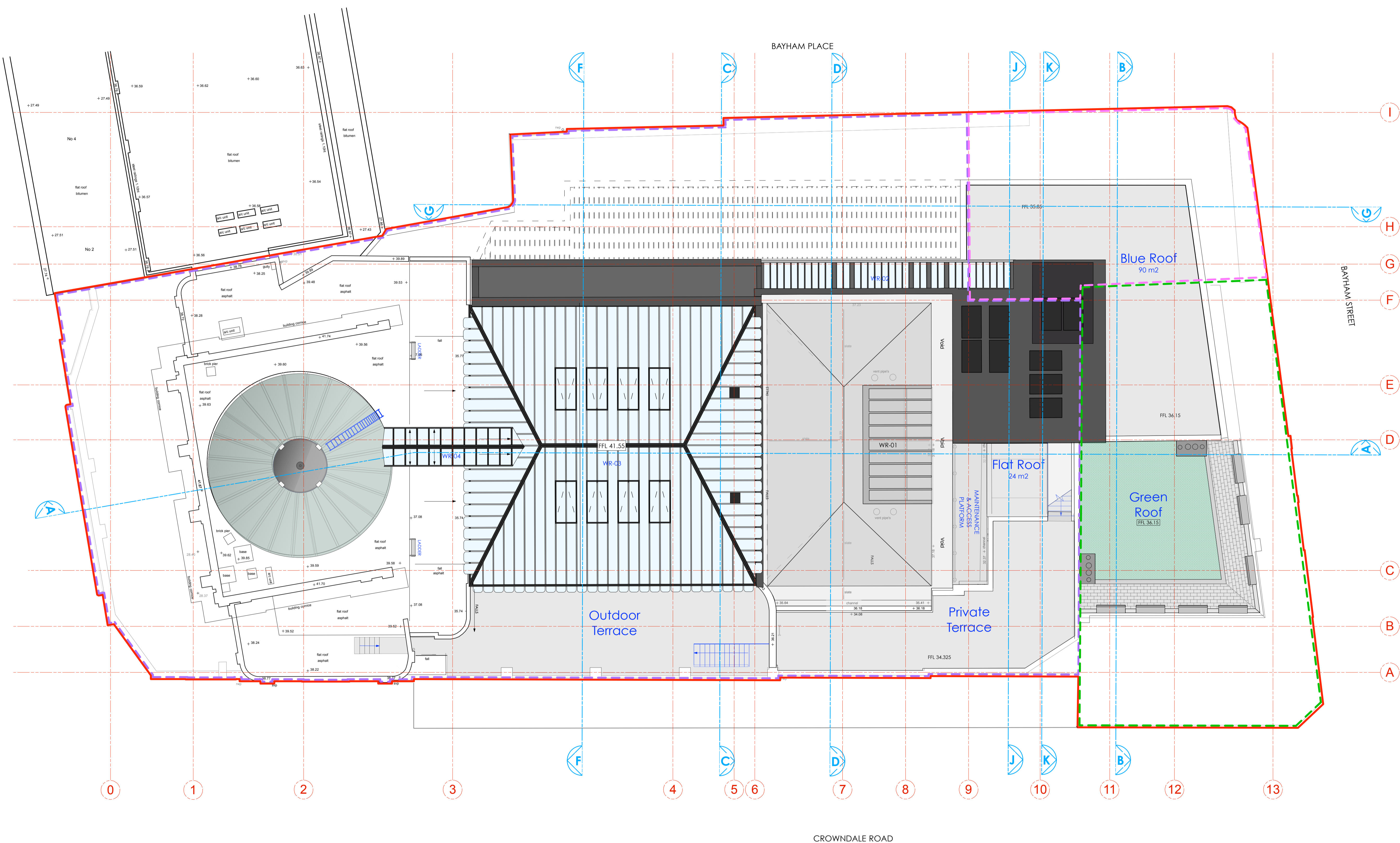
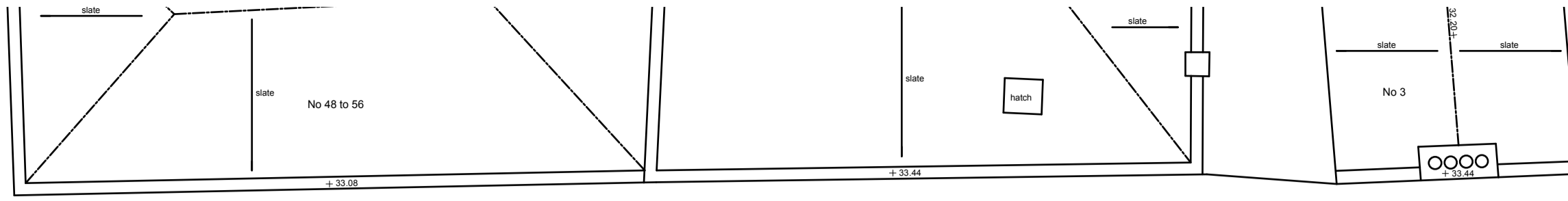

- LEGEND**
- Proposed Works
 - Existing Building Fabric KOKO née Camden Palace Theatre (1900)
 - Existing Building Fabric Hope & Anchor (approx. 1850)
 - Existing Building Fabric Bayham Place (from 1875)
 - Existing Modern Building Fabric Bayham Place (from 2006)
 - Building Fabric to be demolished
 - Demolition of Flooring / Elevation / Wall
 - Proposed Excavation
 - Remove and retain in alternate location
 - Retain and protect existing
 - Retain, make good, ease and adjusted
 - Means of escape Route
 - Private Members Route
 - Koko Customer Route
 - Public Route
 - Artist Route
 - Proposed Riser
 - Proposed Risers Above
 - RM.4-06 Room Number
 - D4-02 Door Number
 - W4-05 Window Number
 - Hope & Anchor Demise
 - Koko Demise
 - 1 Bayham Street & 65 Bayham Place Demise
 - Blue Roof

24.10.17

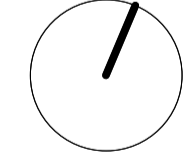

PLANNING

Archer Humphryes Architects

Basement
 Central House
 142 Central Street
 London, United Kingdom
 EC1V 8AR
 T: +44 (0) 20 7251 8555

project title		KOKO + Hope & Anchor + Bayham Place Camden, London	
drawing title	scale	date	
Proposed Roof Plan	1:100 @ A1	26.05.17	
drawing number	drawn	checked	
AHA/KKC/GA/105	FR/PC	DA	
	revision		
	A		

CROWDALE ROAD

BAYHAM PLACE

BAYHAM STREET