

revision / date / amendments
- / - / - / -

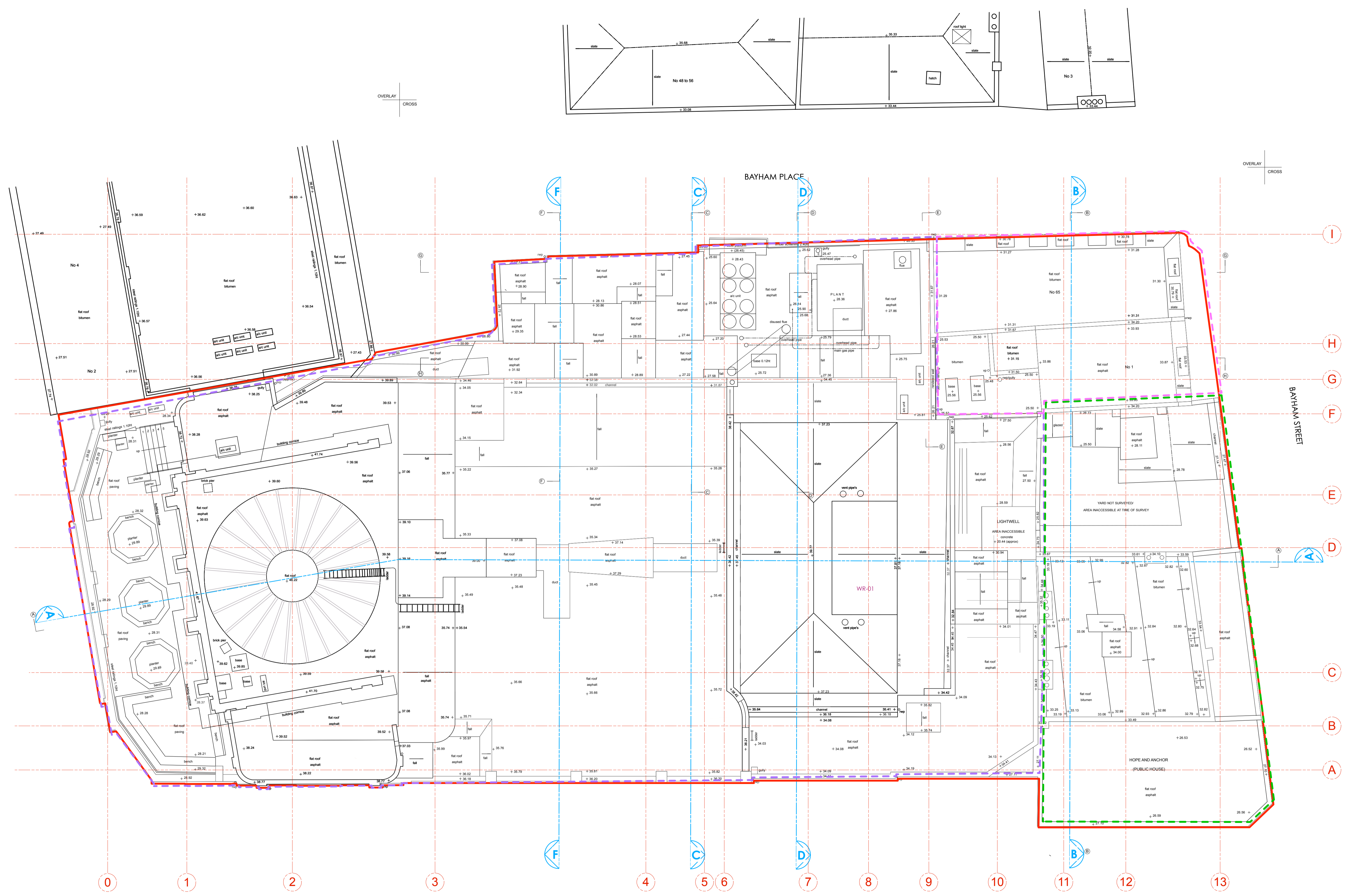

**LEGEND**

- Existing Building Fabric KOKO née Camden Palace Theatre (1900)
- Existing Building Fabric Hope & Anchor (approx. 1850)
- Existing Building Fabric Bayham Place (from 1875)
- Existing Modern Building Fabric Bayham Place (from 2006)

- RM.4-06 Room Number
- D4-02 Door Number
- W4-05 Window Number
- Hope & Anchor Demise
- Koko Demise
- 1 Bayham Street & 65 Bayham Place Demise

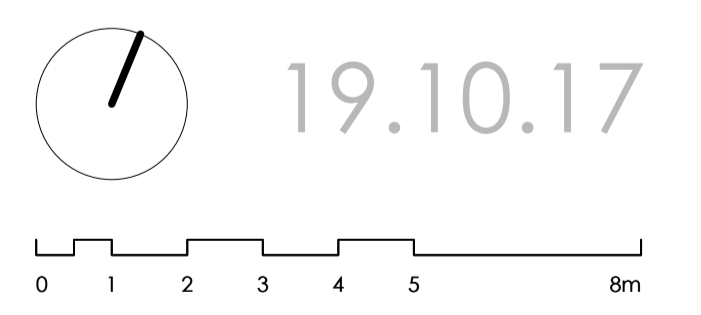

**PLANNING**

Archer Humphryes Architects

Basement  
Central House  
142 Central Street  
London, United Kingdom  
EC1V 8AR  
T: +44 (0) 20 7251 8555

project title	
KOKO + Hope & Anchor + Bayham Place Camden, London	
drawing title	scale date
Existing Roof Plan	1:100 BA1 28.11.14
drawing number	drawn checked
AHA/KKC/GA/105	FR/PC DA
	revision
	-

OVERLAY  
CROSS

CROWDALE ROAD

OVERLAY  
CROSS