

Copyright: All rights reserved. This drawing must not be reproduced without permission.

Only the original drawing should be relied upon. Contractors, subcontractors and suppliers must verify all dimensions on site before commencing any work or making any shop drawings.

All shop drawings to be submitted to the architect for comment prior to fabrication.

This drawing is to be read in conjunction with the Architect's specification, bills of quantities / schedules, structural, mechanical and electrical drawings and all discrepancies are to be reported to the architect.

Do not scale from this drawing. Dimensions are in millimetres unless otherwise stated.

revision / date / amendments
- / - / - / -

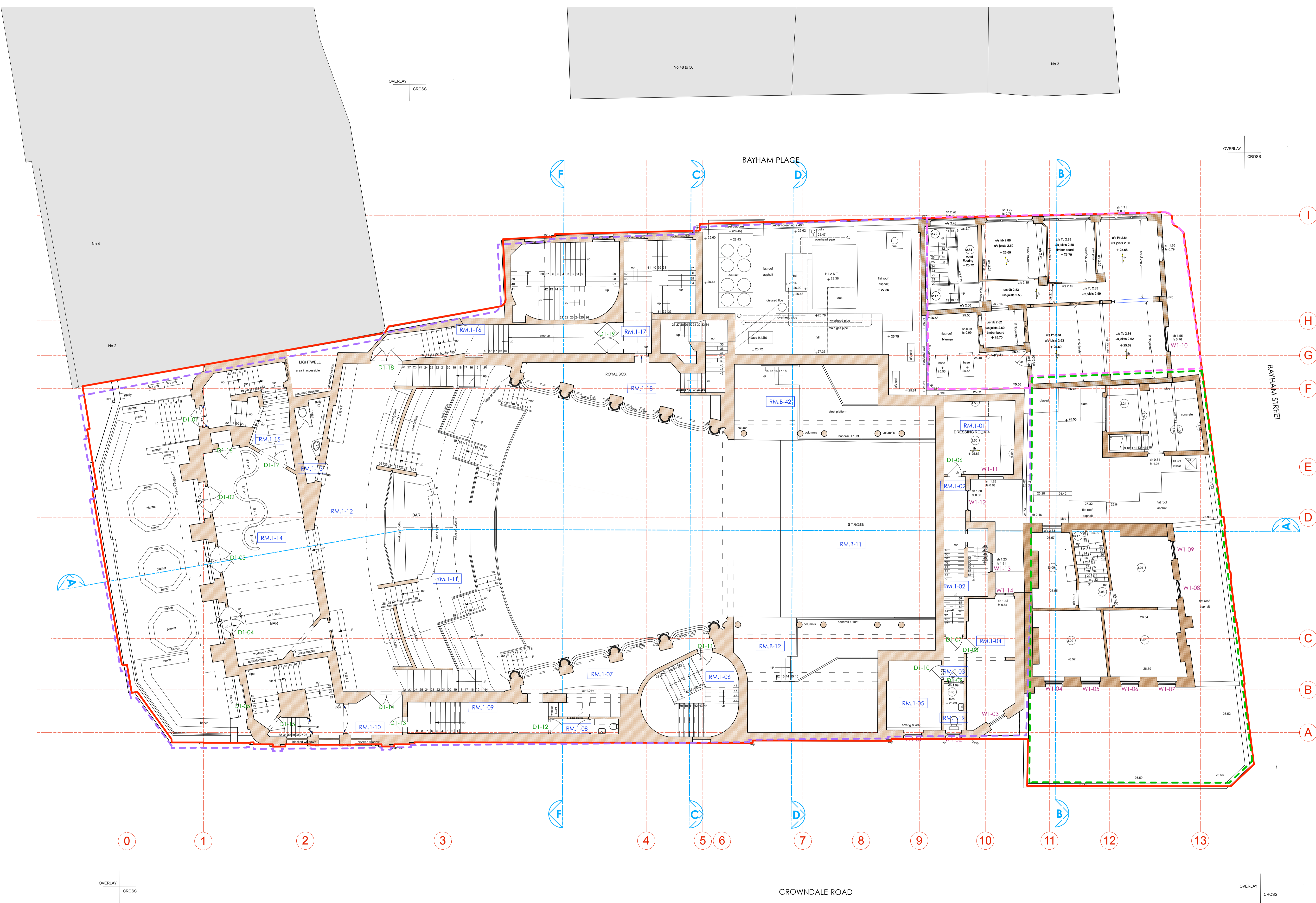

- LEGEND**
- Existing Building Fabric KOKO née Camden Palace Theatre (1900)
 - Existing Building Fabric Hope & Anchor (approx. 1850)
 - Existing Building Fabric Bayham Place (from 1875)
 - Existing Modern Building Fabric Bayham Place (from 2006)
- RM.4-06 Room Number
- D4-02 Door Number
- W4-05 Window Number
- Hope & Anchor Demise
 - Koko Demise
 - 1 Bayham Street & 65 Bayham Place Demise

19.10.17

PLANNING

Archer Humphryes Architects

Basement
Central House
142 Central Street
London, United Kingdom
EC1V 8AR
T: +44 (0) 20 7251 8555

project title	
KOKO + Hope & Anchor + Bayham Place Camden, London	
drawing title	scale / date
Existing First Floor Plan	1:100 BA1 / 28.11.17
drawing number	drawn / checked
AHA/KKQ/GA/101	FR/PC / DA
	revision
	-