

**Section B-B**  
1 : 100

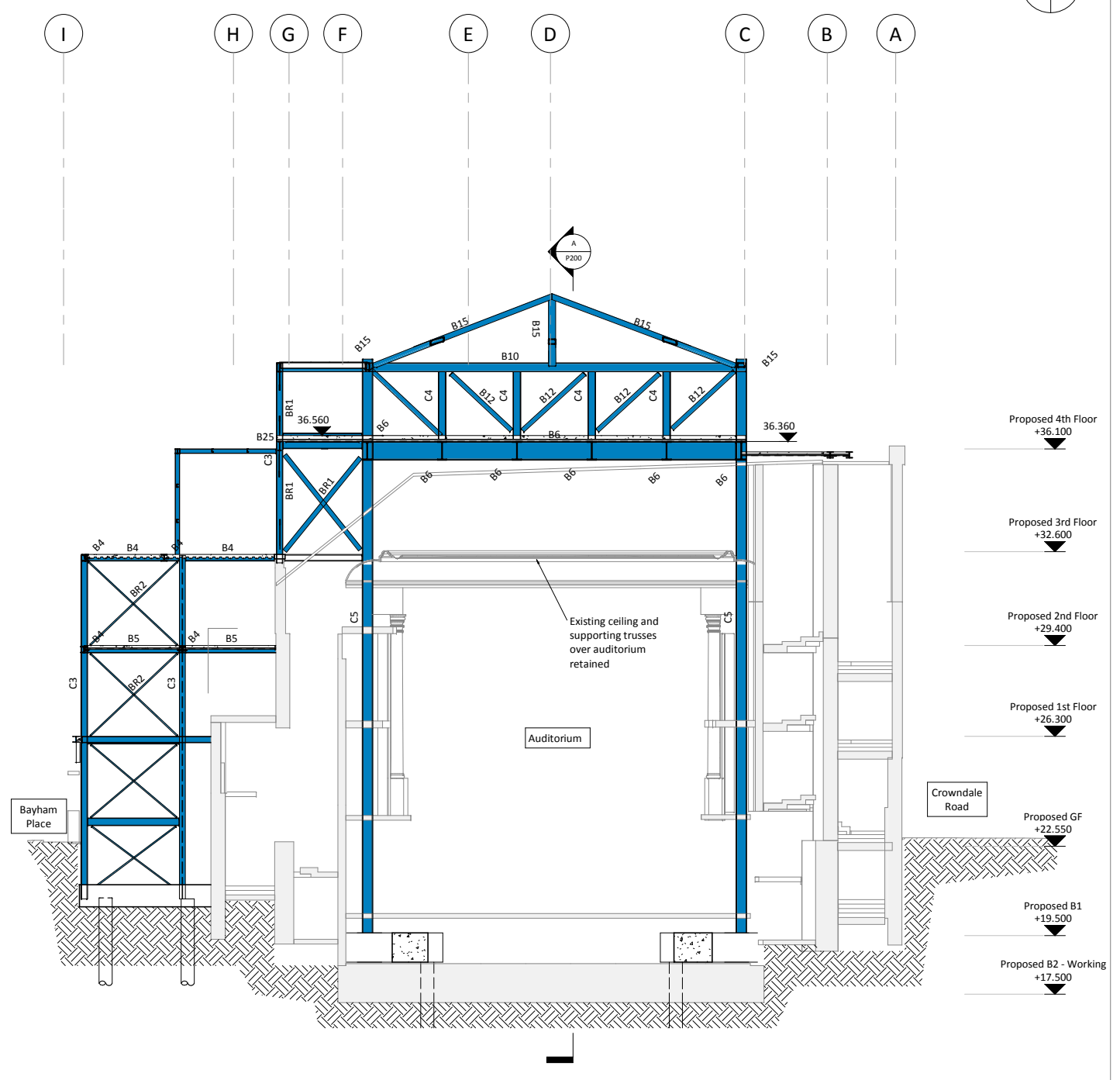

**Section C-C**  
1 : 100

Proposed 4th Floor	+36.100
Proposed 3rd Floor	+32.600
Proposed 2nd Floor	+29.400
Proposed 1st Floor	+26.300
Proposed GF	+22.550
Proposed B1	+19.500
Proposed B2 - Working	+17.500

- This drawing is to be read in conjunction with all relevant architects, engineers and specialists drawings and specifications.
- Do not scale from this drawing in either paper or digital form. Use written dimensions only. To check drawing has been printed to the intended scale the above bar should be 100mm

**Column Schedule**

C2	203x203x46 UC
C3	203x203x86 UC
C4	254x254x89 UC
C5	356x368x153 UC
C6	250x150x14.2 RHS
C7	203x203x52 UC
C8	152x152x30 UC
C9	cranked column
C10	152x152x23 UC

Truss T1 formed with B24 to members with 30mm dia Macalloy ties

**Beam Schedule**

B1	203x203x46 UC + 200x100x10 UA
B2	203x203x60 UC + 150x90x10 UA
B3	406x178x67 UB
B4	203x203x86 UC + 150x90x10 UA
B5	254x254x89 UC + 200x100x10 UA
B6	610x305x238 UB
B7	203x203x46 UC
B8	203x203x86 UC
B9	254x254x107 UC + 200x100x10 UA
B10	305x305x97 UC
B11	533x210x92 UB
B12	150x150x10 SHS
B13	305 UC137 + 200x100x10 UA
B14	305x305x137 UC + 200x100x10 UA
B15	250x150x14.2 RHS
B16	200x90x30 PFC
B17	457x191 UB89 + 150x90x10 UA
B18	533x210 UB92 + 150x90x10 UA
B19	533x210 UB109 + 150x90x10 UA
B20	200x150x10.0 RHS
B21	203x203x52 UC
B22	406x178x60 UB
B23	356x171 UB45
B24	300x100x12.0 RHS
B25	305x102x28 UB
B26	254x102x25 UB
B27	254x102 UB25
B28	203x102 UB23
B29	305 UC118 + 200x100x10 UA
B30	356x171 UB51 + 150x90x10 UA
B31	305x102 UB28 + 150x90x10 UA
B32	400x150x12.0 RHS
B33	152x152x23 UC
B34	203x102x23 UB
B35	254x254x89 UC
BR1	150 x 10 MS plate cross-brace
BR2	45mm macalloy bar
BR3	30mm macalloy bar
EA1	100x100x10 EA fixed to perimeter
PG01	550 dp x 350 wd plate girder

**Floor Legend**

RC Slab	1 130 thk profiled LWC slab on TATA Comflor 60 1.0 mm gauge deck with A193 mesh top and 1 no. H16 bar per trough
Profiled metal deck	2 200 thk profiled NWC slab on TATA Comflor 60 1.0 mm gauge deck with A193 mesh top and 1 no. H16 bar per trough
Timber floor	4 200 d x 50 w C24 joists at 400 crs with 18 thk plywood screwed to top face
	5 200 thk RC slab
	6 300 thk RC slab
	7 250 thk RC slab
	8 700 thk WRC slab

\* Indicates angle welded to web of beam. Size indicated in table above

**Detail Key**

	Proposed RC structure
	Proposed Steel Framing
	PSx - 450lg x 150wd x 150dp MC padstone
	Connection Strengthening
	Moment connection
	Pre-camber
	C Crank
	S Splice
	TB Thermal Break
	BR Break in beam

**HEYNE TILLET STEEL** STRUCTURAL ENGINEERS  
hts.uk.com

Job Name  
**The Hope Project**

Drawing Title  
**Proposed Overall Sections B-B and C-C**

P2	27.10.17	JH	AC	PLANNING
P1	01.09.17	SLS	AC	Preliminary Issue
Rev	Date	By	Eng	Amendments

Purpose of Issue **Preliminary** Scale at A1 **1 : 100**

Drg No **1444 / P201** Rev **P2**

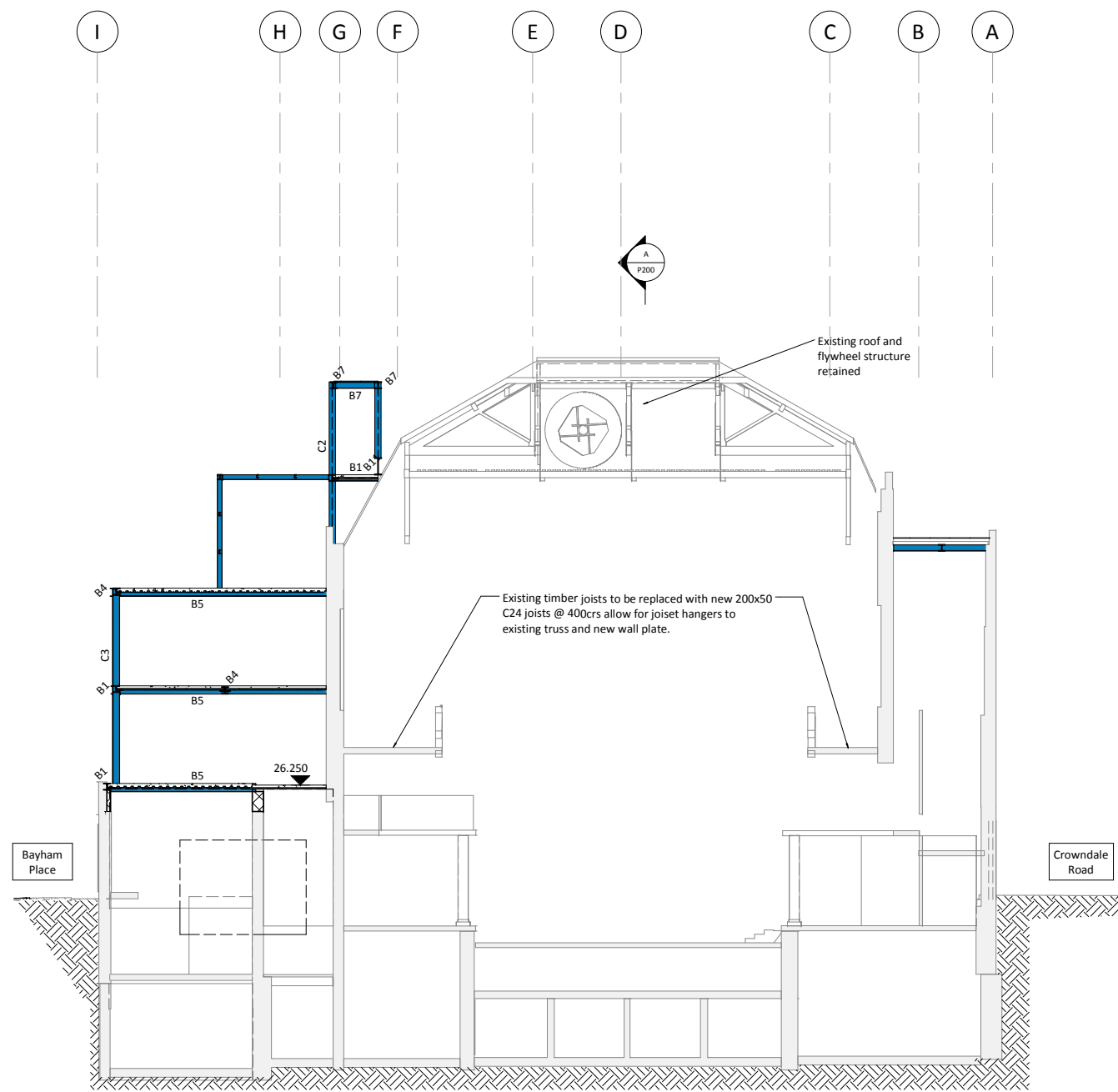
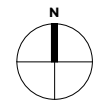

**Section D-D**  
1 : 100

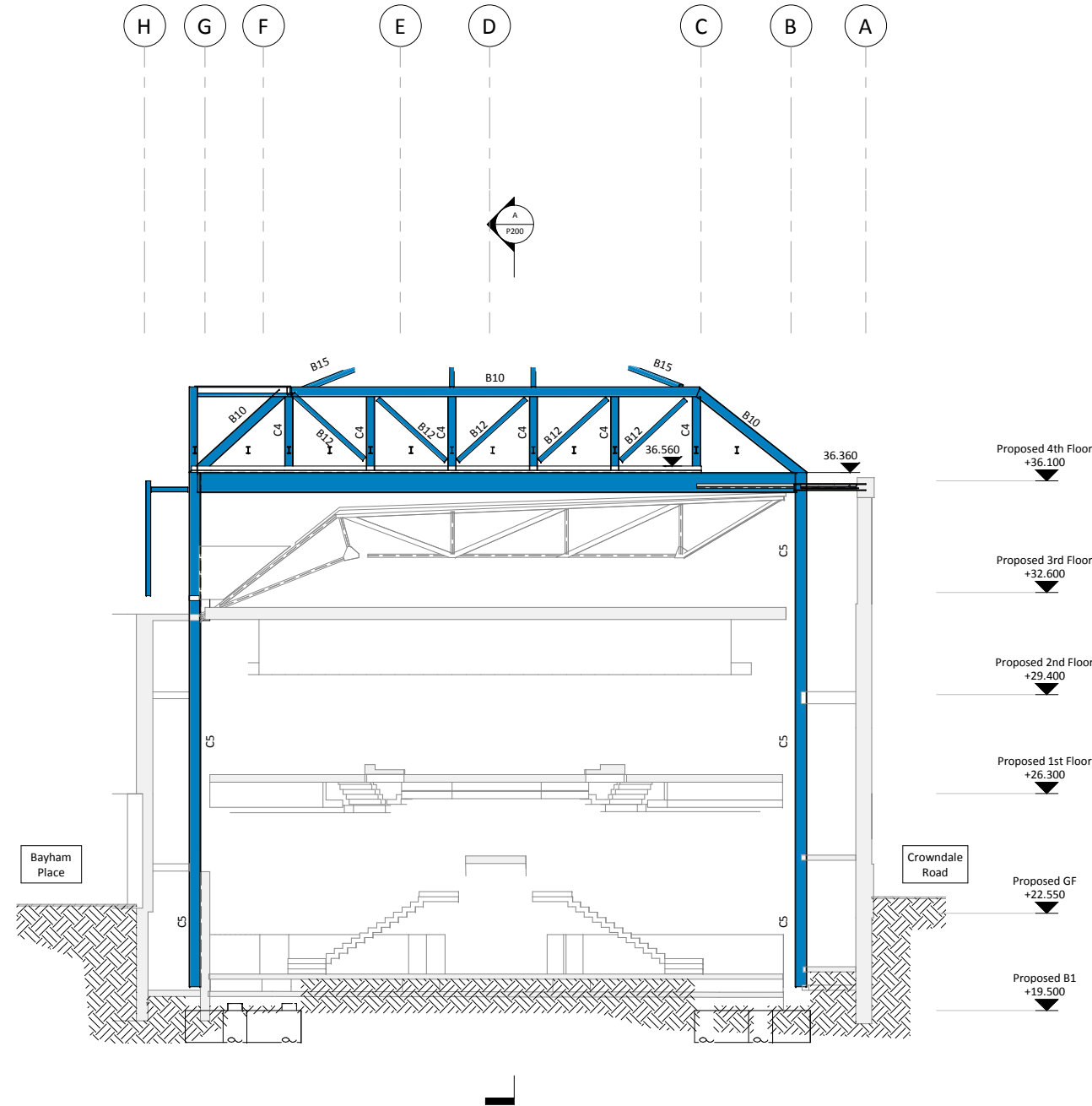

**Section E-E**  
1 : 100

1 This drawing is to be read in conjunction with all relevant architects, engineers and specialists drawings and specifications.

2 Do not scale from this drawing in either paper or digital form. Use written dimensions only. To check drawing has been printed to the intended scale the above bar should be 100mm

Column Schedule	Beam Schedule
C2 203x203x46 UC	B1 203x203x46 UC + 200x100x10 UA
C3 203x203x86 UC	B2 203x203x60 UC + 150x90x10 UA
C4 254x254x89 UC	B3 406x178x67 UB
C5 356x368x153 UC	B4 203x203x86 UC + 150x90x10 UA
C6 250x150x14.2 RHS	B5 254x254x89 UC + 200x100x10 UA
C7 203x203x52 UC	B6 610x305x238 UB
C8 152x152x30 UC	B7 203x203x46 UC
C9 cranked column	B8 203x203x86 UC
C10 152x152x23 UC	B9 254x254x107 UC + 200x100x10 UA

Truss T1 formed with B24 to members with 30mm dia Macalloy ties

B10 305x305x97 UC	B14 305x305x137 UC + 200x100x10 UA	B28 203x102 UB23
B11 533x210x92 UB	B15 250x150x14.2 RHS	B29 305 UC118 + 200x100x10 UA
B12 150x150x10 SHS	B16 200x90x30 PFC	B30 356x171 UB51 + 150x90x10 UA
B13 305 UC137 + 200x100x10 UA	B17 457x191 UB89 + 150x90x10 UA	B31 305x102 UB28 + 150x90x10 UA
	B18 533x210 UB92 + 150x90x10 UA	B32 400x150x12.0 RHS
	B19 533x210 UB109 + 150x90x10 UA	B33 152x152x23 UC
	B20 200x150x10.0 RHS	B34 203x102x23 UB
	B21 203x203x52 UC	B35 254x254x89 UC
	B22 406x178x60 UB	BR1 150 x 10 MS plate cross-brace
	B23 356x171 UB45	BR2 45mm macalloy bar
	B24 300x100x12.0 RHS	BR3 30mm macalloy bar
	B25 305x102x28 UB	EA1 100x100x10 EA fixed to perimeter
	B26 254x102x25 UB	PG01 550 dp x 350 wd plate girder
	B27 254x102 UB25	

**Floor Legend**

RC Slab	1 130 thk profiled LWC slab on TATA Comflor 60 1.0 mm gauge deck with A193 mesh top and 1 no. H16 bar per trough
Profiled metal deck	2 200 thk profiled NWC slab on TATA Comflor 60 1.0 mm gauge deck with A193 mesh top and 1 no. H16 bar per trough
Timber floor	4 200 d x 50 w C24 joists at 400 crs with 18 thk plywood screwed to top face
	5 200 thk RC slab
	6 300 thk RC slab
	7 250 thk RC slab
	8 700 thk WRC slab

\* Indicates angle welded to web of beam. Size indicated in table above

**Detail Key**

Proposed RC structure	PSx	PS1 - 450lg x 150wd x 150dp MC padstone
Proposed Steel Framing	ST	Connection Strengthening
	M	Moment connection
	B1 [25mm]	Pre-camber
	C	Crank
	S	Splice
	TB	Thermal Break
	BR	Break in beam

Rev	Date	By	Eng	Amendments
P2	27.10.17	JH	AC	PLANNING
P1	01.09.17	SLS	AC	Preliminary Issue



STRUCTURAL ENGINEERS

hts.uk.com

Job Name  
**The Hope Project**

Drawing Title  
**Proposed Overall Sections D-D and E-E**

Purpose of Issue **Preliminary** Scale at A1 **1 : 100**

Drg No **1444 / P202** Rev **P2**

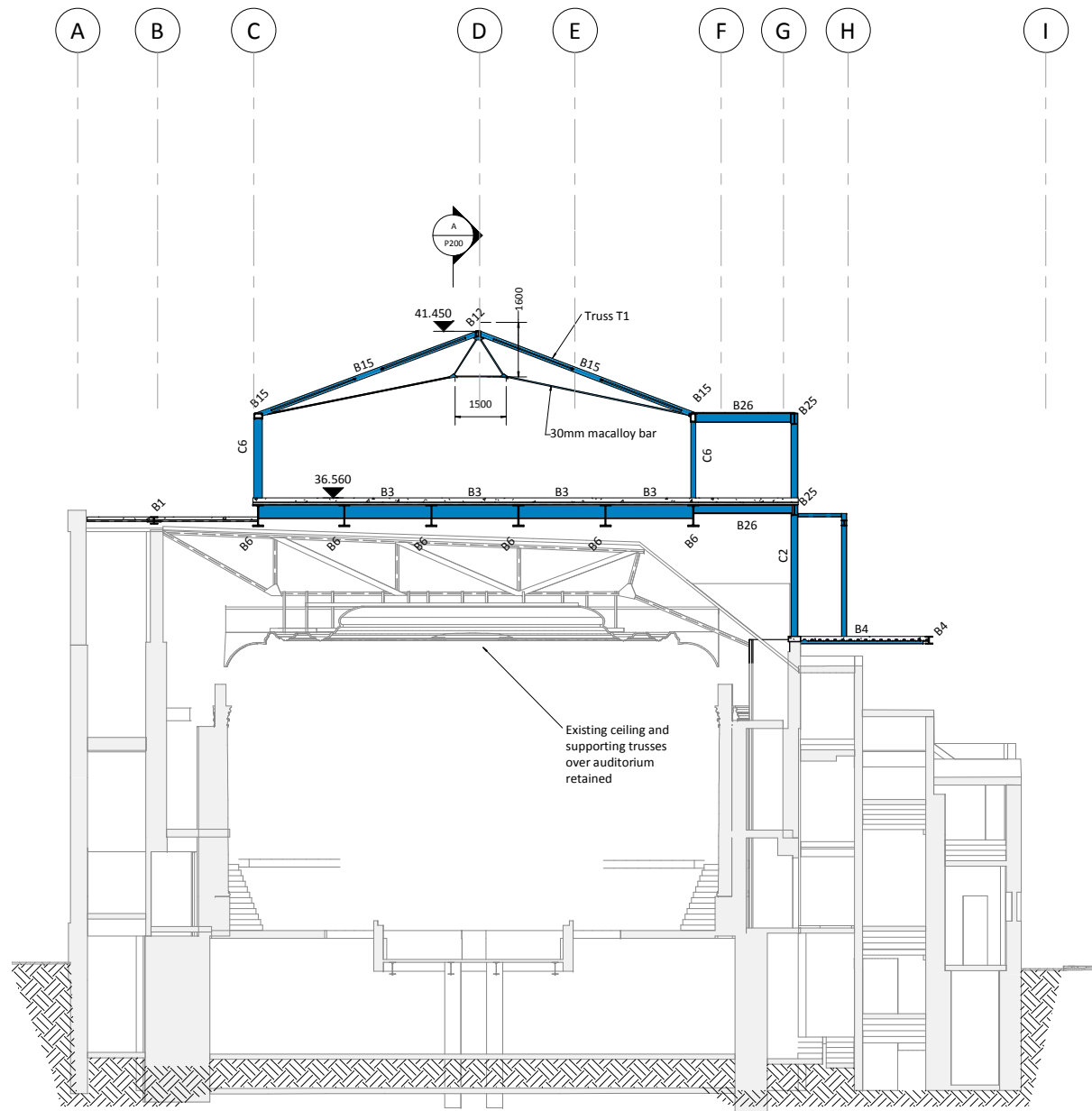
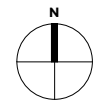

**Section F-F**  
1 : 100

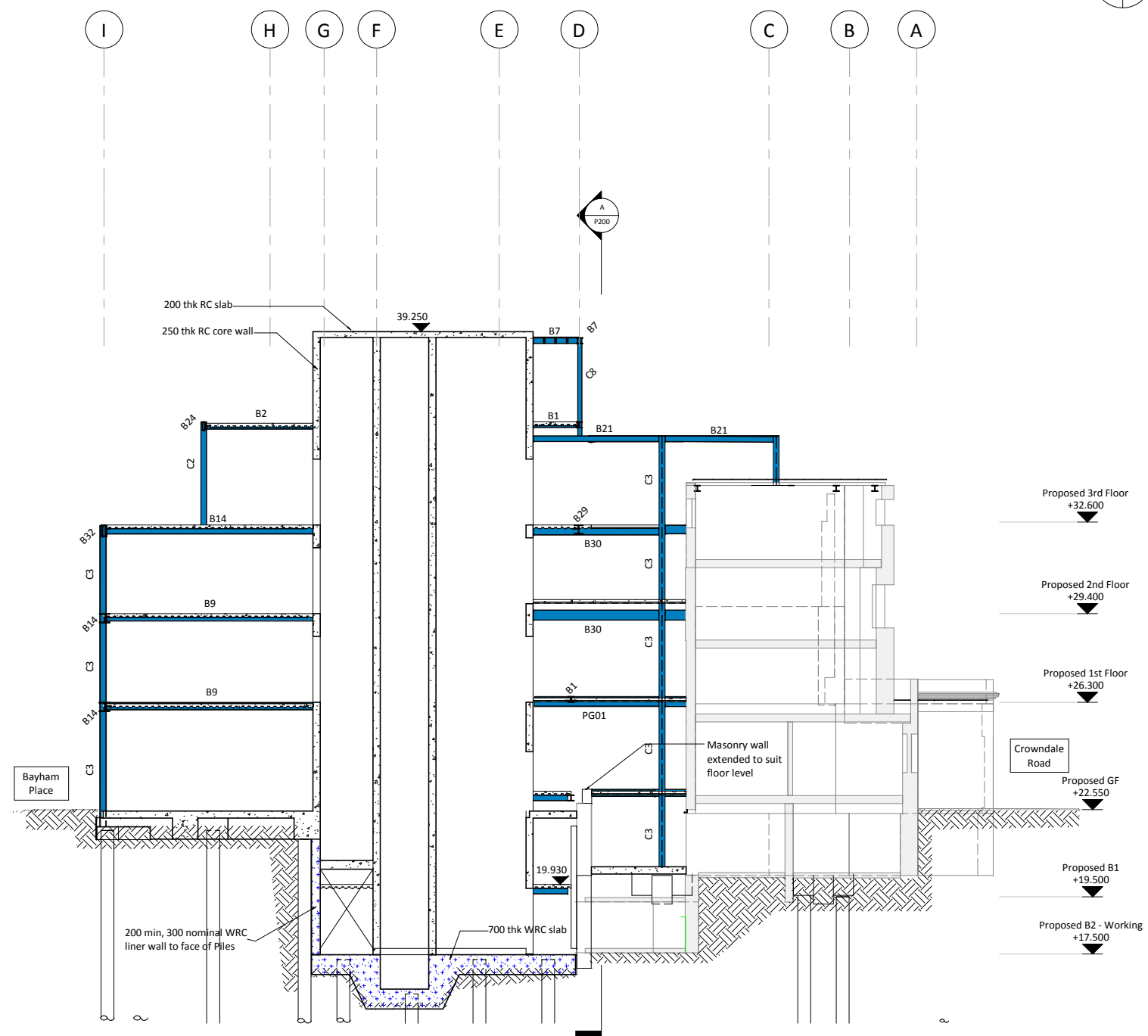

**Section G-G**  
1 : 100

**Column Schedule**

C2	203x203x46 UC
C3	203x203x86 UC
C4	254x254x89 UC
C5	356x368x153 UC
C6	250x150x14.2 RHS
C7	203x203x52 UC
C8	152x152x30 UC
C9	cranked column
C10	152x152x23 UC

Truss T1 formed with B24 to members with 30mm dia Macalloy ties

**Beam Schedule**

B1	203x203x46 UC + 200x100x10 UA
B2	203x203x60 UC + 150x90x10 UA
B3	406x178x67 UB
B4	203x203x86 UC + 150x90x10 UA
B5	254x254x89 UC + 200x100x10 UA
B6	610x305x238 UB
B7	203x203x46 UC
B8	203x203x86 UC
B9	254x254x107 UC + 200x100x10 UA
B10	305x305x97 UC
B11	533x210x92 UB
B12	150x150x10 SHS
B13	305 UC137 + 200x100x10 UA
B14	305x305x137 UC + 200x100x10 UA
B15	250x150x14.2 RHS
B16	200x90x30 PFC
B17	457x191 UB89 + 150x90x10 UA
B18	533x210 UB92 + 150x90x10 UA
B19	533x210 UB109 + 150x90x10 UA
B20	200x150x10.0 RHS
B21	203x203x52 UC
B22	406x178x60 UB
B23	356x171 UB45
B24	300x100x12.0 RHS
B25	305x102x28 UB
B26	254x102x25 UB
B27	254x102 UB25
B28	203x102 UB23
B29	305 UC118 + 200x100x10 UA
B30	356x171 UB51 + 150x90x10 UA
B31	305x102 UB28 + 150x90x10 UA
B32	400x150x12.0 RHS
B33	152x152x23 UC
B34	203x102x23 UB
B35	254x254x89 UC
BR1	150 x 10 MS plate cross-brace
BR2	45mm macalloy bar
BR3	30mm macalloy bar
EA1	100x100x10 EA fixed to perimeter
PG01	550 dp x 350 wd plate girder

**Floor Legend**

RC Slab	1	130 thk profiled LWC slab on TATA Comflor 60 1.0 mm gauge deck with A193 mesh top and 1 no. H16 bar per trough
Profiled metal deck	2	200 thk profiled NWC slab on TATA Comflor 60 1.0 mm gauge deck with A193 mesh top and 1 no. H16 bar per trough
Timber floor	4	200 d x 50 w C24 joists at 400 crs with 18 thk plywood screwed to top face
	5	200 thk RC slab
	6	300 thk RC slab
	7	250 thk RC slab
	8	700 thk WRC slab

\* Indicates angle welded to web of beam. Size indicated in table above

**Detail Key**

Proposed RC structure	PSx	PS1 - 450lg x 150wd x 150dp MC padstone
Proposed Steel Framing	ST	Connection Strengthening
	C	Crank
	S	Splice
	TB	Thermal Break
	BR	Break in beam
	M	Moment connection
	B1 [25mm]	Pre-camber

1 This drawing is to be read in conjunction with all relevant architects, engineers and specialists drawings and specifications.

2 Do not scale from this drawing in either paper or digital form. Use written dimensions only. To check drawing has been printed to the intended scale the above bar should be 100mm

Job Name  
**The Hope Project**

Drawing Title  
**Proposed Overall Section F-F and G-G**

P2	27.10.17	JH	AC	PLANNING
P1	01.09.17	SLS	AC	Preliminary Issue
Rev	Date	By	Eng	Amendments

# Appendix B

Historic Maps



Published 1870-1873



Published 1876-1879



Published 1896



Published 1916



Published 1951-1952



Published 1952



Published 1961-1964



Published 1961-1972



Published 1971



Published 1986-1991



Published 1991-1995



Published 1992-1994