

■ Elements to be adjusted

Lath and plaster ceiling and non-original cornice to be removed locally to allow for installation of shutter boxes.

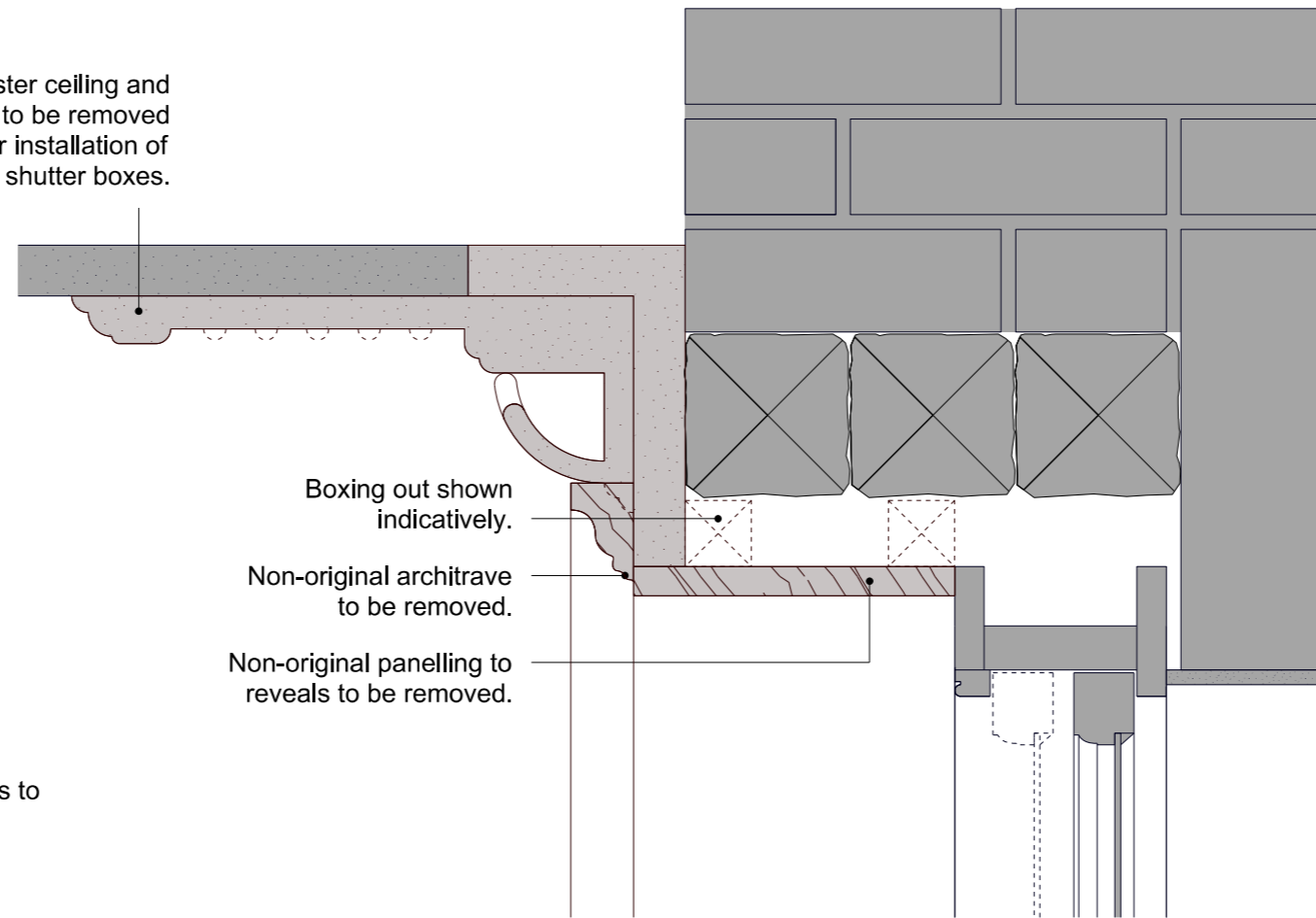

Boxing out shown indicatively.

Non-original architrave to be removed.

Non-original panelling to reveals to be removed.

Sash windows to be retained.

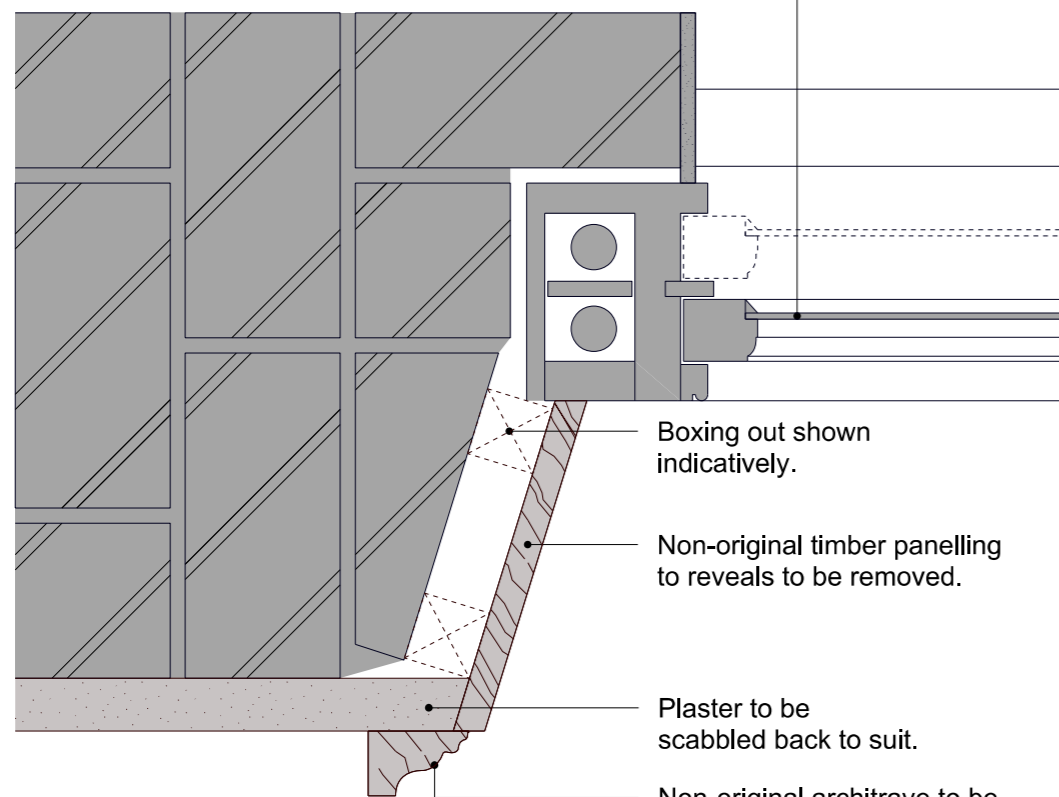

Boxing out shown indicatively.

Non-original timber panelling to reveals to be removed.

Plaster to be scabbled back to suit.

Non-original architrave to be removed.

Sash windows to be retained.

Original window apron to be removed, retained, repaired and reinstated.

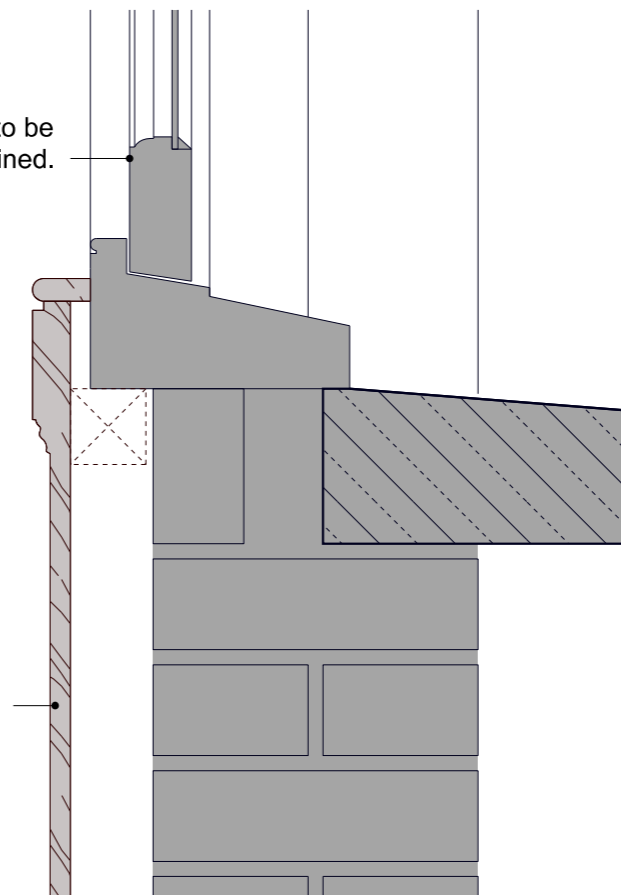

Any discrepancies should be reported immediately to the architect. If in doubt ask. This drawing is copyright of the Architect.

Drawing Status:

Planning

Revision	Date

**prewett
bizley
architects**

118a London Wall London EC2Y 5JA 020 7256 2195
rp@prewettbizley.com www.prewettbizley.com

Project
**42 Doughty Street
London
WC1N 2LF**

Drawing
**Existing First Floor
Rear Window Details**

Scale
1:5 @ A3

Date
**October
2017**

Dwg. no.
145 S 156

Revision