

STATUTORY STATUS	
LISTED	NO
CONSERVATION	YES

	Old Customer		New Customer		Existing Back Office		New Back Office		Other Bank Area		Customer Gain		Internal Area	
	(m <sup>2</sup> )	(ft <sup>2</sup> )	(m <sup>2</sup> )	(ft <sup>2</sup> )	(m <sup>2</sup> )	(ft <sup>2</sup> )	(m <sup>2</sup> )	(ft <sup>2</sup> )	(m <sup>2</sup> )	(ft <sup>2</sup> )	(m <sup>2</sup> )	(ft <sup>2</sup> )	(m <sup>2</sup> )	(ft <sup>2</sup> )
Basement	0	0	57.670	621	0	0	62.460	672	7	75	58	621	127	1368
Ground	0	0	58.000	624	0	0	30.840	332	1	11	58	624	90	967
First	0	0	0	0	0	0	0	0	0	0	0	0	0	0
Second	0	0	0	0	0	0	0	0	0	0	0	0	0	0
Third	0	0	0	0	0	0	0	0	0	0	0	0	0	0
<b>Total Area</b>	<b>0</b>	<b>0</b>	<b>116</b>	<b>1245</b>	<b>0</b>	<b>0</b>	<b>93</b>	<b>1004</b>	<b>8</b>	<b>86</b>	<b>116</b>	<b>1245</b>	<b>217</b>	<b>2335</b>

**Feature Wall Finishes**

- Self Service Wall / ASC Wall / Transaction Area Feature Wall
- Consultation Area Feature Wall
- Counters Area Feature Wall
- Heritage Wall
- Dark Grey Feature Wall
- Dark Blue Feature Wall With Heritage Rail Premier Consultation Room
- Premier Hub Feature Wall

**Furniture Types**

- Open Counter Waiting Visalia Chair
- Customer Chair Panama Chair
- Customer Chair Oslo Meeting Chair
- Customer Chair Kruze or Smith
- Customer Chair PLC Chair
- Customer Chair Toto High-Back
- Customer Chair Toto Low-Back
- Customer Chair Kruze only use with 720mm height Kruze Table
- Customer Chair Hood Chair
- Customer Chair Cross Stool (low)
- Task Chair
- Customer Chair Kruze Chair only use with 720mm height Kruze Table

**NOTE**  
This drawing has been prepared from historical information that cannot be guaranteed accurate. Responsibility is not accepted for errors made by others in scaling from this drawing. All construction information should be taken from figured dimensions only. All dimensions should be checked on site prior to the manufacture of any components.

**HATCHING**

- New Secure partition wall
- New Partition wall
- Book Room Secure wall
- Existing Partition wall
- Structural wall
- Domus Industriak DFDL 04 (600X600mm) ASD Floor Area
- Amitico Spacia SS5S3566 (457X457mm) ASD Floor Area
- Barrier matting
- 2008 Hard Flooring 1200x600
- 2008 Hard Flooring 600x300
- Area not in scope
- Domus Industriak DFDL 06 (600X600mm)
- Amitico Spacia SS5S2594 (457X457mm) Banking Hall

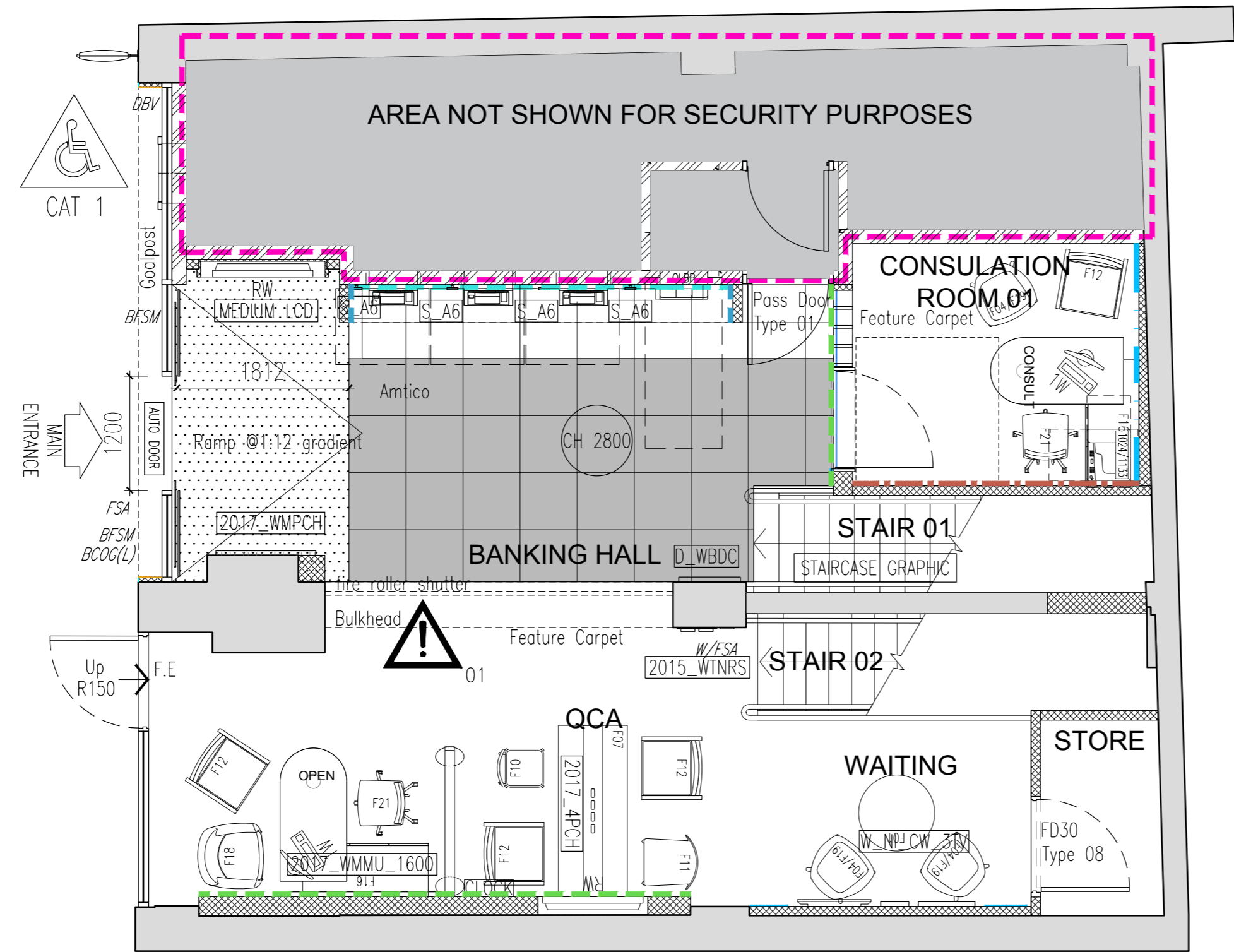

Floor Net Area: 94.0m<sup>2</sup> /1012ft<sup>2</sup>  
 Floor Gross Area: 107.6m<sup>2</sup> /1159ft<sup>2</sup>

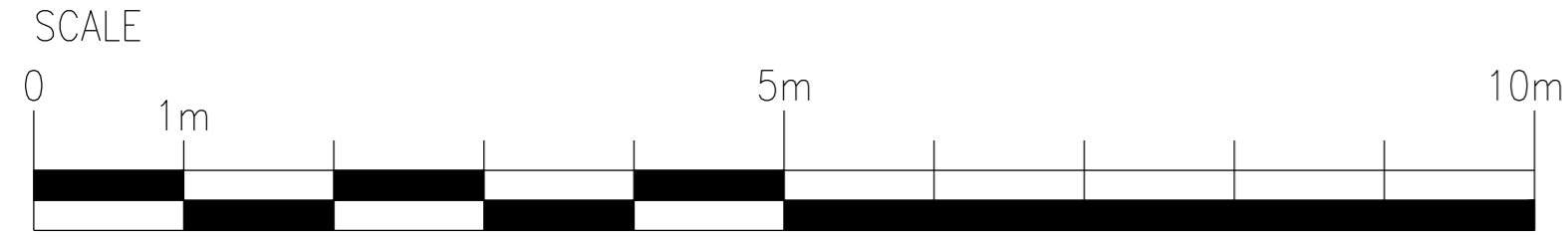

- 01 Fire Shutter to be retained to comply with Building Control
- 02 Cash safe size to be confirmed

27.07.17	C	ICT	-	Layout re-design following clients instruction. Design Review 14/06/2017 Graham Taylor.
17.05.17	B	ICT	-	External ATM and door relocated. Traka box added Design Review 02/05/2017 Graham Taylor / David Smith.
20.04.17	A	ICT	-	Clock, WBDC & Podium added.

**STYLES & WOOD LTD**  
 99 Charterhouse Street  
 London EC1M 6HR  
 t: +44 (0)20 7014 0400  
 www.stylesandwood.co.uk

**Project**  
**TOTTENHAM COURT ROAD**  
 154-155 TOTTENHAM COURT ROAD  
 W1T 7NG  
 LONDON  
 PIM No.XXXXXX

<b>Drawing Title</b>			
<b>GROUND FLOOR LAYOUT AS PROPOSED ACQUISITION 2017</b>			
Branch Sort Code XX-XX-XX	Branch ID XX	Supplier Project No D0881	Date 10/04/2017
Scale 1:50@A2	Drawn ICT	Checked -	Revision C
Drg.No D0881_012			Architectural Practice: S&WDesign

**CONSTRUCTION ISSUE**