

REVISIONS

Rev.	Date	By
A - General amendments following Council comments	20.12.16	MG
B - General amendments following construction development	24.10.17	MG

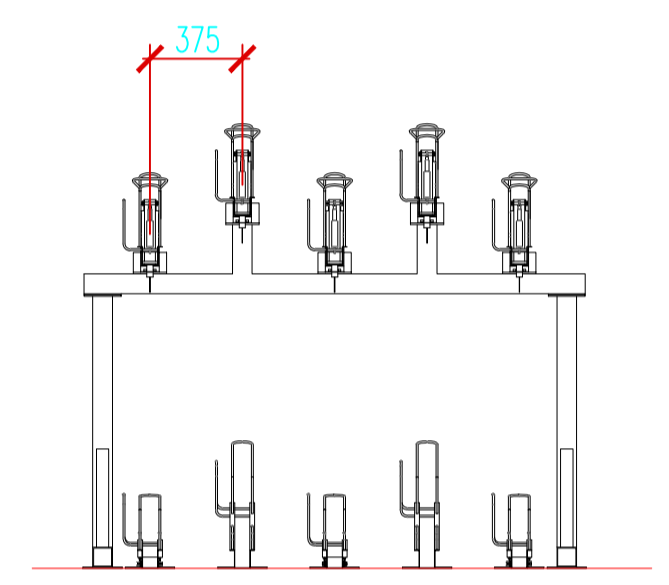
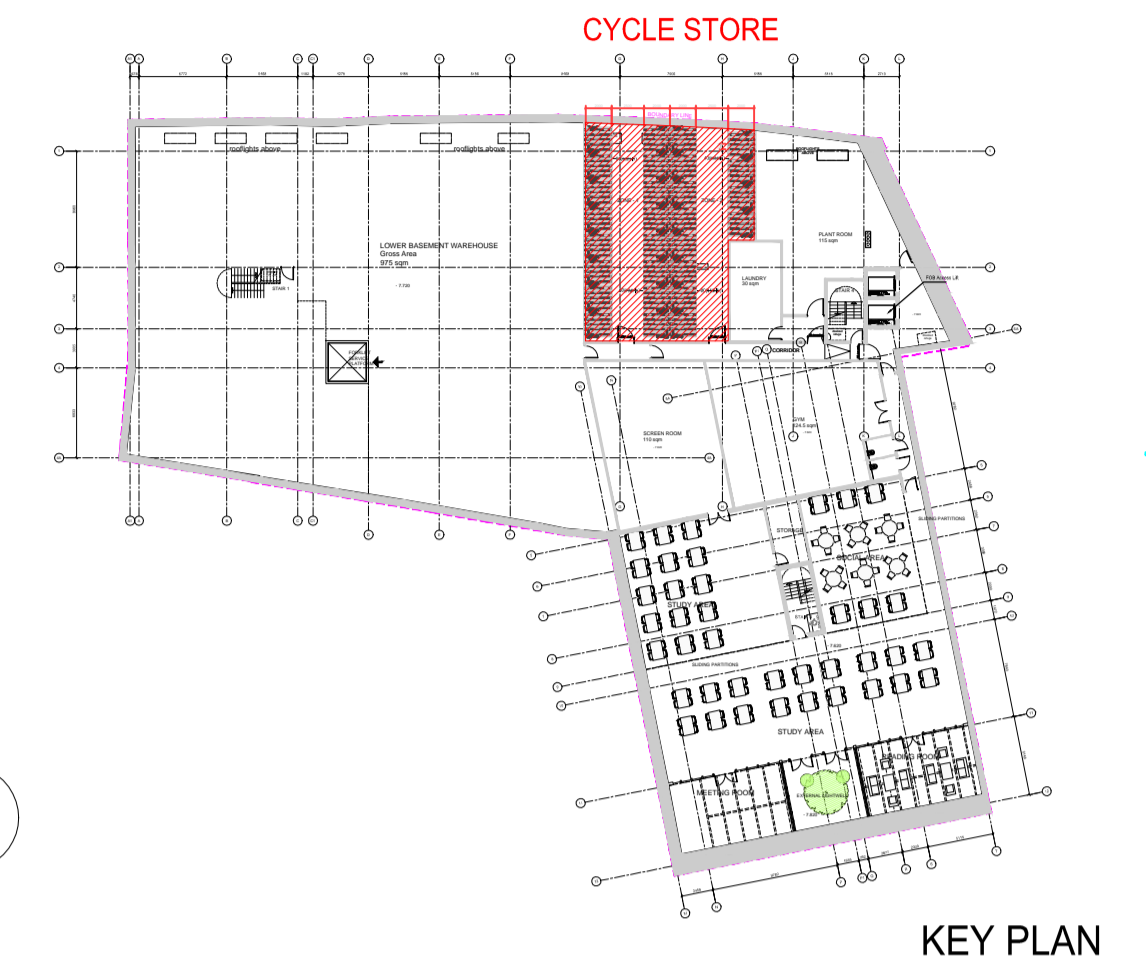
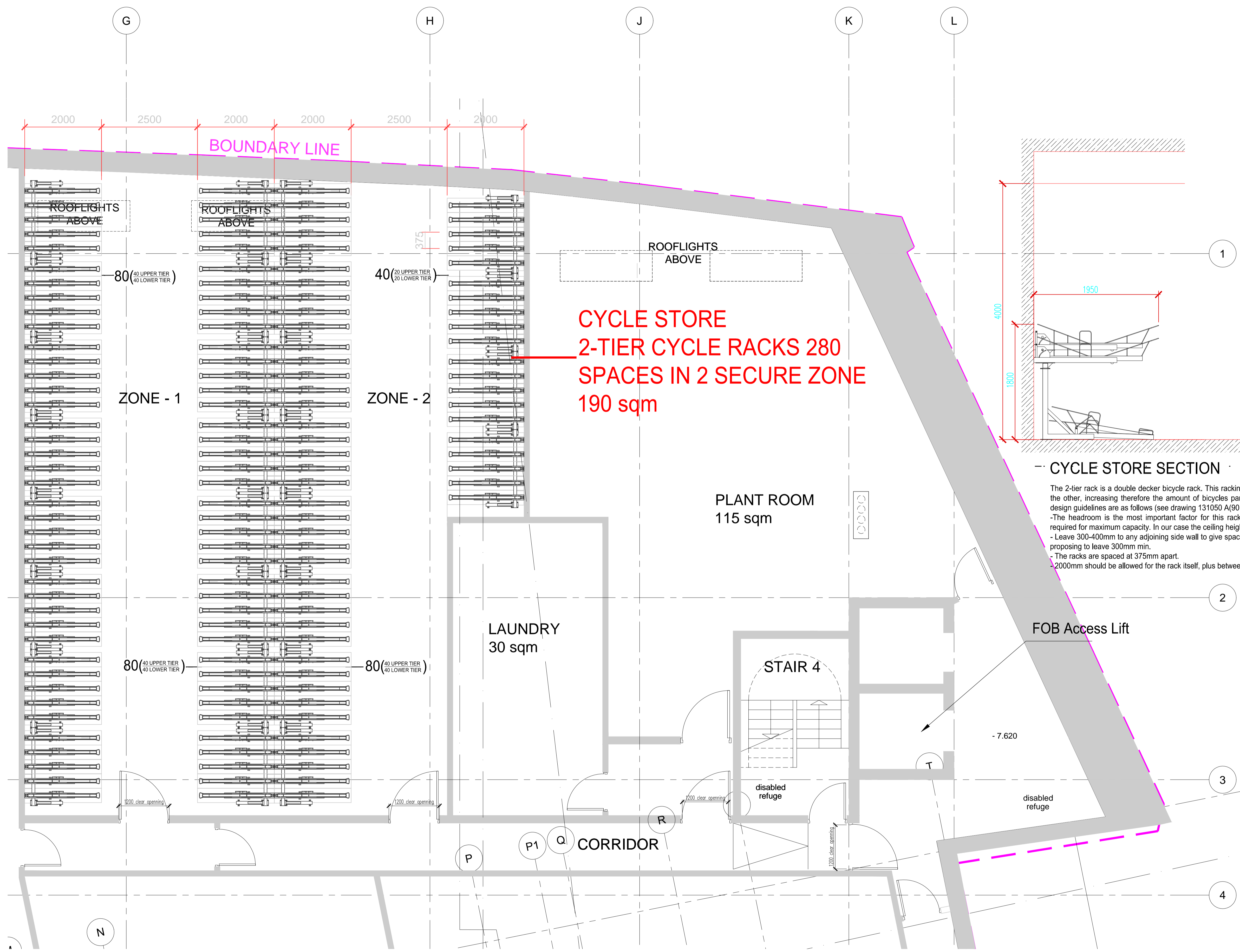

CYCLE STORE
2-TIER CYCLE RACKS 280
SPACES IN 2 SECURE ZONE
190 sqm

CYCLE STORE SECTION

The 2-tier rack is a double decker bicycle rack. This racking system stores one bike directly above the other, increasing therefore the amount of bicycles parked by up to 50%. The manufacturer's design guidelines are as follows (see drawing 131050 A(90)110_Bicycle Racks Details):

- The headroom is the most important factor for this racking system. A minimum of 2800mm is required for maximum capacity. In our case the ceiling height is 4000mm.
- Leave 300-400mm to any adjoining side wall to give space for the handlebars. In our case we are proposing to leave 300mm min.
- The racks are spaced at 375mm apart.
- 2000mm should be allowed for the rack itself, plus between 2500mm in front for access.

SUBMISSION DRAWING FOR APPROVAL OF DETAILS REQUIRED BY CONDITION 7 OF PLANNING PERMISSION DATED 06/03/2014 (ref 2013/7130/P)

PLANNING APPLICATION

ALL DIMENSIONS TO BE CHECKED ON SITE WORK TO FIGURED DIMENSIONS ONLY REPORT DISCREPANCIES TO THE ARCHITECT AT ONCE BEFORE PROCEEDING

Contemporary Design Solutions

46 Great Marlborough Street
 London
 W1F 7JW
 Telephone: 020 7494 9000 Fax: 020 7494 4944

Client
HALLMARK PROPERTY GROUP

Project Title
B8/WAREHOUSE & STUDENT ACCOMMODATION
 65-69 HOLMES ROAD

Drawing Title
LOWER BASEMENT FLOOR
CYCLE STORE

Scale 1:150@A1 1:100@A3 Date Oct 2017
 Drawn MG Checked CT
 Drawing No. 131050 A(90)080 Rev. B

LOWER BASEMENT PLAN

