

1 Head Detail C
596_D521

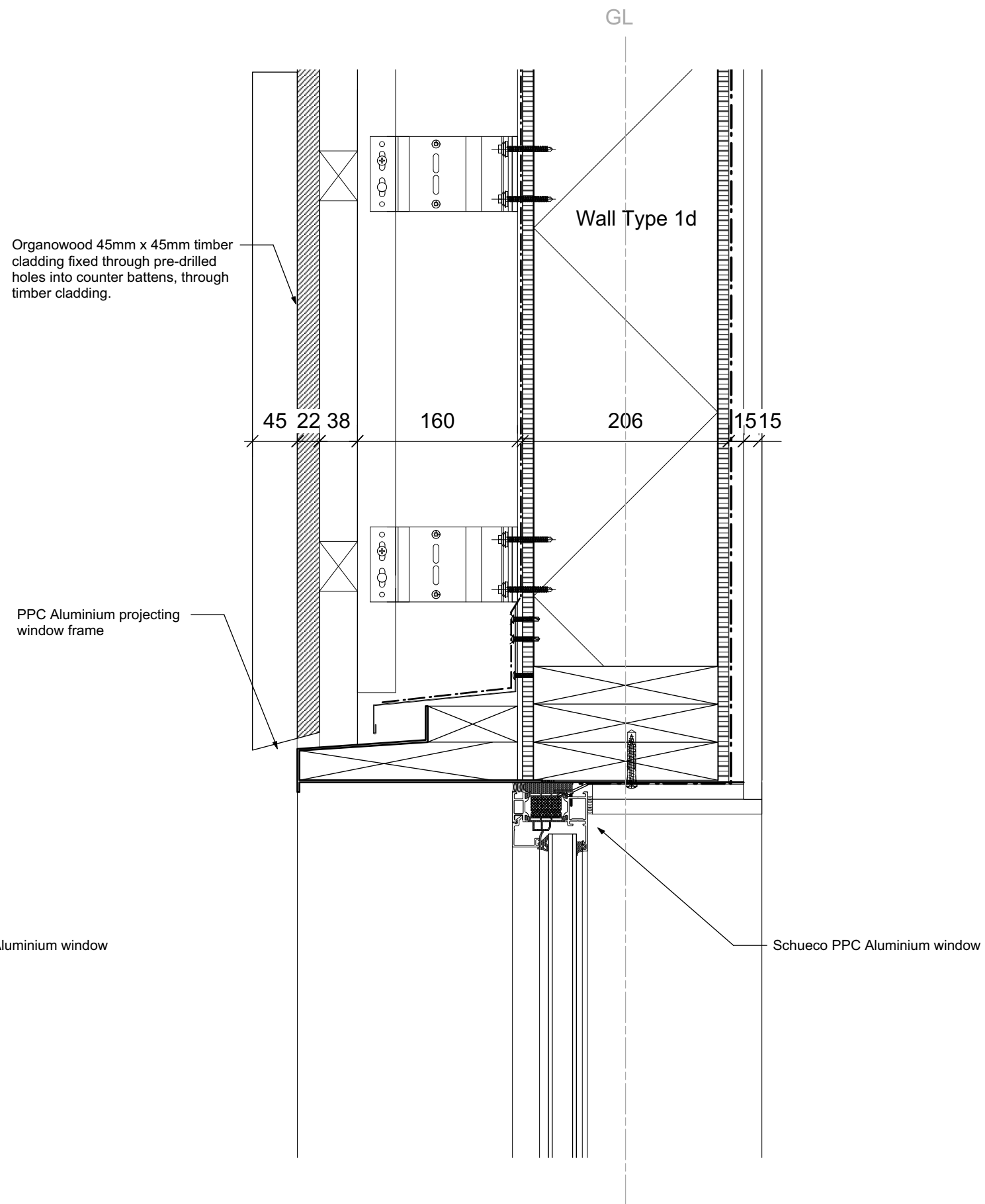

2 Head Detail D
596_D521

notes		
REVISIONS		
rev. no.	date	description
P1	15-07-17	Discharge of Planning Conditions
T1	28-04-17	Tender Issue
KINGSGATE PRIMARY SCHOOL KS2 EXPANSION CAMDEN - NW6 2JG		job title
Glazing Detail - Head Types C+D		dwg. title
1:5@A3	scale	KT drawn
596_D521	dwg. no.	rev. no.
596	date 15.07.17	P1
PLANNING		status