

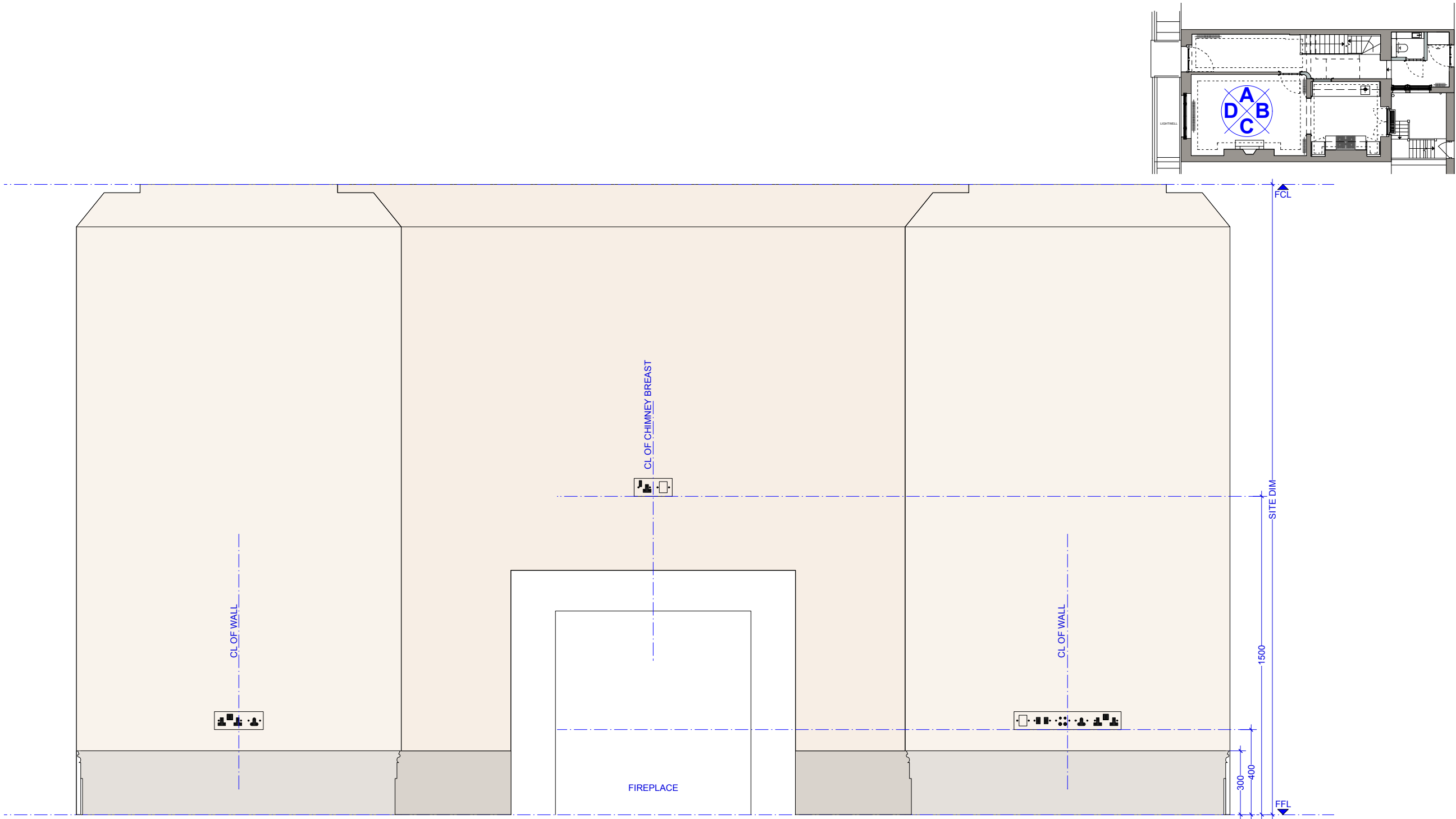

1:20@A3



DETAIL C

KEY	FINISHES
	Ceramic tiles finished
	Painted timber finished
	Painted plaster finished

NOTES:
· DO NOT SCALE FROM THIS DRAWING.
· ALL DIMENSIONS TO BE CHECKED ON SITE.
· ALL OMISSIONS AND DISCREPANCIES TO BE REPORTED TO THE ARCHITECT IMMEDIATELY

NORTH POINT



TF ARCHITECTURE

2-3 WOODSTOCK STREET
LONDON W1C 2AB

T. 020 7052 0756
F. 020 7052 0757
E. info@tfarchitecture.com

CLIENT	CROWN STATE			
PROJECT	10 CHESTER PLACE, LONDON NW1			
DRAWING TITLE	PLANNING	INTERNAL ELEVATIONS_DINING ROOM_PROPOSED		
DATE	171006	SCALE	1:20@A3	JOB NO. 471
DRWG NO.		DET.113.2	REV.	