

BLOCK C



SOUTHAMPTON SQUARE
FFL +34.500

+54.300
+52.200
ROOF FFL +51.075
04 FFL +47.550
03 FFL +44.400
02 FFL +41.250
01 FFL +37.875
GF FFL +34.500



AREA FOR PVS

1B2P

1B2P

1B2P

3B5P Duplex

3B5P Duplex

FFL +34.000

SITE BOUNDARY

INTERCHANGE BUILDING

GILBEYS YARD

MORRISONS SERVICE YARD
FFL +26.800

MORRISONS WAREHOUSE
FFL +28.000

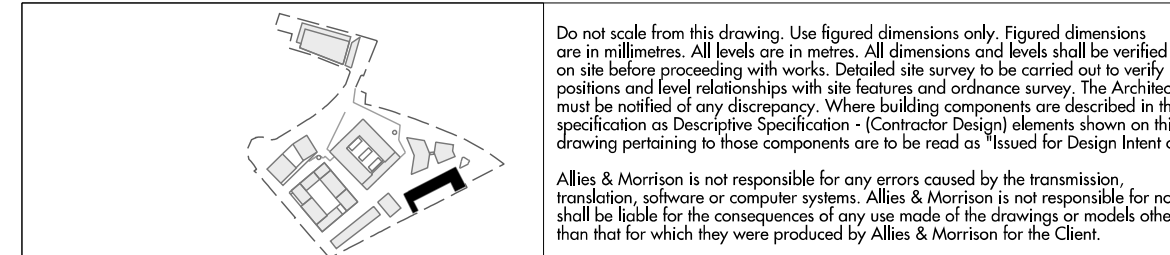

REV	DATE	DESCRIPTION	ISS	REV	DATE	DESCRIPTION	ISS
P1	20/06/17	ISSUES FOR MARKING	MCJ				
P2	03/10/17	ISSUES FOR MARKING - AMENDMENTS	MCJ				

AMENDMENTS:
- canopy above ground floor duplex entrances moved below brick
- planters pushed back to be flush with facade
- brick parapet replaced with balustrade

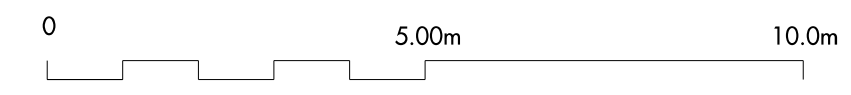

NOTES

Allies and Morrison
85 Southwark Street
London SE1 0XK
020 7921 0100
020 7921 0101
info@alliesandmorrison.com
A&M JOB NO: 1095

CAMDEN GOODS YARD
BLOCK D
SECTION AA
1095_04_07_300
SCALE 1:100 @A0

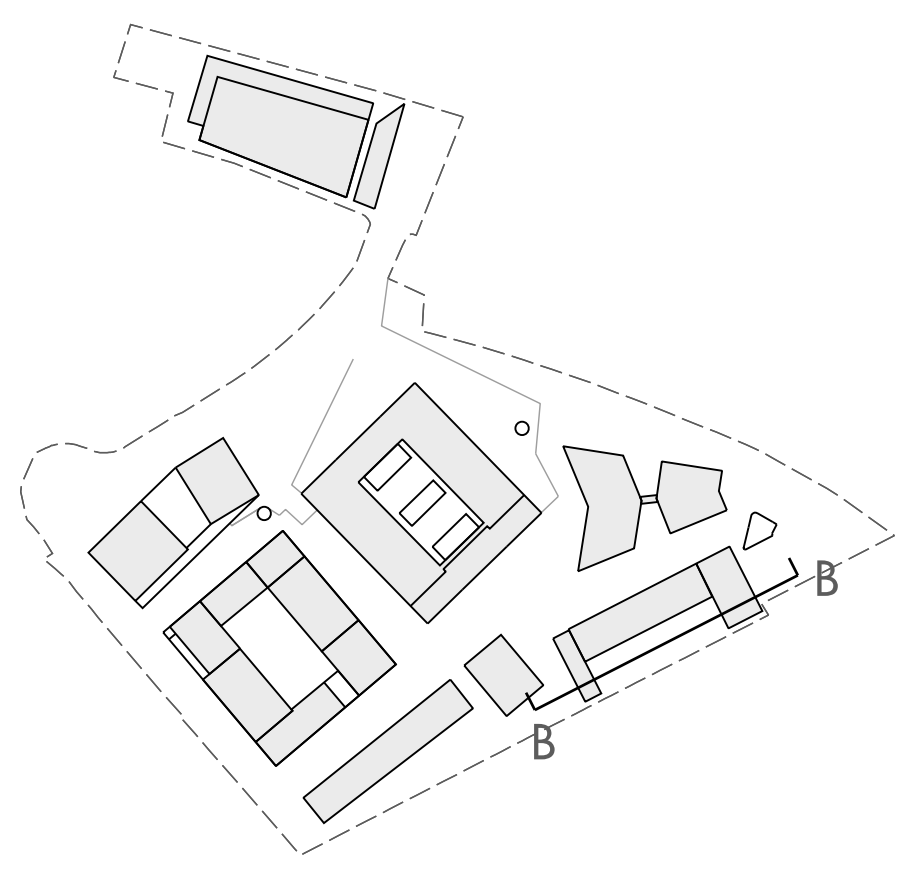

REV	DATE	DESCRIPTION	ISS	REV	DATE	DESCRIPTION	ISS
P1	30/06/17	ISSUES FOR MARKING	MCJ				
P2	02/10/17	ISSUES FOR MARKING AMENDMENTS	MCJ				

AMENDMENTS:
 - eastern part of building - parapet height reduced and 1m recessed balustrade added
 - retail structure - parapet reduced by 200mm
 - ground floor plant room openings changed

NOTES

Allies and Morrison
 85 Southwark Street
 London SE1 0YK
 telephone 020 7921 0100
 facsimile 020 7921 0101
 email info@alliesandmorrison.com
 A&M JOB NO: 1095
 SCALE 1:100 @A0

CAMDEN GOODS YARD
BLOCK D
SECTION BB
1095_04_07_301
 SCALE 1:100 @A0

P2
 Revision