





CONSTRUCTION KEY

-  existing retained
-  line over/under/behind
-  demolished
-  new construction
-  28mm thick drylining (incorporating Newton 503 mesh & 12.5mm plasterboard)

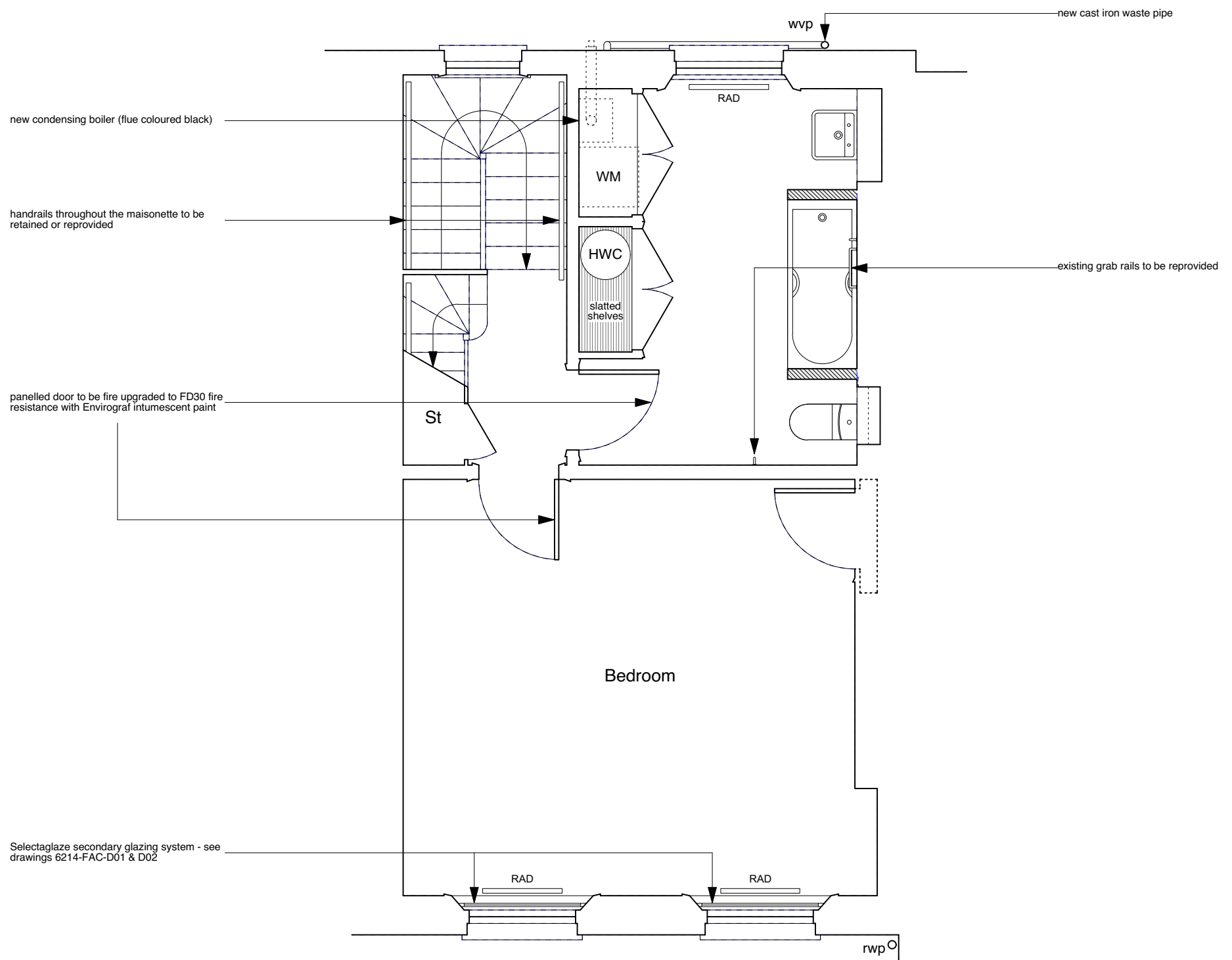

NOTE:

Existing ceiling plasterboard to be replaced throughout second floor (1 hour fire resisting) on resilient bars.

Existing, flush internal doors to be replaced with solid timber flush fire doors.

Defective, non-original sash windows to be replaced like-for-like but without horns and using stretched ovolo mouldings/glazing bars & hardwood cills.