





CONSTRUCTION KEY

-  existing retained
-  line over/under/behind
-  demolished
-  new construction
-  28mm thick drylining (incorporating Newton 503 mesh & 12.5mm plasterboard)

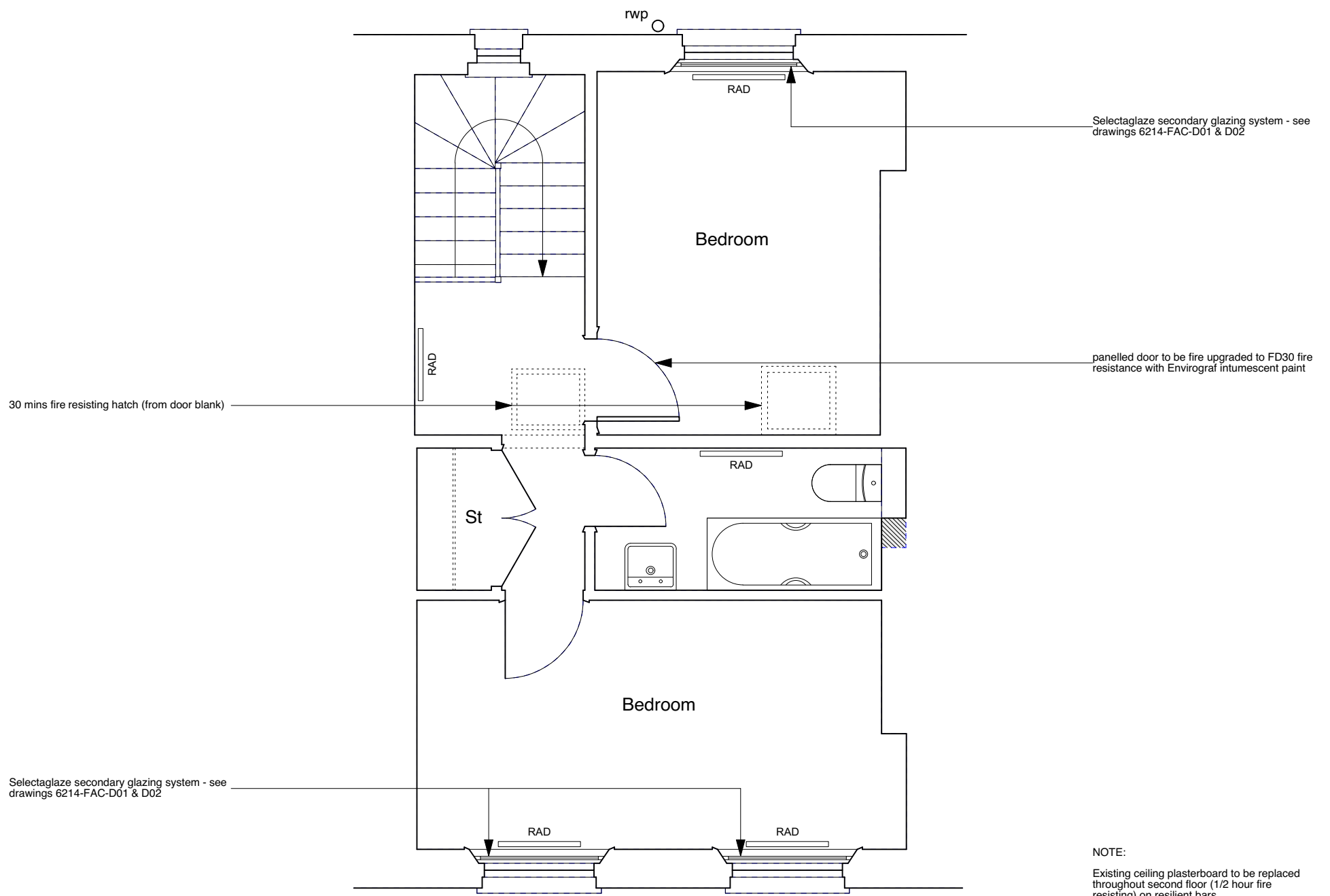

NOTE:
 Existing ceiling plasterboard to be replaced throughout second floor (1/2 hour fire resisting) on resilient bars.
 Existing, flush internal doors to be replaced with solid timber flush fire doors.
 Defective, non-original sash windows to be replaced like-for-like but without horns and using stretched ovolo mouldings/glazing bars & hardwood cills.