

CONSTRUCTION KEY

- existing retained
- line over/under/behind
- demolished
- new construction
- 28mm thick drylining (incorporating Newton 503 mesh & 12.5mm plasterboard)

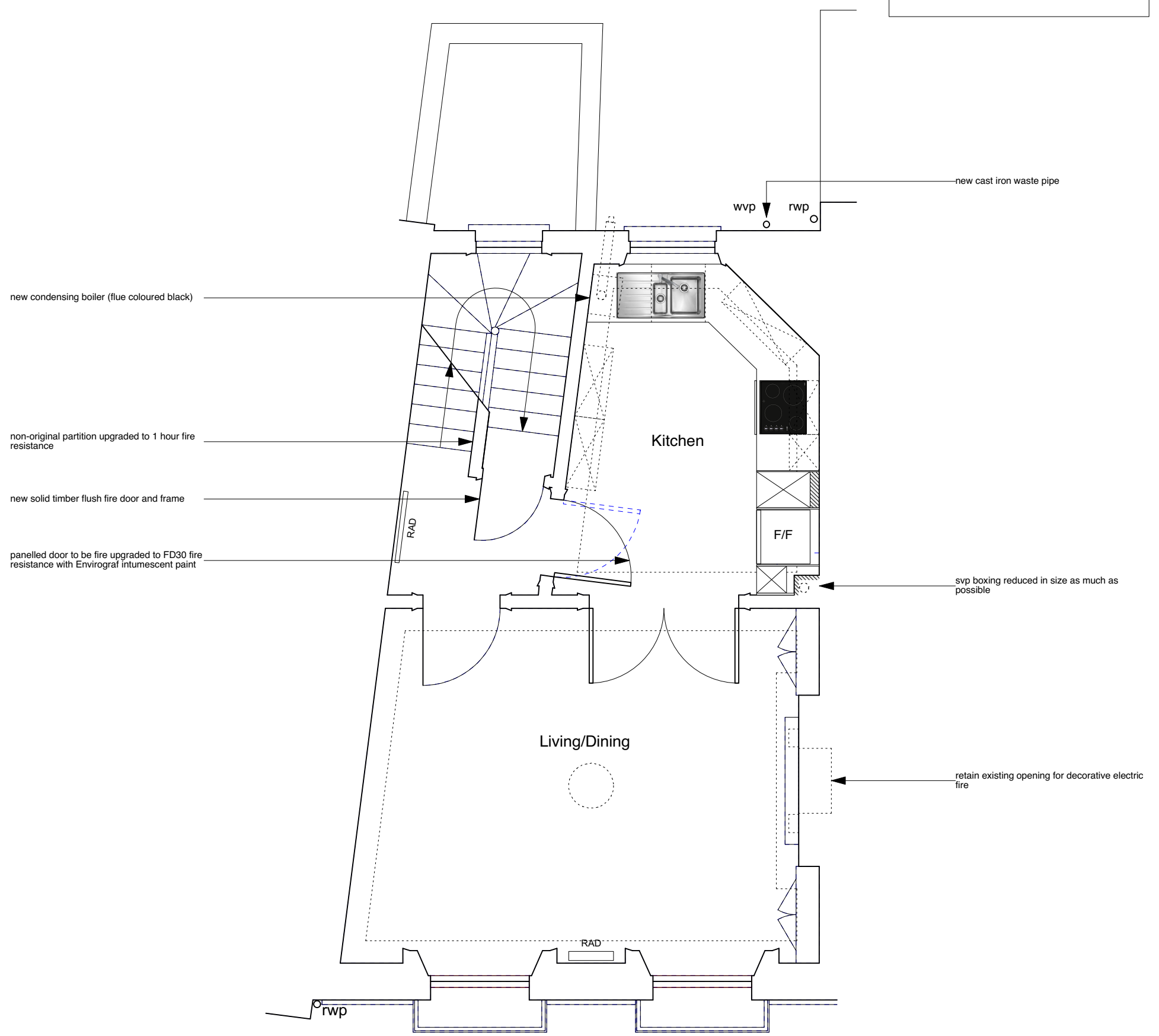

NOTE:
 Existing, flush internal doors to be replaced with solid timber flush fire doors.
 Defective, non-original sash windows to be replaced like-for-like but without horns and using stretched ovolo mouldings/glazing bars & hardwood cills.

	PROJECT 5 ARCHITECTURE LLP 8 Waterson Street London E2 8HL T: +44 (0)20 7739 9131 F: +44 (0)20 7739 3687 E: info@p5a.co.uk	job title 16 FREDERICK STREET, LONDON WC1X 0ND	scale 1:50 @ A3	drawn SA	drawing no. 6214-FS16-P03
	drawing FIRST FLOOR PLAN - PROPOSED	date JUNE 2017	checked XX		