

TYPICAL PLANTING TO BE SELECTED FROM A PALETTE INCLUDING:

Note: This indicative planting palette reflects the environmental conditions expected in the planting locations, whilst also complementing the aesthetic of the hard landscape materials and architectural palette. The palette has been developed in reference to advice within Camden's Biodiversity Action Plan and surrounding resources such as Canley Street Natural Park and aims to be inclusive of the goals of being wildlife friendly and being predominately composed of native species. Non-native species that are known harmful invasives will be completely avoided. The planting style will generally be in swathes of species intended to appear natural.

Proposed Trees				
Abbreviation	Species	Size/Spec	Girth	Condition
Ac	Acer campestre	Clear stem	20-25cm	RB, 2m clear stem
Gt	Gleditsia triacanthos	Clear stem	5m ht minimum	RB, 2m clear stem
Ph	Platanus x hispanica	Clear stem	35-40cm	RB, 2m clear stem
Sa	Sorbus aria	Multi-stem	15-20cm	RB

Proposed Shrub, Grass and Perennial Planting				
Species	Size/Specification	Density/m2	Condition	
Anemone nemorosa	C5	5	CG	
Alchemilla mollis	C3	7	CG	
Artemisia 'tuff'	C5	5	CG	
Aurinia saxatilis	C5	5	CG	
Asarum europaeum	C2	11	CG	
Asplenium scolopendrium	C3	7	CG	
Calamagrostis 'Karl Forester'	C5	5	CG	
Carex pendula	C5	5	CG	
Centranthus ruber	C5	5	CG	
Chimonanthus praecox 'Luteus'	C7,5	3	CG	
Cornus sanguinea 'Midwinter Fire'	C5	5	CG	
Deschampsia cespitosa	C7,5	5	CG	
Digitalis purpurea	C5	5	CG	
Dryopteris erythrosora	C3	7	CG	
Escallonia rubra 'Crimson Spire'	C7,5	3	CG	
Epilobium perralichicum 'frohnhilfian'	C3	7	CG	
Fuchsia magellanica var. 'gracilis Aurea'	C5	5	CG	
Hosta devon green	C3	7	CG	
Lavandula angustifolia 'Hidcote'	C5	5	CG	
Ligustrum vulgare 'Lodense'	C3	7	CG	
Liriope Ingwersen	C3	7	CG	
Olearia x haszlii	C5	5	CG	
Pachysandra terminalis	C3	7	CG	
Polystichum polyblepharum	C5	5	CG	
Polypodium vulgare	C3	7	CG	
Stachys officinalis	C3	7	CG	
Viburnum davidii	C7,5	5	CG	

Proposed Climbers				
Species	Size/Specification	Density/m2	Condition	
Hedera helix	C5	5	CG	

Proposed Bulb Planting				
Species	Size/Specification	Density/m2	Condition	
Narcissus pseudonarcissus	topsize	10		
Crocus sp.	topsize	10		

- Notes:**
- Any works outside of the project boundary are shown indicatively for design intent purposes and are subject to the London Borough of Camden Highways Approval and S278 agreement.
 - All product references are to be 'or similar approved.'
 - All doors opening outward to be installed with door protections.
 - This drawing is the property of fabrik. It must not be copied or reproduced without written consent.
 - This drawing shall be read in conjunction with all relevant contract drawings and fabrik Landscape Specification with any conflicting information to be brought to the attention of fabrik before work commences.
 - All dimensions are in millimeters unless otherwise specified.
 - Only figured dimensions are to be taken from this drawing. All contractors must visit site and be responsible for taking and checking all dimensions related to the works shown on the drawing.
 - All dimensions and sizes of units to be verified by the contractor on shop drawings for each element before the commencement of works.
 - All concrete structures/members to structural engineer's/architect's detail.
 - All supportings to manufacturer's/engineer's detail.
 - All tree supporting measures to contractor design and approved by fabrik Ltd. and the engineers.
 - All trees/shrubs/hedges planted at nursery level.
 - All stone paving to meet BS EN 1341 - 1342 requirements.
 - All paving patterns are illustrative and subject to design development.
 - This Drawing uses coloured lines. Please do not rely on a monochrome copy.

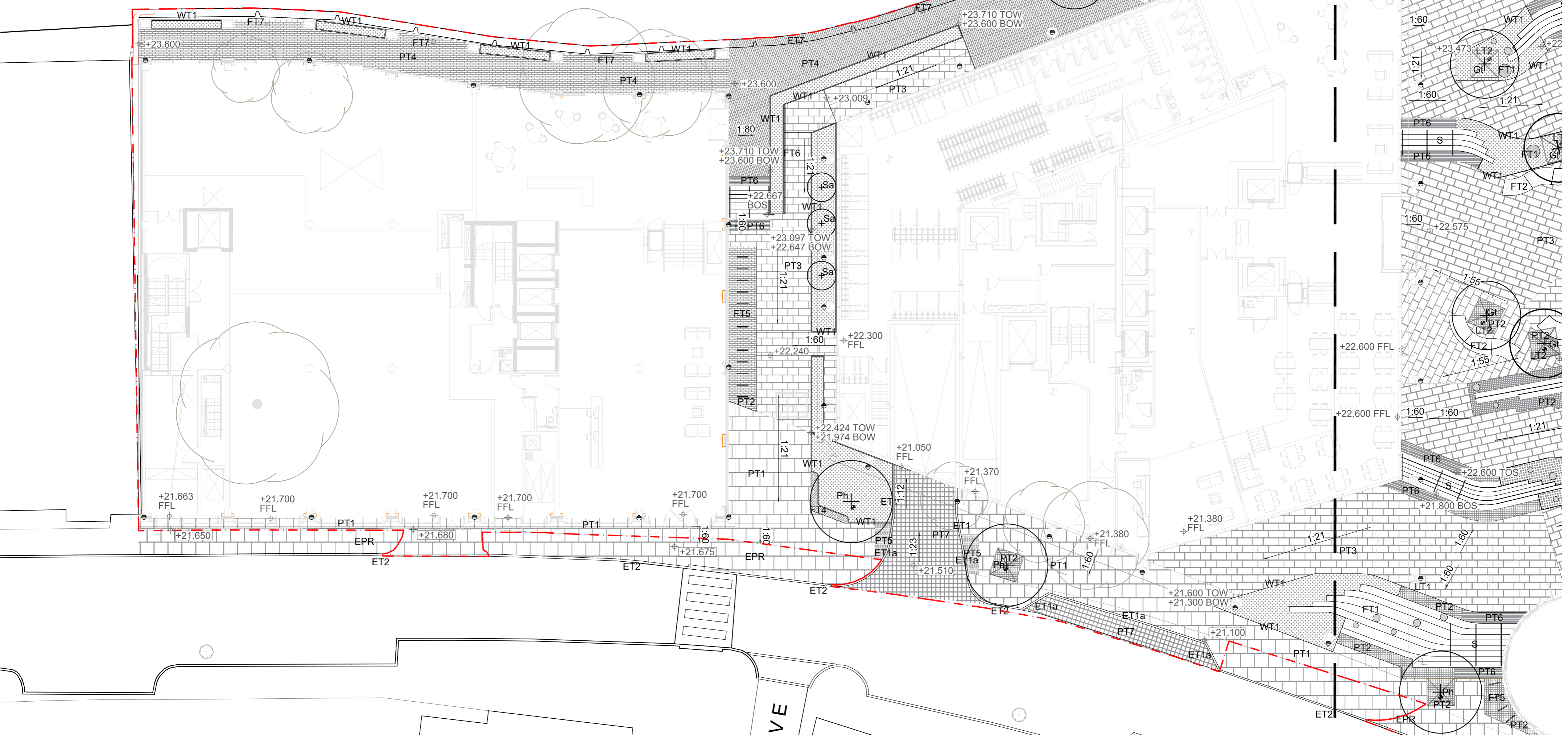

KEY LEGEND - PROPOSED HARD LANDSCAPE

- Application Site
- Building Overhang
- EPR: Existing paving retained and made good as necessary
- PT1: Paving type 1 - Concrete flag paving to match specification of existing Camden Standard pedestrian paving along St Pancras Way
- PT2: Paving type 2 - Sandstone cropped setts paving Size: 100mm x 100mm
- PT3: Paving type 3 - Cambrian Sandstone Size: Mix of widths - 130mm, 450mm, 600mm x variable lengths
- PT4: Paving type 4 - Bricks clay pavers Size: 215x52x70mm
- PT5: Paving type 5 - Hazard warning stainless steel blister tactile paving Size: 400x400mm.
- PT6: Paving type 6 - Sandstone hazard warning corduroy flag paving. Size: 400x400mm
- PT7: Paving type 7 - Granite Setts to Camden Highways Standard.
- ET1: Edge type 1 - Granite kerb to match existing. Transitions and radius as required, 125mm raised. Size: 205 (w) x 255 (d) x 915 (l)
- ET1a: Edge type 1a - Granite kerb installed flush with adjacent paving. Size: 205 (w) x 255 (d) x 915 (l)
- ET2: Edge type 2 - Granite kerb to be retained / replaced if necessary with similar installed, 125mm raised. Size: 205 (w) x 255 (d) x 915 (l)
- WT1: Wall type 1 - Raised metal edge planter wall Height: Varies. Max. 600mm above adjacent level

- FT1: Furniture type 1 - LED illuminated street furniture fixed onto ground.
- FT2: Furniture type 2 - Modular bench with illuminated LED.
- FT3: Furniture type 3 - Timber bench with armrest and backrest
- FT4: Furniture type 4 - Bespoke timber bench integrated with metal edge planter
- FT5: Furniture type 5 - Stainless steel cycle stands
- FT6: Furniture type 6 - Stainless steel wire balustrade 1100mm height
- FT7: Furniture type 7 - Mooring bollards Positions and numbers shown indicatively, to be agreed in consultation with Canal&River Trust / London Borough of Camden.
- FT8: Furniture type 8 - Recessed tree pit
- LT1: Lighting type 1 - Wall / column mounted light
- LT2: Lighting type 2 - Plant uplighter
- LT3: Lighting type 3 - Handrail light refer to S for location
- LT4: Lighting type 4 - LED light refer to FT1 for location

Note: Lighting layout is indicative only and to be developed by lighting engineer.

KEY LEGEND - PROPOSED SOFT LANDSCAPE - refer to D2477 L.200 for specification

- Proposed ornamental shrub planting
- Existing tree to be removed
- Platanus x hispanica
- Geditsia triacanthos
- Acer campestre
- Sorbus aria

fabrik

First Floor
4-8 Emerson Street
London
SE1 9DU

T: 0207 620 1453
E: london@fabrikuk.com
W: www.fabrikuk.com

0 1 2.5 5 7.5 10 15 20m north

Project: Transformation of the Ugly Brown Building, St Pancras Way for Reef Estates Limited

Scale: 1:200 @ A1

Date: May '17

Checked: JR

Drawn: CG

Drawing No.: D2477 L.200

Revision: B

Drawing: Typical Hard and Soft Landscape General Arrangement Plan - Sheet 1 of 2

Legend: Preliminary, Issued for Planning Approval, Issued for Construction, Issued for Design/Information, Issued for Tender, As Built

Copyright Reserved ©

Refer to drawing D2477 L.201