

Approved Ground Floor Plan - 2016/3133/P

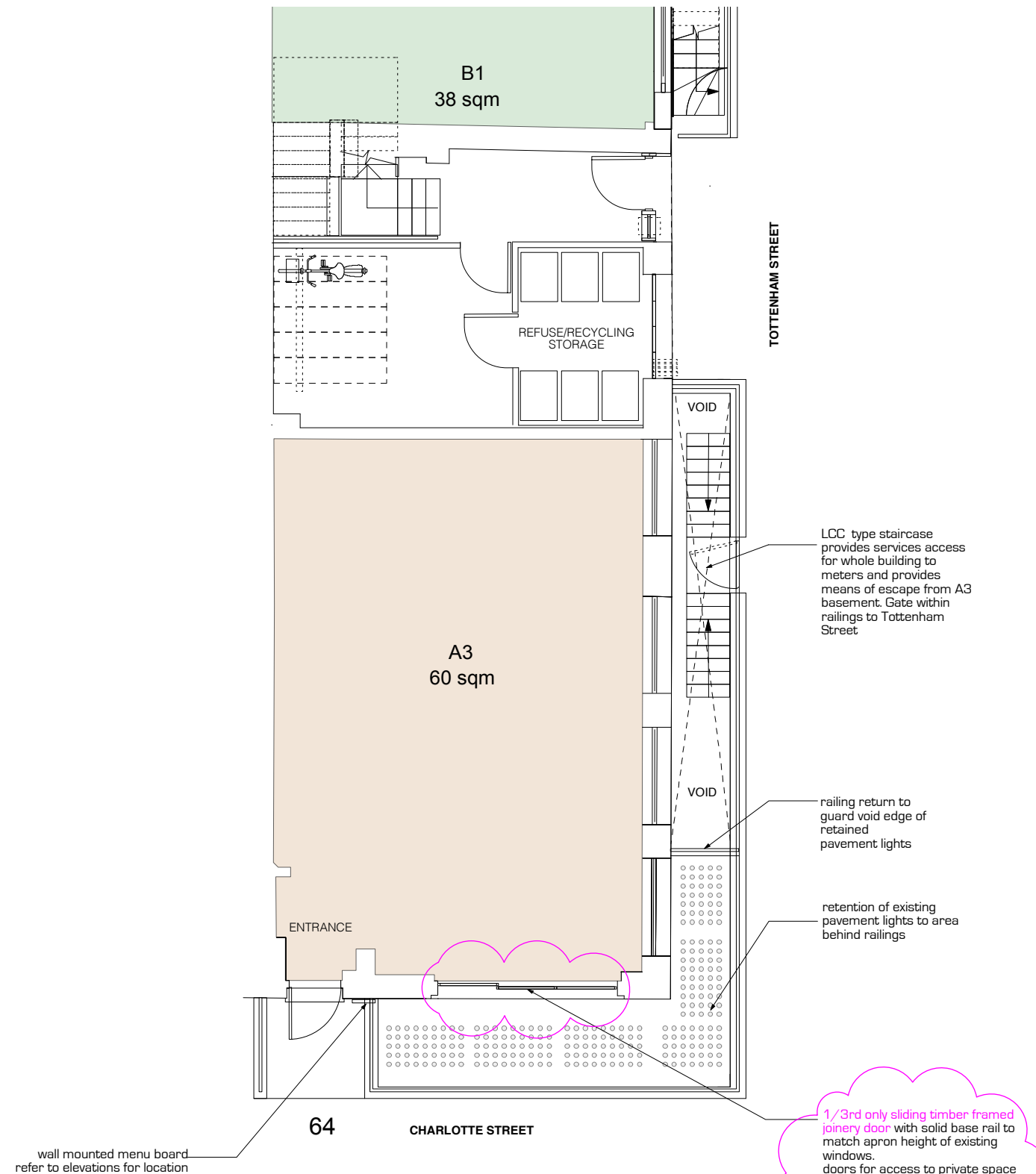

Proposed Ground Floor Plan

1/3rd only sliding timber framed joinery door with solid base rail to match apron height of existing windows. doors for access to private space behind railings and natural ventilation. joinery to be gloss painted 'heritage colour' from F&B or similar" on ogee sections to match existing

cdm statement

Any information given on this drawing must be used in conjunction with the construction health and safety plan prepared by the principal contractor. The planning supervisor must be consulted before any construction work commences. Any changes in design, or conditions arising or information becoming known at a later date that may adversely impact upon health and safety of any person, must be notified to the planning supervisor and principal contractor as soon as possible.

spaced out ltd.
4a godson street
london n1 9gz
tel: +44 (0)20 78 33 9236
email: info@spacedout.co.uk
www.spacedout.co.uk

RIBA Chartered Architects

- all dimensions to be checked on site by contractor
- all dimensions remain the responsibility of the contractor
- all project activity to be covered by CDM regs, rev2015
- all designs are the property of spaced out © 2017

revisions:

- A 25.06.2017 - external well
- B 01.09.2017 - single sliding door

project: **KAZU 和**

drawing:
Approved and Proposed
Ground Floor Plan

client: Paragon Holdings Ltd

scale: 1:100 @ A3

dwg.no: 17.227.104

B

purpose of issue:

original issue date:
21.02.2017

